



STRADA Whisper : The Next-Gen 25-Gbps Connector

EVERY CONNECTION COUNTS



Whisper Electrical Review

- Power Sum FEXT is lower than -50 dB for system implementation at 12.5 GHz
- Insertion loss is less than 1dB and linear up to 20 GHz
- Individual shielded pairs offer excellent signal integrity / EMI performance
- Little to no skew through high-speed differential pairs
- Common mode impedance controlled throughout the connector, including footprint and mating interface
- Superior 25-Gbps electrical performance maintained even in a 1.5mm unmated condition
- No reliance on noise cancellation which can be critical in high-speed applications, unlike some competitive products
- 85-Ohm and 100-Ohm versions available



STRADA Whisper 3.9mm Connector

STANDARD CONSTRUCTION

EVERY CONNECTION COUNTS



High-Performance Backplane Solution

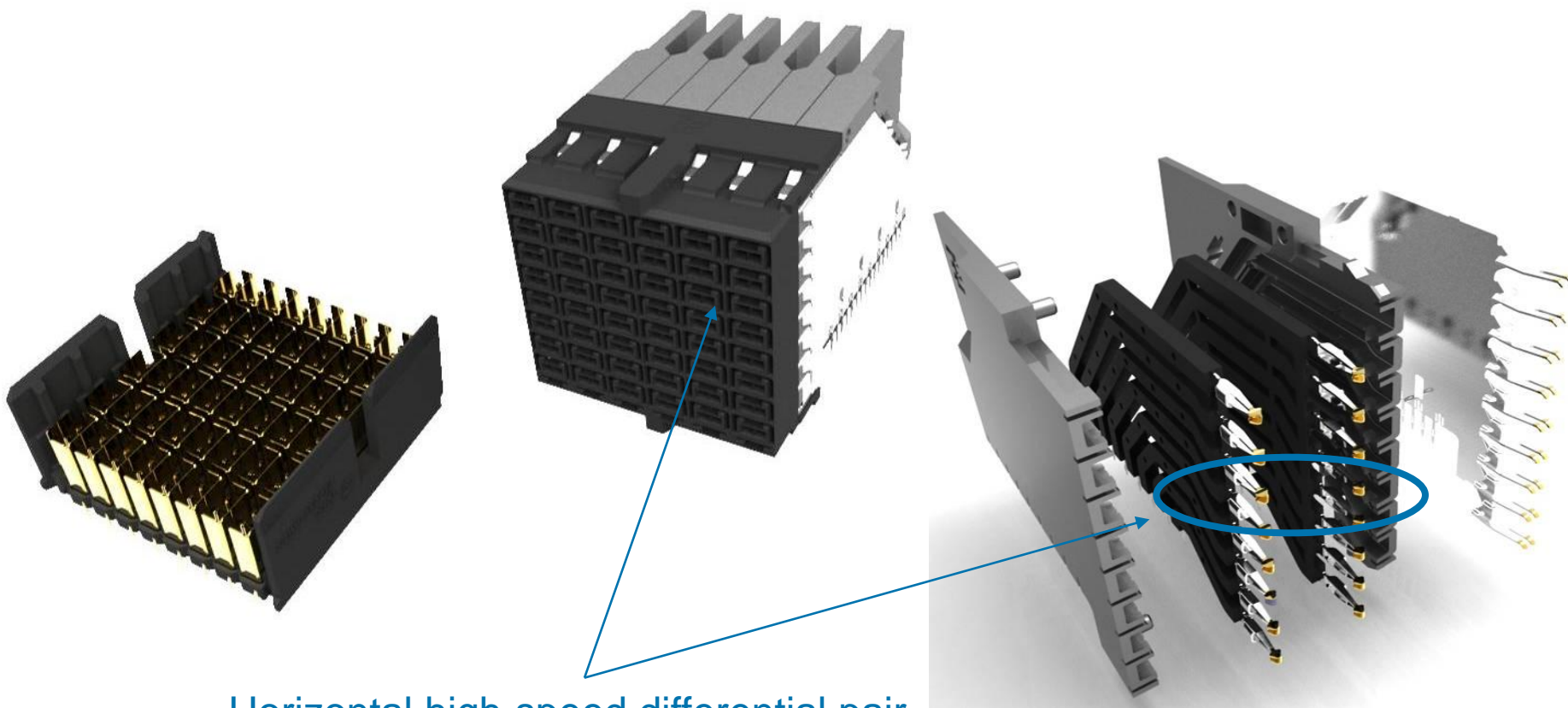

Horizontal high-speed differential pair
“Zero Skew” through connector

Receptacle Assembly: 6-pair 4-column (6x4)

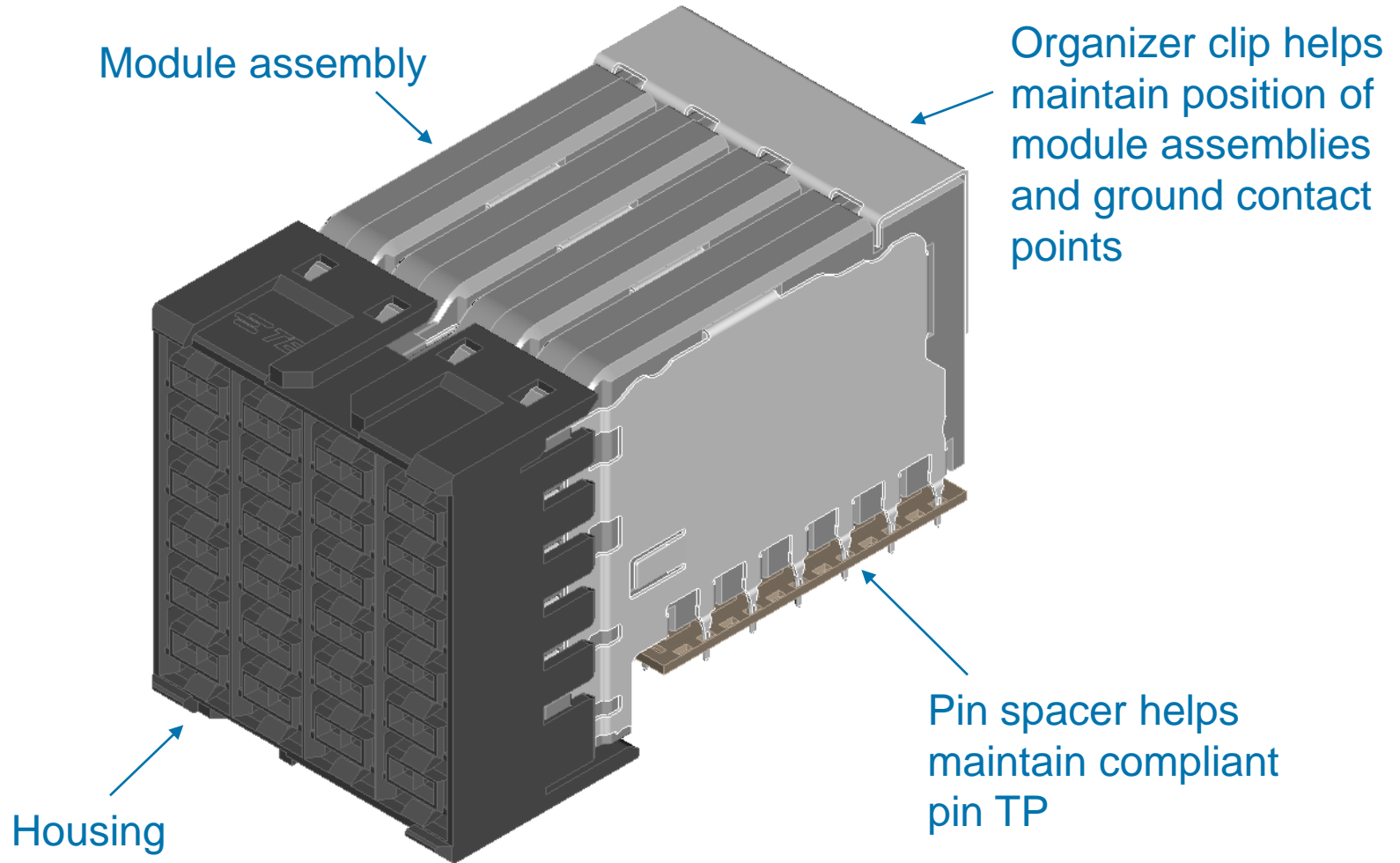

Receptacle Assembly: Front Housing Mating Interface

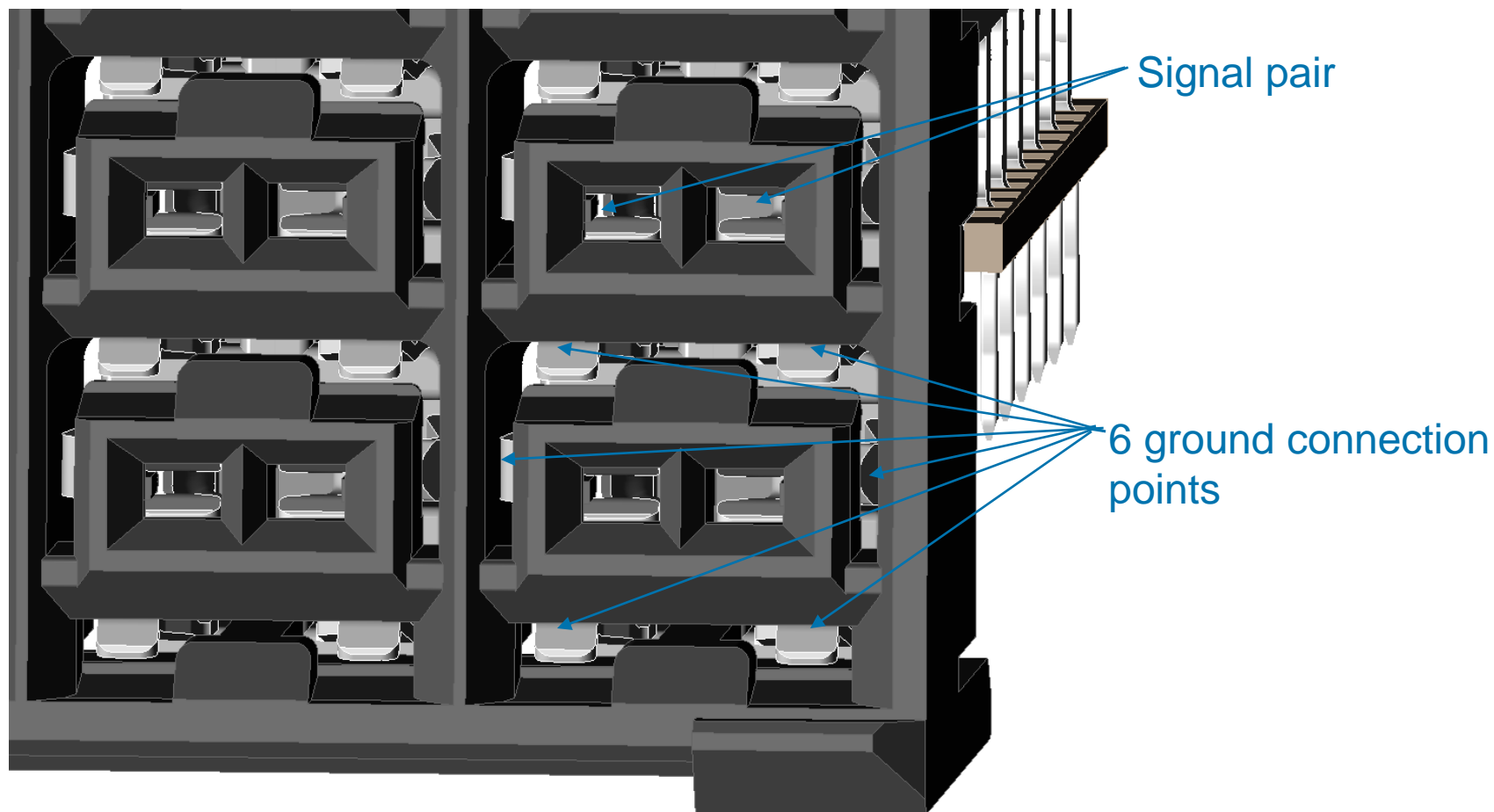

Receptacle Module Assembly: Shield Contacts

All shield springs
mate on the inside
of the header
C-Shield

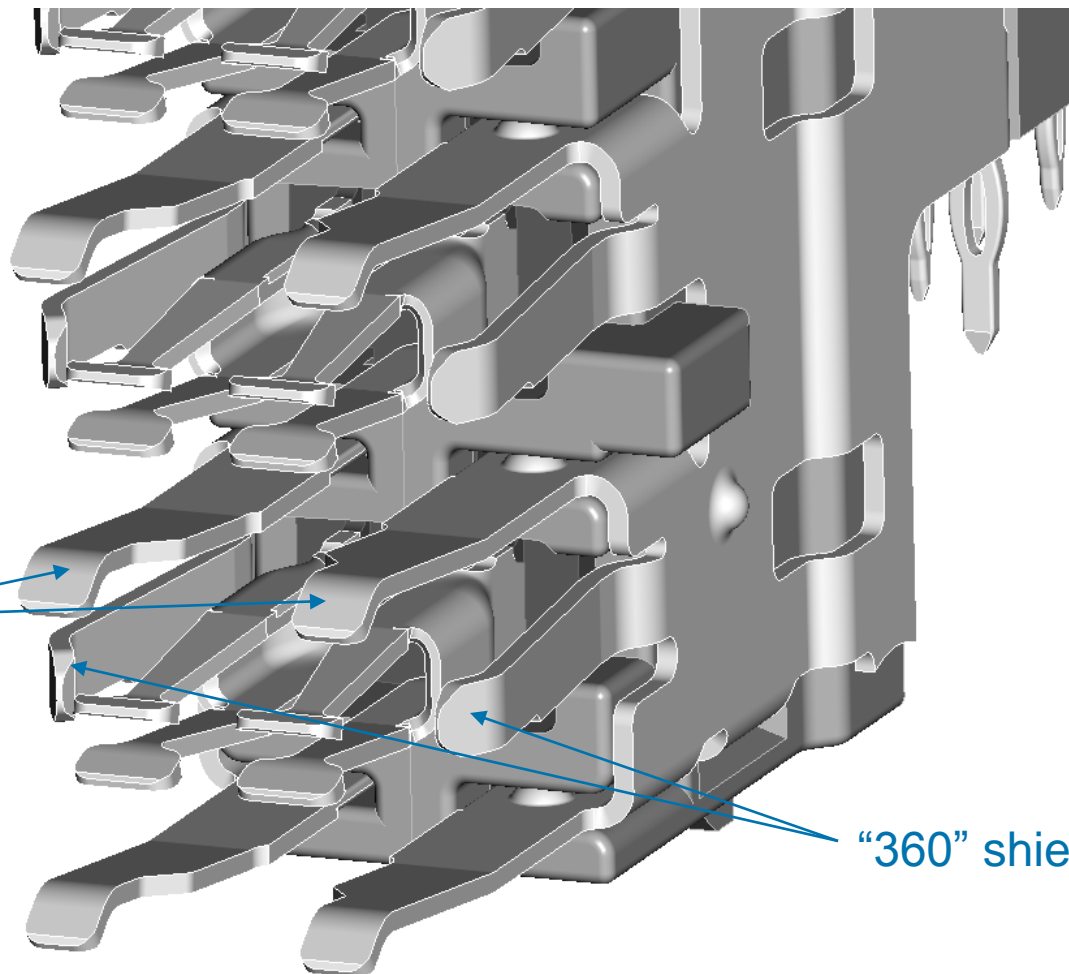

Horizontal shield
springs

"360" shield springs

Receptacle Module Assembly (Shields Hidden): Receptacle Contact

Signal contacts have two points of contact

Wide paddle tips ensure maximum contact surface area when interfacing with header pin for added robustness

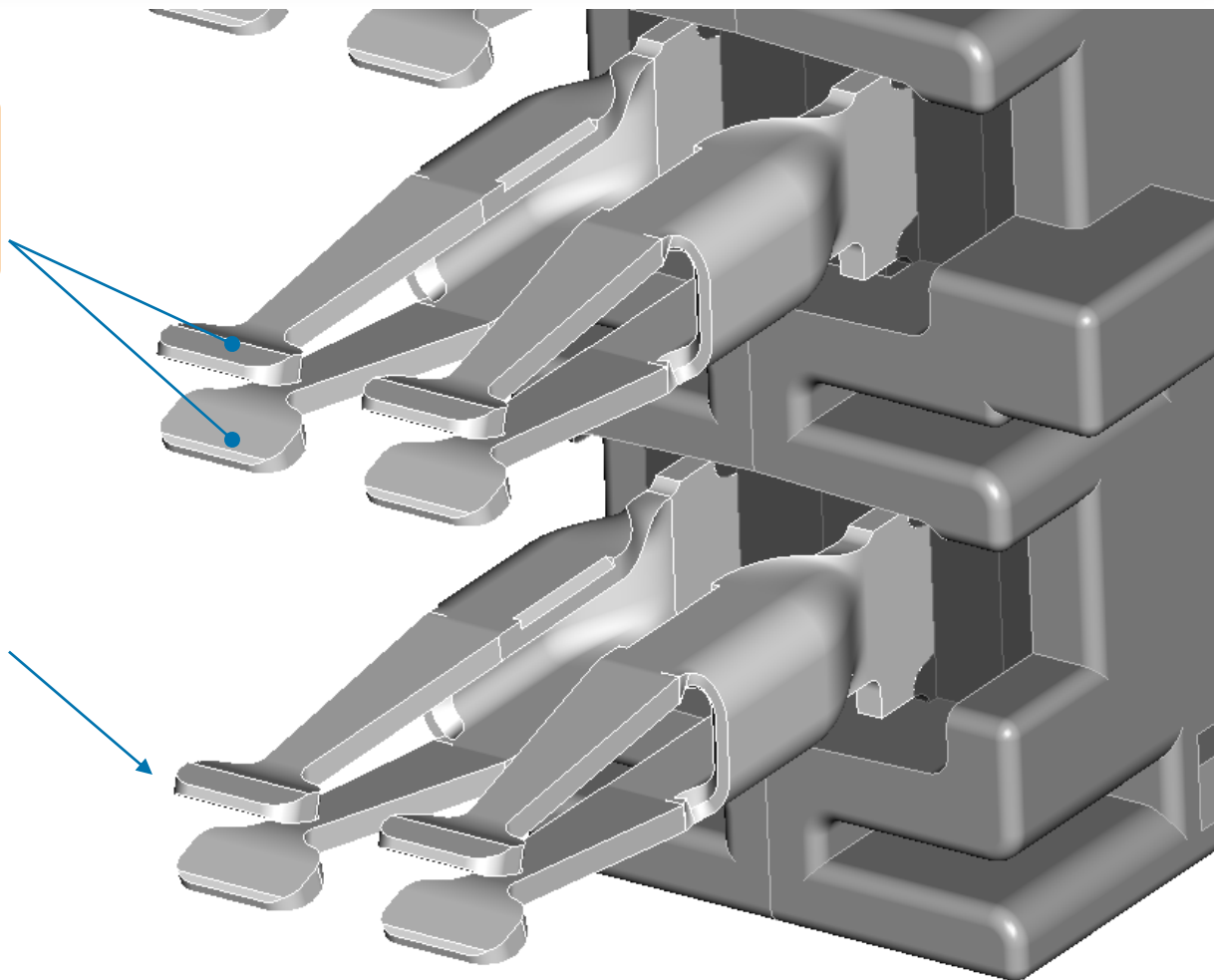

Header Assembly: Open End Wall 6x4

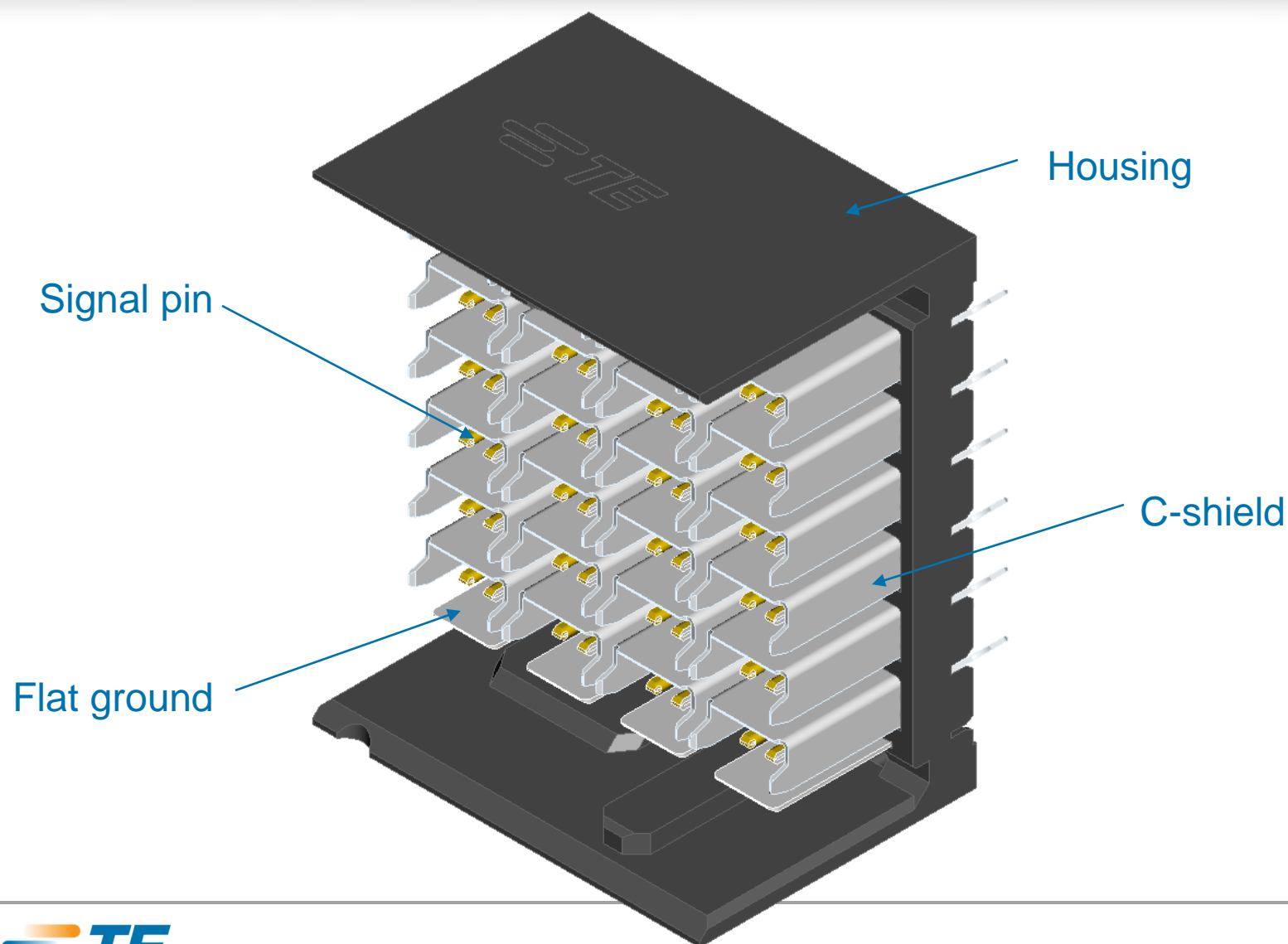

Header Assembly C-Shield Contact Detail

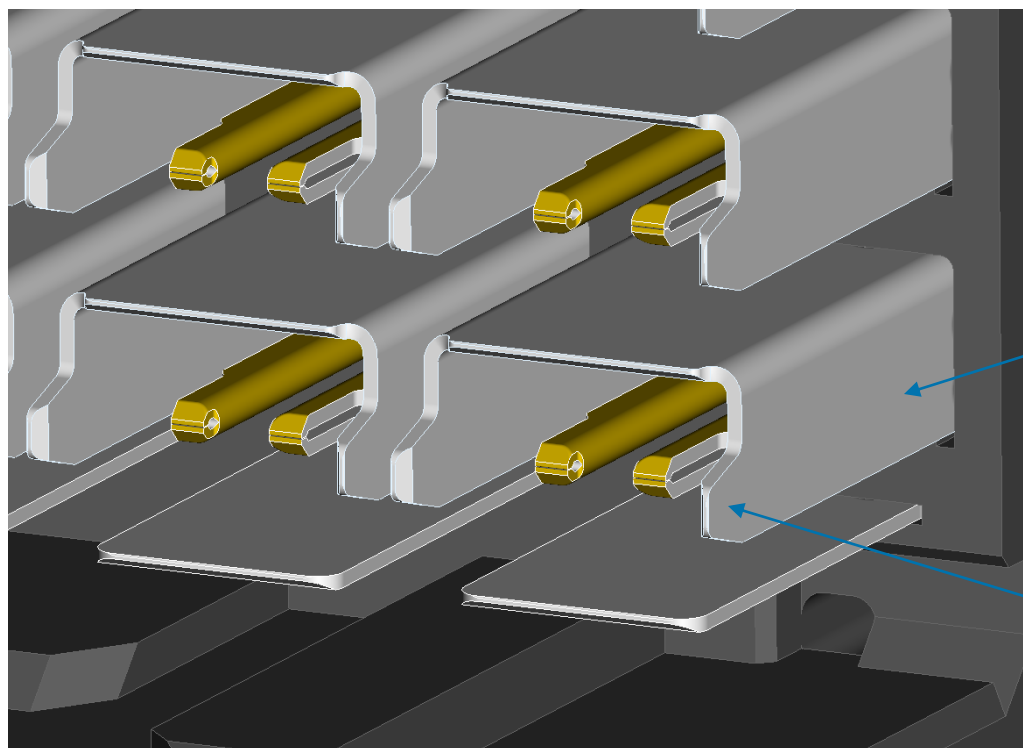

C-shield protects
signal pins from
damage

Tabs on sides of
C-shield provide
extra wipe

Whisper Robust Header Pins

TinMan



Ground and Signal



Cross Section

Impact



Ground and Signal



Cross Section

STRADA Whisper



Ground



Signal

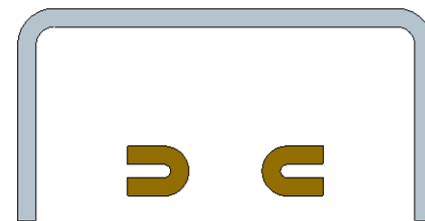

Cross Section



Strada Whisper 3.9mm MidPlane: Orthogonal Overview

ORTHOGONAL CONSTRUCTION

EVERY CONNECTION COUNTS



Orthogonal: Connector Mating

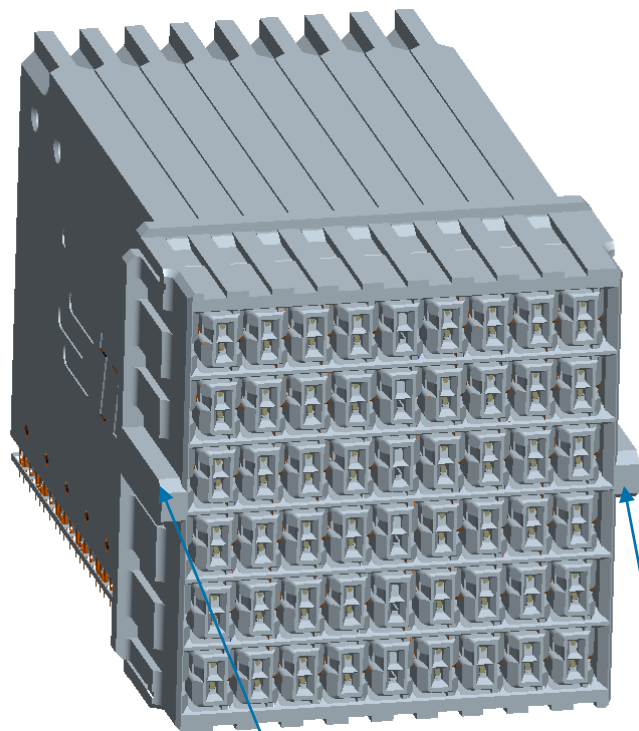

Keys provide proper alignment during connector mating

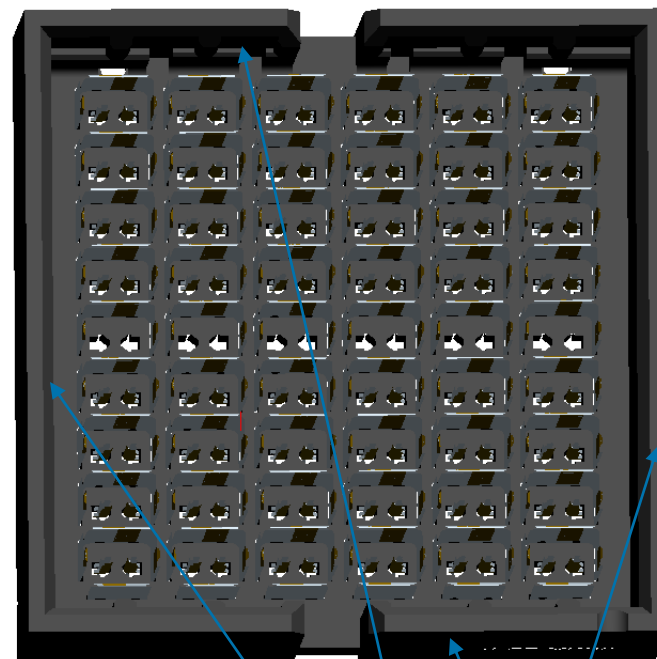

4-sided shroud provides robustness during system mating

Orthogonal Receptacle: Front Housing

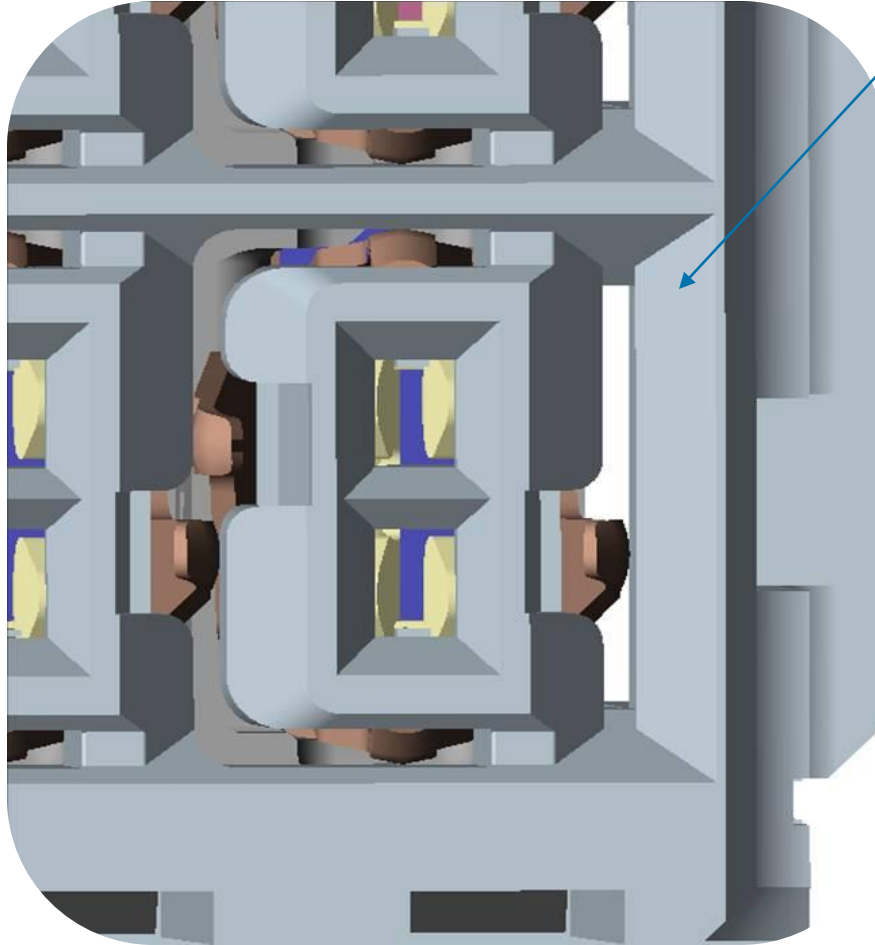

Front housing ensures good contact location and proper alignment during mating

Orthogonal Receptacle: Signal Contacts

Signal contacts provide two points of contact

Wide paddle tips provide good alignment of header pin

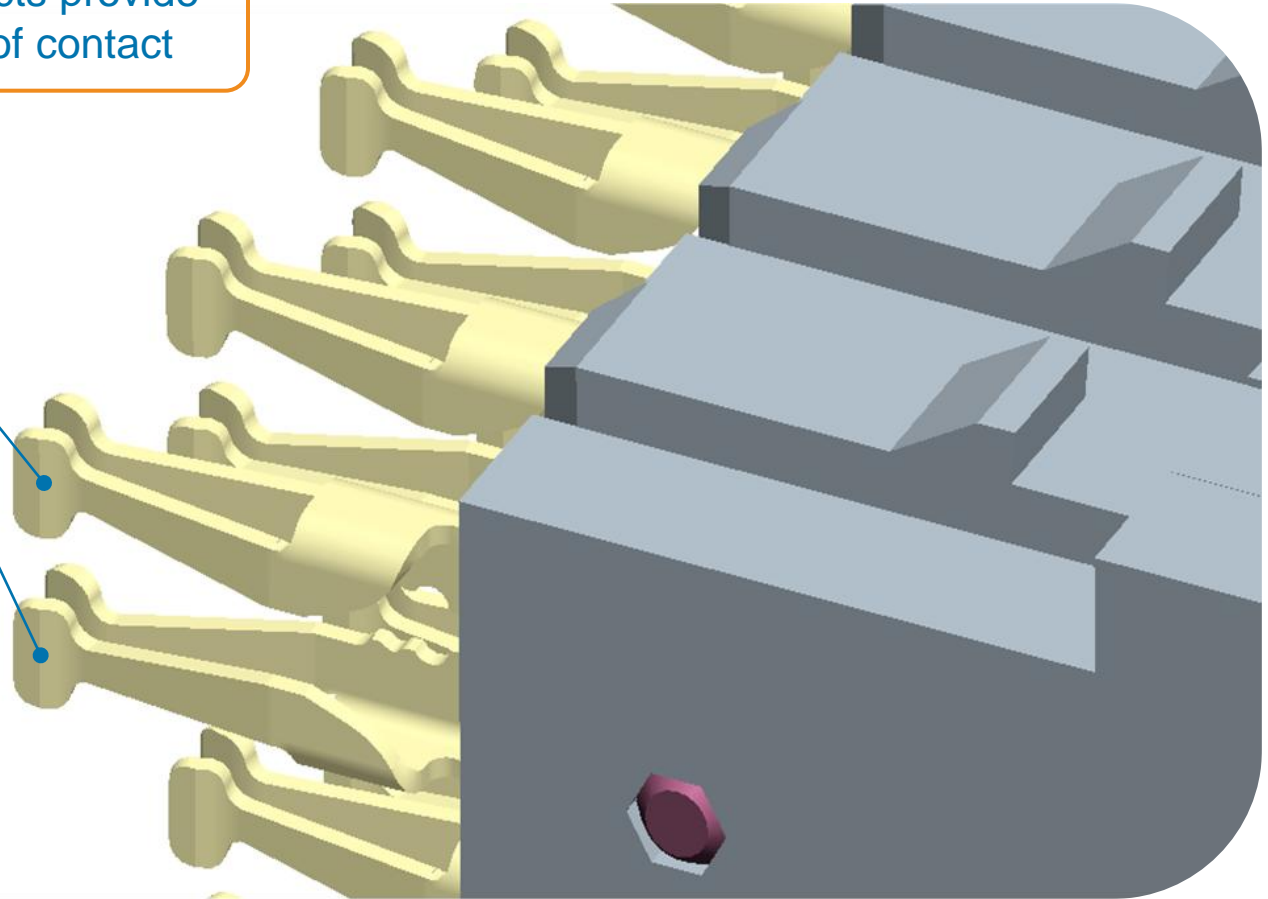

4x4 Header Assembly (Exploded View)

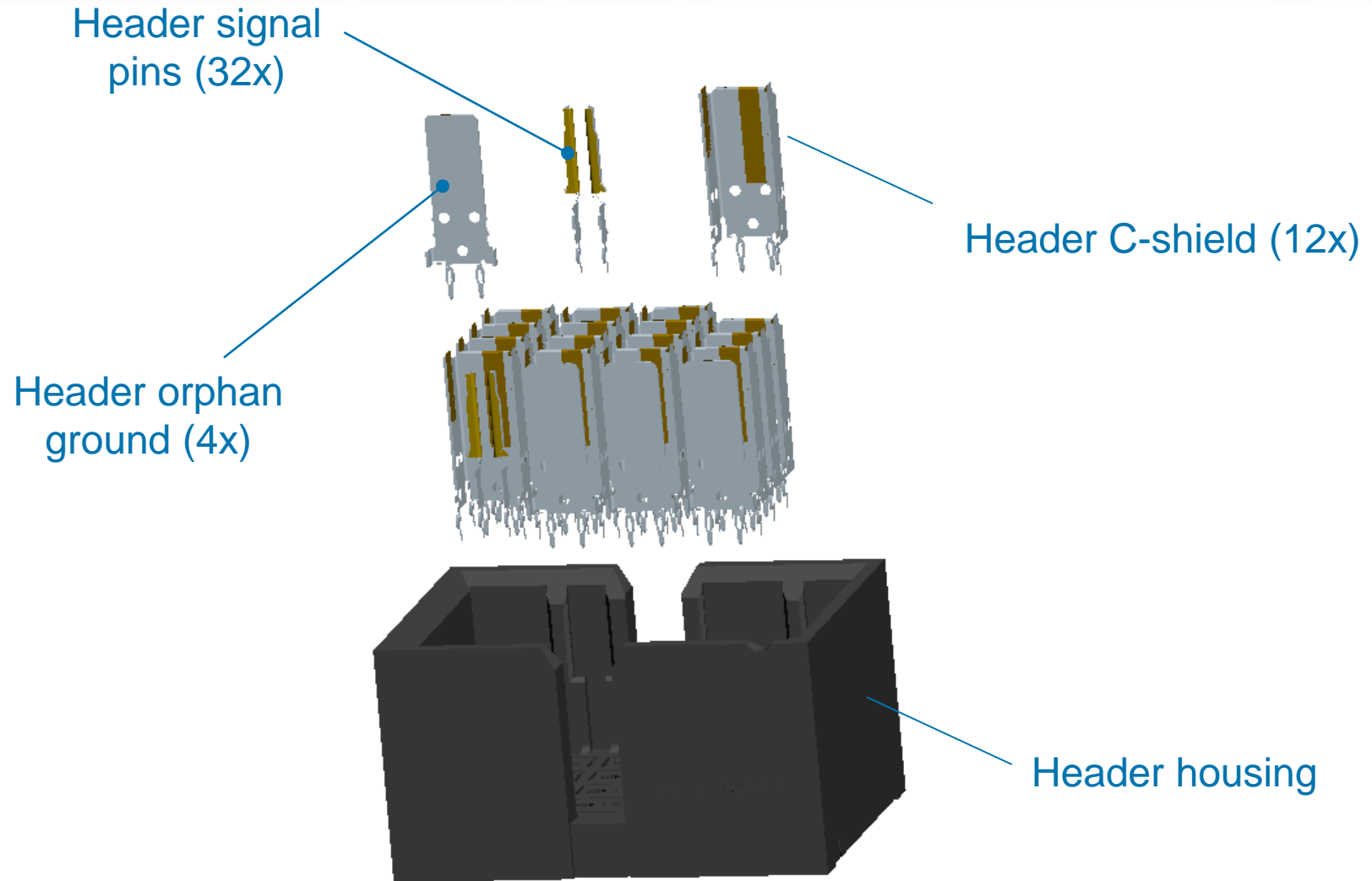

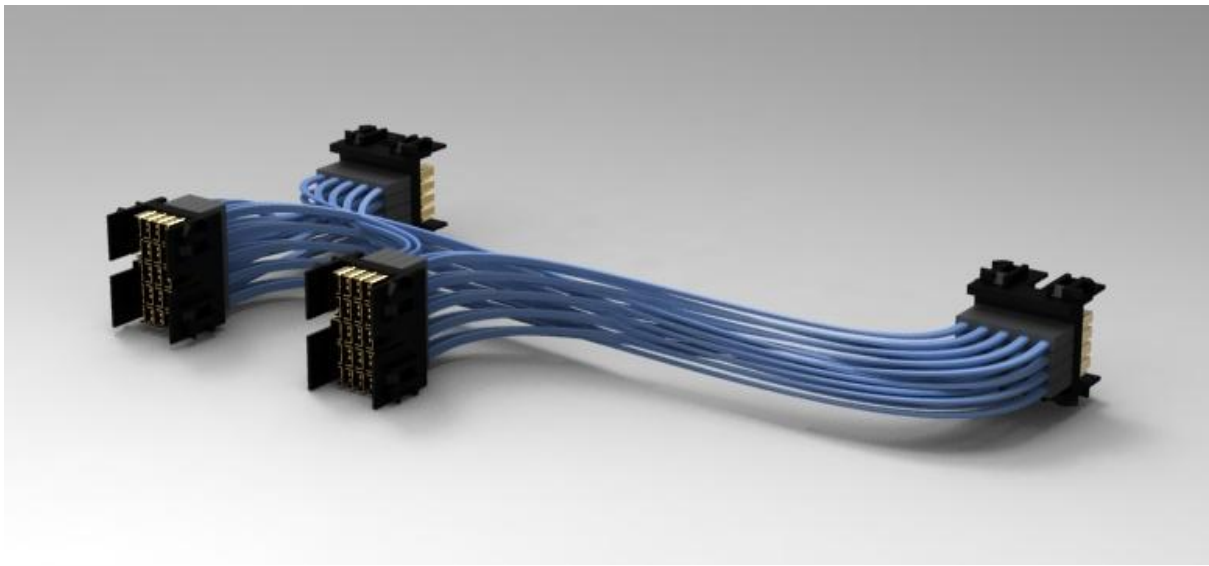

STRADA Whisper 3.9mm Cable Assembly

CABLE ASSEMBLY

EVERY CONNECTION COUNTS



Alternate Architectural Concept: STRADA Whisper Cable

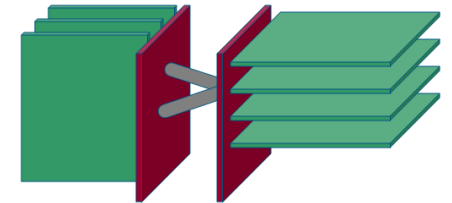
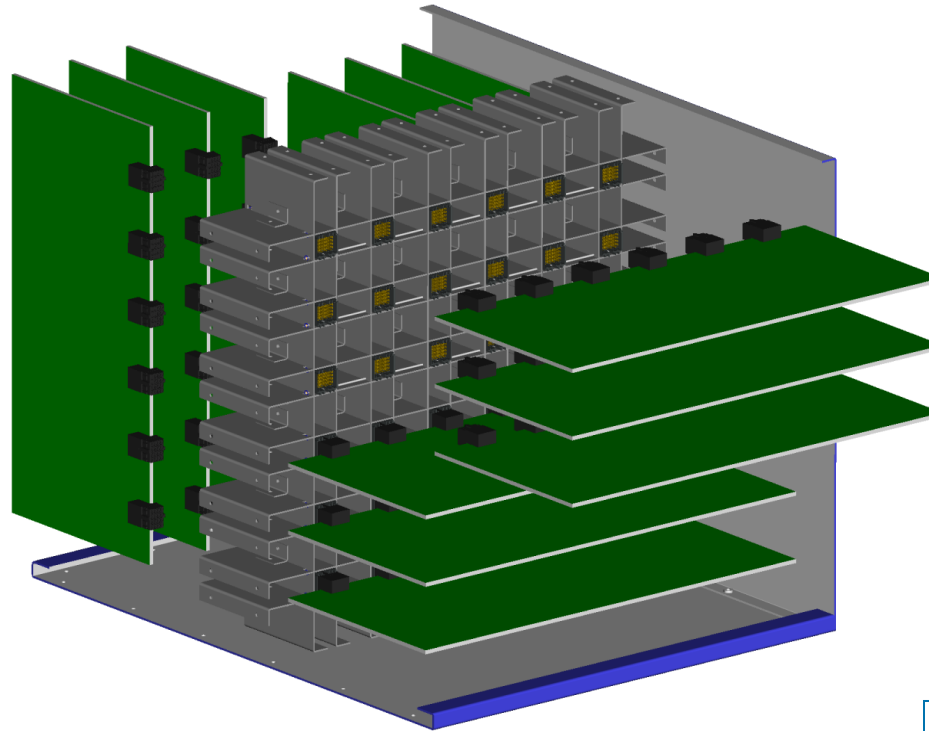

Switch Cards

- Up to 6 in a chassis
- Cable-to-board configuration

Dual Panels for Cabling

- Estimated at 6" from panel to panel
- Must support 25Gb/s
- Envision a "Whisper-Like" Internal Cable
- "Y" Cables: 1 I/O to 2 Switch Cards

Blades

- Processor Cards
- May contain I/O modules
 - Co-Planar or Mez
- Up to 12 in a chassis
- Cable-to-Board Config.

High-Speed Cable Orthogonal System

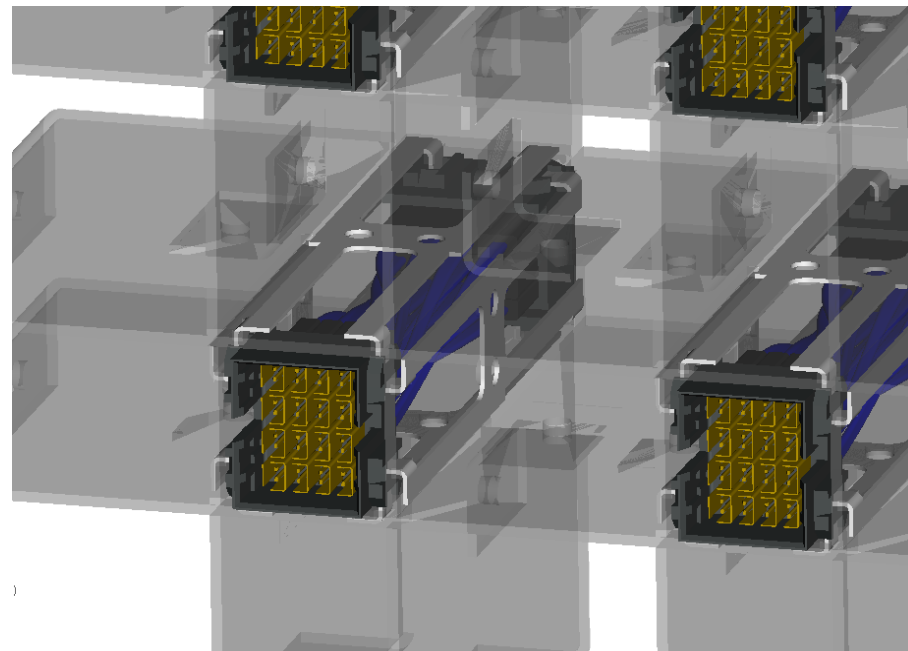
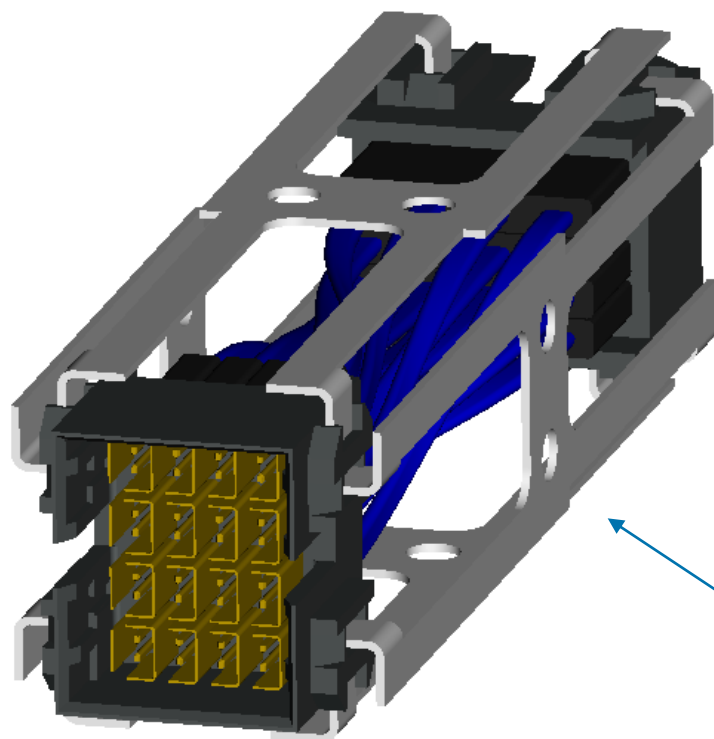
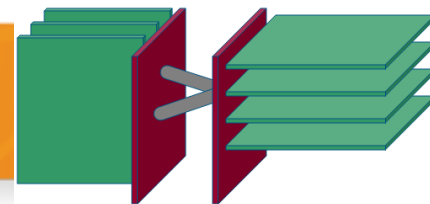

Leaf Spring (4) to Center Header

Sheetmetal “HoneyComb Midplane” Detail – Vertical Card Side

STRADA Whisper Cable Header: Complete Assembly

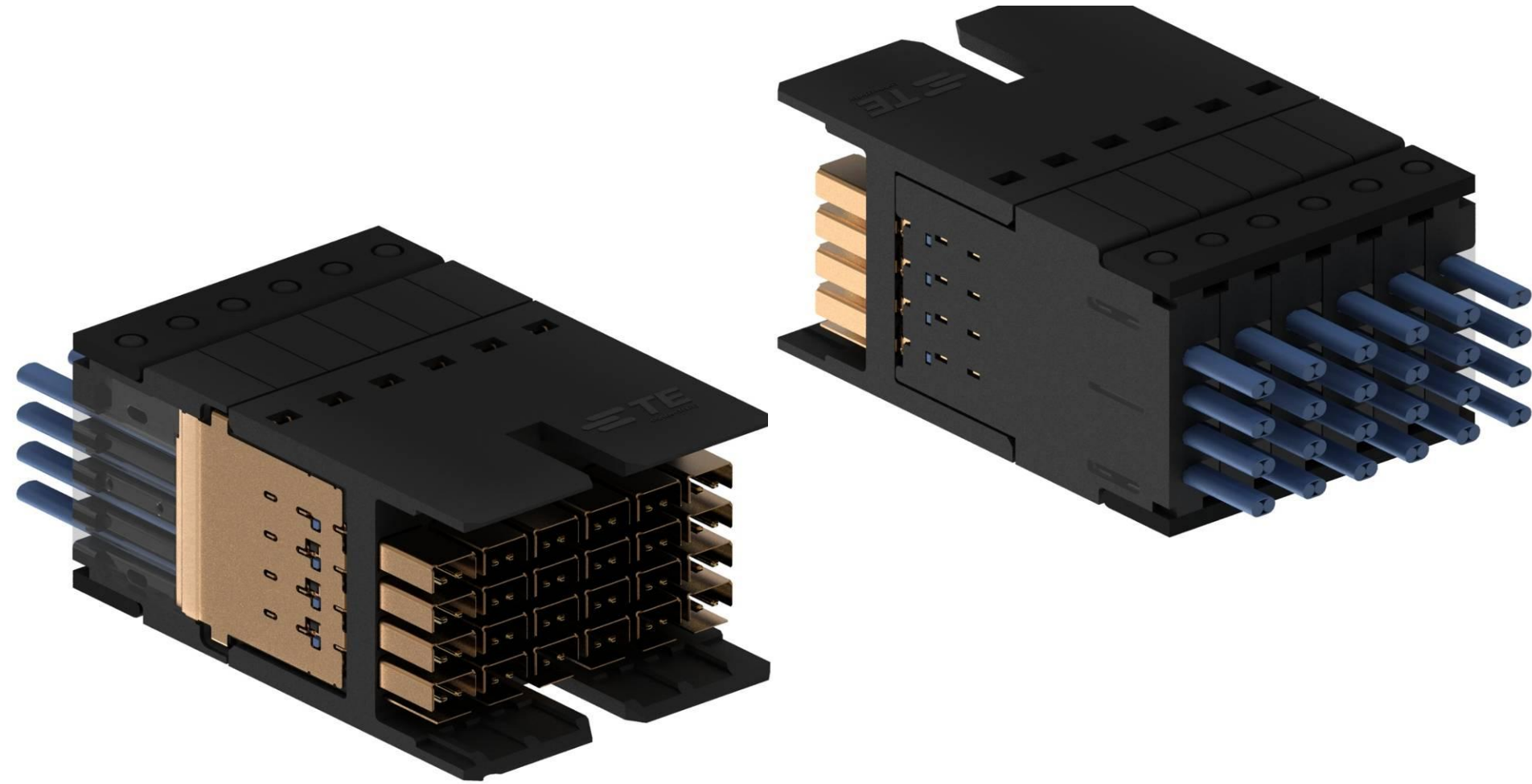

Questions?

Please visit www.te.com/products/stradawhisper or contact your local TE sales representative.