



RotaConnect® Board-to-Board Product Presentation

Basics Portfolio

Amphenol
FCi

Rotaconnect® Board-To-Board

Value Proposition

- The unique RotaConnect® Board-To-Board solution is a rotatable Board-to- Board SMT connector that can be used to support perpendicular, coplanar and angled connections, in multiple mating and un- mating directions for all needs.
- Thanks to the hermaphroditic “mates to itself” design the RotaConnect® BtB solution enables mating at any angle between +90° and -60°, the connectors can be placed anywhere on the PCB and a single part number which will comprise both male and female contacts.
- The RotaConnect® BtB solution includes 2 and 4 positions with hold-down and locating peg options with a latching feature (connector with locating pegs only have latching feature) to accept the latch from the Wire to Board RotaConnect®.
- The high temperature grade housing material is reflow solder compatible.

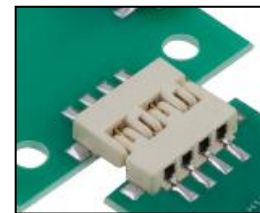
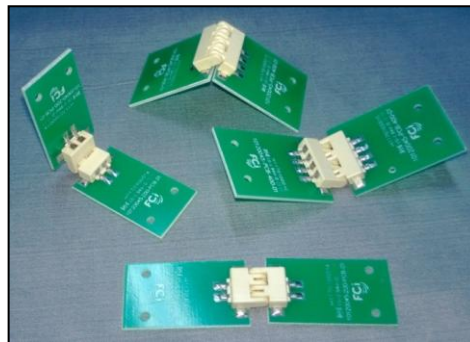
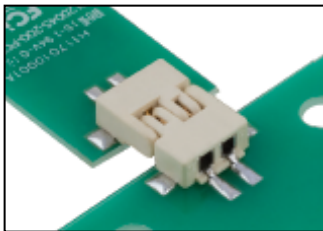

Rotaconnect® Board-To-Board

Product Overview

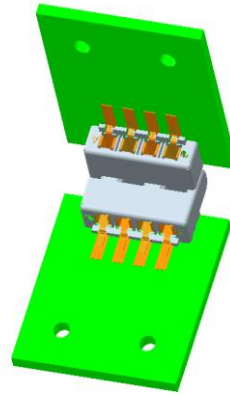

Rotate angle +90°

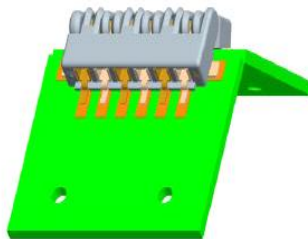
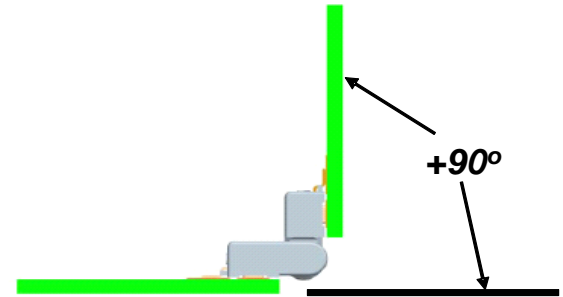

*Rotate angle -60°
(PCB T=1.57mm)*

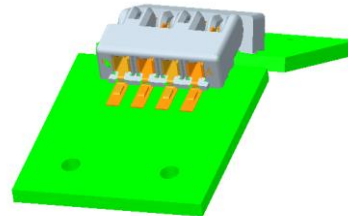

*Rotate angle -60°
(PCB T=1.57mm)*

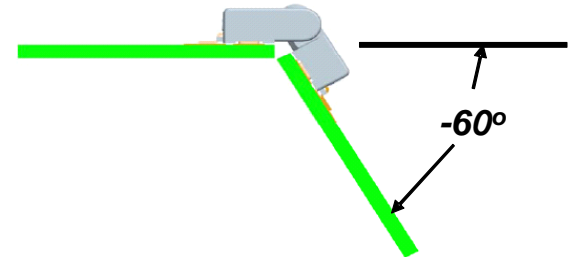

Rotaconnect® Board-To-Board

Product Specifications

Product Facts

- Hermaphroditic: mates to itself (1 Part number)
- Contact System: dual beam spring contact
- Positions: 2 and 4 pos currently available
- Pitch: 3.00mm
- Mating angle: all in between +90° and -60°
- RoHS compliance

Performance Characteristics

- Durability: max 20 mating cycles
- Current Rating: up to 5A
- Operating Temperature: -40°C up to +125°C

Specifications

- Product Spec. : GS-12-1079

Materials

- Plating: GXT
- Housing: High Temperature Thermoplastic (UL94V0)
- color: natural

Rotaconnect® Board-To-Board





Feature & Benefits

| Features | Benefits |
|---|---|
| Hermaphroditic “mates to itself” design and Mates under any angle +90° and -60° | Flexible Design for all needs |
| Reliable dual beam contact | Connection reliability |
| Self-guided features | Prevent mis-mating and assure correct counterpart positioning |
| Hold own option | Better retention on to the PCB |
| Locating pegs | Easy positioning even in manual assembly condition |
| Passive latch | Better for housing retention |
| RoHS compliance | Meet environmental, health and safety requirements |

Rotaconnect® Board-To-Board

Part Numbers

| Connector PN | Description | No of Contacts | Contact Type |
|----------------|--|----------------|------------------|
| 10120045-200LF | 2 Pos Hermaphroditic Rotatable Board to Board Connector | 2 | 1 Male, 1 Female |
| 10120045-201LF | 2 Pos Hermaphroditic Rotatable Board to Board Connector with Locating Pegs | 2 | 1Male, 1 Female |
| 10120045-400LF | 4Pos Hermaphroditic Rotatable Board to Board Connector | 4 | 2 Male, 2 Female |
| 10120045-401LF | 4 Pos Hermaphroditic Rotatable Board to Board Connector with Locating Pegs | 4 | 2Male, 2 Female |

| 2 Position Hermaphroditic Rotatable BTB Connector 10120045-200LF | 4 Position Hermaphroditic Rotatable BTB Connector 10120045-400LF | 2 Position Hermaphroditic Rotatable BTB Connector with Locating Pegs 10120045-201LF | 4 Position Hermaphroditic Rotatable BTB Connector with Locating Pegs 10120045-401LF |
|---|---|--|--|
|  |  |  |  |

Rotaconnect® Board-To-Board

Applications

- Lighting (Luminaires, signages, displays, etc)
- Control Boards
- Sensors
- Rigid LED Strips
- Automotive Electronics

