

ELI Touch Screen Calibration in Windows 10

Windows 10 Calibration Guide

Summary:

This guide will show you how to calibrate your ELI touch screen in a Windows 10 environment. We will use the Tablet PC Settings menu to calibrate your ELI. This OS level touch screen calibration data will be saved on the host machine, so if the ELI unit is moved to another host machine, the calibration will need to be redone.

This method has been tested and confirmed working on the following ELI units:

- ELI70-CR
- ELI70-IPHW
- ELI121-CRW

Target Device(s):

- ELI Device.....[Website](#)

Required Software:

- Windows 10

Contents

1. Connecting to the Board	2
2. Calibrating your ELI.....	3
3. Website and Support	5

1. Connecting to the Board

1. Connect your HDMI source to the HDMI input on the ELI.
2. Connect your 12V power supply to the power input on the ELI.
3. Connect your USB to the mini USB touch output on the ELI.

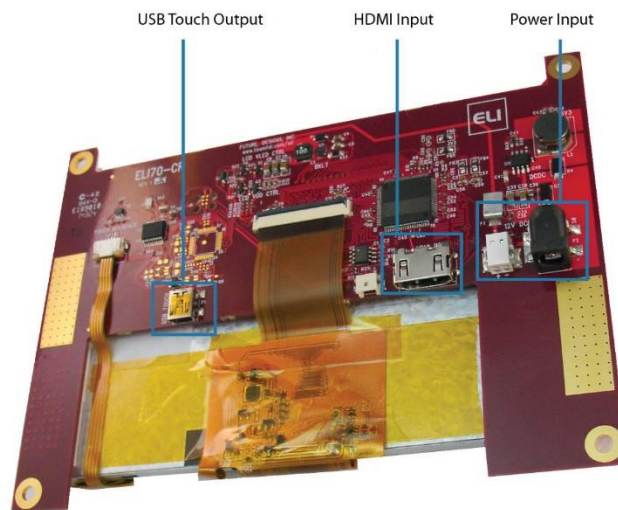

Figure 1 – Connecting your ELI (example using ELI70-CR)

2. Calibrating your ELI

The following steps will guide you through performing an OS-level touch screen calibration for computers using Windows 10. After the display is detected, the display settings must be changed to set the ELI as a secondary display. Once this is done, then the calibration can be run.

1. Press the Windows button, , then type “display” to search.

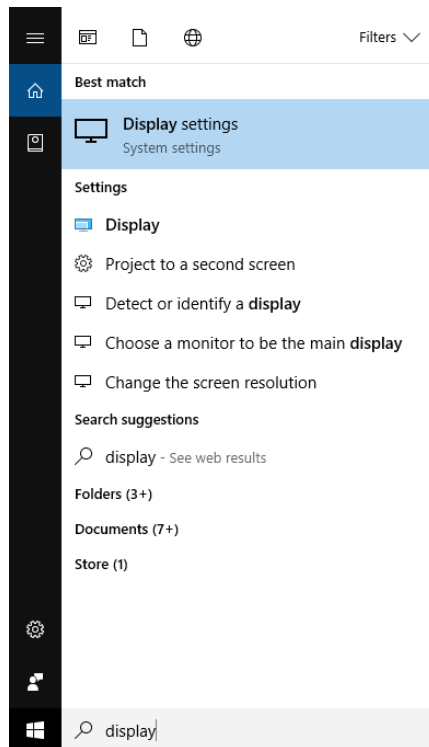

Figure 2. Opening Display settings

2. Click on **Display settings**.
3. For **Multiple displays**, select **Extend these displays**.

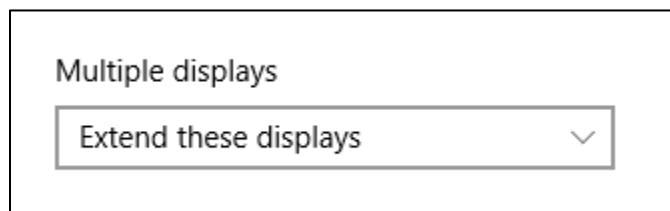

Figure 3. Extending the display to ELI

4. If prompted, select **Keep these settings**.

5. Press the Windows button, , then type “calibrate” to search.

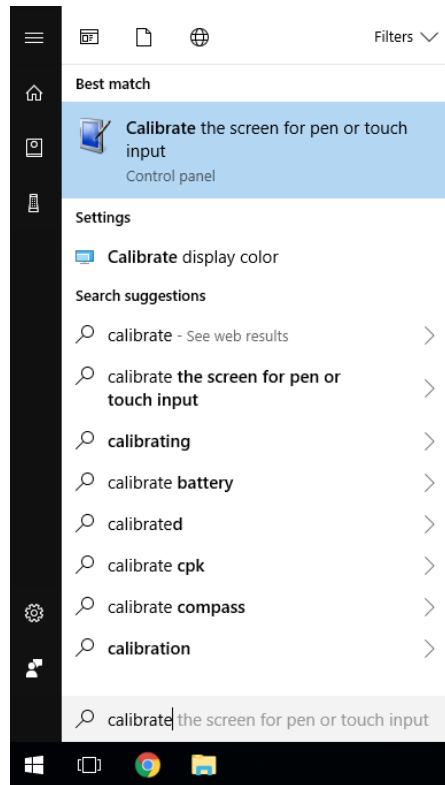

Figure 4. Finding the Calibration Utility

6. Click on **Calibrate the screen for pen or touch input**.
7. In the menu that pops up, find the ELI device in the dropdown menu. In our example, ELI70-CR is the first display option, however, it may not always be the first option.

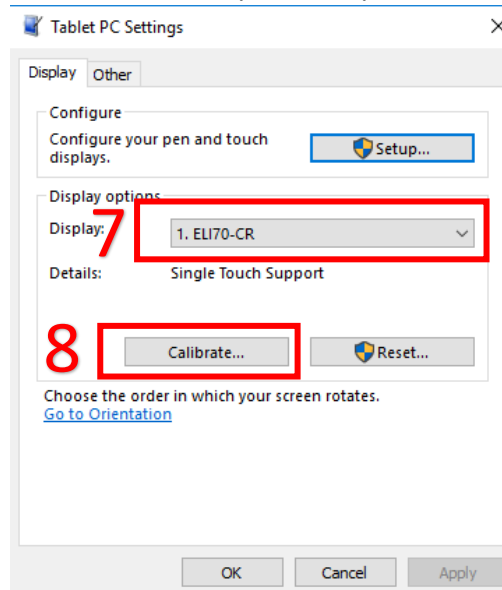

Figure 5. Tablet PC Menu

8. Click on **Calibrate...** and follow the on screen instructions to calibrate your ELI touch screen with Windows 10.

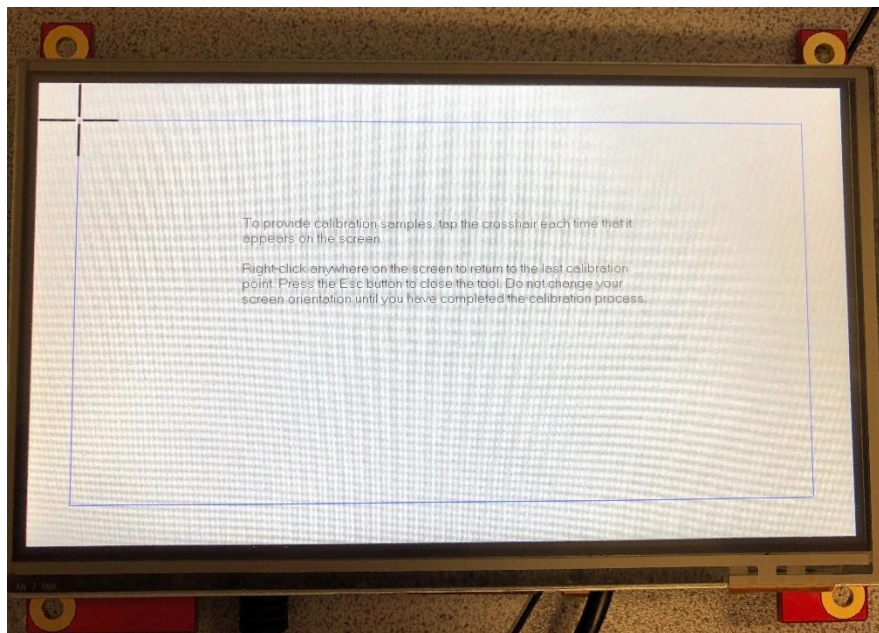

Figure 6. ELI70-CR in Windows 10 Calibration

9. NOTE: If the ELI option does not allow you to click on **Calibrate...** you may need to use the **Setup...** button to select ELI as your touch input device and you may also need to go to a different option in the **Display** dropdown menu and click the calibrate button on this device first. Hit ESC to exit once calibration starts. The calibration option should now be available on ELI.

10. Once you have finished, click **Yes** to save the calibration permanently.

3. Website and Support

Support:

- FDI Support home page:.....<http://www.teamfdi.com/support>
- FDI Forums: <http://www.teamfdi.com/forum>