

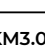
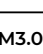
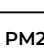
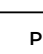
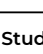
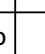
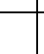

reServer Industrial

Assembly Guide

①	②	③	④	⑤	⑥	⑦	⑧
							
120°-KM3.0 x L5.0	PM3.0 x L7.0	PM2.5 x L4.0	PM3.0 x L4.0	Stud-M3 x 6.5+M2 x 2.0	CM2.0 x L3.0	CM3.0 x L6.0	Stud-M3 x 16.0+4.0

Note: the LoRaWAN®/4G/5G/Series Wireless modules and 2.5" SATA HDD/SSD used in the following installation instructions are not included in the device and are optional.

SATA HDD/SSD Installation Guide

Step 1

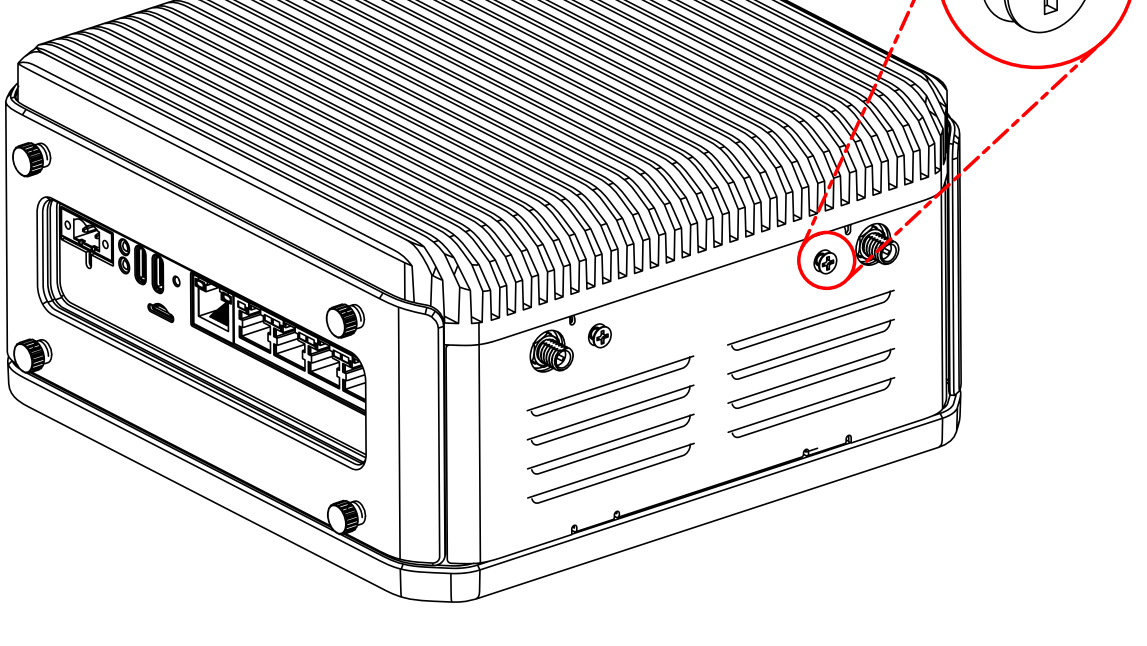

Loosen these two screws.

Step 2

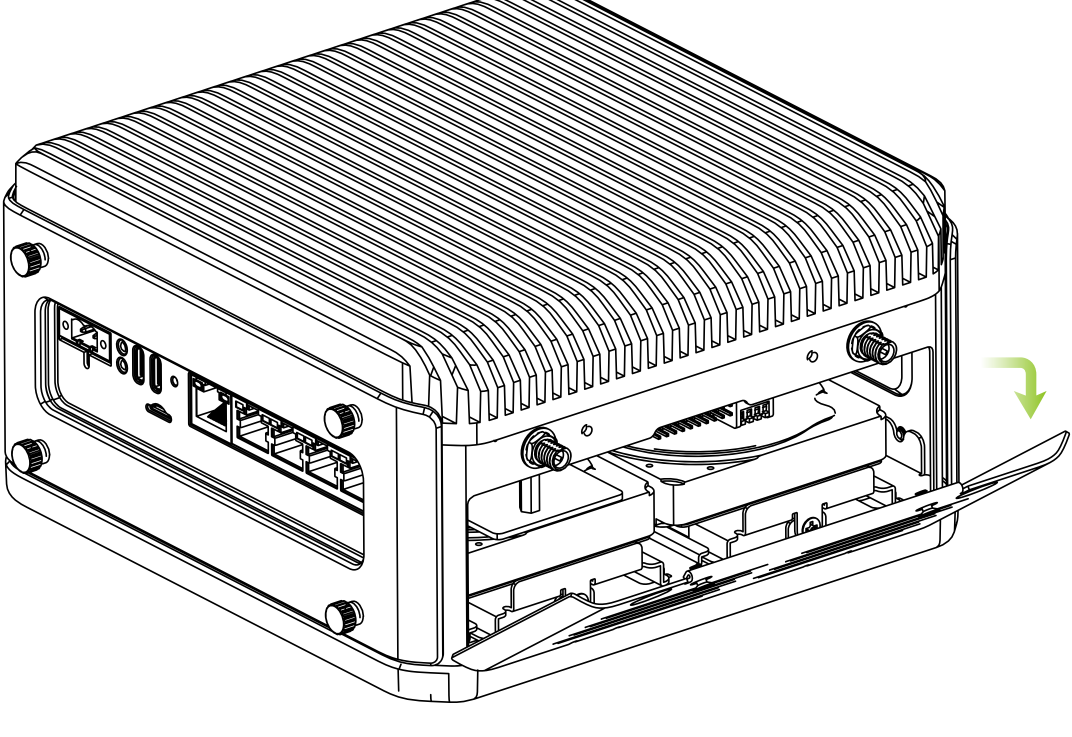

Step 3

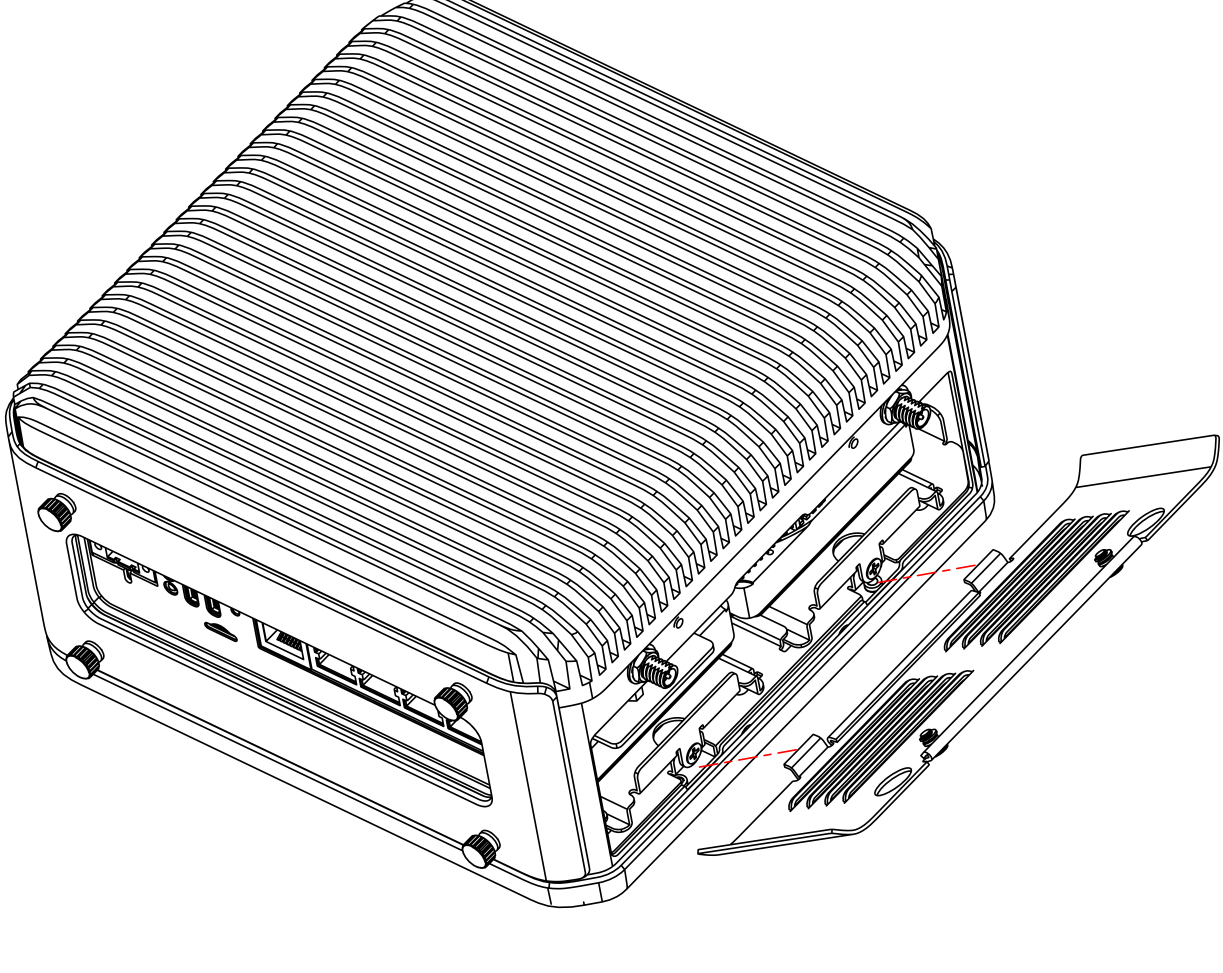

Remove the panel.

Step 4

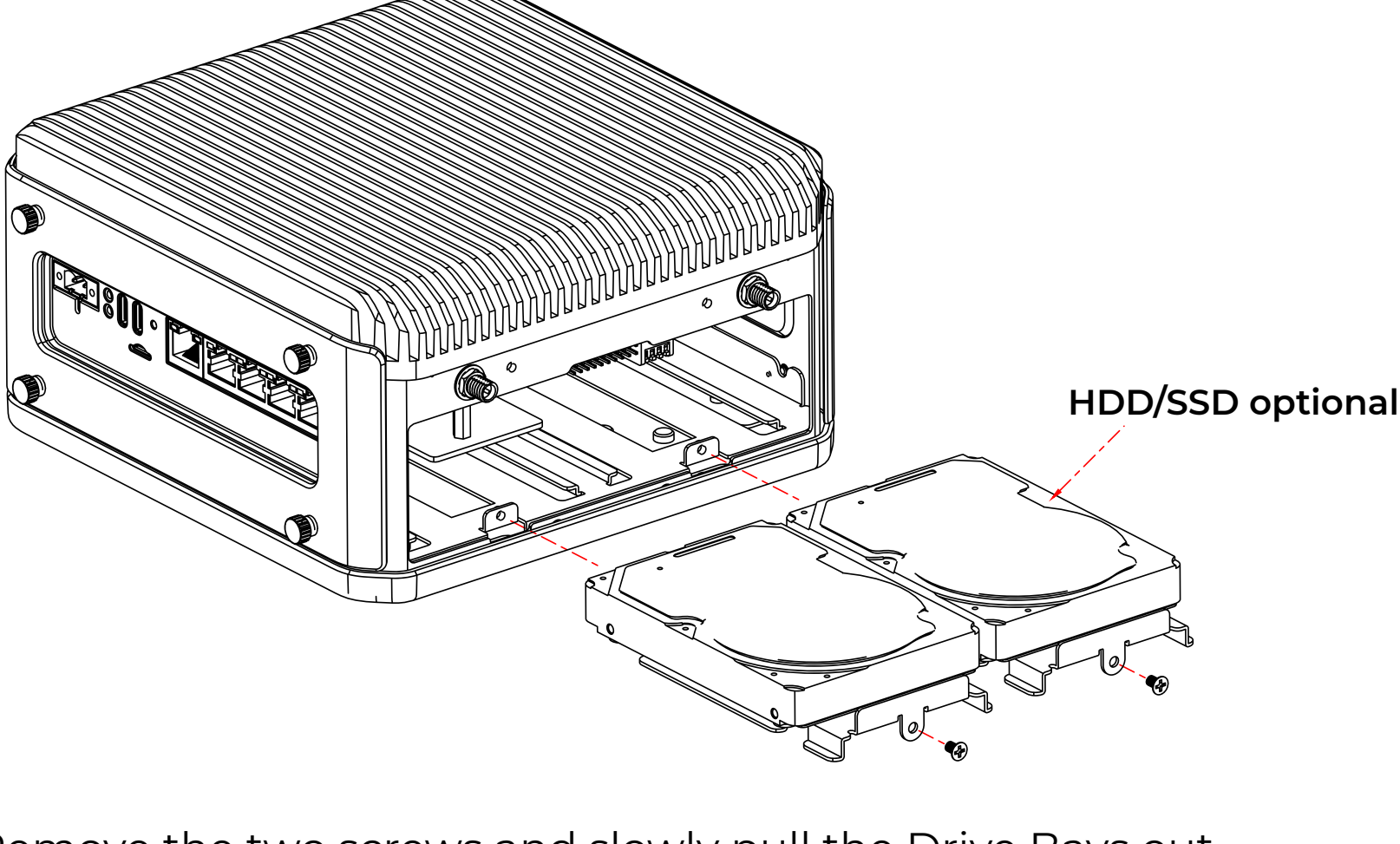

Remove the two screws and slowly pull the Drive Bays out.

Step 5

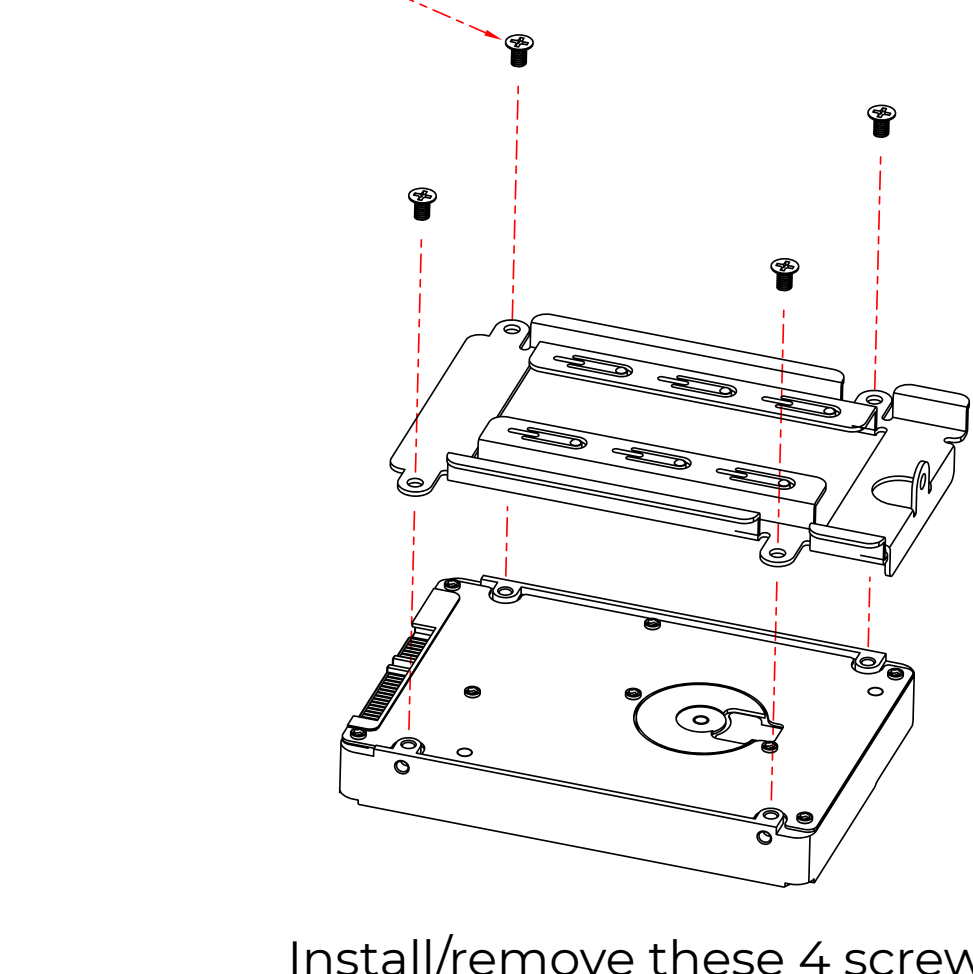

Install/remove these 4 screws.

Step 6

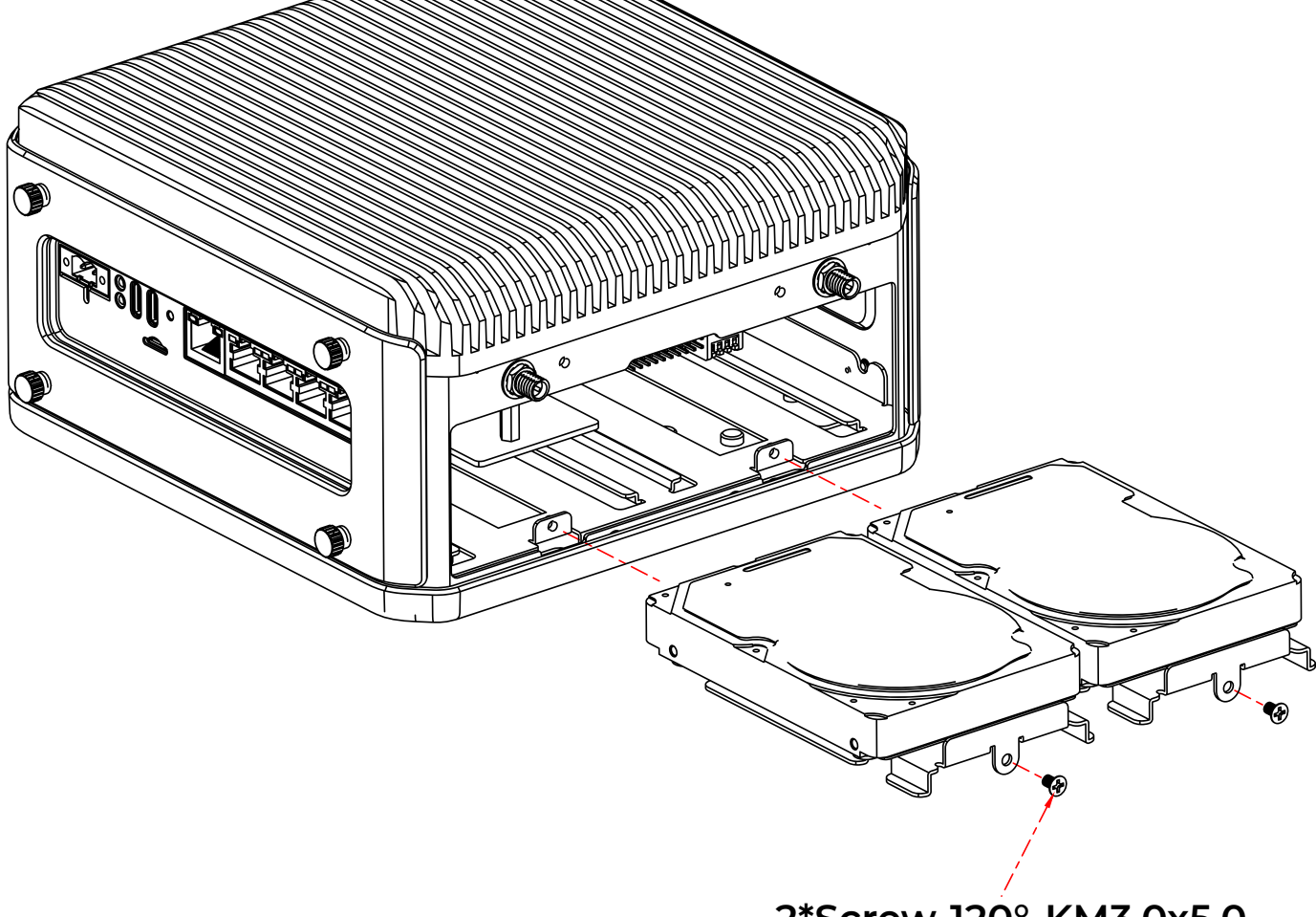

Push the drive bays inside along the bracket tracks slowly.
Lock the drive bays with screws.

Step 7

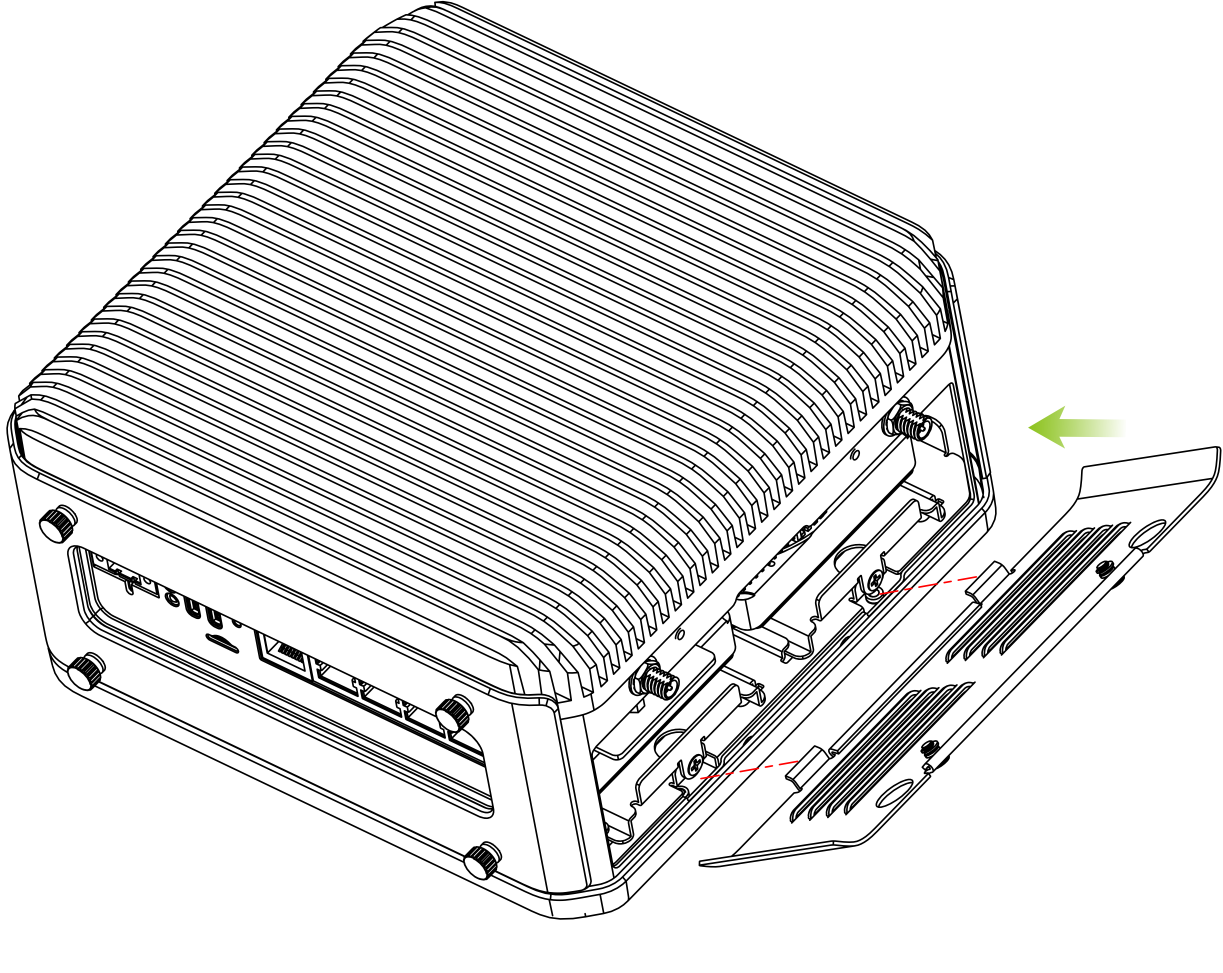

Install the panel, making sure that the protrusions of the panel line up with the grooves on the bottom of the device.

Step 8

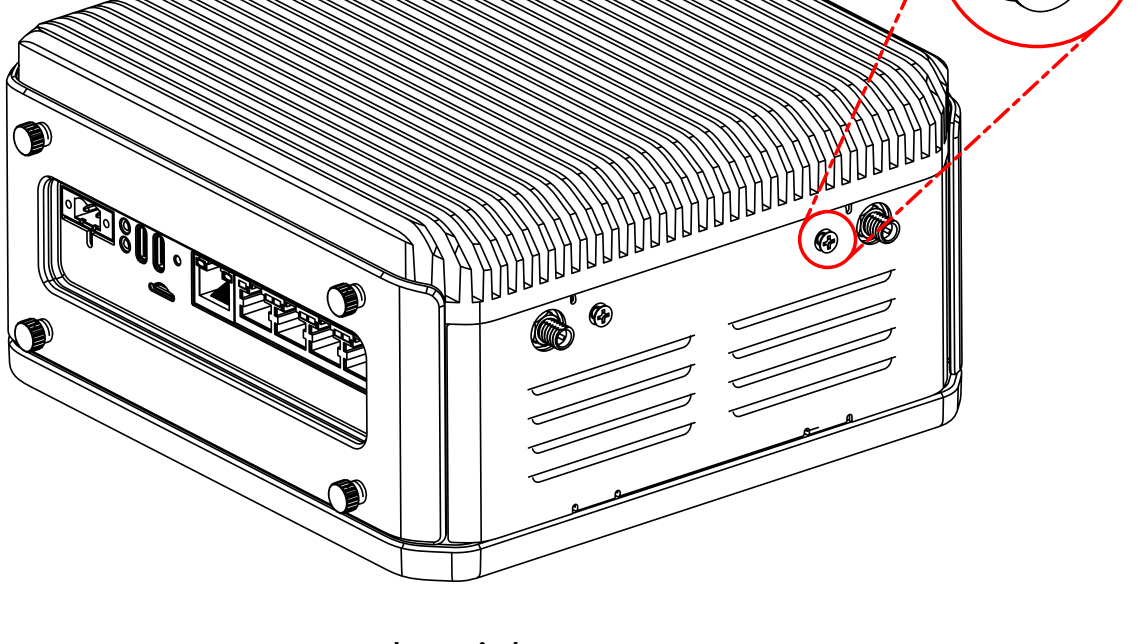

Lock with two screws.

Step 9

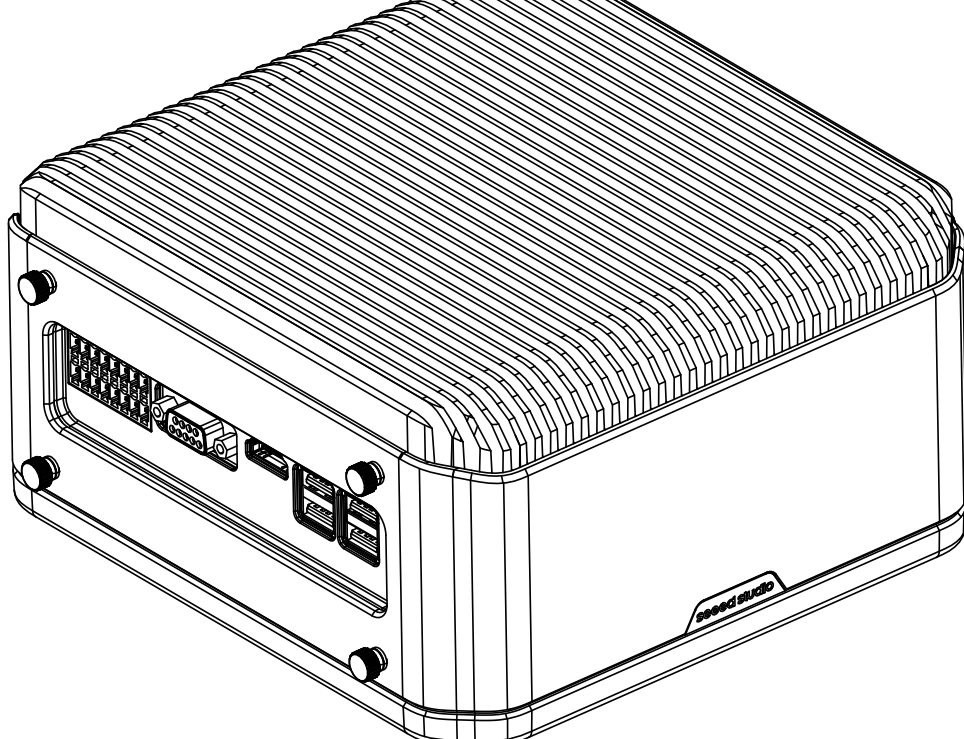

Assembly Guide

Step 1

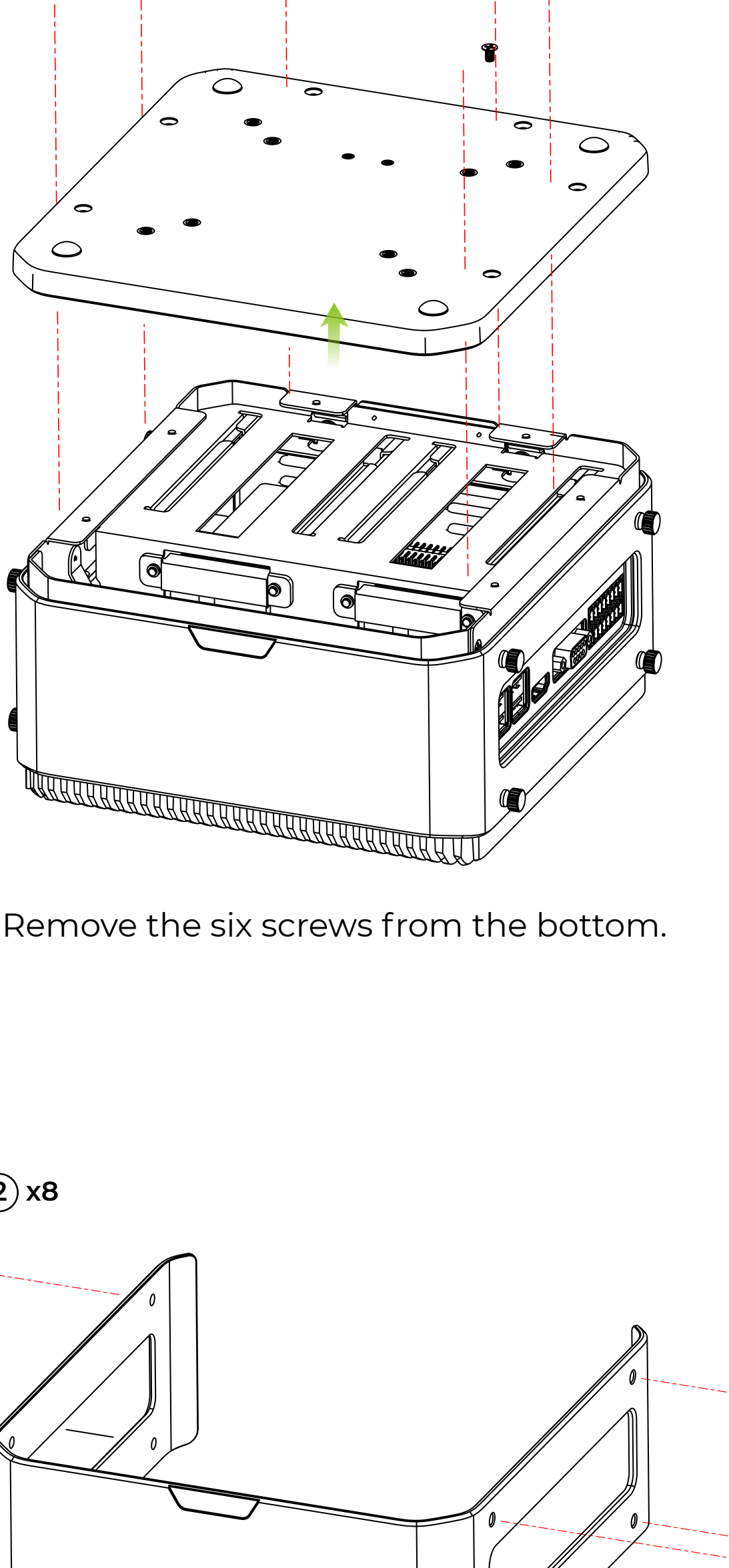

Remove the six screws from the bottom.

Step 2

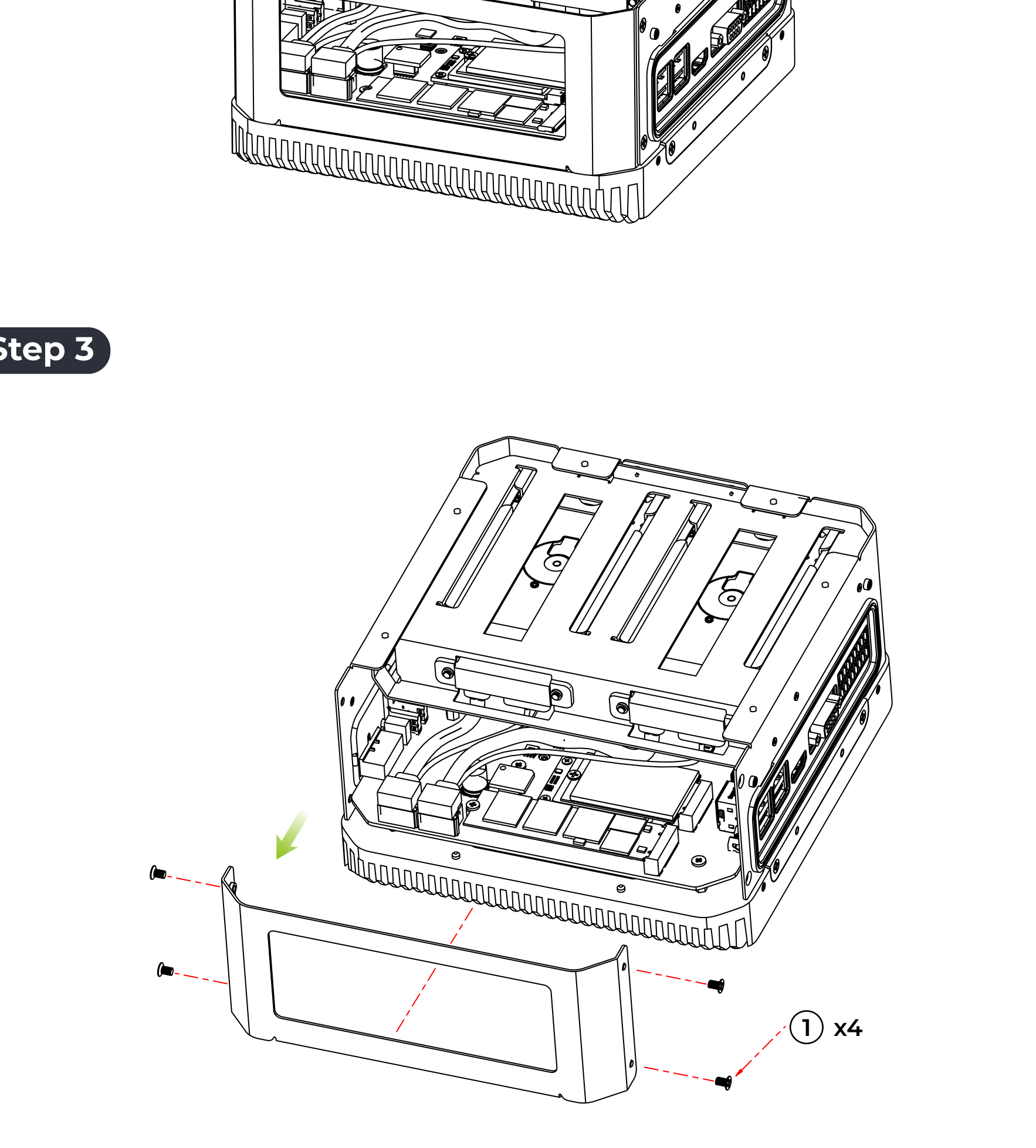

Step 3

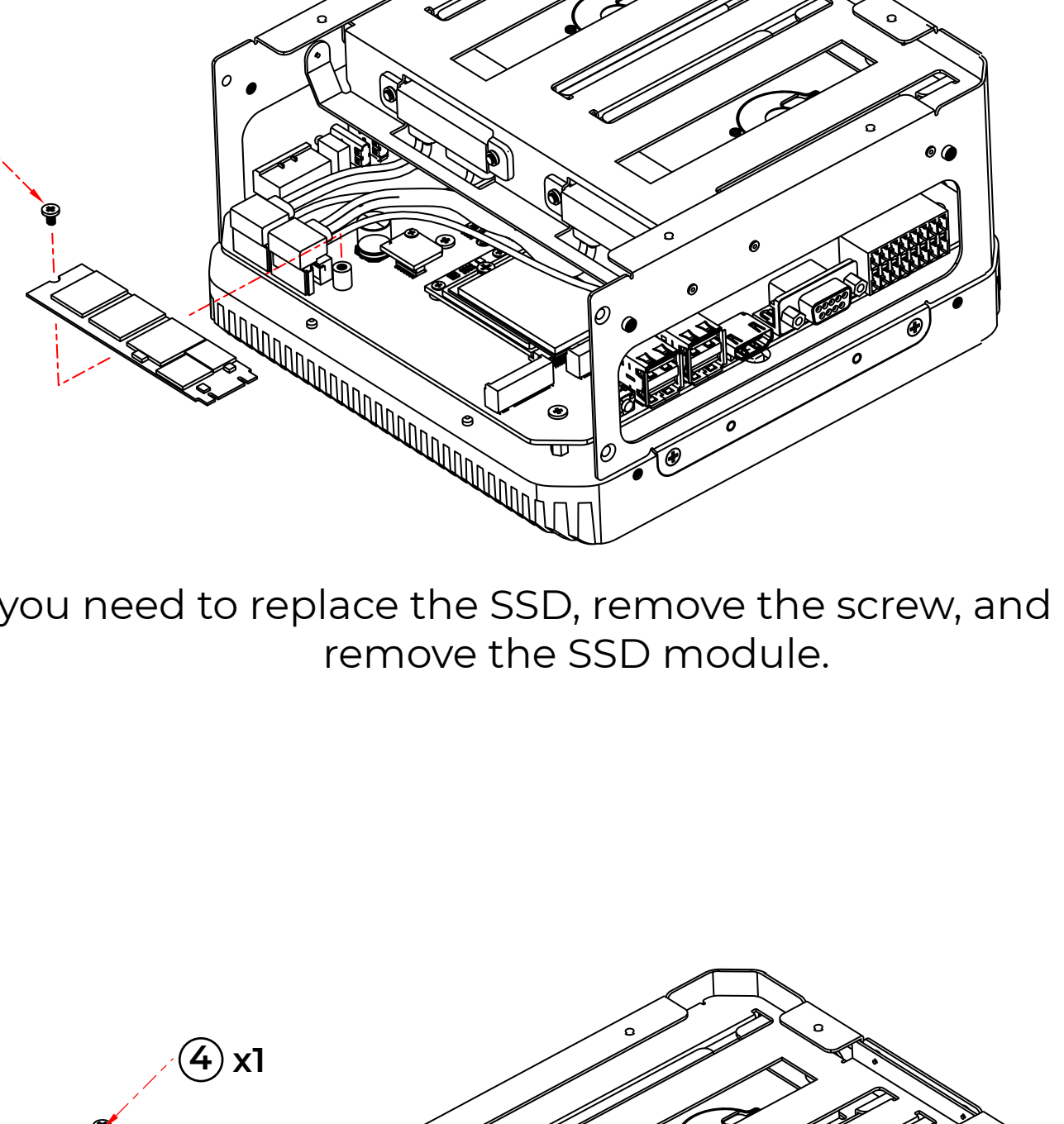

Step 4

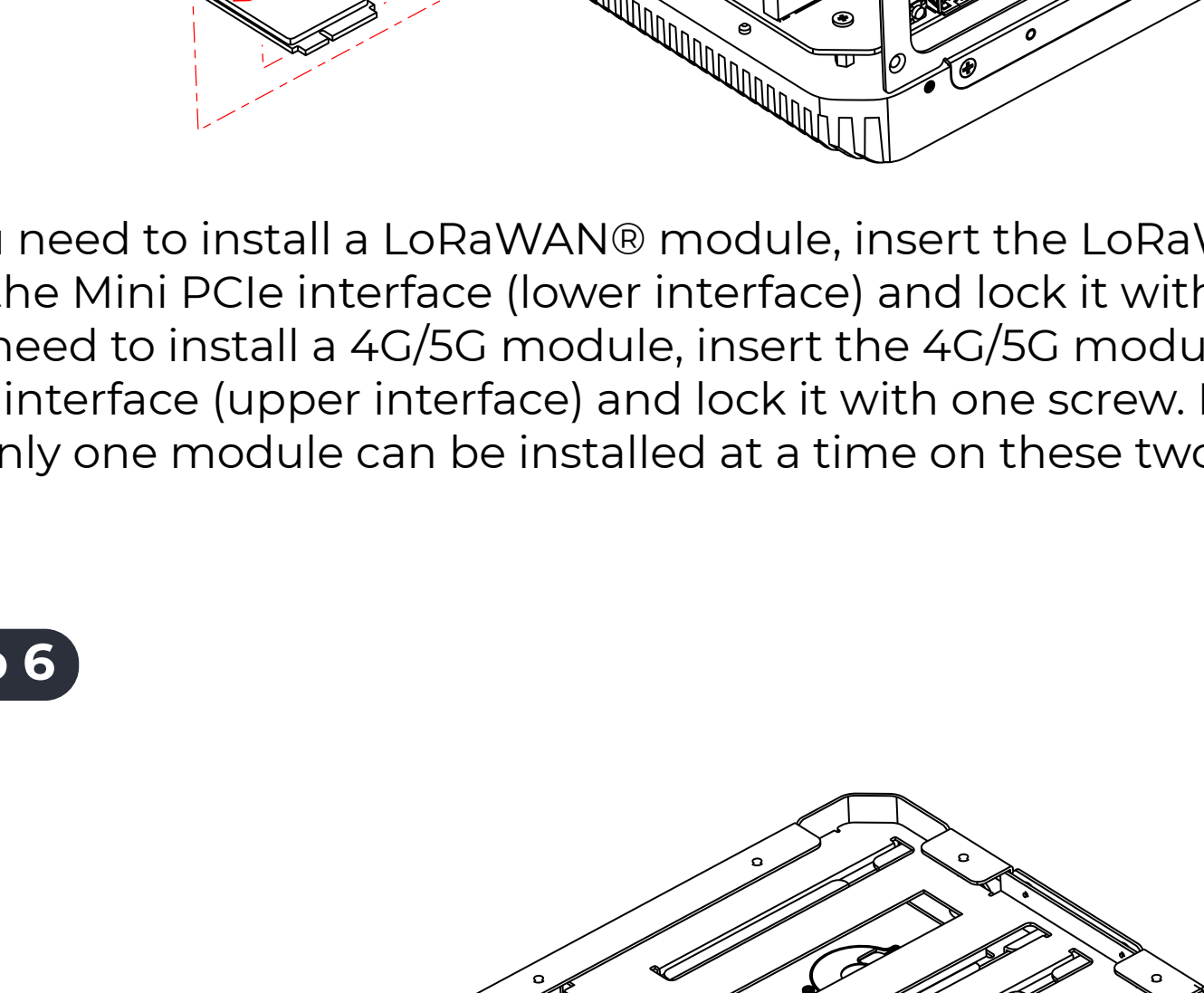

If you need to replace the SSD, remove the screw, and gently remove the SSD module.

Step 5

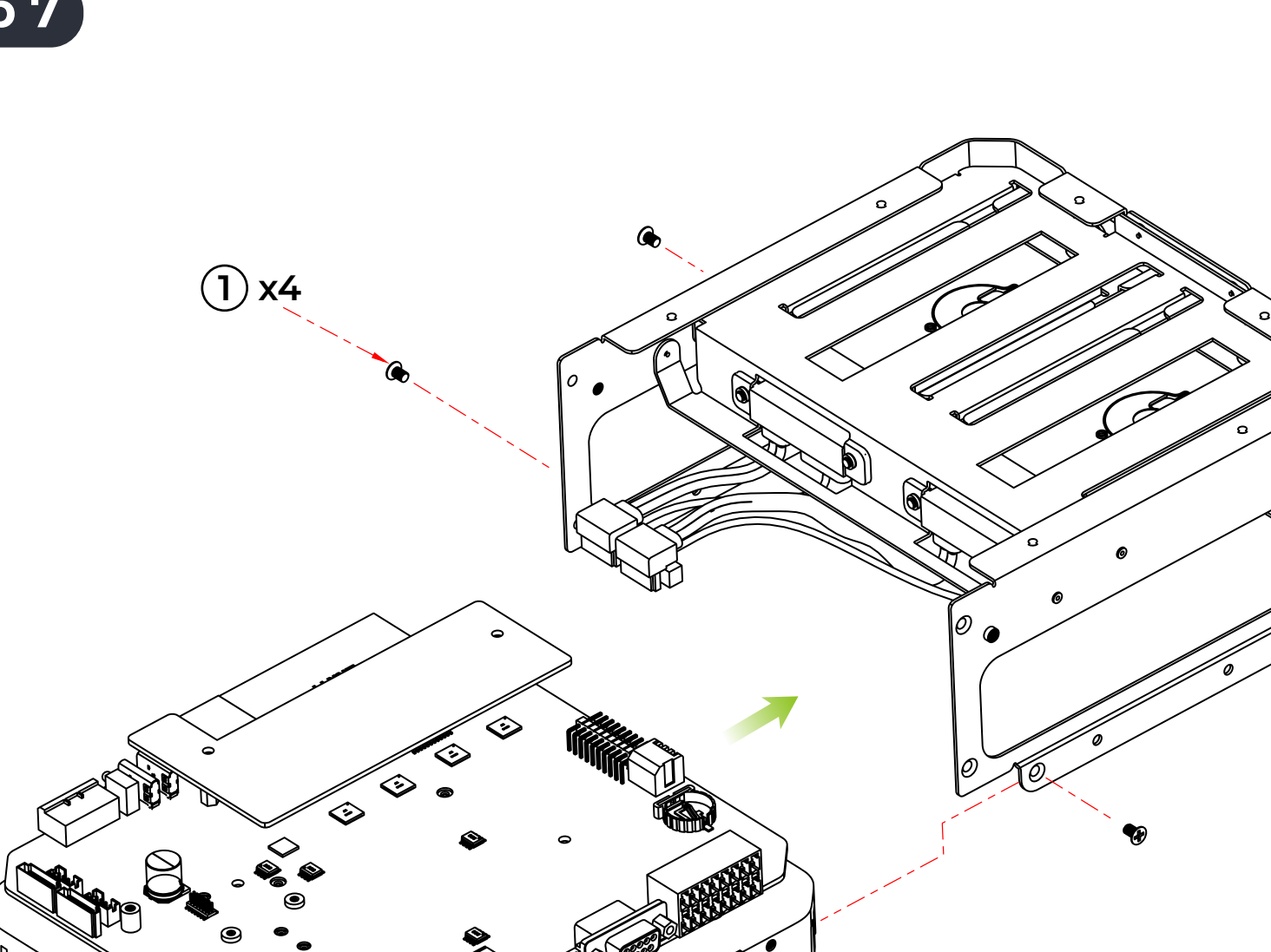

If you need to install a LoRaWAN® module, insert the LoRaWAN® module into the Mini PCIe interface (lower interface) and lock it with two screws. If you need to install a 4G/5G module, insert the 4G/5G module into the M.2 Key B interface (upper interface) and lock it with one screw. Please note that only one module can be installed at a time on these two interfaces.

Step 6

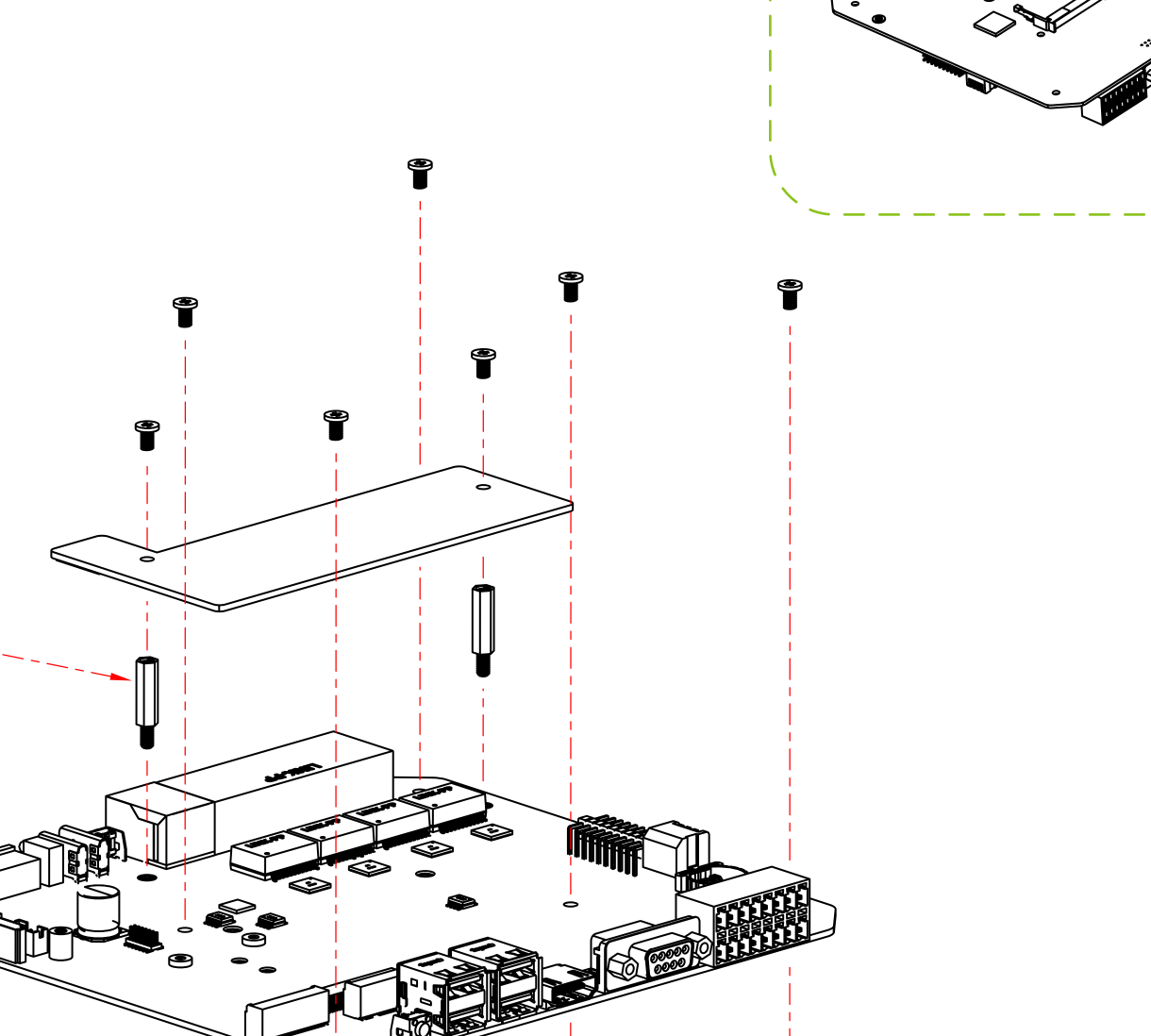

Install the TPM module in the correct orientation.

Step 7

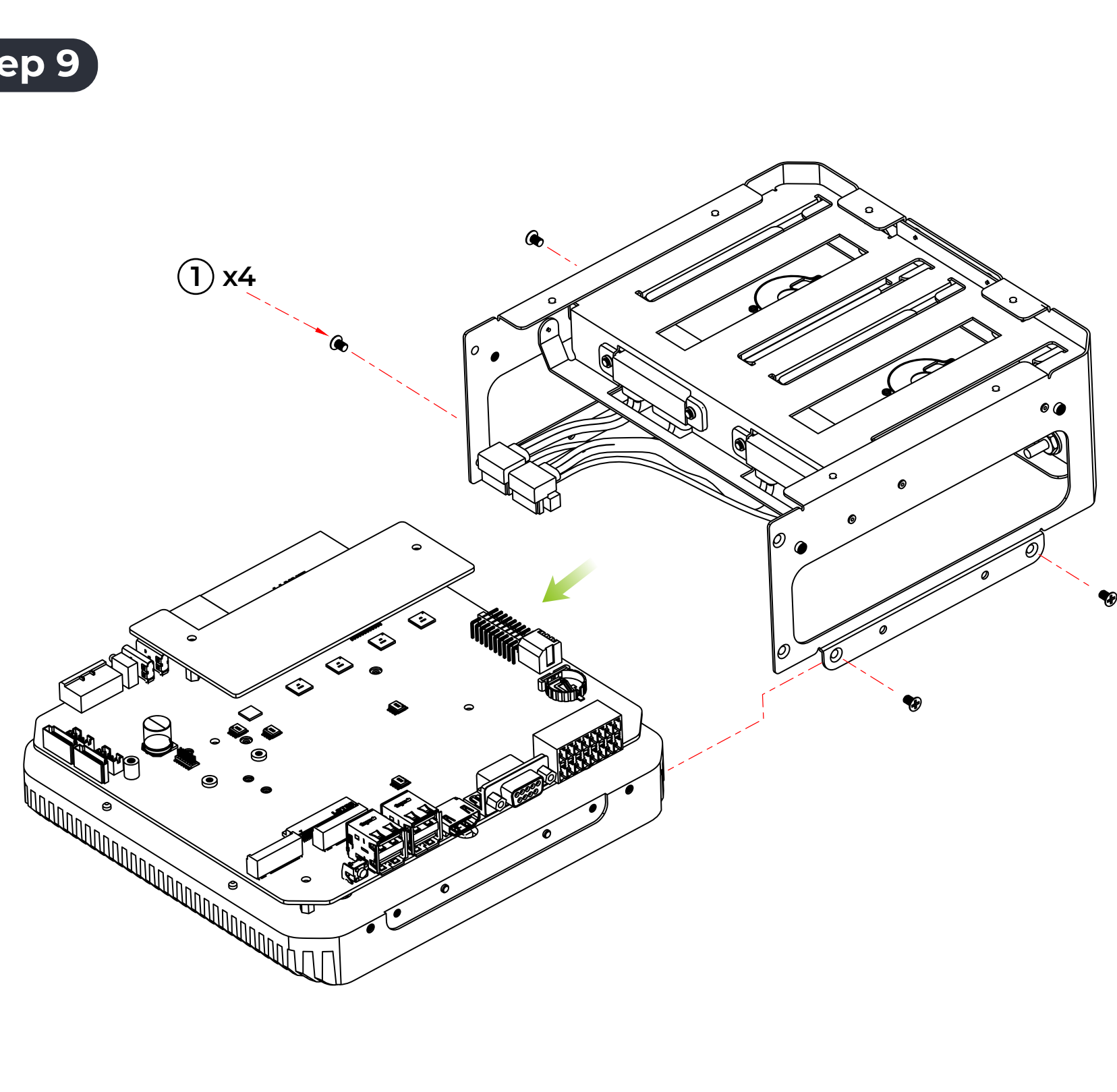

This step is only necessary if you need to remove the carrier board. Remove the two SATA data and power cables and remove the 4 screws on both sides.

Step 8

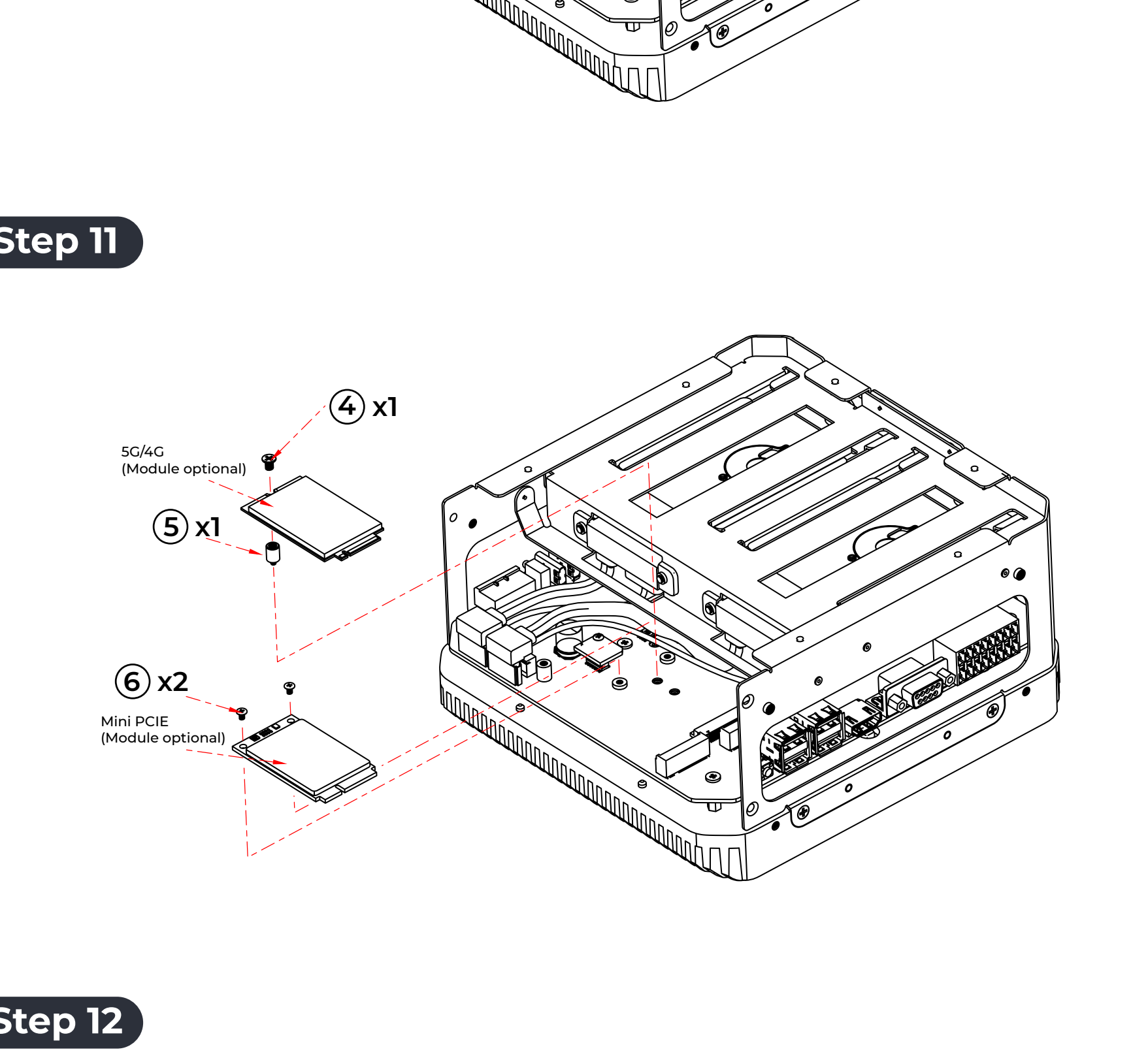

Step 9

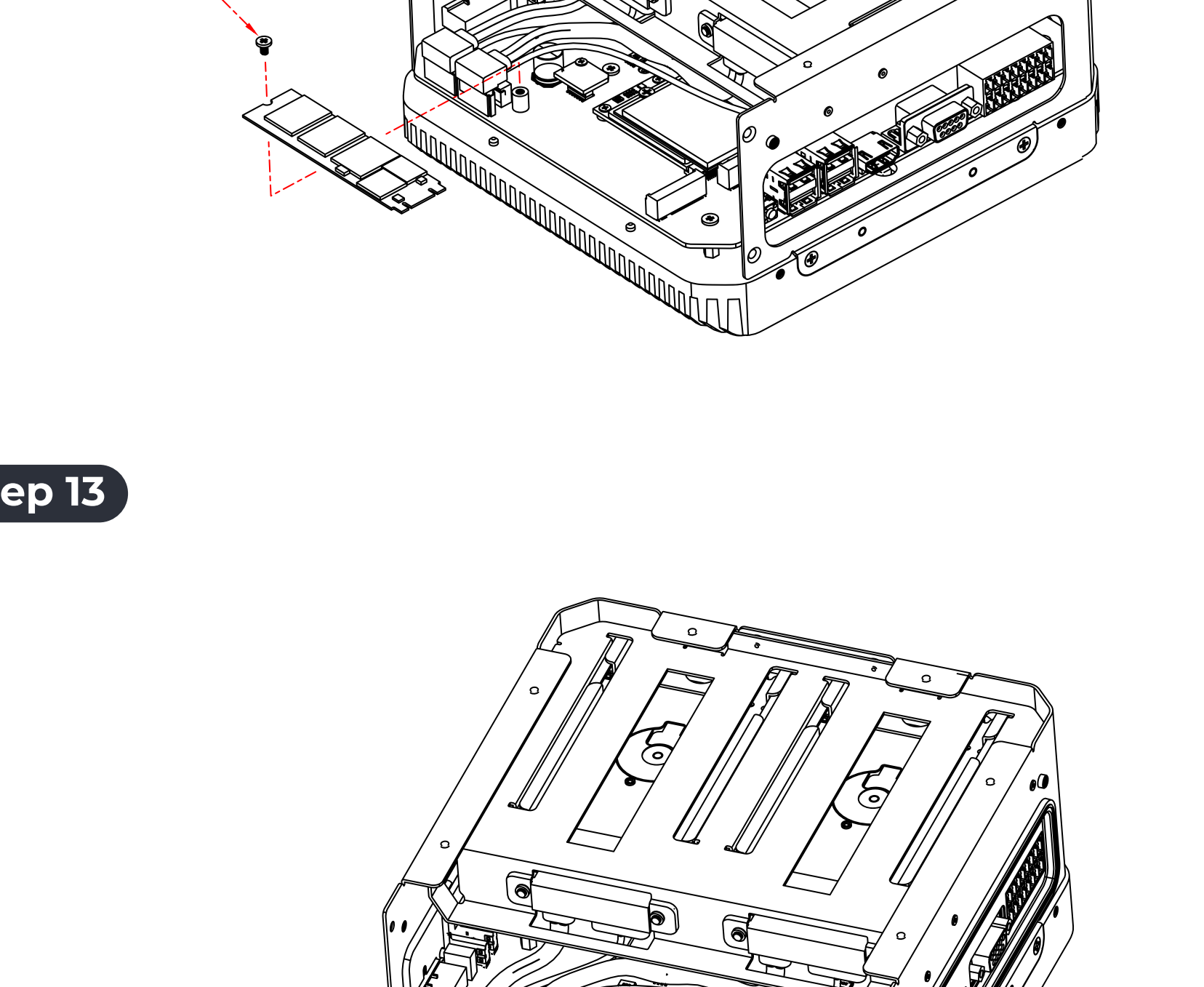

Step 10

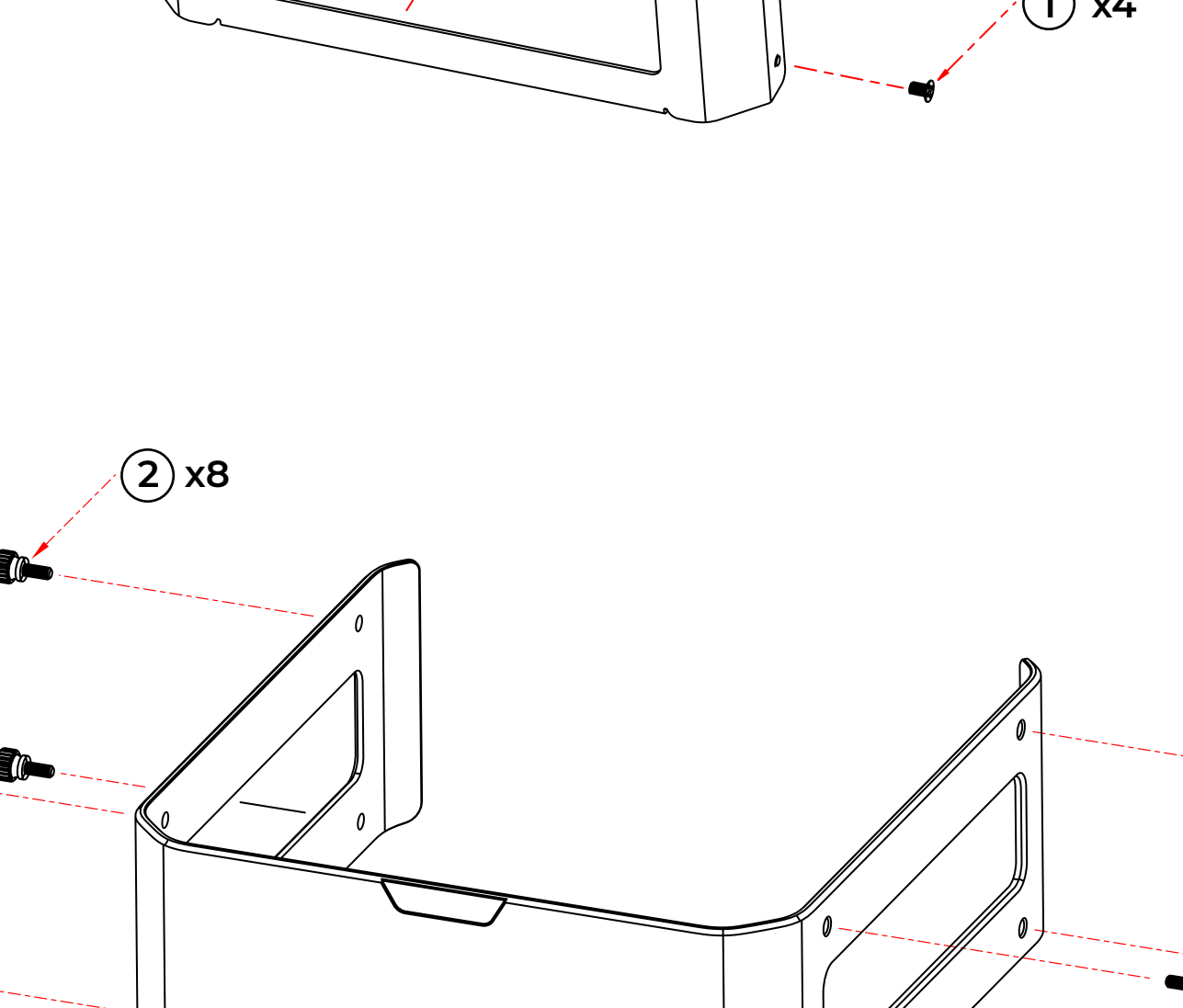

Step 11

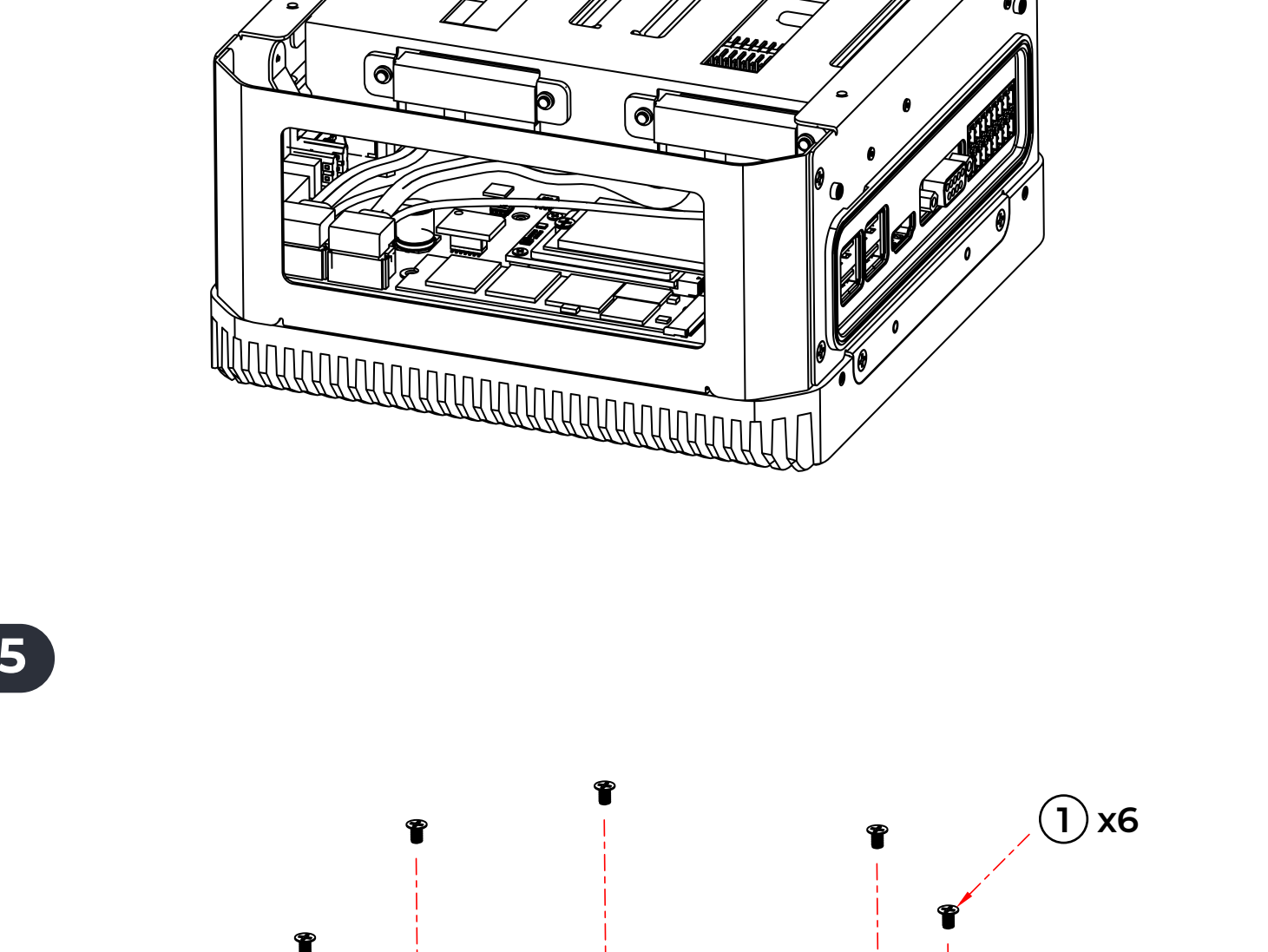

Step 12

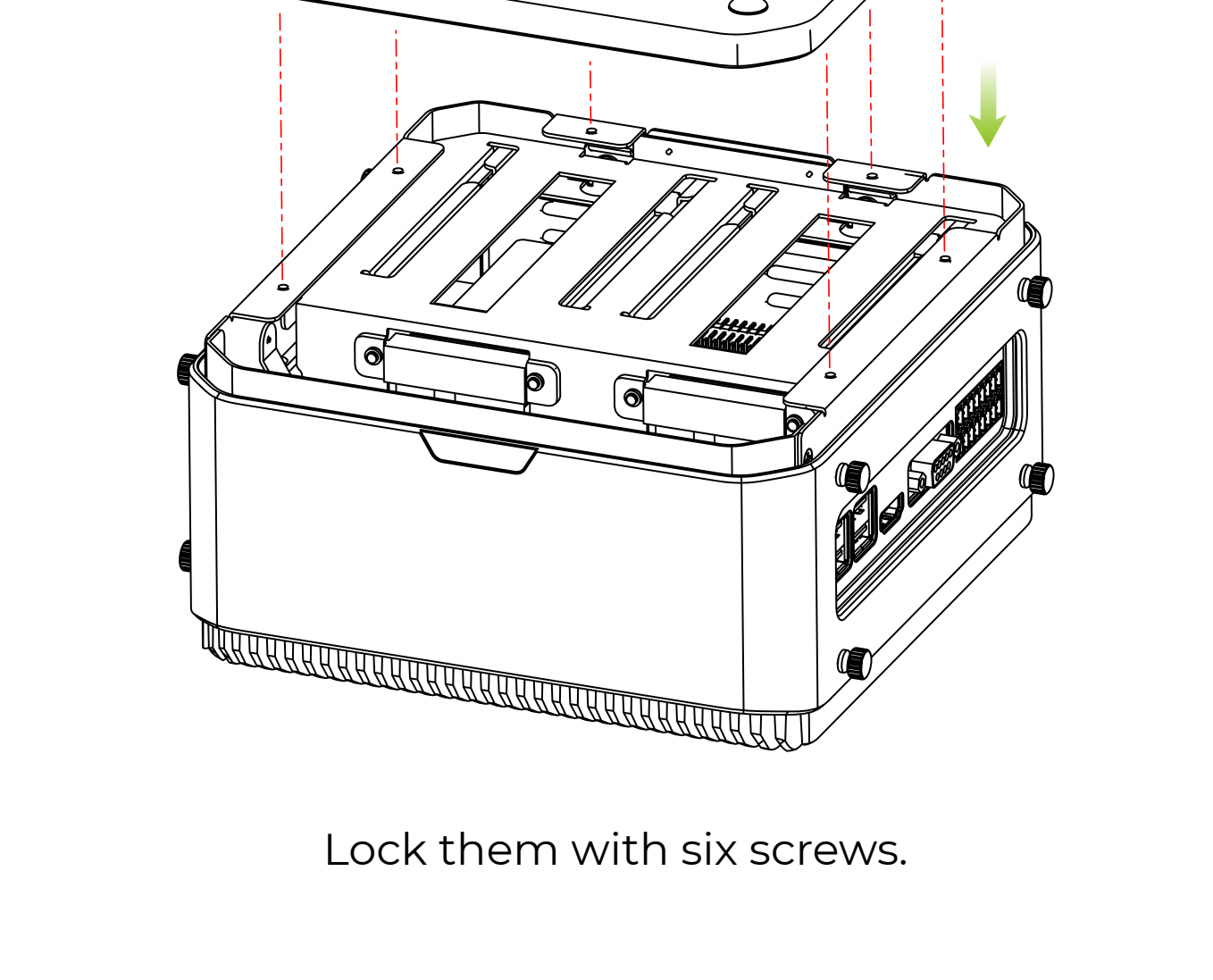

Step 13

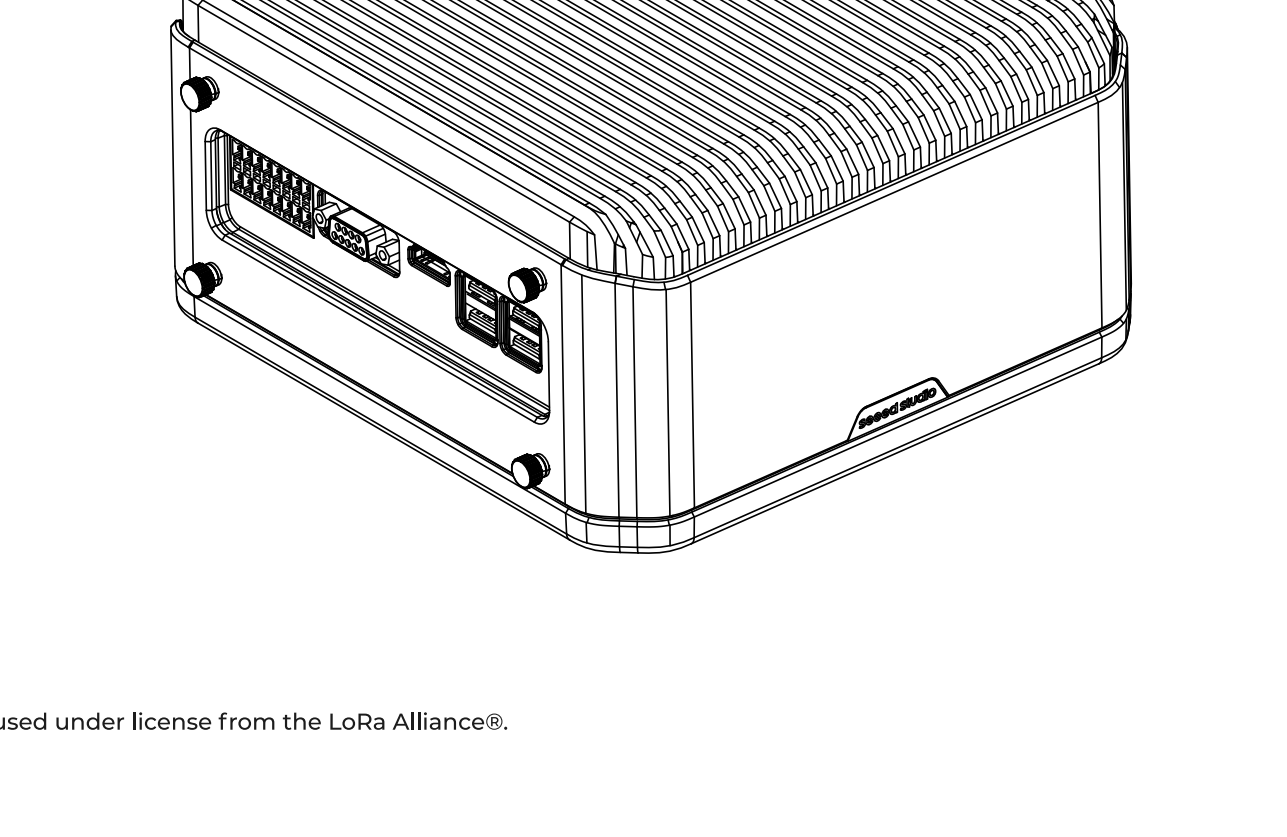

Step 14

Step 15

Lock them with six screws.

Step 16

