

NUMBER GS-20-0737	TYPE General Application Specification	Amphenol ICC	
TITLE 0.8mm pitch WTB series connector		PAGE 1 of 8	REVISION A
		AUTHORIZED BY Song .Yang	DATE 2022/Mar/30
		CLASSIFICATION UNRESTRICTED	

1.0 OBJECTIVE

This specification provides information and requirements regarding customer application of 0.80mm pitch WTB series connector. This specification is intended to provide general guidance for application process development. It is recognized that no single application process will work under all customer scenarios and that customers will develop their own application processes to meet their needs. However, if these application processes differ greatly from the one recommended, AICC cannot guarantee results.

2.0 SCOPE

This specification provides information and requirements regarding customer application of 0.8mm pitch WTB series connector .

3.0 GENERAL

This document is meant to be an application guide. If there is a conflict between the product drawings and specifications, the drawings take precedence.

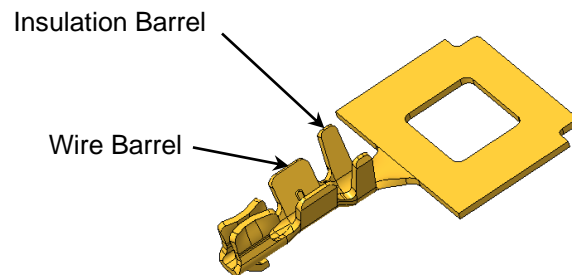

Terminal 10154208

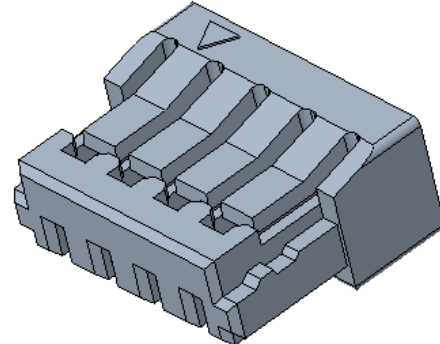

Receptacle Housing 10154207/10159026

NUMBER GS-20-0737	TYPE General Application Specification	Amphenol ICC	
TITLE 0.8mm pitch WTB series connector		PAGE 2 of 8	REVISION A
		AUTHORIZED BY Song .Yang	DATE 2022/Mar/30
		CLASSIFICATION UNRESTRICTED	

4.0 DRAWINGS AND APPLICABLE DOCUMENTS

- AFCI PRODUCT SPECIFICATION GS-12-1546
- AFCI PRODUCT DRAWINGS: 10154207 / 10154208 / 10159026.
- APPLICATION MANUALS/INSTRUCTION SHEETS (IF NOT INCLUDED IN THIS DOCUMENT)

Product drawings and **AFCI's GS-12-1546** Product Specification are available at www.fci.com. In the event of a conflict between this application specification and the drawing, the drawing will take precedence. Customers are advised to refer to the latest revision level of AFCI product drawings for appropriate details.

5.0 APPLICATION REQUIREMENTS

The wires in Table 1 are qualified for use with Terminal 10154208.

Table 1



AWG#	Conductor (mm ²)	Insulation Diameter(mm)
#28~#32	0.08~0.03	0.60 max

NUMBER GS-20-0737	TYPE General Application Specification	Amphenol ICC	
TITLE 0.8mm pitch WTB series connector		PAGE 3 of 8	REVISION A
		AUTHORIZED BY Song .Yang	DATE 2022/Mar/30
		CLASSIFICATION UNRESTRICTED	

6.0 APPLICATION TOOLING

Application Tooling needed for installation of 0.8mm pitch WTB series connector is defined in Table 2:

Table 2

Designation	Photo for information only
Mini applicator WTB AWG28~32 For 10154208	
Spare parts for mini applicator WTB AWG28~AWG32 For 10154208	
Hand tool for mini applicator WTB AWG28~AWG30 For 10154208	 <p>Part number: 10168628-001HT (Please contact with AFCl for the information of business)</p>

NUMBER GS-20-0737	TYPE General Application Specification	Amphenol ICC	
TITLE 0.8mm pitch WTB series connector		PAGE 4 of 8	REVISION A
		AUTHORIZED BY Song .Yang	DATE 2022/Mar/30
		CLASSIFICATION UNRESTRICTED	

7.0 APPLICATION PROCEDURE

- 7.1 Strip the wire
- 7.2 Crimp the wire
- 7.3 Insert the wire into the housing

Crimp the wire

Insert the wire into the housing

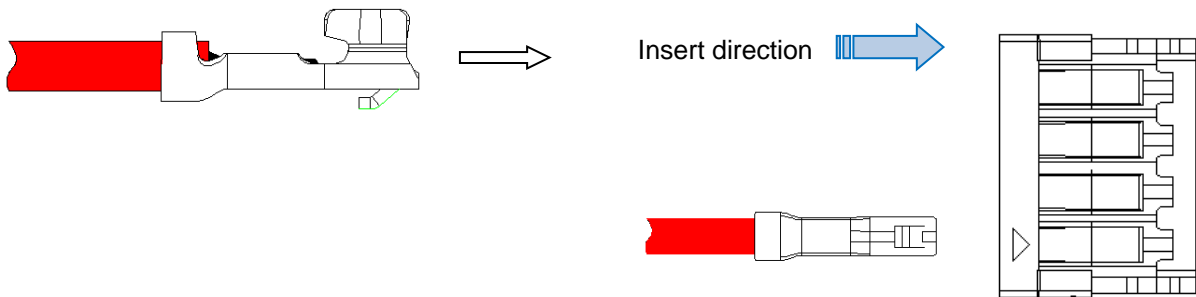

Note:

- a) Make sure the Receptacle terminal is well oriented for the insertion to the housing. Insert the terminal into HSG until the front is stopped by HSG. Then locking tab will be engaged the retention shoulder and prevent back out during mating. Pull back on the wire lightly and ensure the terminal is fully seated.

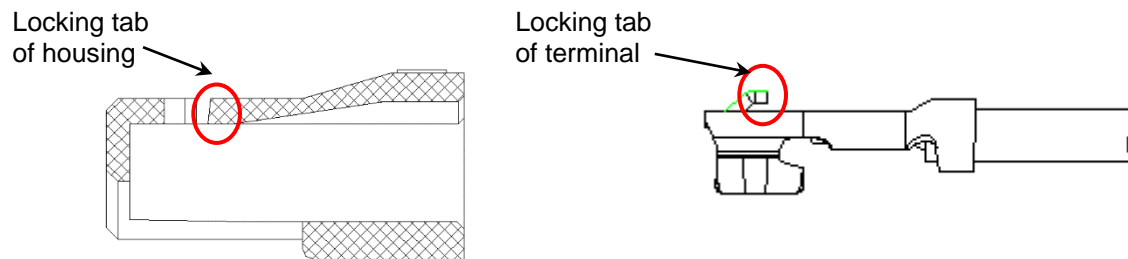

- b) The following incorrect assembly method will result in failure to insert and terminal distortion

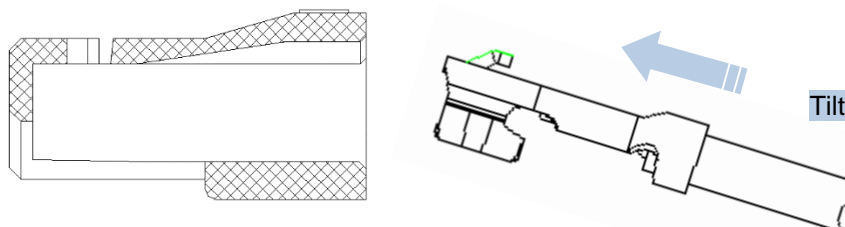

NUMBER	TYPE	Amphenol ICC	
GS-20-0737	General Application Specification		
TITLE		PAGE	REVISION
		5 of 8	A
		AUTHORIZED BY	DATE
		Song .Yang	2022/Mar/30
		CLASSIFICATION	
		UNRESTRICTED	

0.8mm pitch WTB series connector

Failure model-1

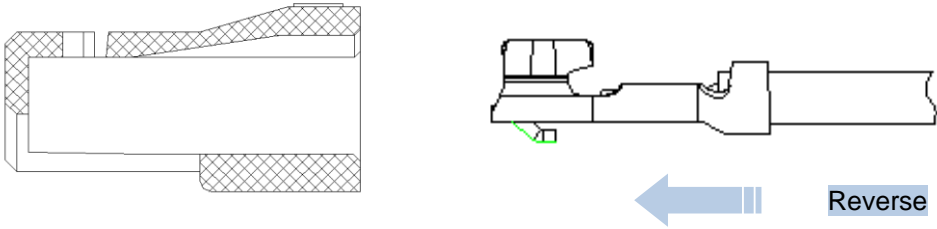

Failure model-2

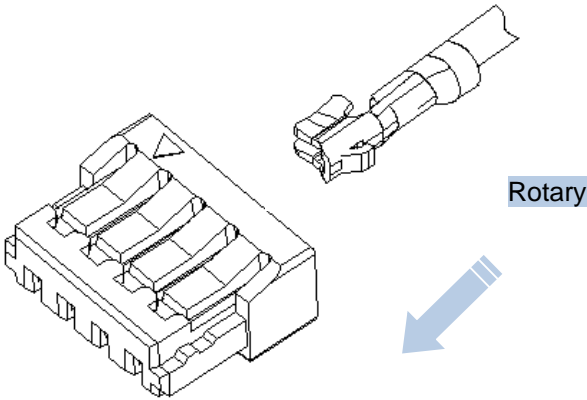

Failure model-3

NUMBER GS-20-0737	TYPE General Application Specification	Amphenol ICC	
TITLE 0.8mm pitch WTB series connector		PAGE 6 of 8	REVISION A
		AUTHORIZED BY Song .Yang	DATE 2022/Mar/30
		CLASSIFICATION UNRESTRICTED	

8.0 POST-APPLICATION INSPECTION PROCEDURES

8.1 Crimp height and width measurement:

8.1.1 Use Crimp Height Type Micrometers to measure crimping height.

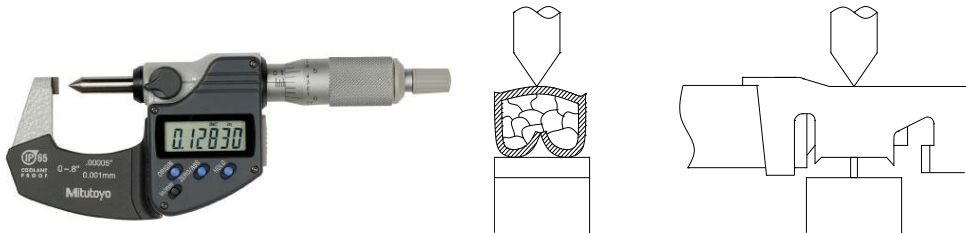

8.1.2 Required crimping dimensions, crimp height and width for different wire AWG are defined in Table 3.

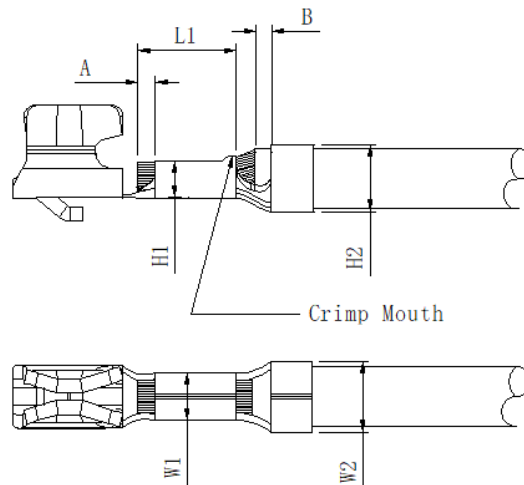

NUMBER GS-20-0737	TYPE General Application Specification	Amphenol ICC	
TITLE 0.8mm pitch WTB series connector		PAGE 7 of 8	REVISION A
		AUTHORIZED BY Song .Yang	DATE 2022/Mar/30
		CLASSIFICATION UNRESTRICTED	

Table 3

Subject:UL1571 or equivalent type electric wire					
AWG#	Conductor (mm ²)	Insulation Diameter	Insulator skins length (Dim .B) mm	Dim. L1 (mm) out	
#32~#28	0.032mm ² ~0.080mm ²	0.6mm	0.1~0.3mm	1.3~1.5mm	
Wire Gauge (AWG#)	Conductor Crimp Area		Insulator Crimp Area		Terminal Tensile Strength
	Width (W1)	Height (H1)	Width (W2)	Height (H2)	
#28	0.60±0.03mm	0.52±0.03mm	0.60±0.03mm	0.75±0.05mm	0.90kgf
#30		0.41±0.03mm		0.75±0.05mm	0.70kgf
#32		0.37±0.03mm		0.75±0.05mm	0.45kgf

Note:

1. Conductor crimp width. W1
2. Conductor crimp height. H1
3. Insulator crimp width. W2
4. Insulator crimp height. H2
5. Conductor wire shall be dimension long (mm) out A.
6. Naked part of sheathed wire must be located in the vicinity of center B.
7. The Crimp mouth must be equipped like bell.

9.0 REPAIR / REMOVAL PROCEDURE

Repairs are not recommended

NUMBER GS-20-0737	TYPE General Application Specification	Amphenol ICC	
TITLE 0.8mm pitch WTB series connector		PAGE 8 of 8	REVISION A
		AUTHORIZED BY Song .Yang	DATE 2022/Mar/30
		CLASSIFICATION UNRESTRICTED	

10.0 RECORD RETENTION

<u>REV</u>	<u>PAGE</u>	<u>DESCRIPTION</u>	<u>EC#</u>	<u>DATE</u>
A	All	New Release		2022/03/12