



# **San Ace 40**

## **High Static Pressure Fan (9HVA Type)**

**40 mm x 28 mm**

**July 9th, 2020**

# Products Highlights

---

- High airflow and static pressure
- Energy-saving
- Space-saving
- Target applications: 1U servers, switching power supplies, and communications equipment

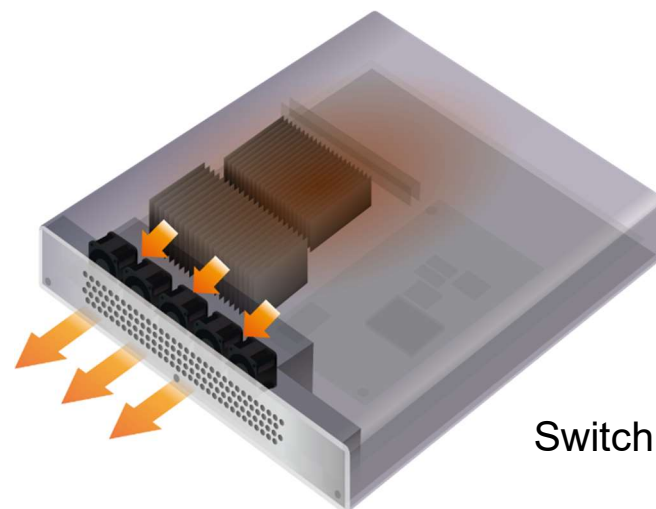

**SANYO DENKI** *AMERICA, INC.*

# High Airflow and Static Pressure And Energy-Saving

## Specifications

\*Rated speed and Sound pressure level are values at rated voltage in free air.

\*Sound pressure level is measured at 1m from the inlet.

	Rated voltage [V]	Rated speed [min <sup>-1</sup> ]	Max. airflow [CFM]	Max. static pressure [inchH <sub>2</sub> O]	SPL [dB(A)]	Rated input [W]
New model 9HVA0412P3J001	12	38,000	37.1	9.24	71	31.2
at the same air flow with current model	-	2,9000	29.0	5.46	(65)	13.9
Current model 9HV0412P3K001	12	25,000	29.3	4.42	65	17.8

## Airflow – Static Pressure Characteristics

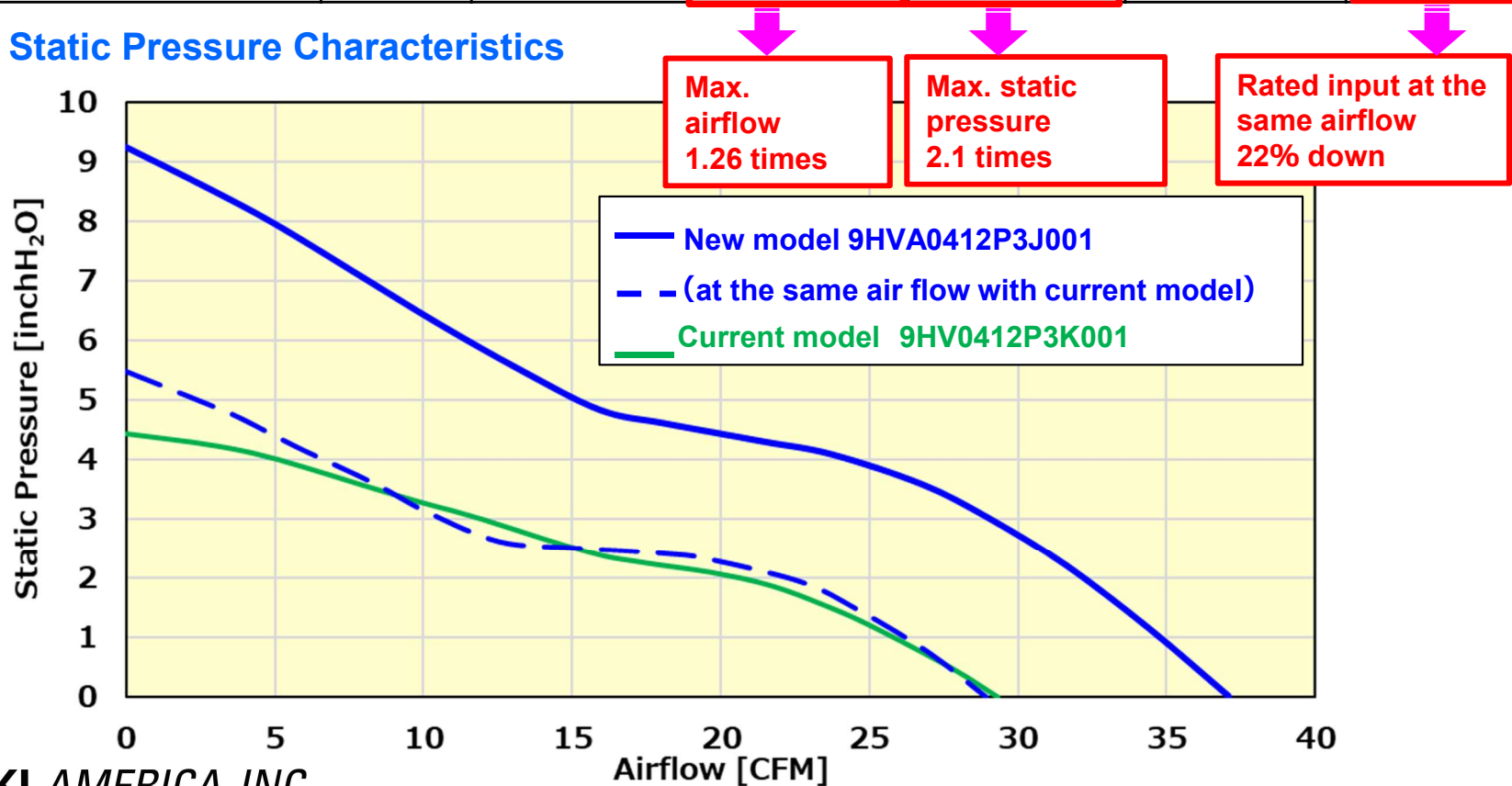

# Space-Saving

This fan delivers higher cooling performance than our 40 × 40 × 56 mm Counter Rotating Fan. The smaller fan size provides enhanced design flexibility.

## Specifications

\*Rated speed and Sound pressure level are values at rated voltage in free air.

\*Sound pressure level is measured at 1m from the inlet.

	Rated voltage [V]	Rated speed [min <sup>-1</sup> ]	Max. airflow [CFM]	Max. static pressure [inchH <sub>2</sub> O]	SPL [dB(A)]	Rated input [W]
<b>New model 9HVA0412P3J001 (40x28mm)</b>	<b>12</b>	<b>38,000</b>	<b>37.1</b>	<b>9.24</b>	<b>71</b>	<b>31.2</b>
<b>current model 9CRV0412P5J201 (40x56mm)</b>	<b>12</b>	<b>22,500 / 20,000</b>	<b>31.8</b>	<b>4.22</b>	<b>68</b>	<b>21.6</b>

## Airflow – Static Pressure Characteristics

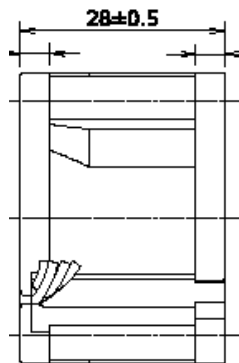

9HVA 40x28mm

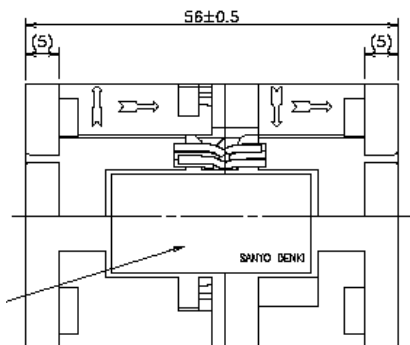

9CRV 40x56mm

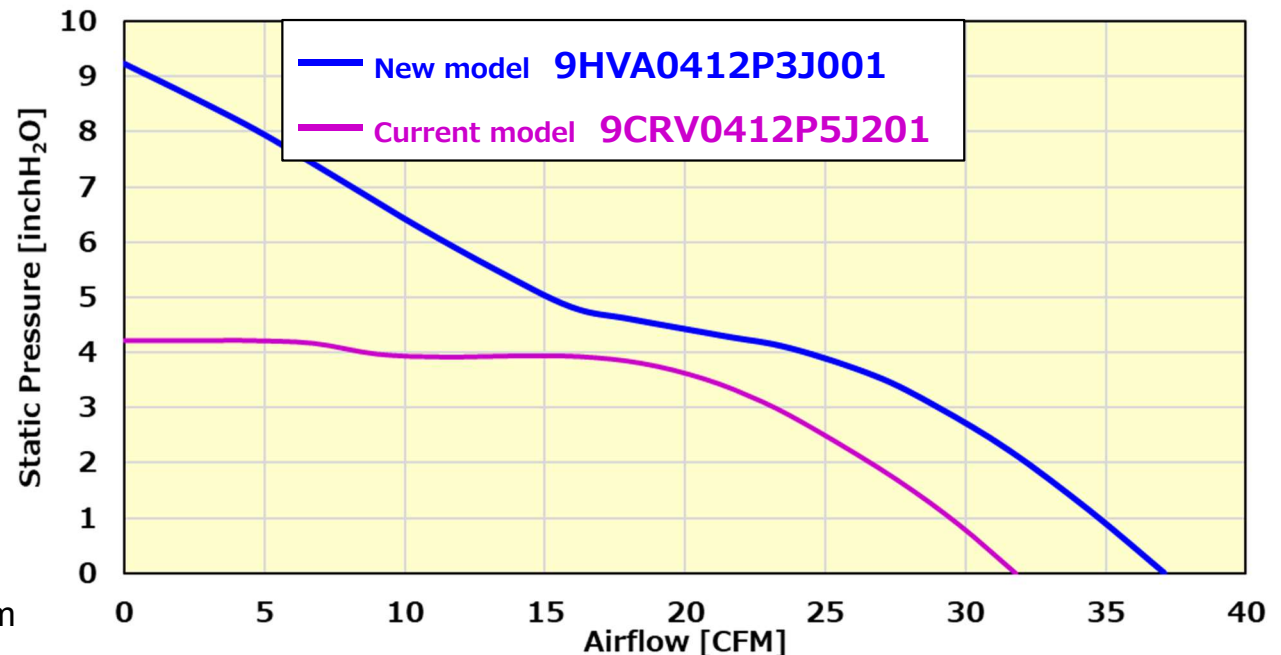

# Target Applications

---

- 1U Servers
- Switching power supplies
- Communication equipment

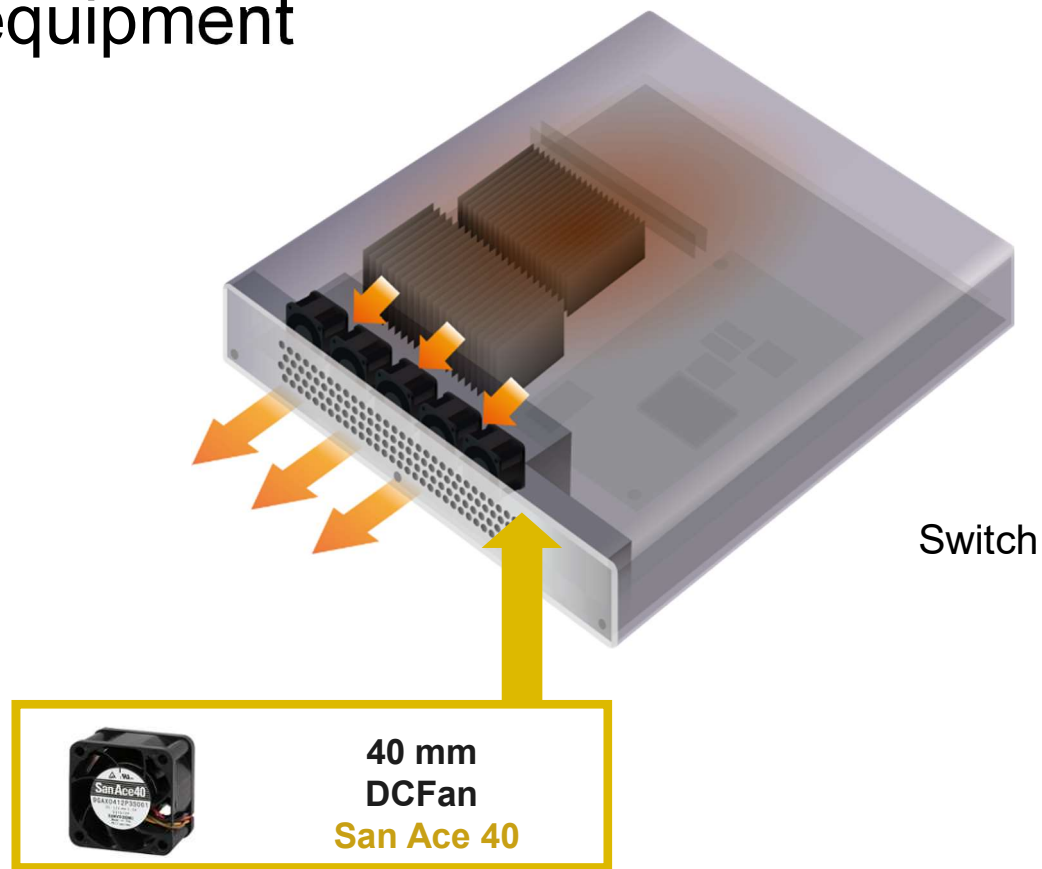

# Specifications

## Specifications

\*Rated speed and Sound pressure level are values at rated voltage in free air.

\*Sound pressure level is measured at 1m from the inlet.

Rated voltage [V]	Operating voltage range [V]	PWM duty cycle [%]	Rated input [W]	Rated speed [min <sup>-1</sup> ]	Max. airflow		Max. static pressure		Sound pressure level [dB(A)]	Operating temperature range [°C]	Expected life [h]
					[m <sup>3</sup> /min]	[CFM]	[Pa]	[inchH <sub>2</sub> O]			
12	10.2~13.8	100	31.2	38,000	1.05	37.1	2,300	9.24	71	-20~70	30,000 @60°C
		20	1.4	8,000	0.22	7.8	101	0.41	34		

## Sensor

Pulse sensor is standard, Lock sensor and sensor less are available as options.

## Dimensions

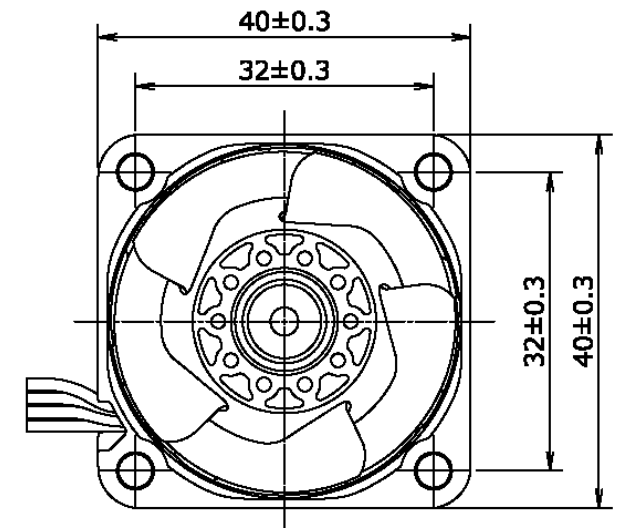
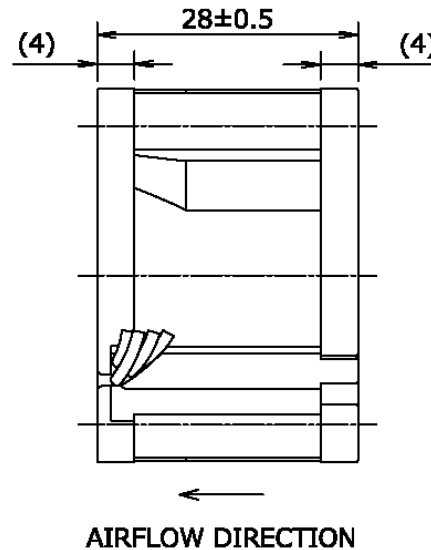
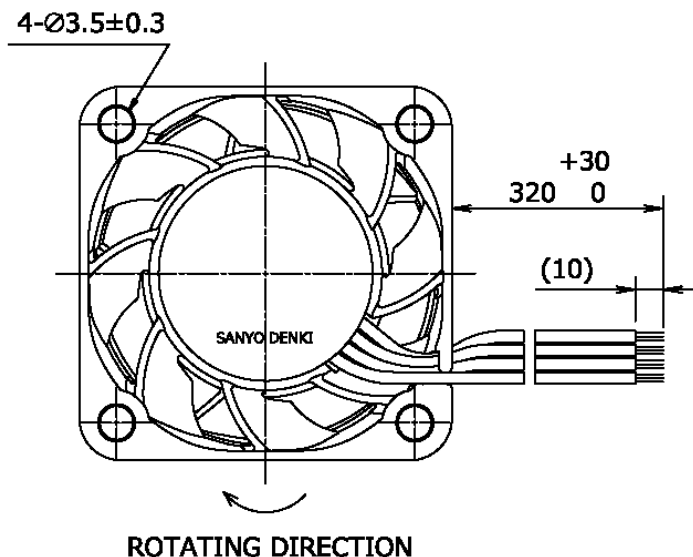

□ MTBF = 3 million hours

□ FIT rate = 330

**SANYO DENKI AMERICA, INC.**

# Performance vs Power

**MODEL : 9HVA0412P3J001**

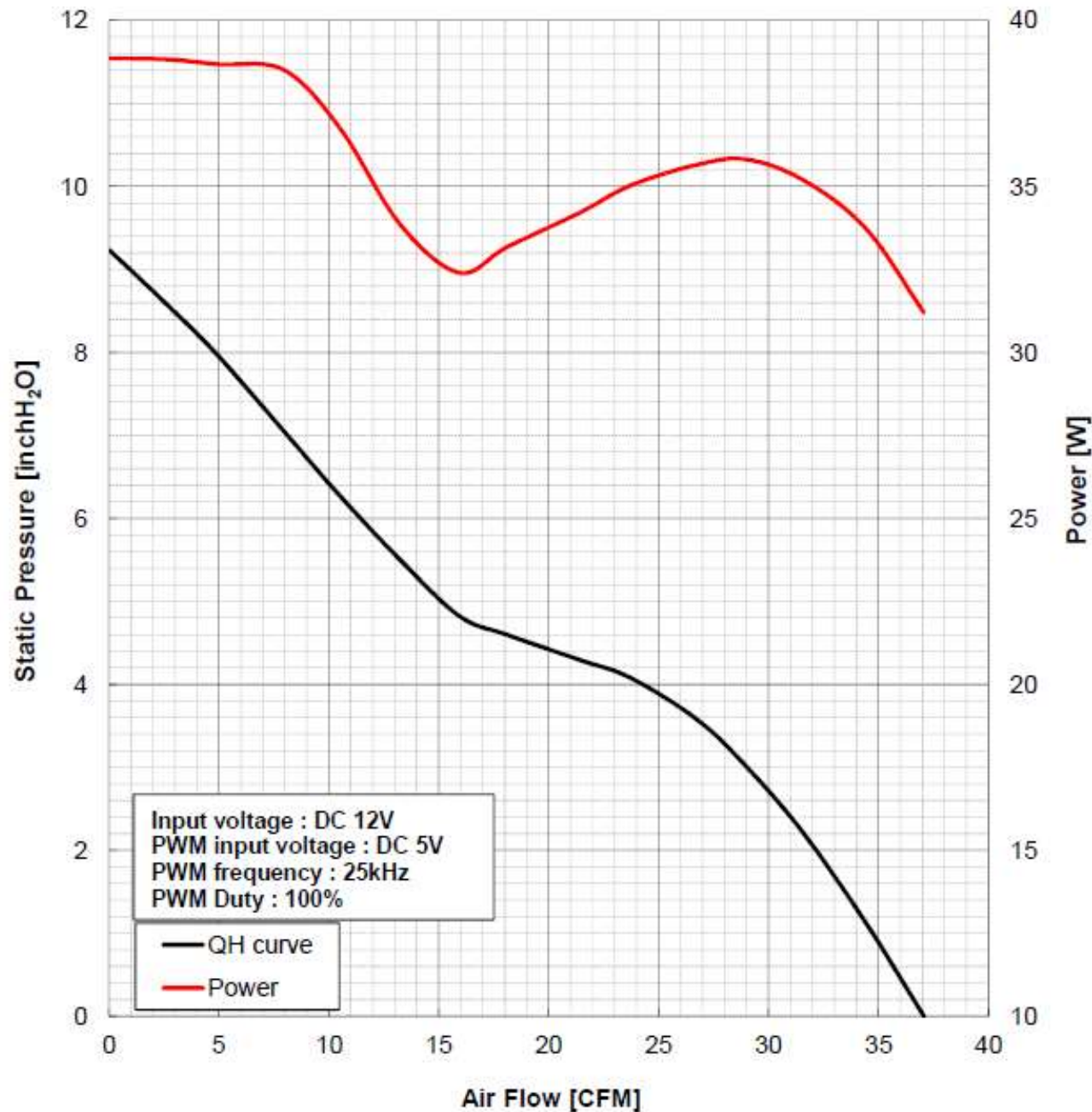

**SANYO DENKI** *AMERICA, INC.*



# Sound Pressure vs RPM

MODEL : 9HVA0412P3J001

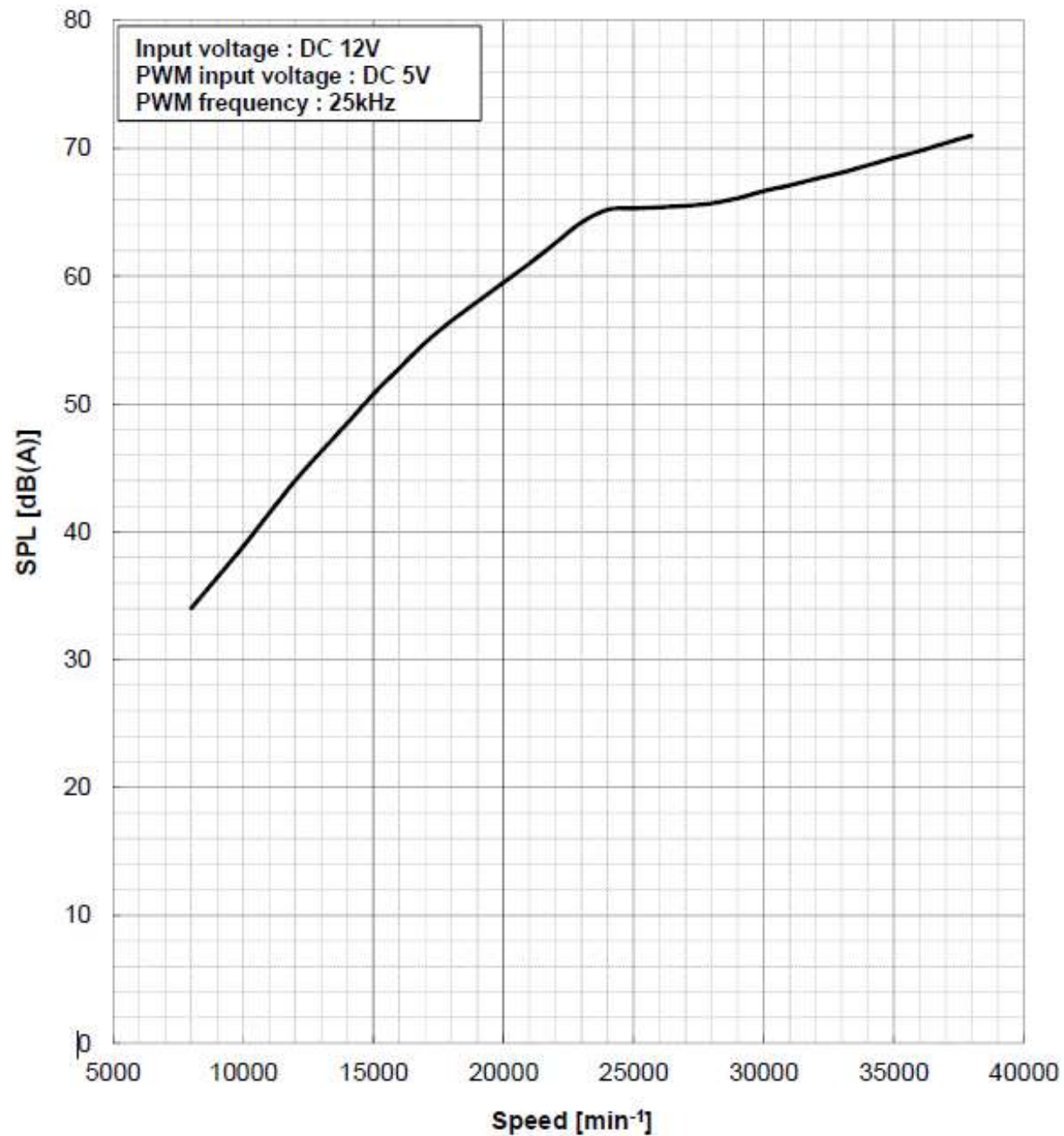

**SANYO DENKI** *AMERICA, INC.*



# Speed vs PWM Duty

MODEL : 9HVA0412P3J001

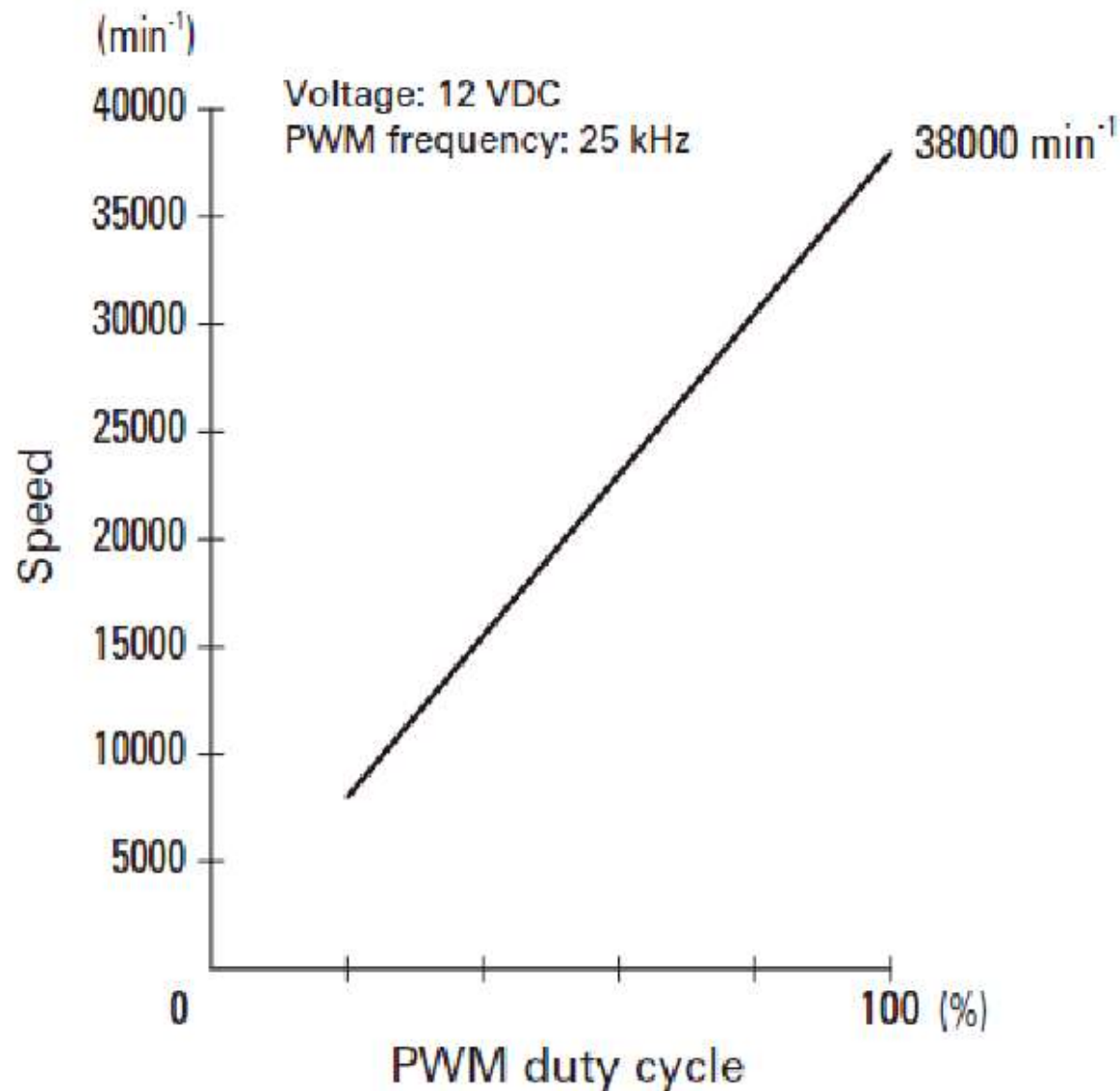

# Miscellaneous

---

- **Customizations available;**
  - **Harness assembly and custom wiring**

Sanyo Denki can recommend connectors and terminals.
  - **Conformal coating options**
  - **Others**
- **Only 12VDC available**
- **cUL and TUV approved**