

RS485 Wind Speed Transmitter

SEN0483

Product Overview

12-28-2022

For the most up-to-date information, visit www.mouser.com or the supplier's website.

Description

DFRobot RS485 Wind Speed Transmitter is a professional meteorological instrument used to measure horizontal wind speed from 0m/s to 32.4m/s. This transmitter features quality bearings, low resistance, low start-up wind speed, high measurement accuracy, good stability, and strong anti-interference ability. The RS485 wind speed transmitter also features 7V to 24V power voltage, ± 0.3 m/s accuracy, and RS485 interface Modbus protocol.



The RS485 wind speed transmitter integrates a hall sensor inside. The shell and wind cups are made of aluminum alloy material and use a special mold precision die-casting process featuring small dimension tolerance and high surface accuracy. The sensor's internal circuit is protected, which makes the sensor have high strength, weather resistance, anti-corrosion, and waterproof properties. The cable connector adopts a corrosion-resistant military plug that ensures the long service life of the product. The sensor can be widely used in meteorology, ocean, environment, airports, ports, laboratories, industry, agriculture, and transportation.

Features

- Compact size, easy to install, and portable
- The surface of aluminum alloy material is sprayed with plastic, anti-corrosion, and high-temperature resistance
- Quality bearings, low resistance, and low start-up wind speed
- High measurement accuracy, wide range, and good stability
- Reasonable structure design, good appearance quality
- Long signal transmission distance and strong anti-interference ability

Specifications

- 0m/s to 32.4m/s measuring range
- 0.2m/s to 0.4m/s start-up wind speed
- ± 0.3 m/s accuracy
- 2.5m/98.43" lead length
- 7V to 24V power voltage range
- RS485 interface Modbus protocol communication protocol

Dimensions

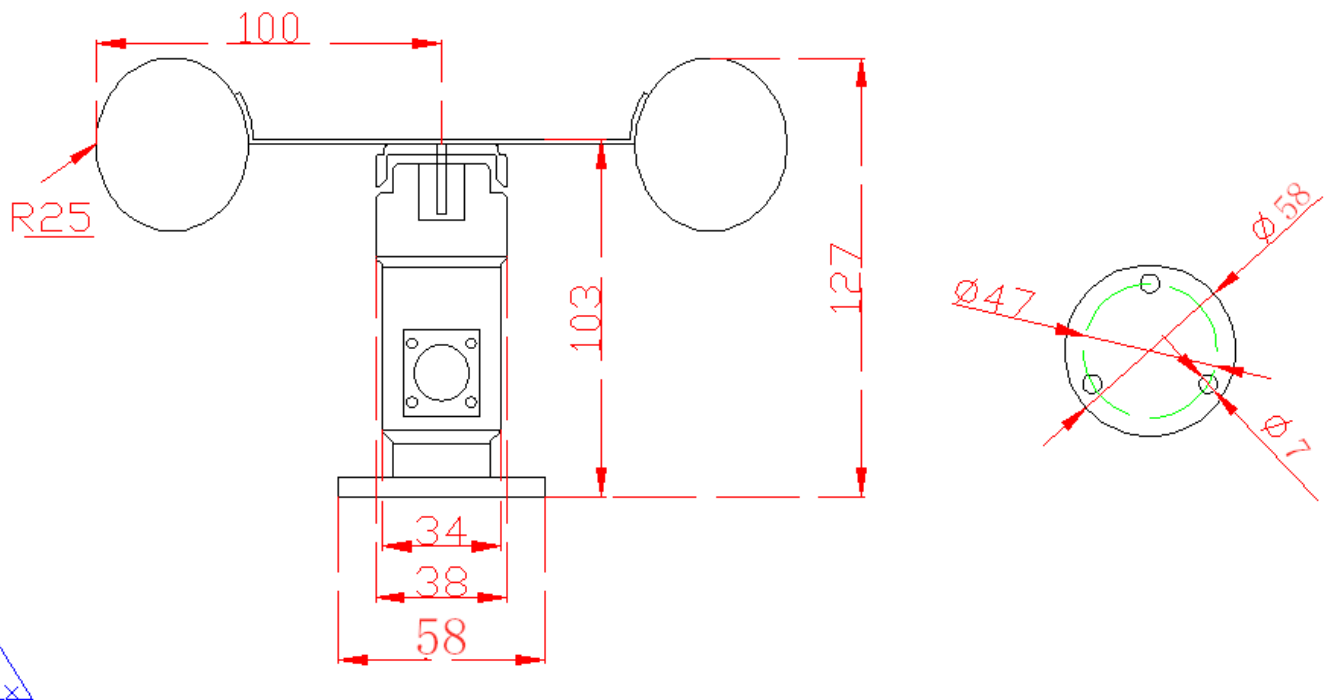

Mouser Part Number

[View Part](#)

To learn more, visit <https://www.mouser.com/new/dfrobot/dfrobot-rs485-wind-speed-transmitter/>