

# 370 Mini Vacuum Pump

FIT0801

## Product Overview

01/09/2023

For the most up-to-date information, visit [www.mouser.com](http://www.mouser.com) or the supplier's website.

## Description

DFRobot 370 Mini Vacuum Pump is an easy-to-use air pump suitable for beginners to make inflatable or pneumatic projects. This vacuum pump is basically a DC motor, and the power consumption is only 2.5W when powered by 5V. Use the same power supply as other DC motors or servo systems to power it.



When powered on, the pump sucks air from the side port and outputs it from the middle port. The direction of the airflow can be changed by reversing the polarity of the motor. Two pumps are required to inflate and deflate at the same time. The pump flow rate is 2.2 Liters Per Minute (LPM), and its maximum suction is -58kpa. This air pump can be used in household appliances, medical equipment, vacuum packaging machines, and so on.

## Features

- 1.5V~5V operating voltage range
- $\leq 500\text{mA}$  (5V) no-load current
- $\geq 2.2\text{L/min}$  (5V) no-load flow
- $< 60\text{dB}$  noise
- $\geq -58\text{Kpa}$  maximum vacuum

## Dimensions in mm

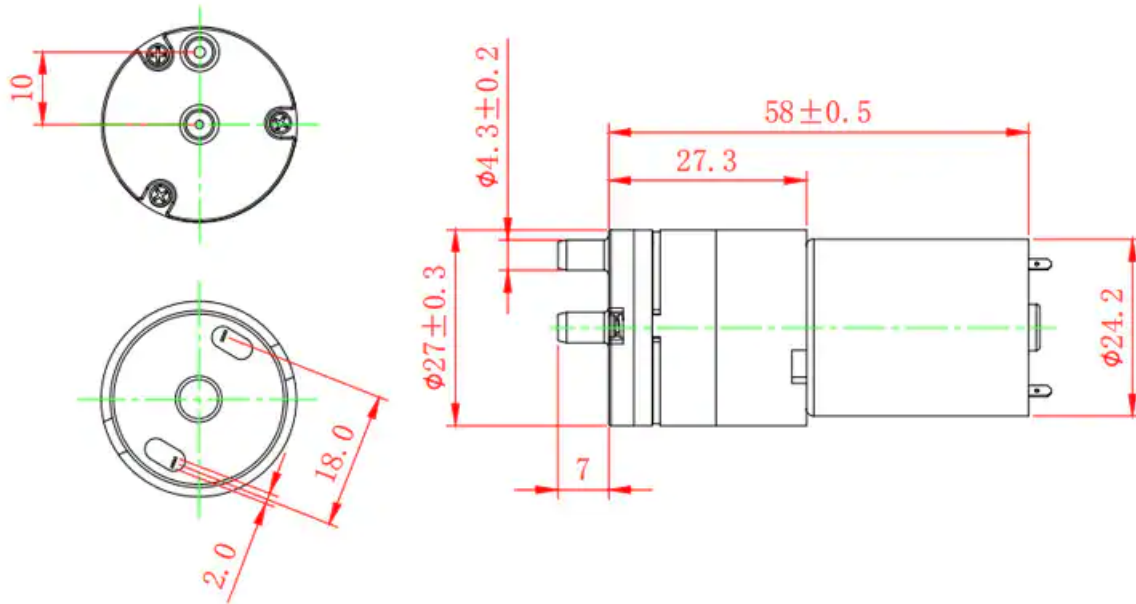

## Mouser Part Number

[View Part](#)

To learn more, visit <https://www.mouser.com/new/dfrobot/dfrobot-370-mini-vacuum-pump/>