

24V Surface Mount Transient Voltage Suppressor



FEATURES

- AEC-Q101 qualified
- Extremely low clamping voltage
- Bidirectional Transient Voltage Suppressor
- Low leakage current
- Clamping ratio (V_C / Stand-off Voltage) between 1.0~1.05
- Moisture sensitivity level: level 1, per J-STD-020
- RoHS compliant
- Halogen-free

APPLICATIONS

- Transient Surge Protection

MECHANICAL DATA

- Case: DO-214AA (SMB)
- Molding compound meets UL 94V-0 flammability rating
- Terminal: Matte tin plated leads, solderable per J-STD-002
- Meet JESD 201 class 2 whisker test
- Weight: 0.08g (approximately)

KEY PARAMETERS		
PARAMETER	VALUE	UNIT
V_{WM}	24	V
V_{BR}	35	V
$T_J \text{ MAX}$	175	°C
Package	DO-214AA (SMB)	



DO-214AA (SMB)



ABSOLUTE MAXIMUM RATINGS ($T_A = 25^\circ\text{C}$ unless otherwise noted)

PARAMETER	SYMBOL	VALUE	UNIT
Junction temperature	T_J	-55 to +175	°C
Storage temperature	T_{STG}	-55 to +175	°C

ELECTRICAL SPECIFICATIONS ($T_A = 25^\circ\text{C}$ unless otherwise noted)

Part number	Breakdown voltage V_{BR} at I_T (V) (Note 1)		Test current I_T (mA)	Working stand-off voltage V_{WM} (V)	Maximum blocking leakage current I_R at V_{WM} (μA) (Note 1)	Maximum peak impulse current I_{PPM} (A) $t_p = 10/1000$ (μs)	Typical clamping voltage V_C at I_{PPM} (V)
	Min	Max					
LSMB24CAH	31	35	1	24	1	45	24

Notes:

1. Pulse test with $PW = 30\text{ms}$

ORDERING INFORMATION

ORDERING CODE	PACKAGE	PACKING
LSMB24CAH	DO-214AA (SMB)	3,000 / Tape & Reel

I - V CURVE CHARACTERISTICS

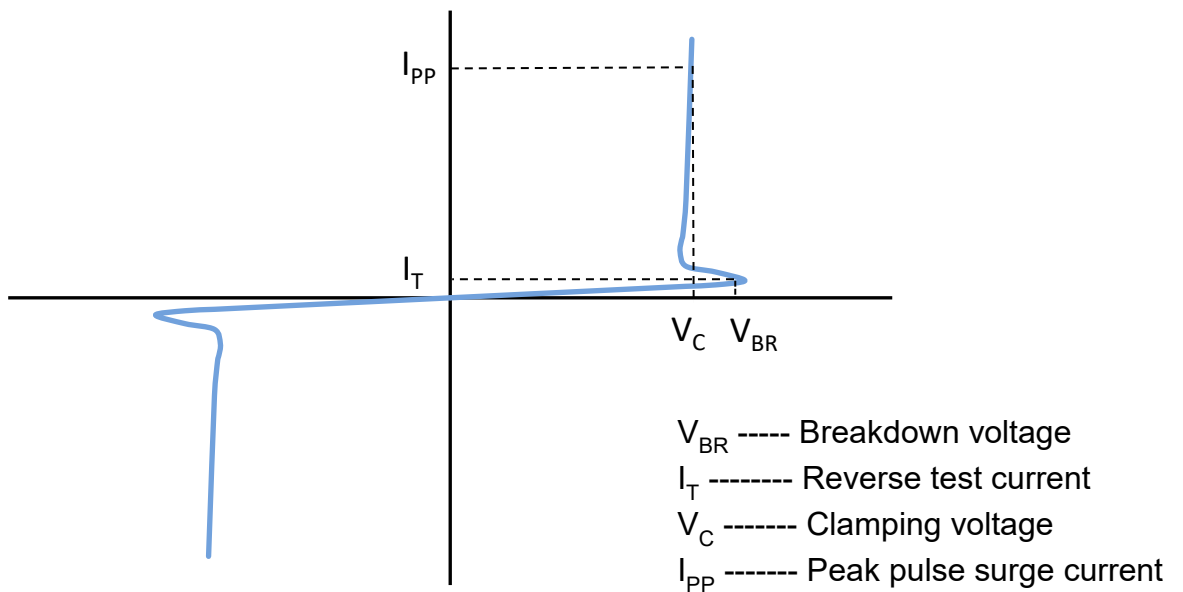

CHARACTERISTICS CURVES

($T_A = 25^\circ\text{C}$ unless otherwise noted)

Fig.1 Peak Pulse Power Derating Curve

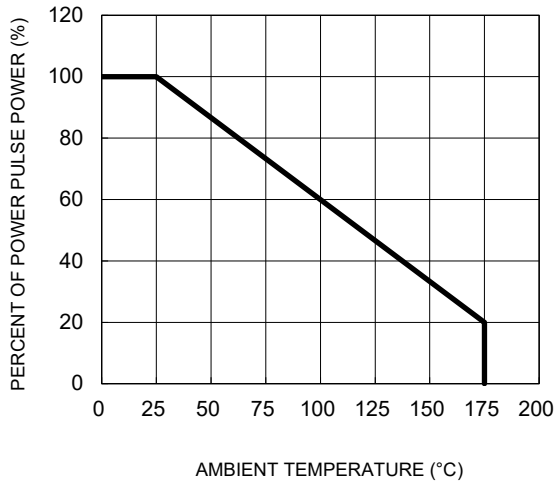

Fig.2 Peak Pulse Current vs. Pulse Time

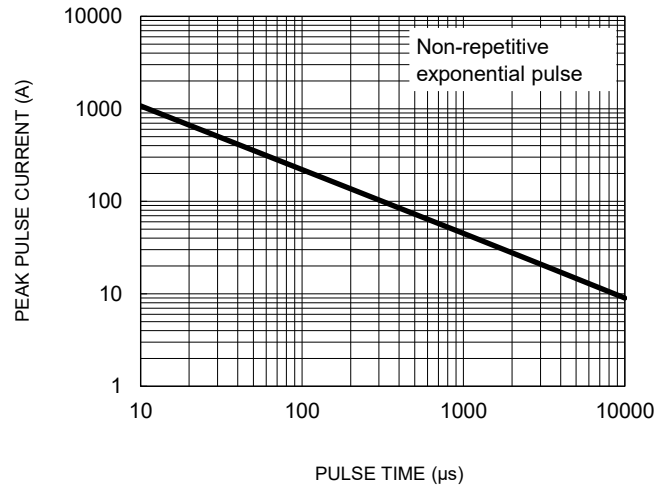

Fig.3 Typical Breakdown Voltage vs. Temperature

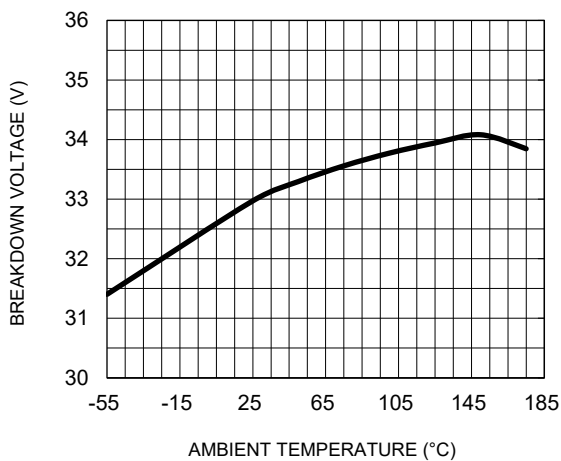

Fig.4 Typical Junction Capacitance

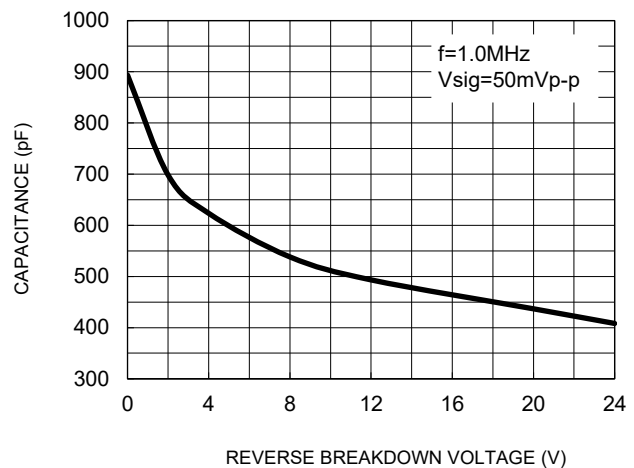
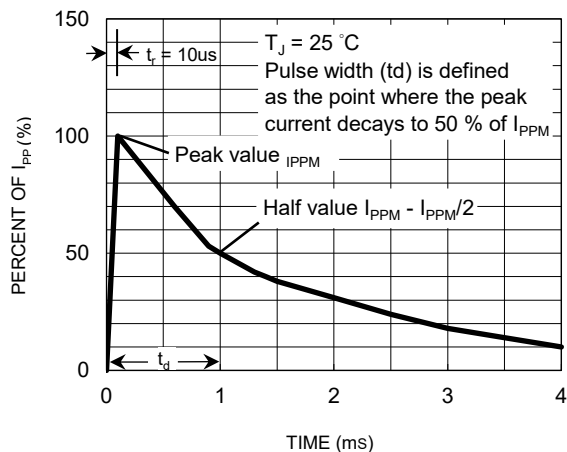
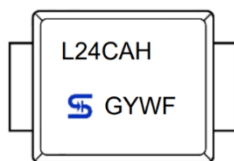
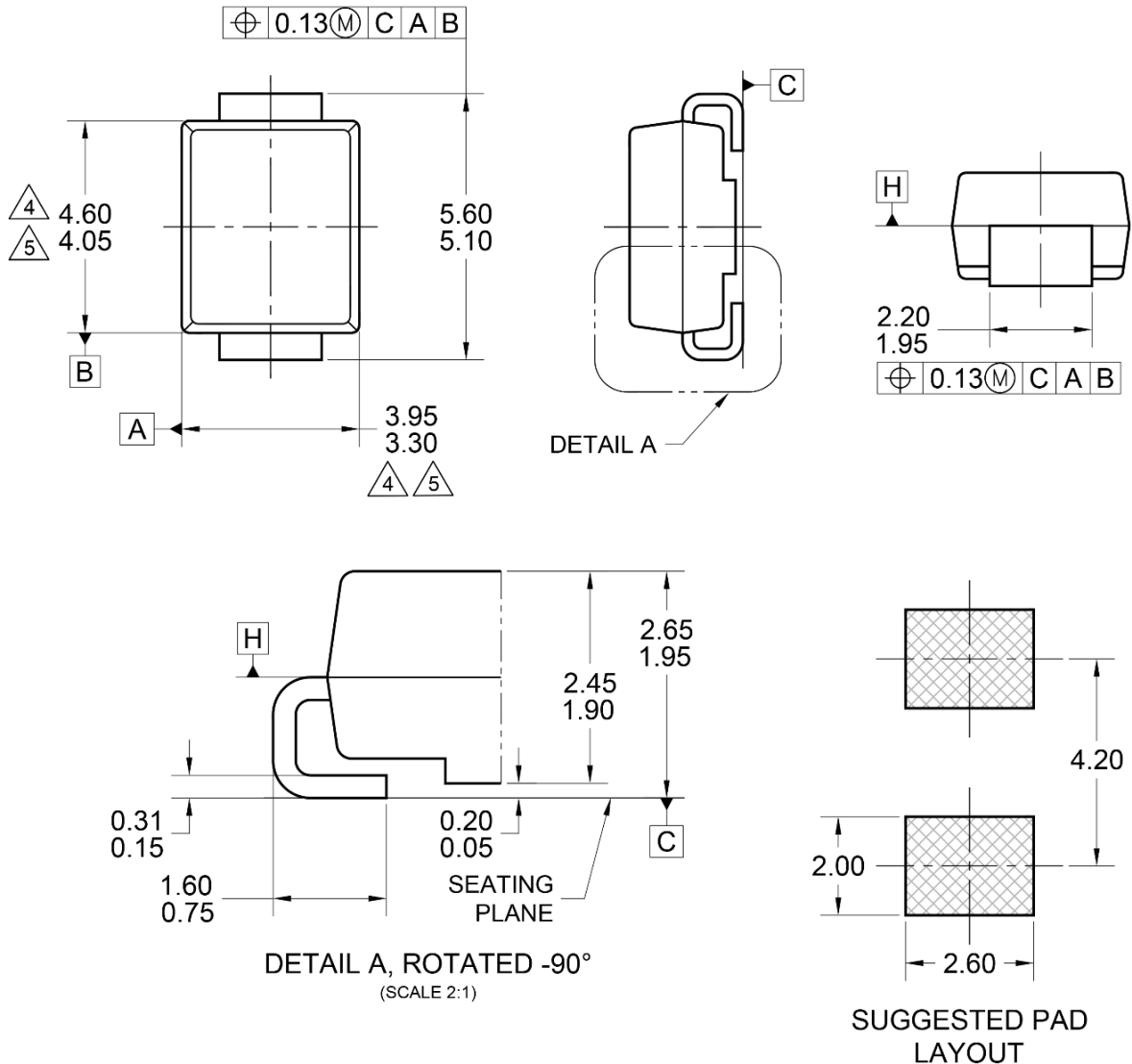

Fig.5 10/1000µs pulse waveform



PACKAGE OUTLINE DIMENSIONS

DO-214AA (SMB)



MARKING DIAGRAM

G = Green compound
YW = Date code
F = Factory code

NOTES: UNLESS OTHERWISE SPECIFIED

1. ALL DIMENSIONS ARE IN MILLIMETERS.
2. DIMENSIONING AND TOLERANCING PER ASME Y14.5M-1994.
3. PACKAGE OUTLINE REFERENCE: JEDEC DO-214, VARIATION AA, ISSUE D.
4. MOLDED PLASTIC BODY DIMENSIONS DO NOT INCLUDE MOLD FLASH.
5. MOLDED PLASTIC BODY LATERAL DIMENSIONS TO BE DETERMINED AT DATUM PLANE H.
6. DWG NO. REF: HQ2SD07-DO214SMB-035 REV A.

Notice

Specifications of the products displayed herein are subject to change without notice. TSC or anyone on its behalf assumes no responsibility or liability for any errors or inaccuracies.

Purchasers are solely responsible for the choice, selection, and use of TSC products and TSC assumes no liability for application assistance or the design of Purchasers' products.

Information contained herein is intended to provide a product description only. No license, express or implied, to any intellectual property rights is granted by this document. Except as provided in TSC's terms and conditions of sale for such products, TSC assumes no liability whatsoever, and disclaims any express or implied warranty, relating to sale and/or use of TSC products including liability or warranties relating to fitness for a particular purpose, merchantability, or infringement of any patent, copyright, or other intellectual property right.

The products shown herein are not designed for use in medical, life-saving, or life-sustaining applications. Customers using or selling these products for use in such applications do so at their own risk and agree to fully indemnify TSC for any damages resulting from such improper use or sale.