

IRC40

Rectangular Inductive Sensor

Market Introduction

September 2022

CONTENTS

INTRODUCTION

What is it?
Why?

THE PRODUCT

Relevant technical features
Part numbers

APPLICATIONS

Examples
Features & benefits

CONCLUSIONS





INTRODUCTION

INTRODUCTION

What Is It?

- ▼ A new family of DC 4-wire inductive sensors in a compact, rectangular housing to detect metal targets with:
 - ▼ **Exceptional performance** due to a long sensing range, microprocessor technology, IP69K rating, and extended temperature range.
 - ▼ **Easy & flexible installation** due to push-button mounting bracket, adjustable sensing face, and status LEDs.

Why?

- ▼ By expanding the inductive sensor portfolio, Carlo Gavazzi expects to strengthen its position with OEMs designing for challenging industries, such as conveying systems, material handling, and escalators. The new IRC40 sensors appeal to a variety of applications due to:
 - ▼ **Exceptional performance** even in challenging applications
 - ▼ **Easy & flexible installation** to save time and fit a variety of needs



PRODUCT

IRC40 INDUCTIVE SENSOR PRODUCT LAUNCH



PRODUCT - PART NUMBERS

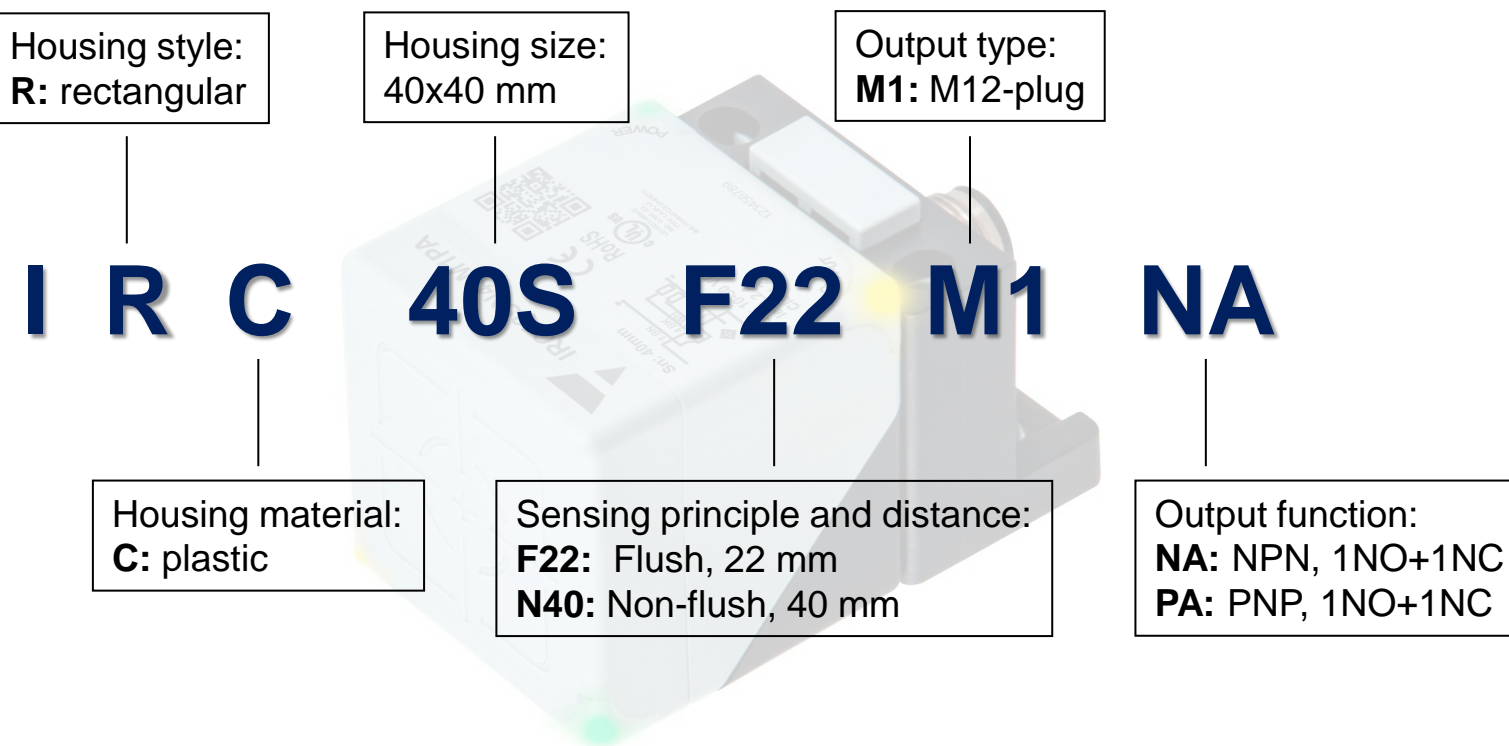

Mounting	Rated operating distance Sn	Output type	Ordering no.
Flush	22 mm	NPN, 1NO + 1NC	IRC40SF22M1NA
		PNP, 1NO + 1NC	IRC40SF22M1PA
Non-flush	40 mm	NPN, 1NO + 1NC	IRC40SN40M1NA
		PNP, 1NO + 1NC	IRC40SN40M1PA

Relevant Technical Data – IRC40

- Rotatable sensing face in 5 different positions without the need of additional tools
- Bracket with push unlock system for easy and quick mounting or replacement
- Flush or non-flush mountable
- Extended sensing distance: **22 to 40 mm**
- Antivalent output (NO+NC): NPN or PNP
- 4 corner visible LEDs with diagnostic functions
- Operating temperature: **-25°C to +80°C (-13°F to +176°F)**
- IP67, IP68 and **IP69K**



PRODUCT - FLEXIBLE INSTALLATION

- IRC40 sensors can be quickly and easily installed without the need of any tools thanks to the push-unlock system present on the mounting bracket

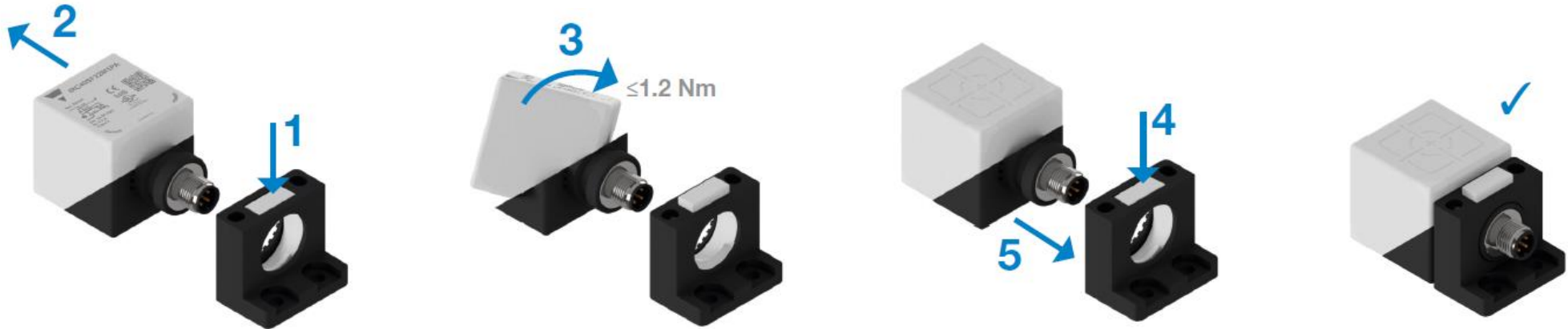

IRC40 INDUCTIVE SENSOR PRODUCT LAUNCH



PRODUCT - FEATURES

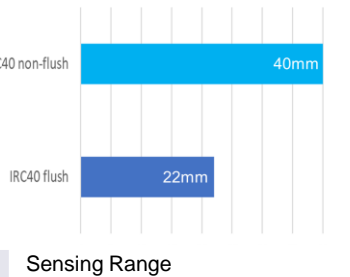

Long switching distance (40mm non-flush & 22mm flush) allows the sensor to be positioned farther away from the moving target reducing the risk of physical impact and damage to the sensor.

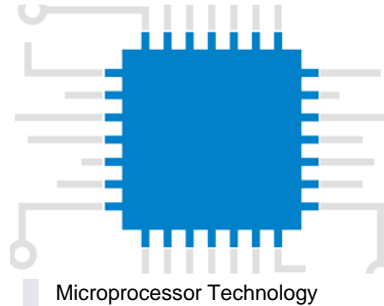

Accurate and reliable detection of the target across the entire temperature range



2 LEDs on each side of the sensor (4 total) allow clearly visible indication from any direction

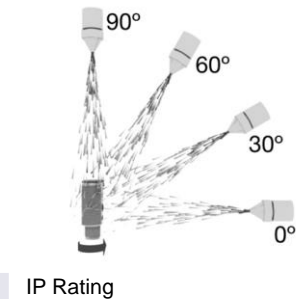

Certified IP69K protection ensures sensor is sealed from water or moisture ingress

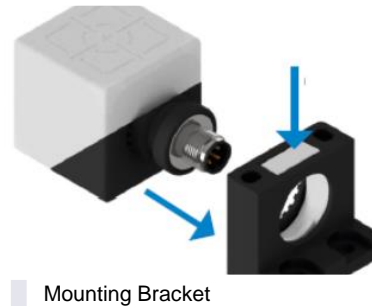

Quick and easy installation and replacement without any tools due to push-button mounting bracket system

Green LED	Yellow LED	Output	Description
ON	OFF	OFF	Target not present
ON	ON	ON	Target present
-	Blinking	f: 2Hz	Short-circuit or overload

Status LEDs

2 green LEDs indicate operating status and 2 yellow LEDs indicate target detection and diagnostic information (overload or short circuit)

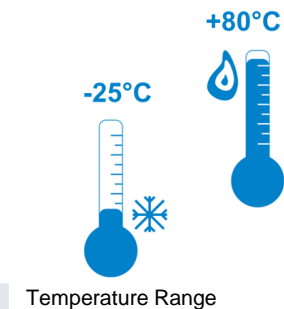

Continuous operation between -25°C to +80°C (-13°F to +176°F) allows consideration for many applications



Rotatable head allows 5 positions of the sensing face in a single sensor for reduced variants and ease of installation



Laser etched label permanently legible on housing



APPLICATIONS

IRC40 INDUCTIVE SENSOR PRODUCT LAUNCH

APPLICATIONS - OVERVIEW

Material Handling



To monitor
material position

Logistics



To monitor material position

Escalators



To detect presence of a step

APPLICATIONS – MATERIAL HANDLING EXAMPLE



Customer need

In material handling production lines, installation flexibility is required due to frequent changes of target size and position. When a new setup is needed, the production line is stopped in order to adjust sensor position

Our Solution

The possibility to rotate the sensing face in 5 different positions within a tool-free mounting system ensures fast and easy installation or replacement of the sensor in every application

Benefits

- Easily adaptable to a variety of applications.
- Quick sensor replacement.
- Reduced machine downtime and higher efficiency.

APPLICATIONS – ESCALATOR EXAMPLE



Customer need

Continuous operation is critical for escalator applications. The escalator must continuously run even in challenging environments such as high loads, food / beverage spills, dirt / slush from winter boots, etc. Small misalignments such as shifting during use or slight variations in each step can occur and need to be tolerated without false trips resulting in unnecessary downtime. However, if a step is broken or missing due to aging or extensive use, the conveyor drive must be stopped immediately.

Our Solution

The possibility to rotate the sensing face in 5 different positions within a tool-free mounting system ensures fast and easy installation or replacement of the sensor in every application. Moreover, the longer sensing distance (up to 40mm) provides the sensor some physical protection from being hit by the target.

Benefits

- Easily adaptable to a variety of applications.
- Quick sensor replacement and maintenance.
- Higher efficiency of the escalator.

APPLICATIONS – CONVEYING EXAMPLE

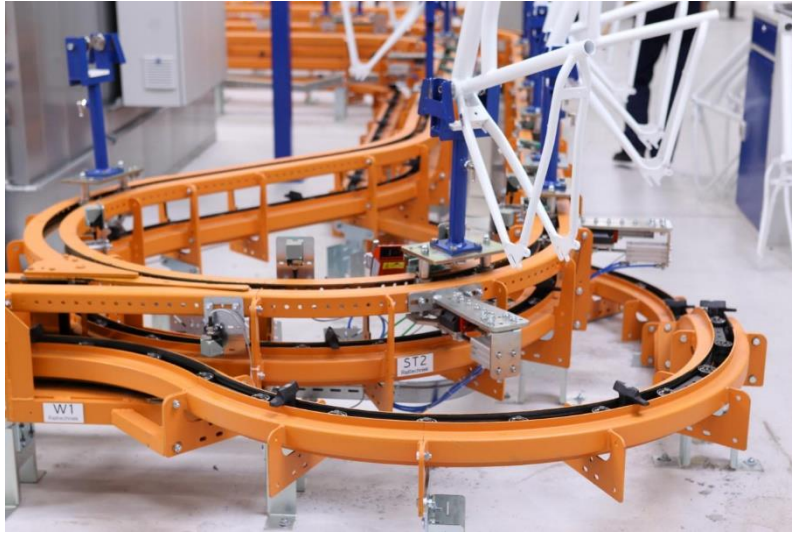

Customer need

Short circuit or overload events can occur resulting in production stoppage. Downtime is costly and therefore fast and easy identification of the problem is critical.



Our Solution

The ICR40 inductive sensors' 4-corner LEDs (2 for power and 2 for status) allow intuitive sensor status monitoring from all positions to indicate if the sensor is operational and target presence. Furthermore, diagnostics allow quick identification of the issue due to yellow status LEDs flashing to indicate a critical event (short circuit or overload.)

Benefits

- Fast and easy troubleshooting to minimize downtime.

APPLICATIONS – FEATURES & BENEFITS

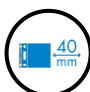
	Customer issue	Our solution – IRC40	Achieved benefits
	Product dimensions/position change in production lines, new configuration is required	Sensing face mountable in 5 directions, thanks to the rotatable head and special mounting bracket	Easily adaptable to several application needs. Less machine downtime and higher efficiency
	Not easy to check the sensor status or ongoing issues such as overload / short-circuit	4-corner LEDs , two at the top and two at the base of the sensor for status/power/overload/short circuit	Clearly visible switching and operating status from any directions. Easy identification and diagnostic
	Sensors are damaged due to periodic high pressure washdown cycles	IP69K certifies an excellent sealing against high pressure and high temperature washing cycles	Reliable detection even with frequent washdown cycles
	Moving parts and mechanical tolerances cause the sensors to be hit by the metal target	Extended sensing distance up to 40 mm allows to position the sensor further away from the moving target	Larger installation tolerances and better protection. Longer life-time and lower downtime

CONCLUSIONS

CONCLUSION

Excellent Performance & Flexible Installation

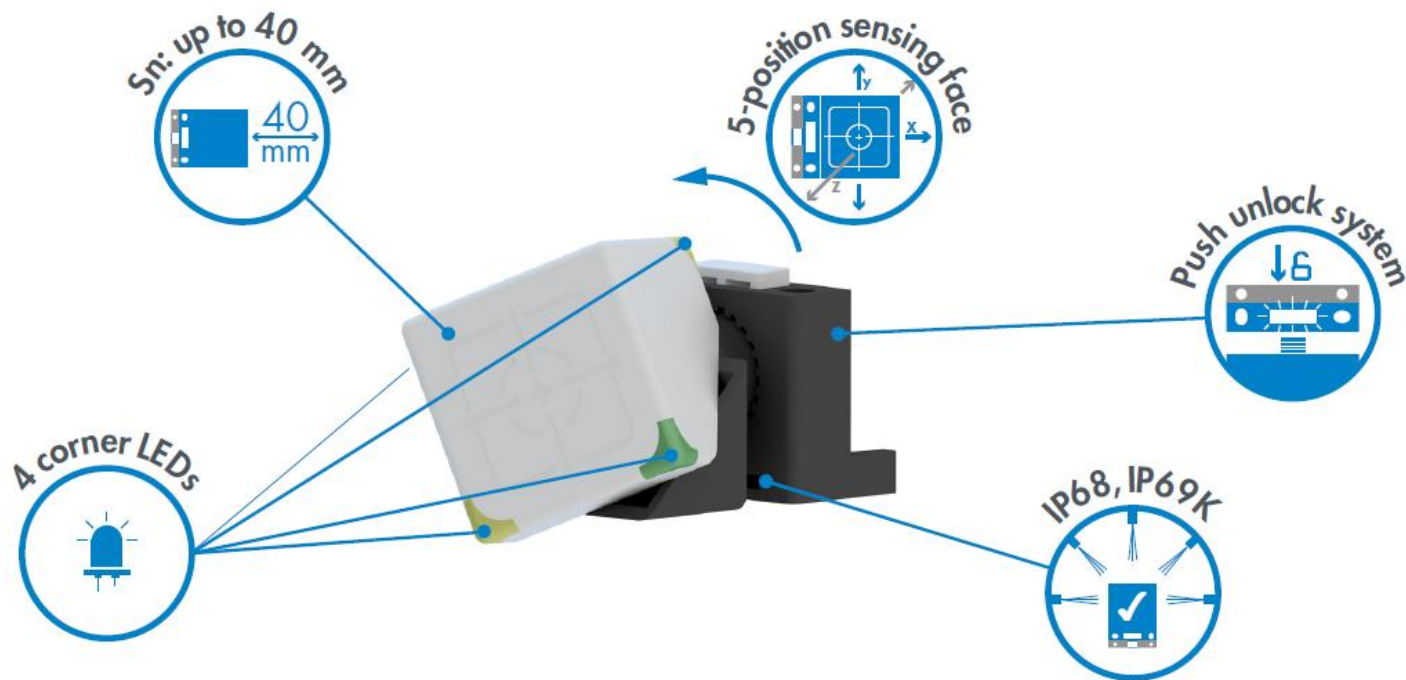



Thank you for your attention!

TECHNICAL INFO

Reduction factor

- The specific operating distance S_n refers to defined measuring conditions
- The following approximate reduction factors must be considered. The operating distance is **reduced by the use of metals and alloys** other than Fe360

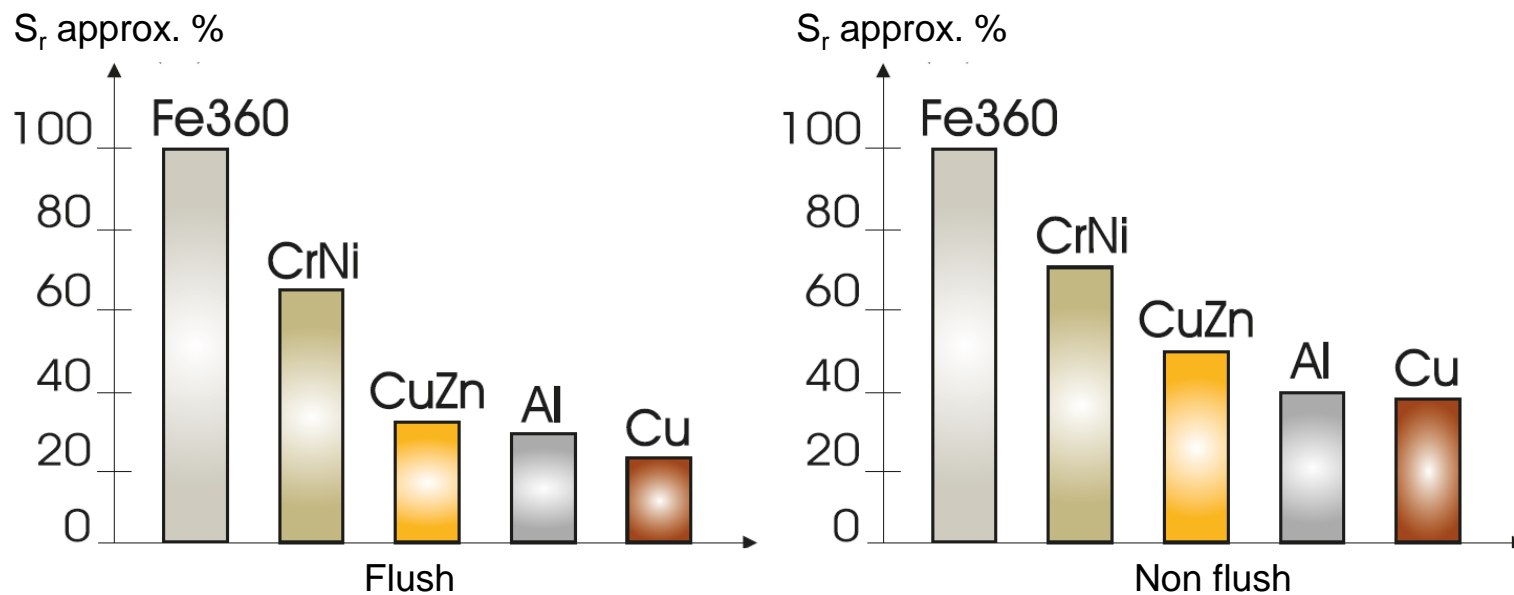

Fe360: Steel; **CrNi:** Chrome(20%)-nickel(80%); **CuZn:** Brass; **Al:** Aluminium; **Cu:** Copper
Sr: Effective operating distance

Drawings – IRC40

Sensors dimensions

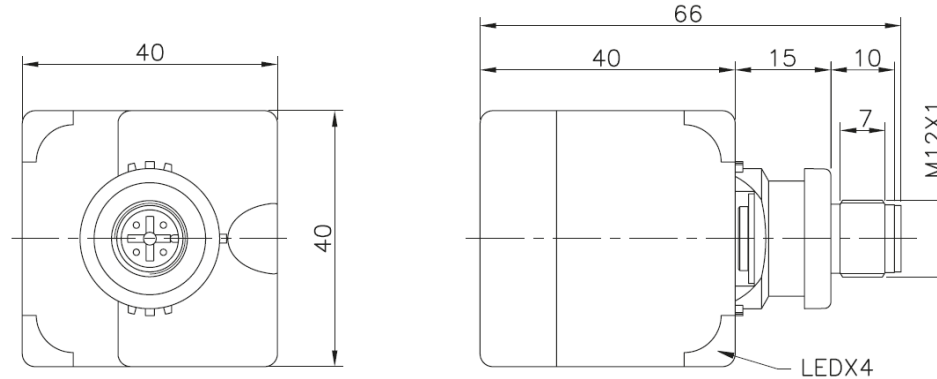

Dimensions with bracket

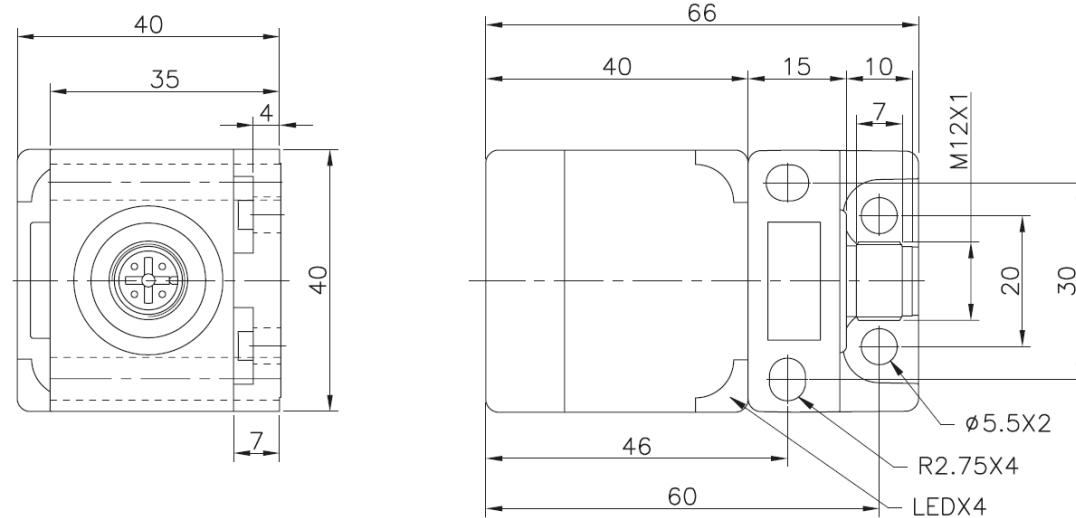

Connection diagrams

NPN, 1NO + 1NC

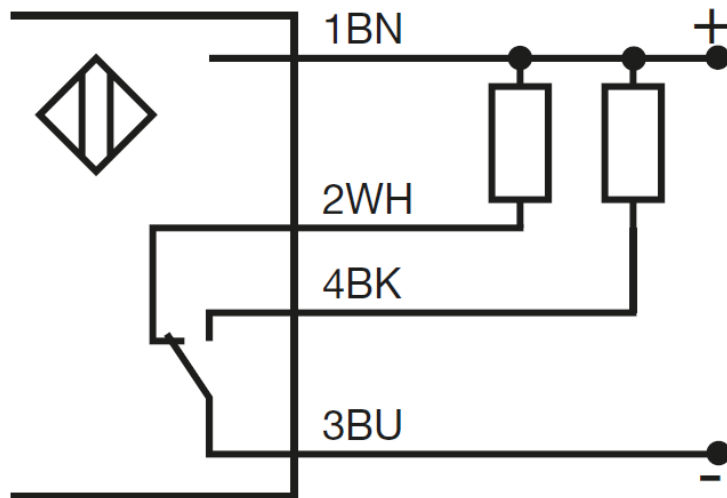

PNP, 1NO + 1NC

