

| PART NUMBER | INSERT<br>COLOR & WIRING | HOUSING FINISH |
|-------------|--------------------------|----------------|
| EHFWX2X     | RED - CROSS WIRED        | NICKEL         |
| EHFWX2BX    | RED - CROSS WIRED        | BLACK CHROME   |

B

INSERT OVERMOLD

FIREWIRE  
CONNECTOR

RETAINING NUT

STANDARD E SERIES HOUSING  
SEE TABLE FOR FINISH

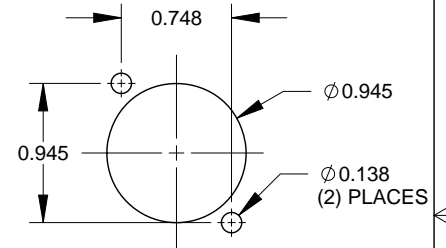
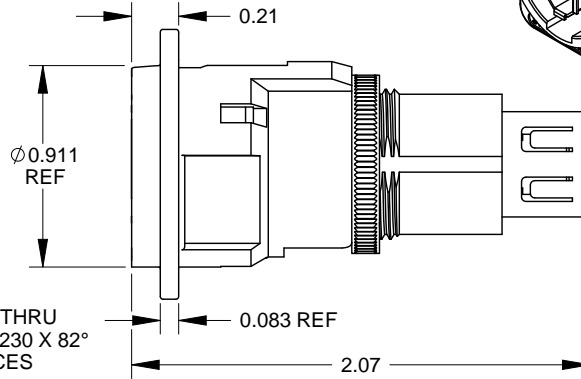
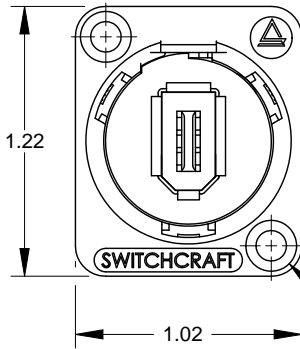

Ø 0.138 THRU  
✓ Ø 0.230 X 82°  
(2) PLACES

#### PIN ASSIGNMENT

EHFWX2X & EHFWX2BX  
CROSS WIRED

|   |   |   |   |   |   |        |
|---|---|---|---|---|---|--------|
| 1 | 2 | 3 | 4 | 5 | 6 | SHIELD |
| 1 | 2 | 5 | 6 | 3 | 4 | SHIELD |

#### NOTES:

- MATERIALS:  
INSERT OVERMOLD - THERMOPLASTIC  
RETAINING NUT - BRASS, NICKEL PLATED  
HOUSING - ZINC ALLOY

RECOMMENDED  
PANEL CUT-OUT

- THIS PRODUCT IS RoHS COMPLIANT.

CUSTOMER DRAWING

| REV | ECO NUMBER | DATE     | BY | APVD |
|-----|------------|----------|----|------|
| B   | 26467      | 11/30/09 | RS | TJK  |
| A   | 26076      | 7/15/06  | RS | TJK  |

REVISIONS

UNLESS OTHERWISE SPECIFIED

1. ALL DIMENSIONS IN INCHES

- TWO PLACE DECIMALS ±0.02

- THREE PLACE DECIMALS ±0.005

DO NOT SCALE DRAWING

SolidWorks CAD File

THIS DRAWING DESCRIBES A DESIGN CONSIDERED PROPRIETARY IN NATURE, DEVELOPED AND MANUFACTURED BY SWITCHCRAFT INC. AND IS RELEASED ON A CONFIDENTIAL BASIS FOR IDENTIFICATION PURPOSES ONLY.

|  |  |          |                      |                |                          |       |              |        |          |
|--|--|----------|----------------------|----------------|--------------------------|-------|--------------|--------|----------|
| SIZE   |  | WIDTH    |                      | MULT           |                          | LBS/M |              | TEMPER |          |
| FINISH<br>SPEC No.                                       |  |          |                      |                | MATERIAL<br>SPEC No.     |       |              |        |          |
| FIRSTUSED ON   |  |          |                      | SCALE<br>1.5:1 |                          |       |              |        |          |
| DATE DRAWN<br>5/5/09                                     |  | BY<br>RS | CHKD<br>RS<br>5/5/09 |                | APVD<br>TJK<br>7/15/09   |       | Switchcraft® |        |          |
| SHEET 1 OF 1   |  |          |                      |                |                          |       |              |        |          |
| NAME<br>E SERIES CONNECTOR<br>FIREWIRE FEEDTHROUGH, RoHS |  |          |                      |                | PARTNo.<br>EHFW_X SERIES |       |              |        | REV<br>B |

# Mouser Electronics

Authorized Distributor

Click to View Pricing, Inventory, Delivery & Lifecycle Information:

[Switchcraft:](#)

[EHFWX2XPKG](#)