

# Han<sup>®</sup> 3A Solutions

*Rugged and Compact Connectivity*



Pushing Performance  
Since 1945

For further information, please reach out to  
[techsupportUS@HARTING.com](mailto:techsupportUS@HARTING.com)

## Insert Range

*Various insert options ranging from 100A to High-Speed Data Connectivity*

*Options in wire termination – crimp, screw, QuickLock<sup>®</sup>, axial screw and IDC*

**100A**  
Single Pole



**40A**  
3+GND



**16A**  
5+GND



**10A**  
12+GND



**6.5A**  
21



**10G**  
Ethernet



**Fiber Optics**



## Hood & Housing Configurations

*Many mounting possibilities for any application*

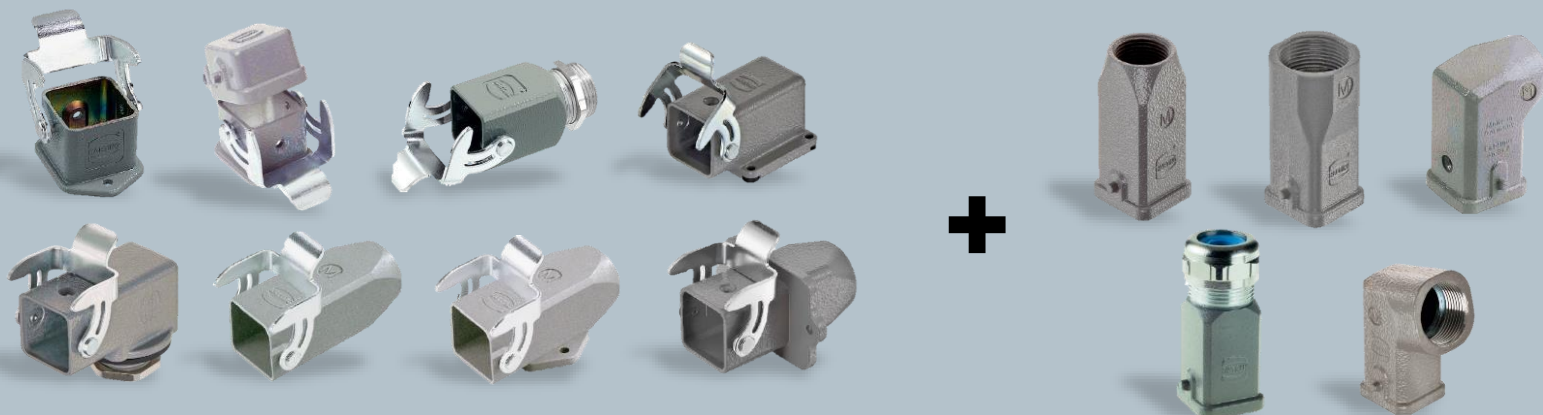

### Housing Range

*Bulkhead Mount, Screw Mount, Inline, Angled, Panel Feed Through*

### Hood Range

*Top Entry, Side Entry*

## Environmental Protection

*Wide selection of hood & housing materials for various degrees of protection*



**Grey Metal**



**HMC**  
*High Mating Cycle*  
*>10,000 Cycles*



**Plastic**



**Marine**  
*For outdoor use*



**EMC**  
*For higher EMC requirements*



**HPR**  
*IP68/69k*  
*For the most rugged environments*



**INOX**  
*Stainless Steel*



**Class 1 Division 2**