



8.4-inch SVGA Color TFT

TCG084SVLRGVNN-AN41

Kyocera's new 8.4-inch diagonal SVGA resolution TFT LCD with low total power consumption provides an ideal solution for portable industrial applications where power consumption is a concern. It features less than 5W total power consumption (Logic+Backlight) with a 1200nits backlight using our higher aperture ratio AWWII technology as well as additional EMI protection built into the design. The total power consumption of this display is lower than any other 8.4" High Bright standard LCD available in the market today by at least 2 watts.



Item	Specification
Resolution / Pixel Configuration	800 x 600
Outline Dimensions (W x H x D mm) (module)	199.5 (W) × 149.0 (H) × 11.5 (D)
Backlight Lifetime (hours)	50,000hrs. (typ.)
Luminance (Cd/m ²)	1200cd/m ² (typ.)
Contrast Ratio (CR>10)	750:1 (typ.)
Electrical Interface	LVDS
Viewing Angle (CR ≥ 10)	H: -85 ~85° ; V: -85~85°
Temperature Range	Operating: -30 ~ 80° C; Storage: -30 ~ 80° C

Note: Specifications are subject to change without notice.

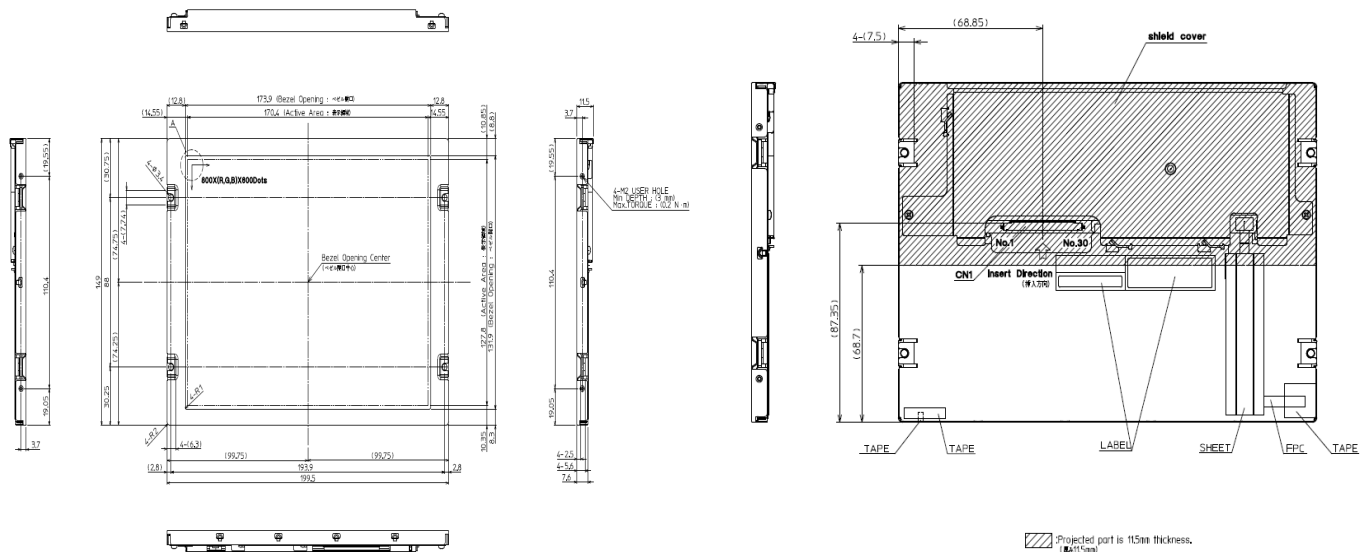

Ask us about our Value-Added Services
Let us add a touchscreen of your choice and more!

For complete specifications call 734-416-8500 or
visit our website at display.kyocera.com