

Edge-mount Brackets Application Specification

1. INTRODUCTION

This specification covers the requirements for application of TE Connectivity Edge-mount Brackets, part numbers 2406230-1 and 2406490-1. The 2406230-1 bracket has been designed to provide mounting for cable diameters up to 15mm. The 2406490-1 bracket has been designed to provide mounting for cable diameters up to 30mm.

Basic terms and features of this product are provided in Figure 1

1. Bracket (Nylon 66)
2. Adhesive bonding area
3. Cable tie slot
4. Bracket locating tab
5. Cable interfacing surface

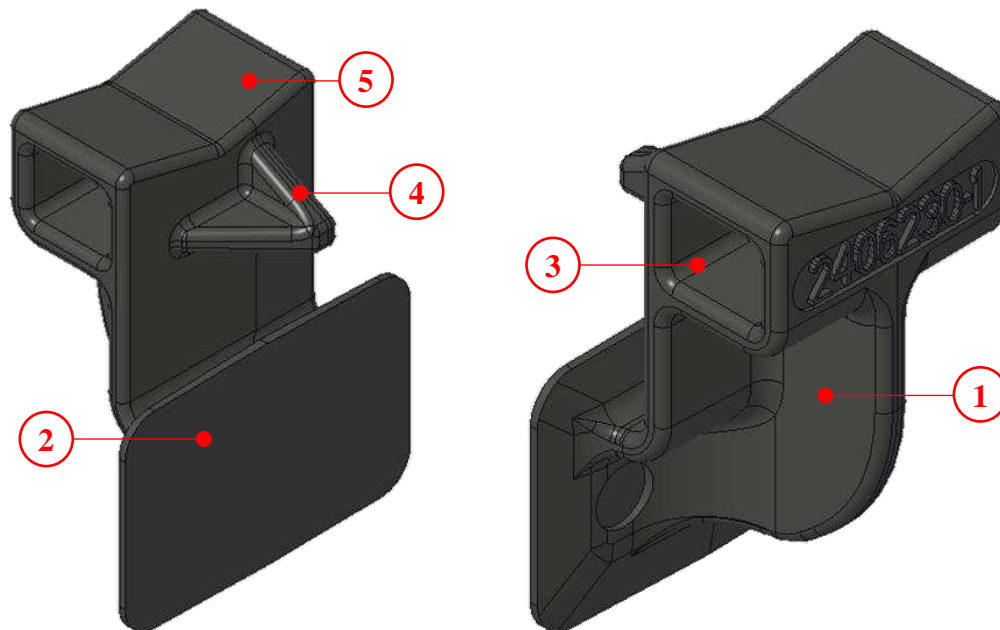

Figure 1 – Edge-mount Bracket Design (P/N 2406230-1)

2. REFERENCE MATERIAL

2.1. Customer Drawings

Customer drawings for product part numbers are available from www.te.com.

Referenced documents form a part of this specification to the extent specified herein. Unless otherwise specified, the latest edition of the document applies. In the event of conflict between the requirements of this specification and the product drawing, the product drawing shall take precedence. In the event of conflict between the requirements of this specification and the referenced documents, this specification shall take precedence.

2.2. Specifications

Product Specification 108-161190 provides product performance and test results.

Tensile strength has been tested in accordance with TE Connectivity Validation Test Plan 109-160319.

TE Connectivity Edge-mount Brackets meet fungus resistance and flammability testing requirements as defined in the product specification 108-161190.

3. REQUIREMENTS

3.1. Operating Temperature Limitations

The product is designed to operate in a temperature range from -55°C to +120°C. Temperatures outside this range shall be validated by the customer.

3.2. Material

See Figure 1.

3.3. Storage

- The products can withstand storage temperatures within the operating temperature range of -55°C to +120°C, but typical ambient warehouse storage temperatures (+15°C to +35°C) are recommended.
- It is recommended that the product remains in the packaging until ready for use.

3.4. Mounting Surfaces

The customer shall provide mounting surfaces as defined in TE Connectivity Installation Instructions, document number 408-160109.

3.5. Mounting Locations

The customer shall select mounting locations as defined in TE Connectivity Installation Instructions, document number 408-160109.

3.6. Adhesive Selection

The customer shall define an adhesive solution as defined in TE Connectivity Installation Instructions, document number 408-160109.



CAUTION To ensure safe operation, the manufacturer's guidelines must be followed when using and discarding the selected adhesive.

3.7. Product Size Selection

Product sizing shall be determined by the customer as defined in TE Connectivity Installation Instructions, document number 408-160109.

3.8. Repair and Replacement

Damaged or defective product shall not be used and should be replaced.

4. VALIDATION

Edge-mount Bracket Validation Testing was performed in accordance with TE Connectivity Validation Test Plan 109-160319 and as reported in TE Connectivity Validation Test Report 501-161236.

5. TOOLING

5.1. Mounting of the Product to the Supporting Structure:

No specific tools are required for mounting of the Edge-mount Bracket to a given structure. Note that, depending on the adhesive selected, fixturing may be required to support the bracket until the adhesive has cured sufficiently. If necessary, fixturing shall be engineered and provided by the customer.

5.2. Installation of Cables (or Similar Objects) to the Product:

A tool can be used, at the discretion of the customer, to tighten the cable tie to a controlled, specified force.