



# ED-VESA-B

## Datasheet

by EDA Technology Co., Ltd

built: 2025-05-30

# ED-VESA-B

VESA Adjustable Wall-mounted Bracket



## Specifications

Mechanical Characteristics	
Material	Aluminum alloy and cold-rolled steel
Color	Black
Weight	About 326g
Max Load Capacity	10kg
VESA Hole Pattern	50mm/75mm/100mm
Clearance From The Wall	85mm
Installation	Wall-mounted

Dimensions



Ordering Code

Model	Description
ED-VESA-B	VESA Adjustable Wall-mounted Bracket for ED-MONITOR

Packing List

- 1 x ED-VESA-B (including 4 x M6\*40 screws, 4 x M6\*40 plastic expansion tubes, 4 x M4\*5 screws, 1 x rivet, 2 x washers and 1 x handle screw)

Installation

Parts List:

NO.	Name	Quantity (PCS)
①	ED-VESA-B	1
②	ED-MONITOR (Not provided)	1

Preparation:

You have acquired the tools, including an electric drill, a pencil, a hammer, a screwdriver, and other equipment.

## Steps:

### 1. Mark the drilling positions:

- Use a pencil to mark the positions of the 4 mounting holes on the wall, based on the screw hole spacing of the bracket Base Plate.

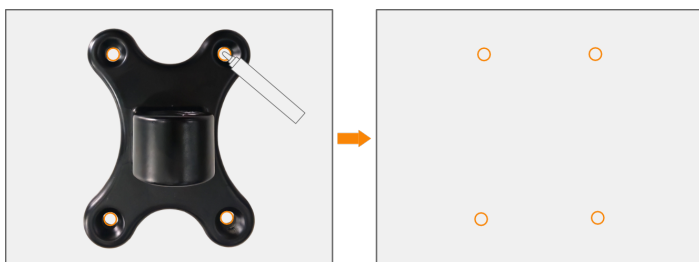

### 2. Drill and install Plastic Expansion Tubes:

- ① Drill 4 holes at the marked positions using an electric drill.
- ② Use a hammer to insert the 4 Plastic Expansion Tubes into the holes.

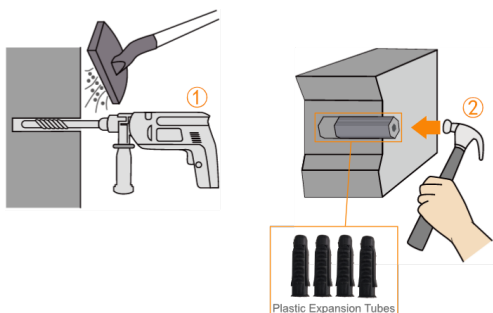

### 3. Secure the Base Plate to the wall:

- ① Align the 4 screw holes on the bracket Base Plate with the installed Plastic Expansion Tubes.
- ② Insert the 4 mounting screws (M6\*40) through the holes and tighten them clockwise with a screwdriver to fix the Base Plate firmly to the wall.



### 4. Attach the bracket Panel to the ED-MONITOR:

- ① Align the 4 screw holes on the bracket Panel with the 4 VESA mounting holes on the back of the ED-MONITOR.
- ② Insert 4 mounting screws (M4\*5) and tighten them clockwise with a screwdriver to secure the Panel to the back of ED-MONITOR.





### TIP

The VESA hole spacing for the ED-MONITOR is 75mm.

#### 5. Fix the bracket Panel to the Base Plate:

- ① Refer to the diagram below for the correct orientation.
- ② Use 1 x rivet, 2 x washers and 1 x handle screw to attach the ED-MONITOR-mounted bracket Panel to the Base Plate installed on the wall.



#### 6. Adjust the viewing angle:

- Rotate the bracket Panel (with the ED-MONITOR attached) left or right to achieve the desired angle.