

Bundling and Securing

Cable Tie Mounts

Screw Mounting Bases

Cable Tie Mounts

Designed specifically for holding heavier cable bundles these mounting bases can be used in many industries from agriculture to truck manufacture. They offer a very secure fixing and can be used with a wide variety of heavy duty cable ties up to 8.3 mm width.

Features and Benefits

- The CTM series is designed to provide stability to wire bundles.
- These mounts can accommodate miniature, intermediate, or standard cross-section cable ties.
- Each mount is secured with a single screw.

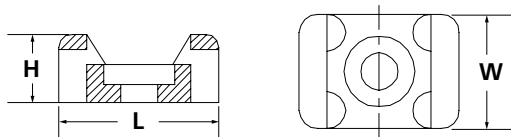

PART NO.	TYPE	Cable Tie Series	Mounting Screw Type	Length (L) in. (mm)	Width (W) in. (mm)	Height (H) in. (mm)	Material	Color	Pkg. Qty.
CTM010M4*	CTM0	T18 - T50	#6 (M3) Screw	0.6 (14.7)	0.4 (9.4)	0.3 (6.9)	PA66	White	1000
CTM00C2*		T18 - T50	#6 (M3) Screw	0.6 (14.7)	0.4 (9.4)	0.3 (6.9)	PA66	Black	100
CTM00M4*		T18 - T50	#6 (M3) Screw	0.6 (14.7)	0.4 (9.4)	0.3 (6.9)	PA66	Black	1000
CTM010C2*		T18 - T50	#6 (M3) Screw	0.6 (14.7)	0.4 (9.4)	0.3 (6.9)	PA66	White	100
CTM10C2*	CTM1	T18 - T50	#8 (M4) Screw	0.6 (14.7)	0.4 (9.4)	0.3 (6.9)	PA66	Black	100
CTM10M4*		T18 - T50	#8 (M4) Screw	0.6 (14.7)	0.4 (9.4)	0.3 (6.9)	PA66	Black	1000
CTM110C2*		T18 - T50	#8 (M4) Screw	0.6 (14.7)	0.4 (9.4)	0.3 (6.9)	PA66	White	100
CTM110M4*		T18 - T50	#8 (M4) Screw	0.6 (14.7)	0.4 (9.4)	0.3 (6.9)	PA66	White	1000
CTM20C2*	CTM2	T18 - T120	#8 (M4) Screw	0.9 (21.8)	0.6 (15.5)	0.4 (9.4)	PA66	Black	100
CTM20M4*		T18 - T120	#8 (M4) Screw	0.9 (21.8)	0.6 (15.5)	0.4 (9.4)	PA66	Black	1000
CTM210C2*		T18 - T120	#8 (M4) Screw	0.9 (21.8)	0.6 (15.5)	0.4 (9.4)	PA66	White	100
CTM210M4*		T18 - T120	#8 (M4) Screw	0.9 (21.8)	0.6 (15.5)	0.4 (9.4)	PA66	White	1000

Dimensions are approximate and subject to technical changes. Use Part No. for ordering and Type for specification purposes.

*This product meets UL standards. Please see appendix for specific file numbers.



Please note! Not all products listed on this page may have this approval. Please check our website for latest approvals.

Screw Mounting Bases

Cable Tie Mounts

PART NO.	TYPE	Cable Tie Series	Mounting Screw Type	Length (L) in. (mm)	Width (W) in. (mm)	Height (H) in. (mm)	Material	Color	Pkg. Qty.
CTM30C2*	CTM3	T18 - T120	#10 (M5) Screw	0.9 (21.8)	0.6 (15.5)	0.4 (9.4)	PA66	Black	100
CTM30M4*		T18 - T120	#10 (M5) Screw	0.9 (21.8)	0.6 (15.5)	0.4 (9.4)	PA66	Black	1000
CTM310C2*		T18 - T120	#10 (M5) Screw	0.9 (21.8)	0.6 (15.5)	0.4 (9.4)	PA66	White	100
CTM310M4*		T18 - T120	#10 (M5) Screw	0.9 (21.8)	0.6 (15.5)	0.4 (9.4)	PA66	White	1000
CTM40C2*	CTM4	T18 - T120	1/4" (M6) Screw	0.9 (21.8)	0.6 (15.8)	0.4 (9.4)	PA66	Black	100
CTM40M4*		T18 - T120	1/4" (M6) Screw	0.9 (21.8)	0.6 (15.8)	0.4 (9.4)	PA66	Black	1000
CTM410C2*		T18 - T120	1/4" (M6) Screw	0.9 (21.8)	0.6 (15.8)	0.4 (9.4)	PA66	White	100
CTM410M4*		T18 - T120	1/4" (M6) Screw	0.9 (21.8)	0.6 (15.8)	0.4 (9.4)	PA66	White	1000
151-00950	MCKR6G5	MCTS series	M4	0.7 (17.8)	0.5 (11.8)	0.4 (8.8)	PA66MP+	Blue	100
151-01020	MCKR8G5-5	MCTS series	M5	1.0 (24.8)	0.4 (14.3)	0.5 (12.0)	PA66MP+	Blue	100

Dimensions are approximate and subject to technical changes. Use Part No. for ordering and Type for specification purposes.

*This product meets UL standards. Please see appendix for specific file numbers.