

# 12, 24 & 48 Volt Solutions

## SELECTOR GUIDE

### APPLICATIONS:

- 48V electrical centers
- Power distribution boxes
- Start-stop systems
- E-turbo
- Battery
- Active suspension
- BSG units
- High current harness and devices
- Sealed pass-through panel mount systems



<b>Application</b>	48V electrical centers, Power distribution boxes, Start-stop systems, E-turbo, Battery, Active suspension, BSG units
<b>Description</b>	SEALED RING CONNECTOR
<b>Amperage at 85°C</b>	250 A
<b>Voltage</b>	12 - 48 V
<b>Orientation</b>	90°
<b># of Ways</b>	1
<b>Shielding</b>	No
<b>Vibration Class</b>	V3
<b>Temperature Class</b>	T4
<b>Sections</b>	35 mm <sup>2</sup> 50 mm <sup>2</sup>
<b>See Page</b>	<b>60-61</b>



		
High current harnesses and devices, Sealed pass-through panel mount systems		
1 WAY INLINE CONNECTORS	2 WAY INLINE CONNECTORS	2 WAY DEVICE CONNECTOR with straight and right angle Exit
145 A		
12 - 48 V		
180°	180°	90° & 180°
1 & 2		
No		
V1		
T3		
8 - 25 mm <sup>2</sup>		
62-63		

# 48V SEALED RING CONNECTOR



## BENEFITS

- Fast and easy assembly process
- High robustness against vibrations
- High current carrying capabilities

## FEATURES

- Ideal solution for 12 to 48V requiring sealed ring connections
- Can be screwed from the top
- Header interface available for system supplier integration on the box
- M8 ring terminal bolted to device

## APPLICATIONS

48V electrical centers  
Power distribution boxes  
Start-stop systems  
E-turbo  
Battery  
Active suspension  
BSG units

## AVAILABLE CONFIGURATIONS

Connector Type	Wire-to-device
Cable Exit Orientation	90°
Cable Range (mm <sup>2</sup> )	35, 50
Terminal Type	M8 ring terminal
# of Power Terminals	1
Shielding Type	Unshielded
HVIL	None
Assembly Assurance	None
Number of Indexes	1

## PERFORMANCE

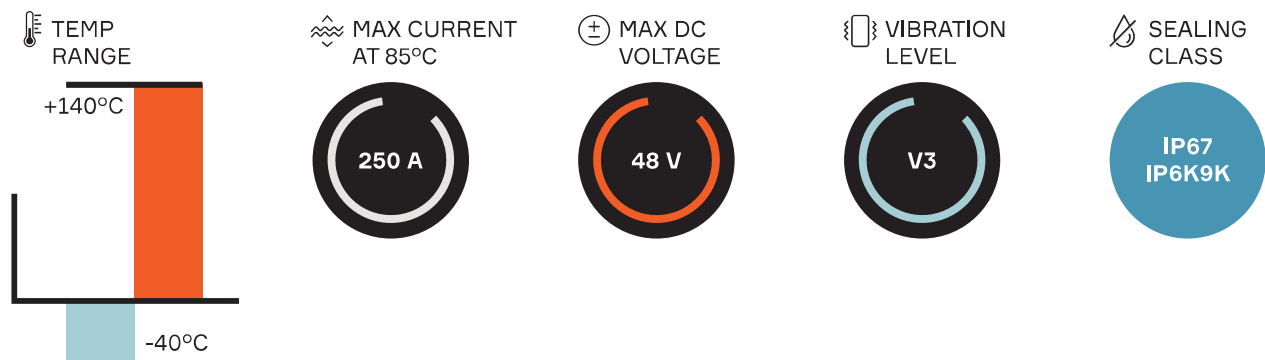

Mating connector	Header connector	BOM
33376962	Please contact you Aptiv representative for more information	1

ASSOCIATED PARTS

Part number	Type	Applicable wire size (mm²)	Cable type	BOM
33376821	Single wire seal retainer	35 - 50	-	1
33329995	M8 O-ring terminal	35 - 50	-	1
35093138	Single wire seal	35	Unshielded	1

DIMENSION MEASUREMENT SAMPLE

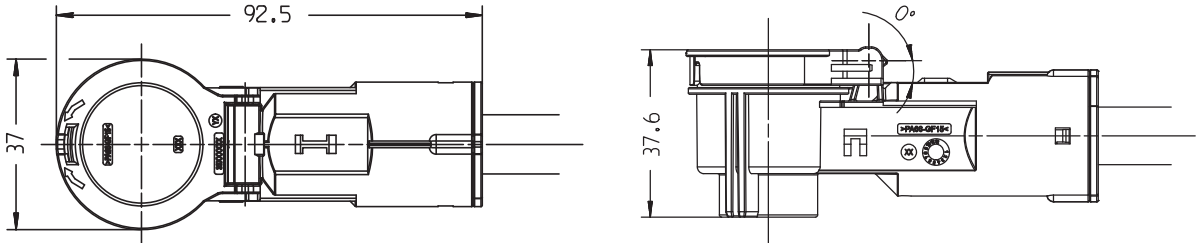

33376962

# POWER PACK 1000



1 Way Inline  
Connectors



2 Way Inline  
Connectors



2 Way Device and  
Pass-Through Connectors

## BENEFITS

- High current carrying capacity
- Proven terminal system
- Compact system design
- Field proven in both automotive and heavy duty applications

## FEATURES

- Silver-plated multi-contact terminal system
- Sealed panel mount pre-stages prior to fastening
- Panel mount secured in place with self-tapping screws
- Pass-through connection accepts both straight and right angle connectors

## AVAILABLE CONFIGURATIONS

Connector Type	Wire-to-device, wire-to-wire, pass-through
Cable Exit Orientation	180°, 90°
Cable Range (mm <sup>2</sup> )	8 - 25
Terminal Type	Power Pack 1000
# of Power Terminals	1 or 2
Shielding Type	Unshielded
HVIL	None
Assembly Assurance	None
Number of Indexes	2

## APPLICATIONS

High current harnesses and devices

Sealed pass-through panel mount systems

## PERFORMANCE

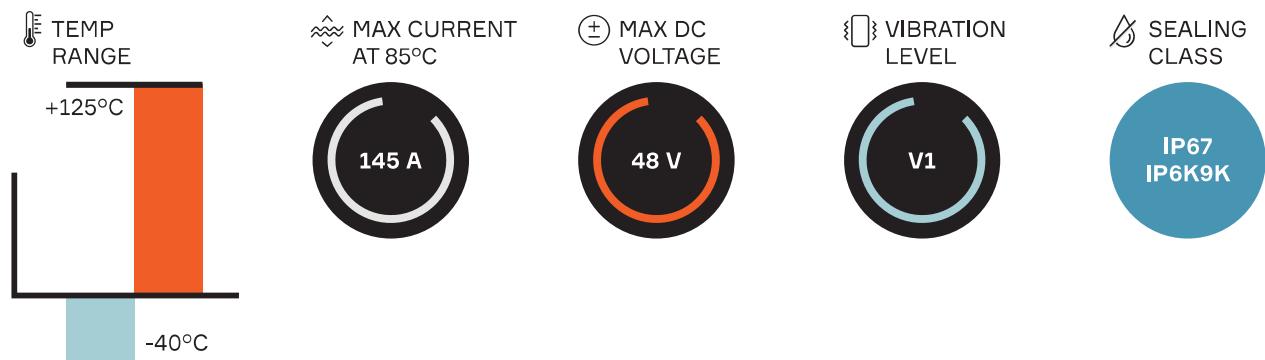

**1 Way Inline Connectors**

Header connector	Mating connector	BOM
13882980	13952702	1

**2 Way Inline Connectors**

Index	Header connector	Mating connector	BOM
103	13849747	13849756	1
104	13849748	13849757	

**2 Way Device and Pass-Through Connectors**

Index	Header connector	Mating connector		BOM
		180°	90°	
103	13959824	13849756	13849758	1

**ASSOCIATED PARTS**

Part number	Description	BOM
Header / Male inline		
13675577	PP1000 silver-plated 8 - 10 mm²	1
13675579	PP1000 silver-plated 19 - 25 mm²	
Mating connector		
13675583	PP1000 silver-plated 8 - 10 mm²	1
13675585	PP1000 silver-plated 19 - 25 mm²	
Seals and Retainers*		
13675510	Cable seal PP1000 4.54 - 5.79 dia cable (grey) 8 - 10 mm²	1
13675513	Cable seal PP1000 1.01 - 9.19 dia cable (blue) 19 - 25 mm²	
13849785	Cable seal retainer PP1000 8 - 10 mm²	1
13849788	Cable seal retainer PP1000 19 - 25 mm²	

\* For both header, male inline + mating connector

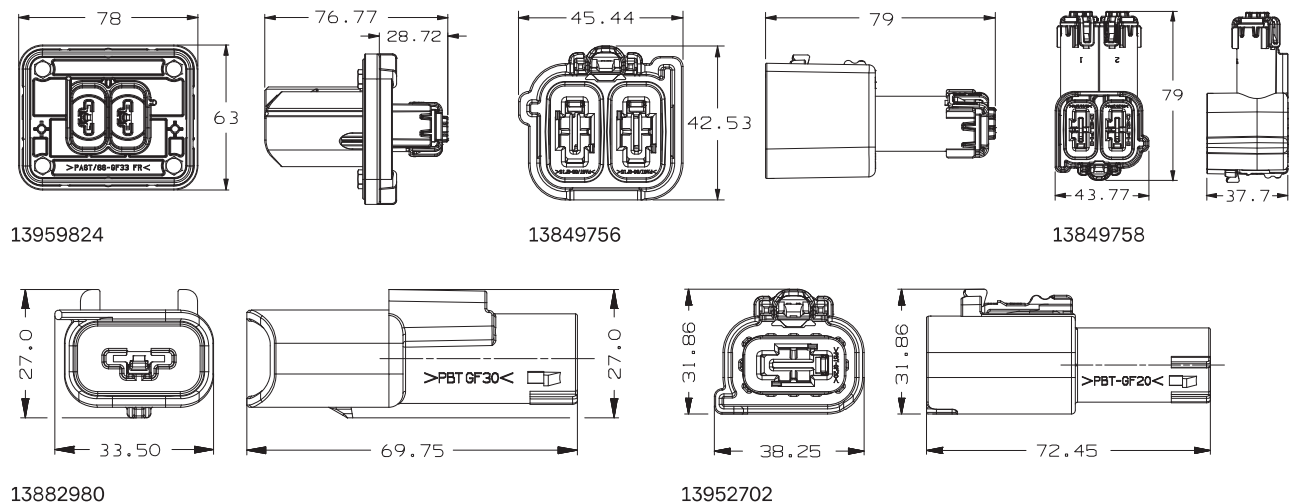
**DIMENSION MEASUREMENT SAMPLE**

Part numbers, specifications, dimensions and performance data in this document are for general references only and are subject to change without notice. To verify product information, please contact an Aptiv representative.