

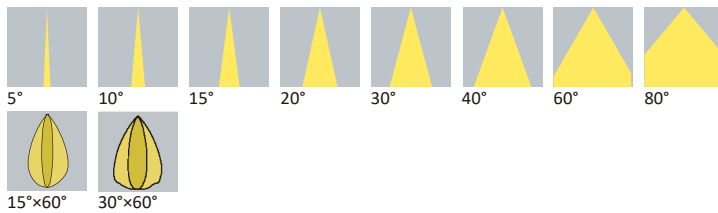

Datasheet

AHA Series

Available Distribution



LED

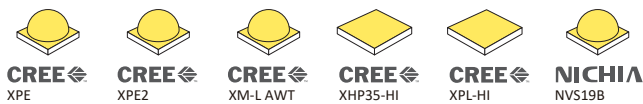

Recommend Applications



General Information

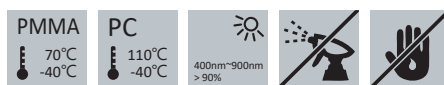

- Lens Material: PMMA / PC
- Lens Color: Transparent
- Operating Temperature: PMMA: -40°C~+70°C / PC: -40°C~+110°C
- Light Transmission Rate: 400nm~900nm > 90%
- ☑ If necessary, Clean lenses with mild soap, water and soft cloth.
- ⚠ Never use any commercial cleaning solvents on lenses, like alcohol.
- 🧤 Please handle or install lenses with wearing gloves, skin oils may damage lens or its optical characteristic.

Dimensions

Part Number	Diameter	Height
LL01ZZ-AHA05L06-M2-T	Ø52	27
LL01ZZ-AHA10L06-M2-T		
LL01ZZ-AHA05L06-M2-T + LL01ZZ-DCKxxL52		

*All dimensions are in millimeters.

Packaging Details (SPQ)

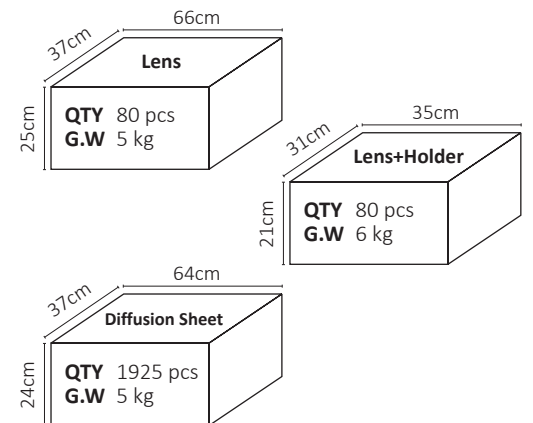

Accessories



- Available with Holder: LL01CRRN05H2
- Available with Diffusion Sheet: LL01ZZ-DCKxxL52
- Available with Tape: LL01A33AXVXX

Mechanical Specification

*All dimensions are in millimeters.

Lens Dimension

LL01ZZ-AHA××L06

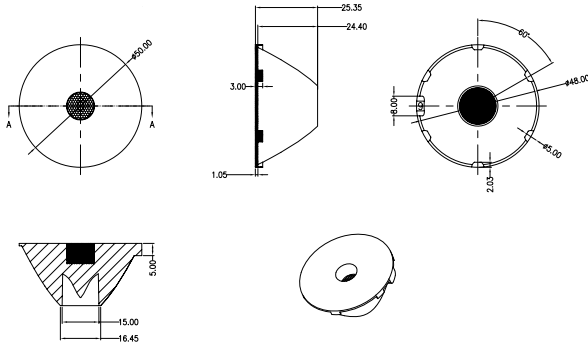

Holder Dimension

LL01CRRN05H2

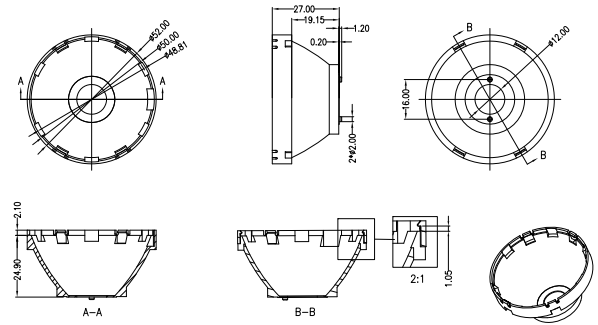

Tape Dimension

LL01A33AXVXX

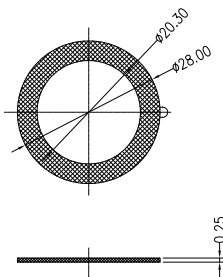

Assembly Instruction

Part No LL01ZZ-AHA××L06-M2-T
Holder LL01CRRN05H2
Tape LL01A33AXVXX

Fixing Method

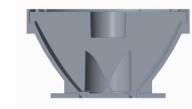
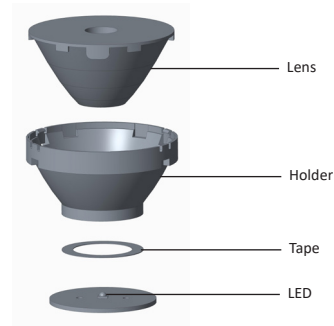

Diffusion Sheet Dimension

LL01ZZ-DCK××L52

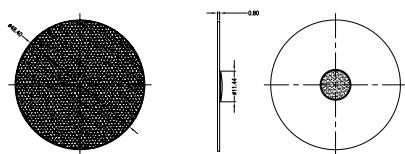

Assembly Instruction

Part No LL01ZZ-AHA05L06-M2-T
+ LL01ZZ-DCK××L52
Holder LL01CRRN05H2
Diffusion Sheet LL01ZZ-DCK××L52
Tape LL01A33AXVXX

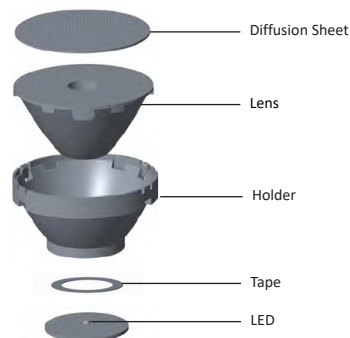

Fixing Method



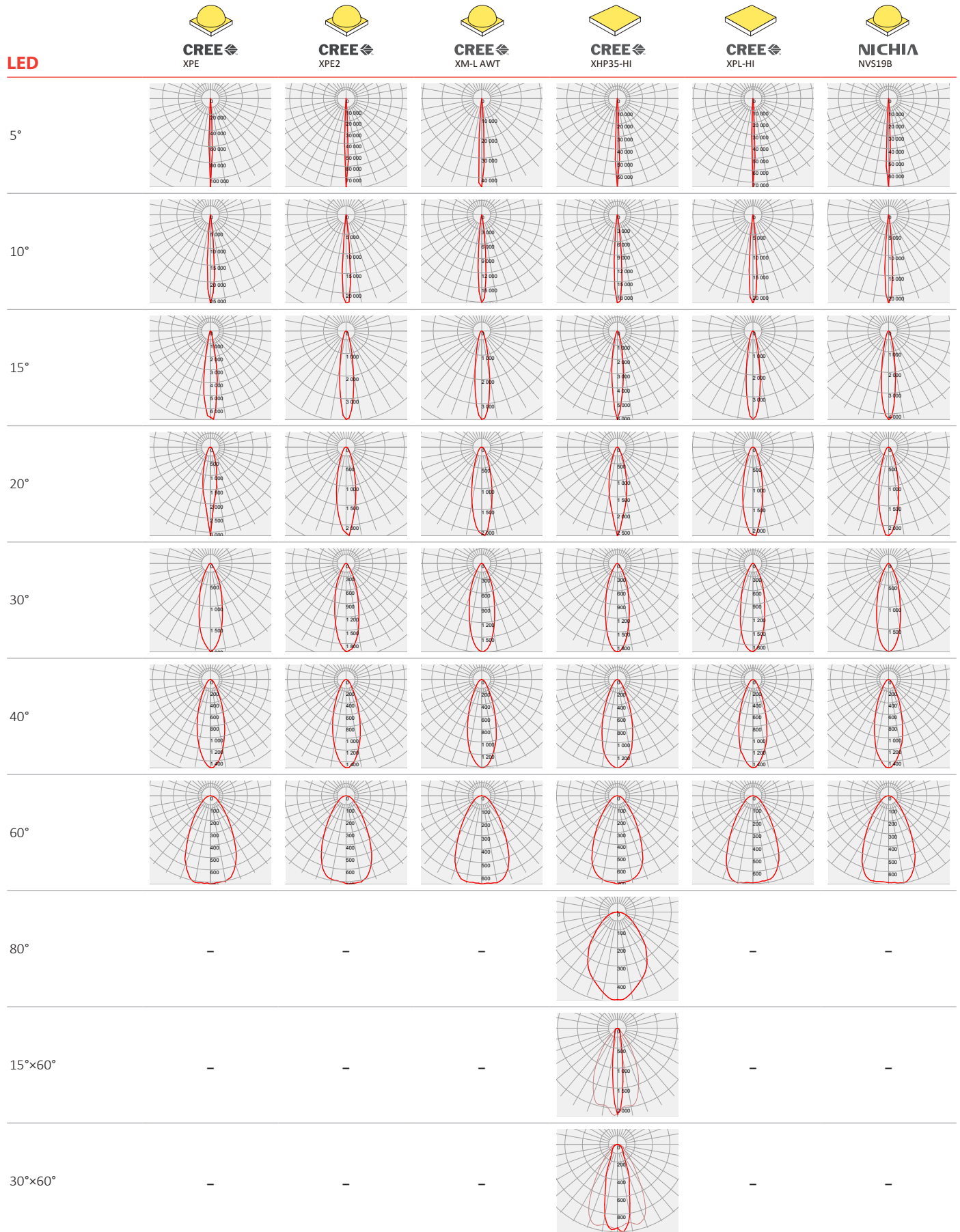



Photometric Distribution

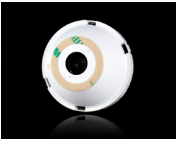
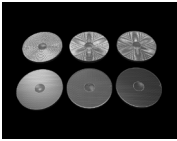

















Details by LED

Part No	Holder	Tape	Diffusion Sheet	LED Package Size
LL01ZZ-AHAxxL06-M2-T	 LL01CRRN05H2	 LL01A33AXVXX	-	3535 / 5050
LL01ZZ-AHA05L06-M2-T + LL01ZZ-DCKxxL52	 LL01CRRN05H2	 LL01A33AXVXX	 LL01ZZ-DCKxxL52	

LED	Part No	FWHM	cd/lm	IES
	LL01ZZ-AHA05L06-M2-T	4°	110.5	↓
	LL01ZZ-AHA05L06-M2-T + LL01ZZ-DCK10L52	9°	26.3	↓
	LL01ZZ-AHA05L06-M2-T + LL01ZZ-DCK15L52	17°	6.8	↓
	LL01ZZ-AHA05L06-M2-T + LL01ZZ-DCK20L52	16°	3.1	↓
	LL01ZZ-AHA05L06-M2-T + LL01ZZ-DCK30L52	30°	2.0	↓
	LL01ZZ-AHA05L06-M2-T + LL01ZZ-DCK40L52	35°	1.5	↓
	LL01ZZ-AHA05L06-M2-T + LL01ZZ-DCK60L52	59°	0.7	↓
	LL01ZZ-AHA05L06-M2-T	4°	78.2	↓
	LL01ZZ-AHA05L06-M2-T + LL01ZZ-DCK10L52	9°	22.5	↓
	LL01ZZ-AHA05L06-M2-T + LL01ZZ-DCK15L52	18°	3.9	↓
	LL01ZZ-AHA05L06-M2-T + LL01ZZ-DCK20L52	25°	2.2	↓
	LL01ZZ-AHA05L06-M2-T + LL01ZZ-DCK30L52	31°	1.9	↓
	LL01ZZ-AHA05L06-M2-T + LL01ZZ-DCK40L52	36°	1.5	↓
	LL01ZZ-AHA05L06-M2-T + LL01ZZ-DCK60L52	60°	0.7	↓

LED	Part No	FWHM	cd/lm	IES
	LL01ZZ-AHA05L06-M2-T	6°	44.6	↓
	LL01ZZ-AHA05L06-M2-T + LL01ZZ-DCK10L52	10°	18.2	↓
	LL01ZZ-AHA05L06-M2-T + LL01ZZ-DCK15L52	19°	3.6	↓
	LL01ZZ-AHA05L06-M2-T + LL01ZZ-DCK20L52	26°	2.1	↓
	LL01ZZ-AHA05L06-M2-T + LL01ZZ-DCK30L52	33°	1.7	↓
	LL01ZZ-AHA05L06-M2-T + LL01ZZ-DCK40L52	37°	1.4	↓
	LL01ZZ-AHA05L06-M2-T + LL01ZZ-DCK60L52	62°	0.6	↓
	LL01ZZ-AHA05L06-M2-T	5°	70.0	↓
	LL01ZZ-AHA05L06-M2-T + LL01ZZ-DCK10L52	9°	19.7	↓
	LL01ZZ-AHA05L06-M2-T + LL01ZZ-DCK15L52	15°	6.2	↓
	LL01ZZ-AHA05L06-M2-T + LL01ZZ-DCK20L52	23°	2.6	↓
	LL01ZZ-AHA05L06-M2-T + LL01ZZ-DCK30L52	31°	1.9	↓
	LL01ZZ-AHA05L06-M2-T + LL01ZZ-DCK40L52	39°	1.4	↓
	LL01ZZ-AHA05L06-M2-T + LL01ZZ-DCK60L52	60°	0.7	↓
	LL01ZZ-AHA05L06-M2-T + LL01ZZ-DCK80L52	79°	0.4	↓
	LL01ZZ-AHA05L06-M2-T + LL01ZZ-DCK1560L52	14°x56°	2.2	↓
	LL01ZZ-AHA05L06-M2-T + LL01ZZ-DCK3060L52	31°x63°	1.0	↓

LED	Part No	FWHM	cd/lm	IES
	LL01ZZ-AHA05L06-M2-T	4°	73.9	
	LL01ZZ-AHA05L06-M2-T + LL01ZZ-DCK10L52	9°	22.0	
	LL01ZZ-AHA05L06-M2-T + LL01ZZ-DCK15L52	18°	4.0	
	LL01ZZ-AHA05L06-M2-T + LL01ZZ-DCK20L52	26°	2.1	
	LL01ZZ-AHA05L06-M2-T + LL01ZZ-DCK30L52	31°	1.9	
	LL01ZZ-AHA05L06-M2-T + LL01ZZ-DCK40L52	36°	1.5	
	LL01ZZ-AHA05L06-M2-T + LL01ZZ-DCK60L52	60°	0.7	
	LL01ZZ-AHA05L06-M2-T	5°	70.5	
	LL01ZZ-AHA10L06-M2-T	7°	32.6	
	LL01ZZ-AHA05L06-M2-T + LL01ZZ-DCK10L52	9°	21.7	
	LL01ZZ-AHA05L06-M2-T + LL01ZZ-DCK15L52	18°	4.2	
	LL01ZZ-AHA05L06-M2-T + LL01ZZ-DCK20L52	26°	2.2	
	LL01ZZ-AHA05L06-M2-T + LL01ZZ-DCK30L52	30°	2.0	
	LL01ZZ-AHA05L06-M2-T + LL01ZZ-DCK40L52	36°	1.5	
	LL01ZZ-AHA05L06-M2-T + LL01ZZ-DCK60L52	61°	0.6	

Product Nomenclature

Ledlink Led Type Lens Angle Holder Diffusion Sheet Angle

LL 01 ZZ -AHA 05 L06 -M2 -T + LL01ZZ-DCK10L52

Lens Dot Number Serial Number Type of Material Tape

Ledlink Optics, Inc

Taiwan HQ

15F, No.655, Bannan Rd., Chung-Ho Dist.,
New Taipei City, Taiwan 235

Ledlink Optics (Dongguan) Co., Ltd

Dongguan Factory

No.6, Gaoxin Road, Tiankeng, Hengli Town, Dongguan City,
Guangdong Province, China 523478

Ledlink Optics (Yangzhou) Co., Ltd

Yangzhou Factory

No.180, LinJiang Rd., Yangzhou City, Jiangsu Province, China 225009

www.ledlink-optics.com

service@ledlink-optics.com

