

FBC PA M12 FM 25M

Weidmüller Interface GmbH & Co. KG

Klingenbergstraße 26

D-32758 Detmold

Germany

www.weidmueller.com

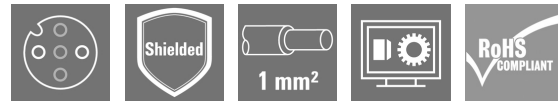

The most reliable way of achieving connections between two I/O slaves or between the control and one I/O subscriber is by way of pre-assembled cables. The line of cables covers PROFIBUS, CANopen, DeviceNet™, EtherCAT and Ethernet.

General ordering data

Version	Bus line, One end without connector, M12, Number of poles: 2, 25 m, Female socket, straight, Shielded: Yes, LED: No, Sheath material: PVC, Halogen: Yes
Order No.	1785112500
Type	FBC PA M12 FM 25M
GTIN (EAN)	4032248645985
Qty.	1 pc(s).

Creation date June 13, 2025 8:09:12 PM CEST

Catalogue status 07.06.2025 / We reserve the right to make technical changes.

FBC PA M12 FM 25M

Weidmüller Interface GmbH & Co. KG

Klingenbergstraße 26

D-32758 Detmold

Germany

www.weidmueller.com

Technical data

Dimensions and weights

Net weight 1,956 g

Technical specifications for cable

Bending radius, min., moving	8 x cable diameter	Bending radius, min., stationary	8 x cable diameter
Cable length	25 m	Colour coding	red, green
Configurable cable length	No	Core cross-section	1 mm ²
Halogen	Yes	Hybrid cable	No
Insulation	PE	Irradiation crosslinked	No
Number of poles	2	Outside diameter	8 mm ± 0.4 mm
Resistant to welding beads	No	Sheath material	PVC
Sheathing colour	black	Shielded	Yes
Suitable for cable carriers	No	Temperature range, moving	-5...60 °C
Temperature range, stationary	-30...80 °C	Welding spark resistance	No

General technical data

Coding	A-coded	Connection thread	M12
Contact material	Ni/Au	Contact surface	Gold-plated
Housing main material	PUR	Insulation strength	10 ⁸ Ω
LED	No	Plugging cycles	≥ 100
Pollution severity	3	Protection degree	IP67
Rated voltage	100 V	Temperature range of housing	-25...+80 °C
Threaded ring material	Brass, nickel-plated	Tightening torque	M12: 0.8 - 1.2 Nm
Version	Female socket, straight	jumpered	No

Electrical properties

Insulation strength 10⁸ Ω Rated voltage 100 V

Plug, left

Plug left M12, A-coded, IP67, female contact, straight, Plastic, shielded

Plug, right

Plug right free conductor end

Classifications

ETIM 6.0	EC002599	ETIM 7.0	EC002599
ETIM 8.0	EC002599	ETIM 9.0	EC002599
ETIM 10.0	EC002599	ECLASS 9.0	27-06-03-08
ECLASS 9.1	27-06-03-08	ECLASS 10.0	27-06-03-08
ECLASS 11.0	27-06-03-08	ECLASS 12.0	27-06-03-08
ECLASS 13.0	27-06-03-08	ECLASS 14.0	27-06-03-08
ECLASS 15.0	27-06-03-08		

FBC PA M12 FM 25M

Weidmüller Interface GmbH & Co. KG
Klingenbergstraße 26
D-32758 Detmold
Germany

www.weidmueller.com

Technical data

Environmental Product Compliance

RoHS Compliance Status	Compliant with exemption
RoHS Exemption (if applicable/known)	6c
REACH SVHC	Lead 7439-92-1 Imidazolidine-2-thione 96-45-7
SCIP	be1e0a9b-b31e-4729-85aa-0ec2ffffea4

Approvals

Approvals



Approvals MAMID	https://mdcop.weidmueller.com/mediadelivery/rendition/900_319222/-T1z1mm-S800/
ROHS	Conform

Downloads

Engineering Data	CAD data – STEP
Catalogues	Catalogues in PDF-format
Brochures	FL FIELDWIRING EN

FBC PA M12 FM 25M

Weidmüller Interface GmbH & Co. KG
Klingenbergstraße 26
D-32758 Detmold
Germany

www.weidmueller.com

Drawings

Pole scheme

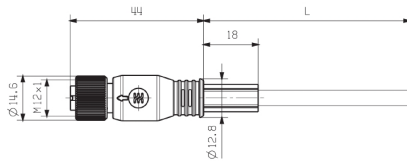

Straight socket

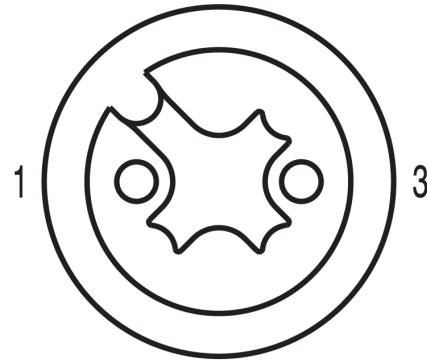

Socket

Wiring diagram

The ideal tool: Screwty® with torque function



Light, securely screwed-in round plug-in connectors. Screwty set DM / VPE: 1 / Order No.: 1920000000 Adapters: M12, M12 F, M8, M8 F