

MMCX7-J-P-GF-RA-TH1



MMCX7-J-P-GF-ST-TH1



MMCX7-P-P-GF-ST-TH1

MMCX7 SERIES

75 Ω MICRO-MINI SYSTEMS

SPECIFICATIONS

For complete specifications and recommended PCB layouts see www.samtec.com?MMCX7-TH

Shell Material:

Brass

Insulator Material:

PTFE

Contact Material:

BeCu

Pin Material:

Brass

Operating Temp Range:

-65 °C to +125 °C

Impedance:

75 Ω

Dielectric Withstanding Voltage:

500 Vrms, 50 Hz

Dielectric Working Voltage:

170 Vrms, 50 Hz

Frequency Range:

0~6 GHz

RoHS Compliant:

Yes

PROCESSING

Lead-Free Solderable:

Yes

MMCX7

GENDER

TYPE

PLATING

ORIENTATION

TERMINATION

Mates with:

MMCX7-P, RF179,
GRF7H-C

-J

= Jack

-P

= PCB Mount

-GF

= 10 μ "
(0.25 μ m) Gold center contact,
3 μ "
(0.08 μ m) Gold outer contact

-RA

= Right-angle

-ST

= Straight

-TH1

= Through-hole

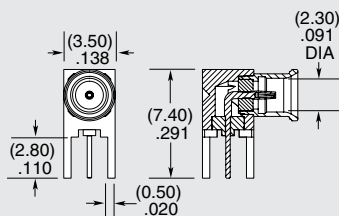

-RA

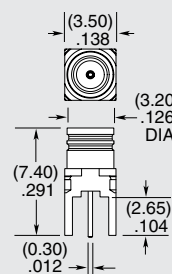

-ST

OTHER SOLUTIONS

- 75 Ω Cable Components available Contact Samtec.

MMCX7

GENDER

TYPE

PLATING

ST

TH1

Mates with:

MMCX7-J, RF179,
GRF7H-C

-P

= Plug

-P

= PCB Mount

-GF

= 10 μ " (0.25 μ m) Gold center contact,
3 μ " (0.08 μ m) Gold outer contact

