

LOW PROFILE AND ELEVATED ONE-PIECE

(1.00 mm) .0394" PITCH • FSI SERIES

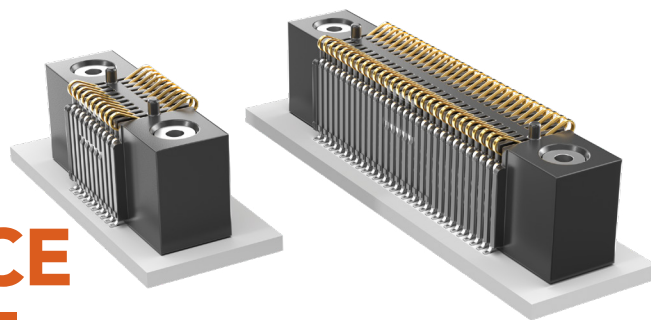

SPECIFICATIONS

Insulator Material:
Liquid Crystal Polymer
Contact Material:
BeCu
Current Rating:
2.8 A per pin
(2 pins powered)
Voltage Rating:
220 VAC/311 VDC
Operating Temp Range:
-55 °C to +125 °C
Plating:
Au over 50 µ" (1.27 µm) Ni

PROCESSING

Lead-Free Solderable:
Yes
SMT Lead Coplanarity:
(0.10 mm) .004" max (05-30)
(0.15 mm) .006" max (50)*
*(.004" stencil solution
may be available; contact
ipg@samtec.com)
Compression Board:
Gold Pads required

OTHER SOLUTIONS

Low Profile

See www.samtec.com?SEI

.050"
(1.27 mm)
Pitch

See www.samtec.com?SIBF

FSI	1	PINS PER ROW	BODY HEIGHT	PLATING OPTION	ROW OPTION	INSERT OPTION	ALIGNMENT OPTION	OTHER OPTION
		10, 20, 30, 50 (Insert/Screw Option)	-03 = 3 mm -06 = 6 mm -10 = 10 mm	-L = 10 µ" (0.25 µm) Gold on contact, Matte Tin on tail (Not available with -03 body height) -G = 10 µ" (0.25 µm) Gold (-03 only)	-S = Single Row (Available with 5, 10 & 20 pins with -AD alignment pin) -D = Double Row	Leave blank for Short Version (No screw down inserts or holes) -E = #2-56 x 1/16" screw thread -M = 2.00 mm x 0.40 mm screw thread	Leave blank for no Alignment Pin -AD = Alignment Pin Top & Bottom	-WT = Weld Tab (Available with -S row option & -06 & -10 body height only) -K = Polyimide Film Pick & Place Pad (50 position with threaded insert option only) -P = Plastic Pick & Place Pad (5.08 mm) .200" x (12.45 mm) .490" (50 not available with -E) (Not available with -S row option or -03 body height)

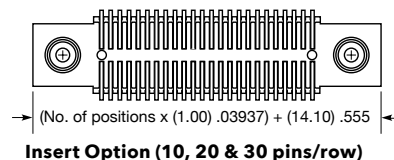
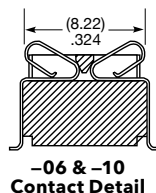
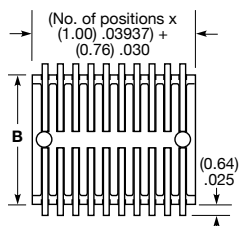

Insert Option (10, 20 & 30 pins/row)

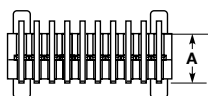

Short Version

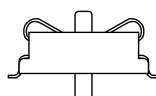

-03-AD Shown

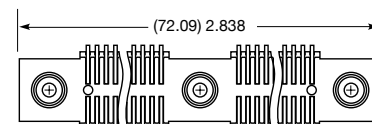

Insert Option (50 pins/row)

Double Row Version -03, -06, -10

-TR
= Tape & Reel

-FR
= Full Reel Tape & Reel (must order max. quantity per reel; contact Samtec for quantity breaks)

ALSO AVAILABLE

Contact Samtec

No alignment pin
Top side alignment pin
Bottom side alignment pin
Other platings

Notes:
Applications requiring 40-50 positions without threaded inserts, please contact Samtec Interconnect Processing Group.

Some lengths, styles and options are non-standard, non-returnable.

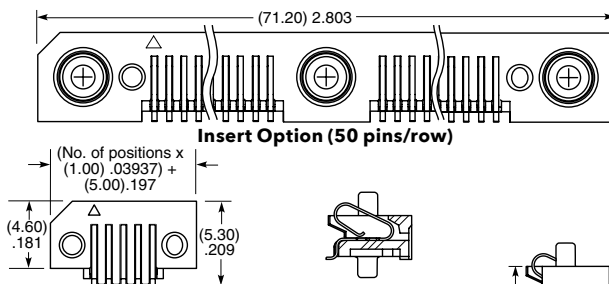

Insert Option (50 pins/row)

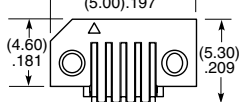

Short Version

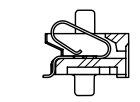

-03, -06 & -10 Contact Detail

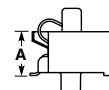

-03-AD Shown

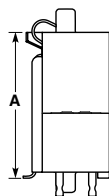

-WT Option (-06 & -10 Body only)

Single Row Version -03, -06, -10

BODY HEIGHT	A	B
-03	(3.00) .118	(8.76) .345
-06	(6.00) .236	(9.02) .355
-10	(10.00) .394	(9.02) .355

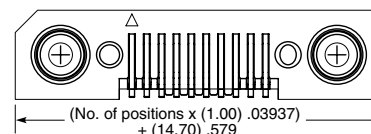

Insert Option (10, 20 & 30 pins/row)