

DIN Cable Assemblies

RFA6T, RFB6T, RF179, RFB8T, RFC6T, RFC8T



SERIES	END 1 CONNECTOR	END 2 CONNECTOR	OVERALL LENGTH
RFC6T* = 12G-SDI, Belden 4694R Cable	-78SP4 = 75 Ω DIN Straight Plug		-“XXXX” = Overall length in millimeters
RFC8T* = 12G-SDI, Belden 4855R Cable	ALSO AVAILABLE		
RFA6T = RG 6 Cable	75 Ω: HDBNC, BNC = RFB6T, RFA6T, RFC6T		
RFB6T = Belden 1694A Cable	75 Ω: BNC, SMB, MCX, MMCX = RF179		
RF179 = PCB 179 Cable	75 Ω: HDBNC = RFB8T, RFC8T		
RFB8T = Belden 1855A Cable			
	-0100 (100 mm) 3.94" minimum (RF179)		
	-0300 (300 mm) 11.81" minimum (RFA6T, RFB6T, RFB8T, RFC6T, RFC8T)		

*Designed to meet SMPTE 2082 12G-SDI specifications.

DIN Board Connectors

DIN7A-TH, DIN7A-BH

Cable Mates:

RFA6T, RFB6T, RF179, RFB8T, RFC6T, RFC8T, GRF7H-C



Notes:
Contact RFGroup@samtec.com for 12G-SDI PCB mount launch characteristics.

Designed to meet SMPTE 2082 12G-SDI specifications.

Additional plating options available on Cable Assemblies, Cable Connectors and Board Connectors. Contact RFGroup@samtec.com

DIN7A	GENDER	TYPE	PLATING	ORIENTATION	TERMINATION	PACKAGING
	-J = Jack	-P = PCB Mount	-GF = 10 μ" (0.25 μm) Gold center contact, 3 μ" (0.08 μm) Gold outer contact, (100 μ" (2.54 μm) Nickel body -RA only)	-ST = Straight (-TH1 only) -RA = Right-angle (-BH1 only)	-TH1 = Through-hole (-ST only) -BH1 = Bulkhead Through-hole (-RA only)	Leave blank for individually bagged. -B = Bulk packaged (-BH1 only)

DIN Cable Connectors

DIN7A-CA



CONNECTORS FOR INDUSTRY STANDARD CABLES	
DIN7A-PP-C-GF-ST-CA3	RG 179
DIN7A-PP-C-GF-ST-CA6	*RG 6, Belden 1694A or Belden 4694R Cable
DIN7A-PP-C-GF-ST-CA8	*Belden 1855A or Belden 4855R Cable

Add "-B" to the end of the part number for bulk packaging (100 max.)

*Designed to meet SMPTE 2082 12G-SDI specifications.

PP-C = Push Pull Plug Cable

GF = Plating (10 μ" Gold on center contact, Flash Gold on outer contact, Nickel on Shell)

ST = Straight

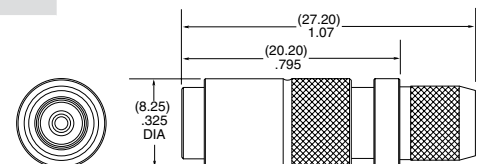

-CA6

Supplied with pins and ferrules.
See website for dimensions