

REVISIONS					
P	LTN	DESCRIPTION	DATE	DWN	APVD
A		REVISED PER ECN-25-300958	10JAN2025	D_K	O_C
B		REVISED PER ECR-25-248564	07JUL2025	MV	CO

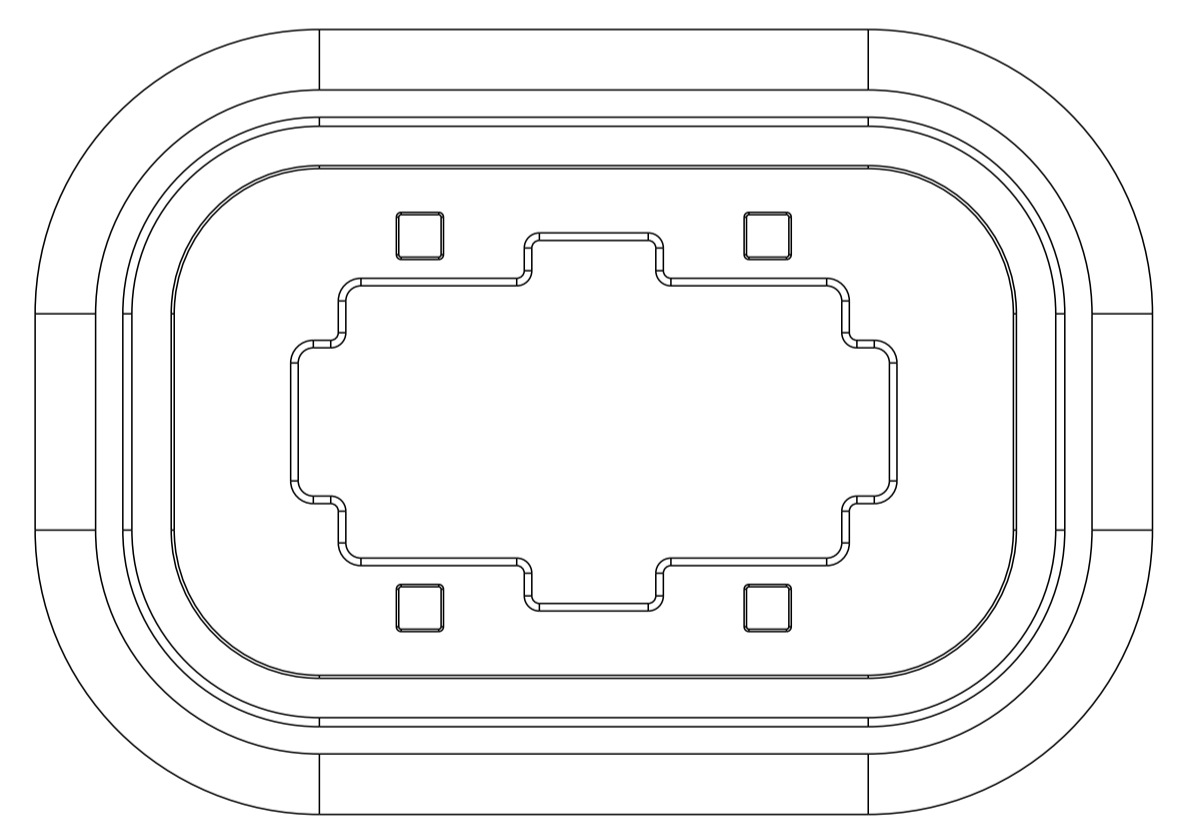

2391531-3 SHOWN

- 1. MATERIAL: SILICONE RUBBER
COLOR: BLUE
- 2. RECOMMENDED MATING PART: SEE TABLE

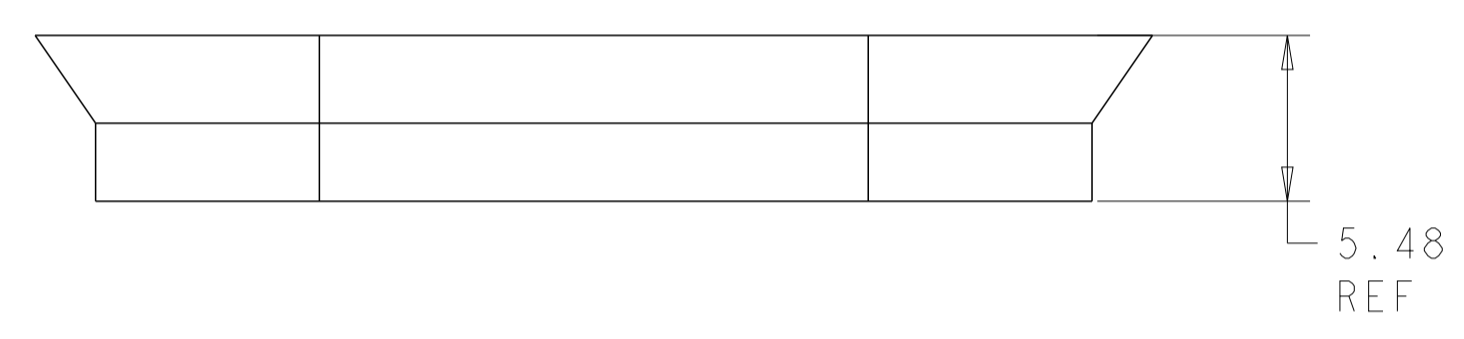
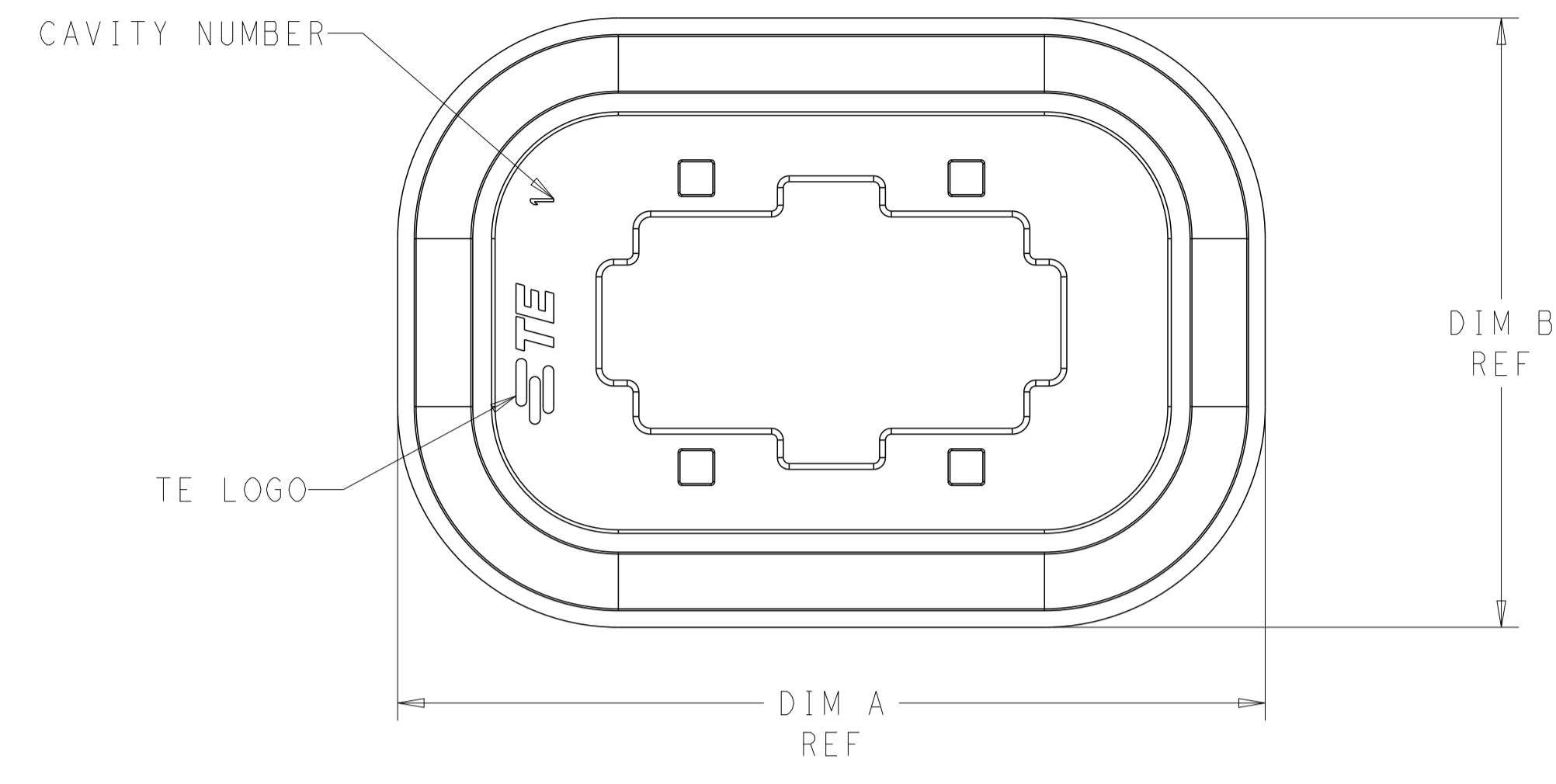
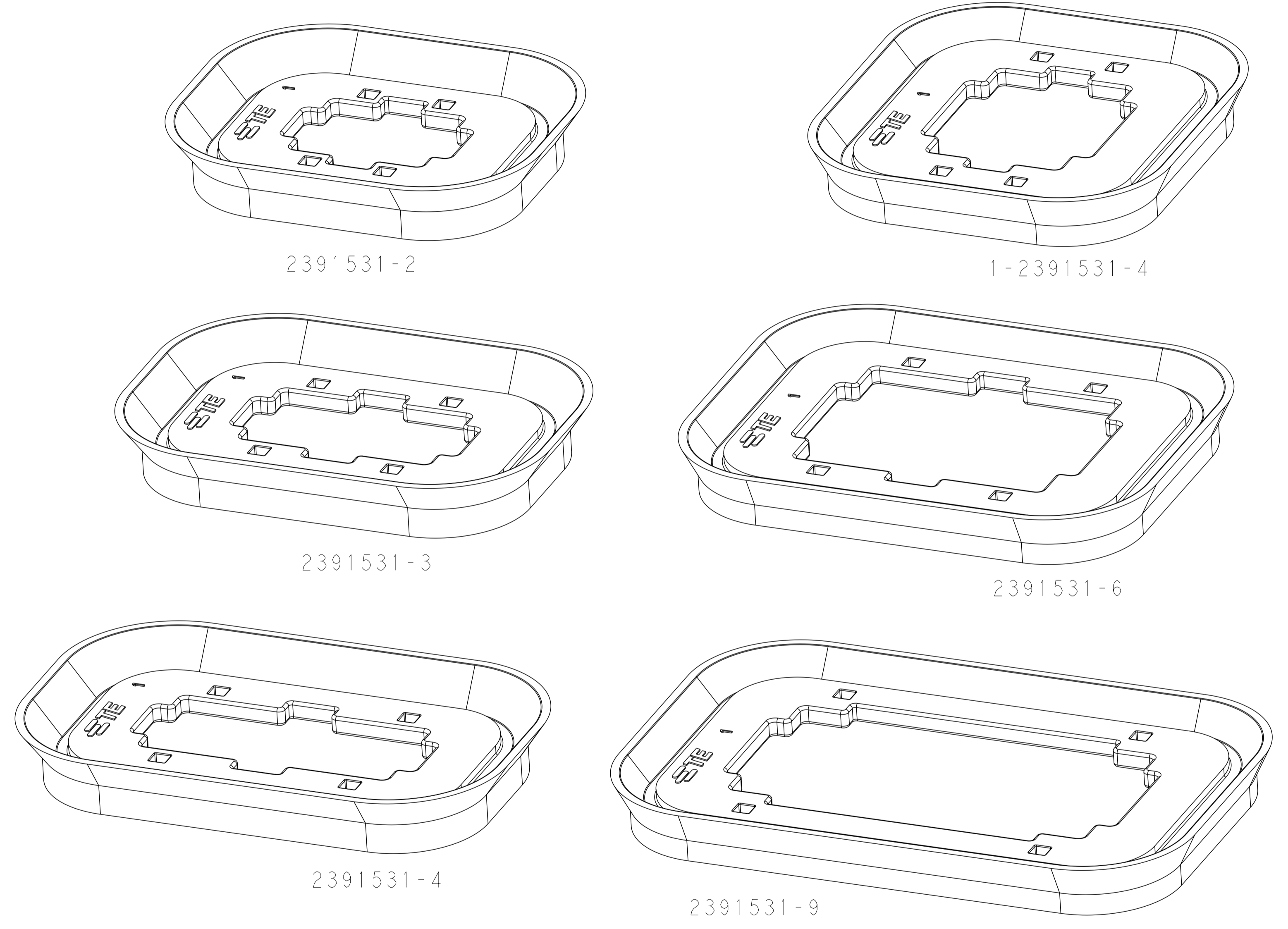

MATING PANEL THICKNESS	MATING CAP HOUSING	DIM C	DIM B	DIM A	POSITIONS	PART NUMBER
1.0	2391520-1	4.73	31.98	49.98	9P(2+3+4)	2391531-9
1.0	2391518-1 2391518-2 2416056-2	4.73	31.98	40.78	6P(2+4)/7P(3+4)	2391531-6
1.0	2391517-1	4.73	31.98	30.78	4P(2+2)	1-2391531-4
0.25 TO 1.0	2391515-4	5.48	25.95	41.95	4P(SINGLE ROW)	2391531-4
0.25 TO 1.0	2391515-3	5.48	25.95	36.95	3P(SINGLE ROW)	2391531-3
0.25 TO 1.0	2391515-2 2-2391515-2	5.48	25.95	31.95	2P(SINGLE ROW)	2391531-2

THIS DRAWING IS A CONTROLLED DOCUMENT.

DIMENSIONS: mm

TOLERANCES UNLESS OTHERWISE SPECIFIED:

0 PLC	±
1 PLC	±
2 PLC	±
3 PLC	±
4 PLC	±
ANGLES	±
FINISH	±

MATERIAL:

APPROVED:

DATE: 07SEP2022

NAME: GASKET SEAL, POWER DOUBLE LOCK

SIZE: A | 00779 | C=2391531

SCALE: 4:1 | SHEET 1 OF 1 | REV B