

REVISIONS					
P	LTN	DESCRIPTION	DATE	DWN	APVD
A		NEW DRAWING	28 JUL 2022	BDA	DH
A1		MATERIAL GENERIC NAME UPDATED	29 MAY 2025	CK	SB

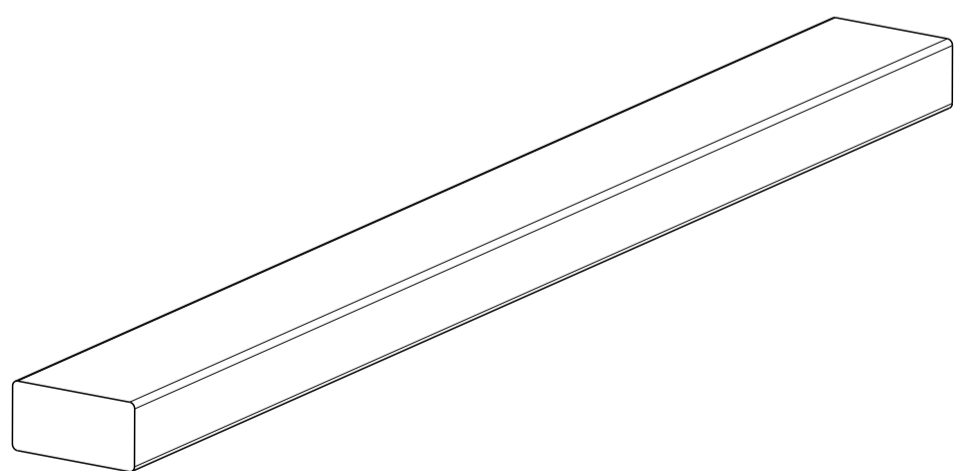
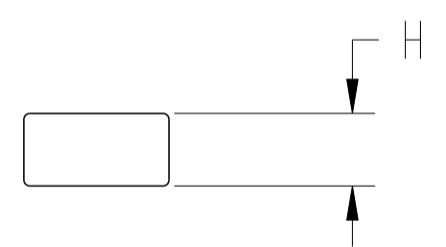
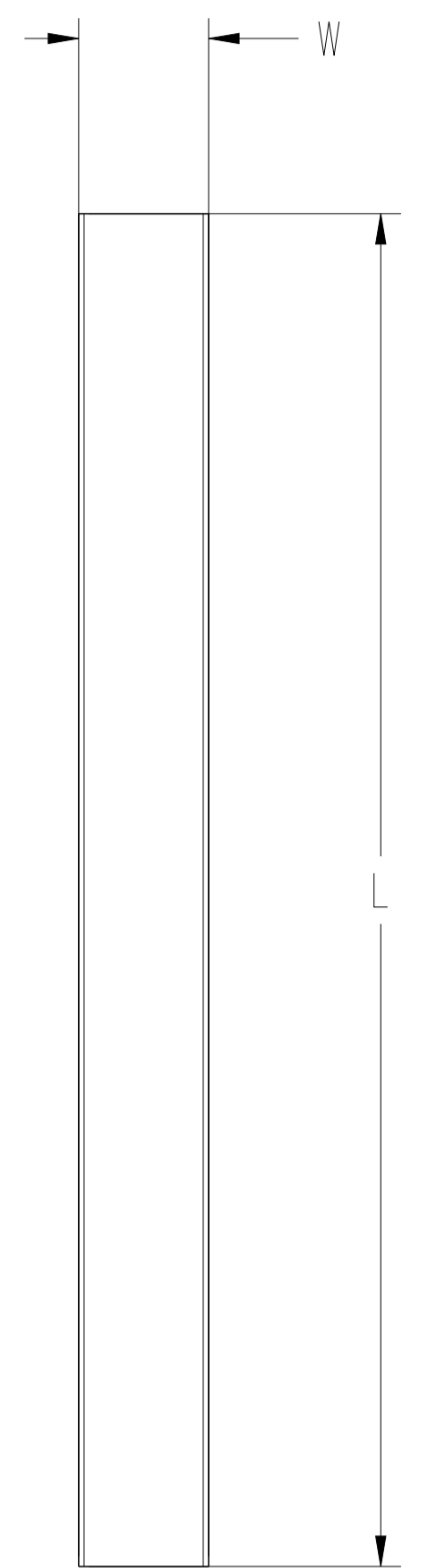

ISOMETRIC VIEW (NTS)

3.2	6.4	25000	136-0032-0064	STAINLESS STEEL (S/S+)	2423847-1
3.2	3.2	25000	136-0032-0032	STAINLESS STEEL (S/S+)	2423846-1
2.4	4.8	25000	136-0024-0048	STAINLESS STEEL (S/S+)	2423845-1
3.2	6.4	25000	134-0032-0064	TIN PLATED COPPER CLAD STEEL (TCS)	2423844-1
3.2	3.2	25000	134-0032-0032	TIN PLATED COPPER CLAD STEEL (TCS)	2423843-1
2.4	4.8	25000	134-0024-0048	TIN PLATED COPPER CLAD STEEL (TCS)	2423842-1
3.2	6.4	25000	132-0032-0064	NICKEL-COPPER ALLOY 400 WIRE (MON)	2423841-1
3.2	3.2	25000	132-0032-0032	NICKEL-COPPER ALLOY 400 WIRE (MON)	2423840-1
2.4	4.8	25000	132-0024-0048	NICKEL-COPPER ALLOY 400 WIRE (MON)	2423839-1
3.2	6.4	250	136-0032-0064-S	STAINLESS STEEL (S/S+)	2423791-1
3.2	3.2	250	136-0032-0032-S	STAINLESS STEEL (S/S+)	2423790-1
2.4	4.8	250	136-0024-0048-S	STAINLESS STEEL (S/S+)	2423789-1
3.2	6.4	250	134-0032-0064-S	TIN PLATED COPPER CLAD STEEL (TCS)	2423788-1
3.2	3.2	250	134-0032-0032-S	TIN PLATED COPPER CLAD STEEL (TCS)	2423787-1
2.4	4.8	250	134-0024-0048-S	TIN PLATED COPPER CLAD STEEL (TCS)	2423786-1
3.2	6.4	250	132-0032-0064-S	NICKEL-COPPER ALLOY 400 WIRE (MON)	2423785-1
3.2	3.2	250	132-0032-0032-S	NICKEL-COPPER ALLOY 400 WIRE (MON)	2423784-1
2.4	4.8	250	132-0024-0048-S	NICKEL-COPPER ALLOY 400 WIRE (MON)	2423783-1
H ± 0.8	W ± 0.8	L	ALIAS PART NUMBER	MATERIAL	PART NUMBER

THIS DRAWING IS A CONTROLLED DOCUMENT.

DIMENSIONS:	TOLERANCES UNLESS OTHERWISE SPECIFIED	CHK	DWN	DATE
mm	0 PLC ±	BASAVARAJA D A	28 JUL 2022	
	1 PLC ±	B. SELVAPANDIAN	28 JUL 2022	
	2 PLC ±	D. HEMMING	28 JUL 2022	
	3 PLC ±			
	4 PLC ±			
	ANGLES			
	FINISH			

MATERIAL: SEE TABLE

WEIGHT: -

CUSTOMER DRAWING

SCALE: 4:1

SHEET 1 OF 1

REV A1

TE Connectivity

13X- RECTANGULAR SOLID KNITTED WIRE MESH

SIZE: A1

CAGE CODE: -

DRAWING NO: C=RECTANGULAR-SKW-MESH

RESTRICTED TO: -