

REVISIONS				
#	LTN	DESCRIPTION	DATE	APPV
C		CPA DESIGN OPTIMIZATION	18OCT2024	LSZ SZN
C1		INTRODUCTION OF NEW VARIANT	18NOV2024	LSZ SZN
D		INTRODUCTION OF NEW VARIANT	18FEB2026	GYR SZN
D1		NOTE CORRECTION	08MAY2026	GYR SZN

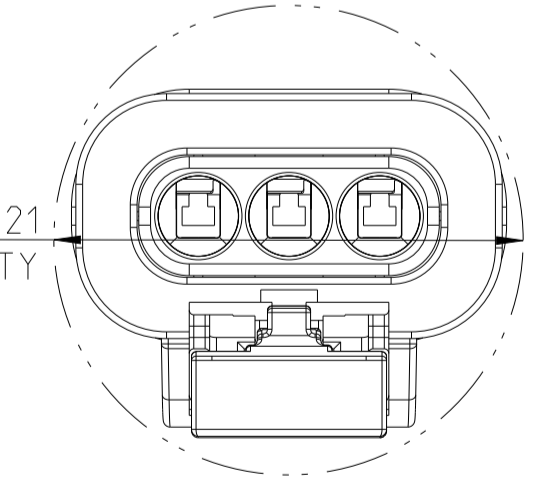
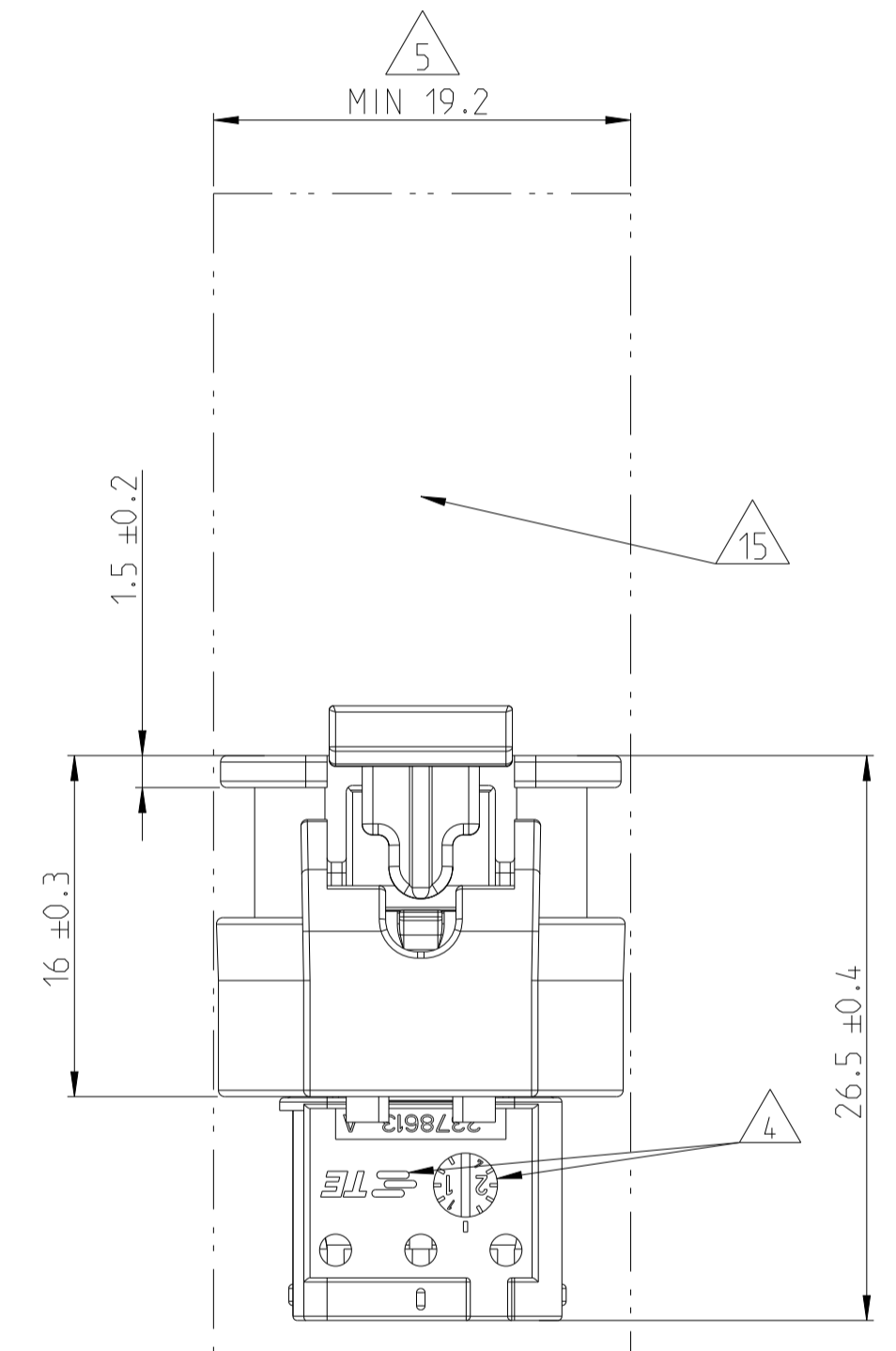
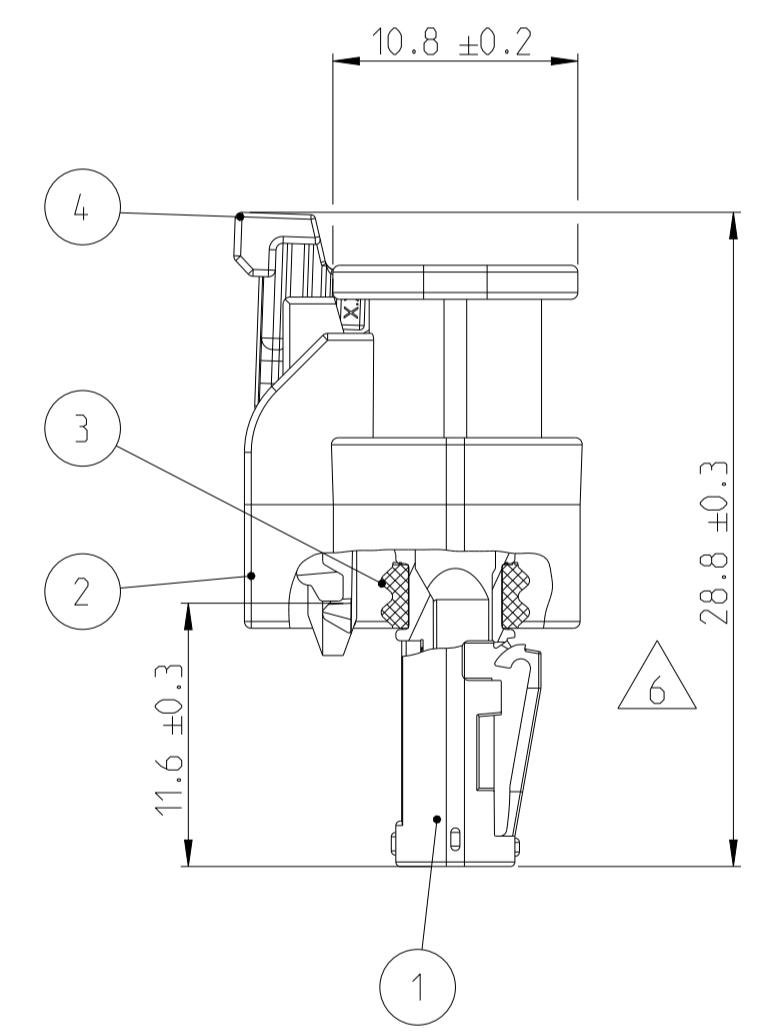
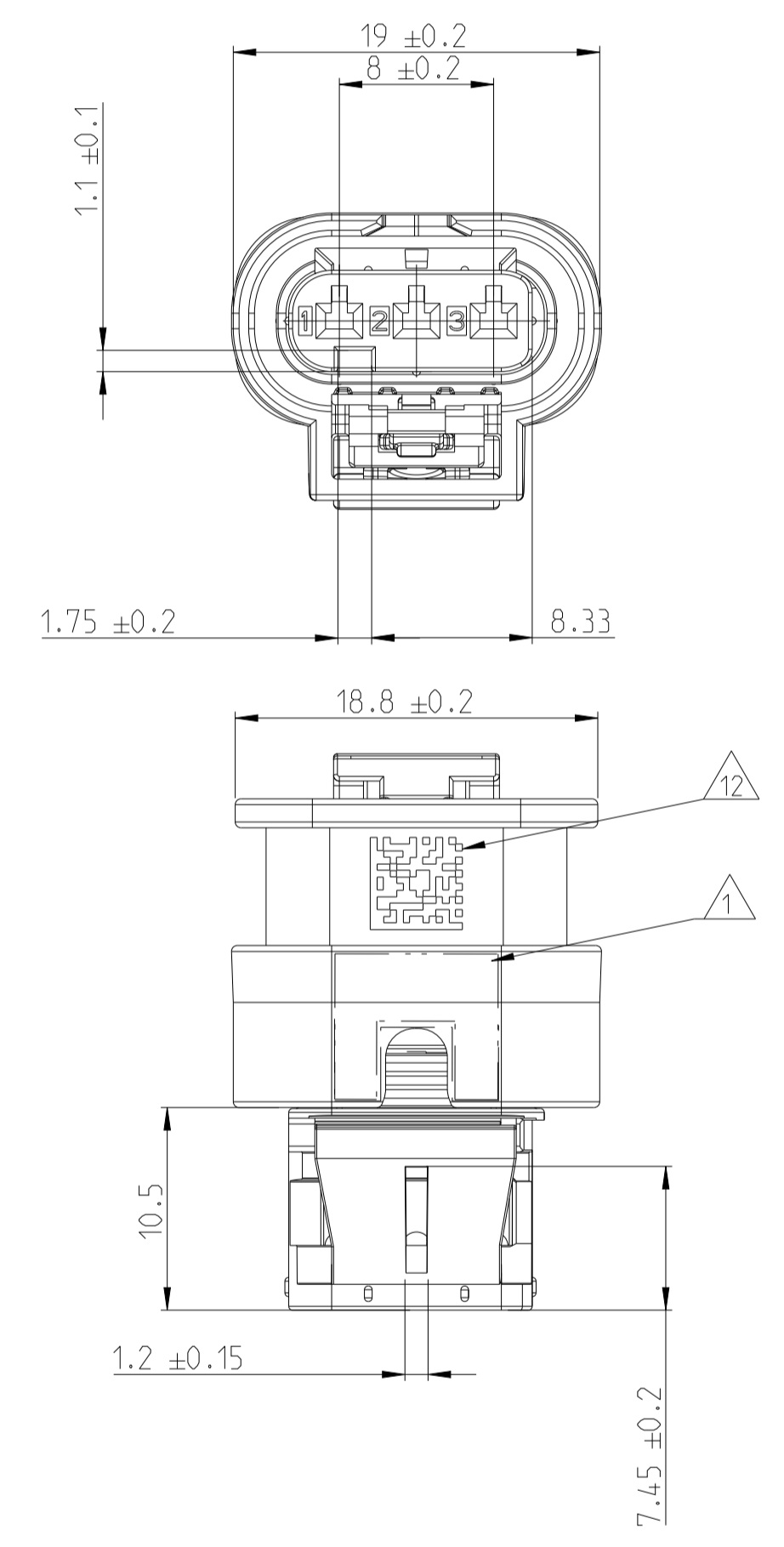
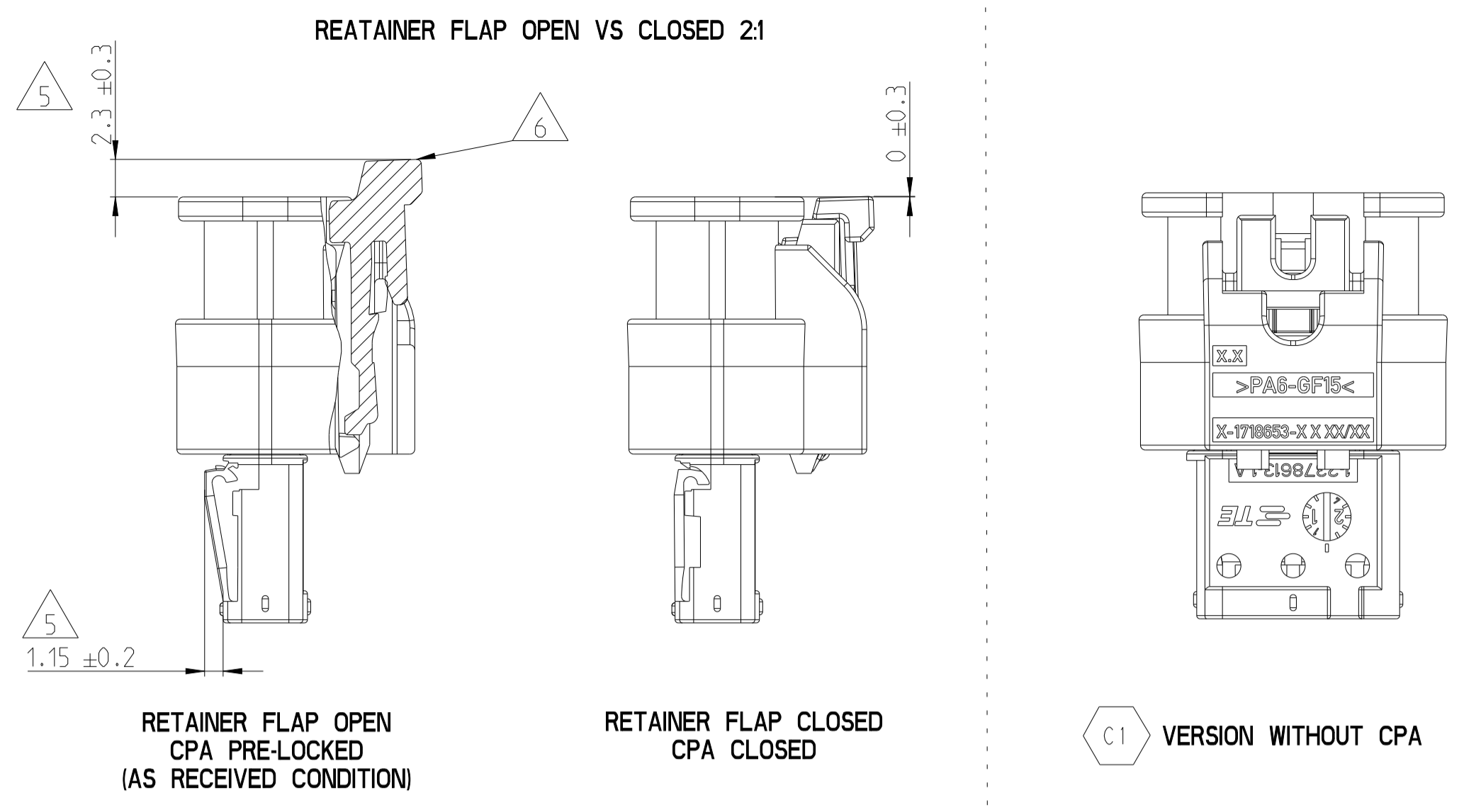
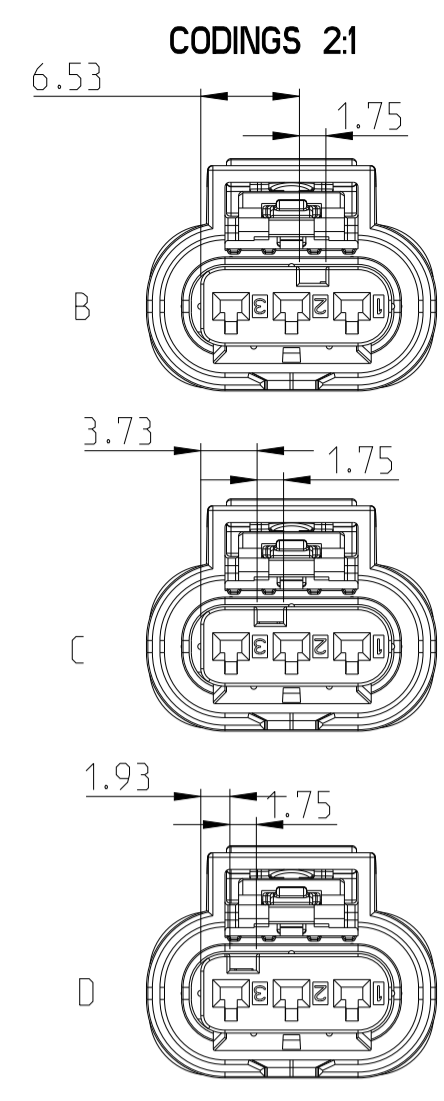
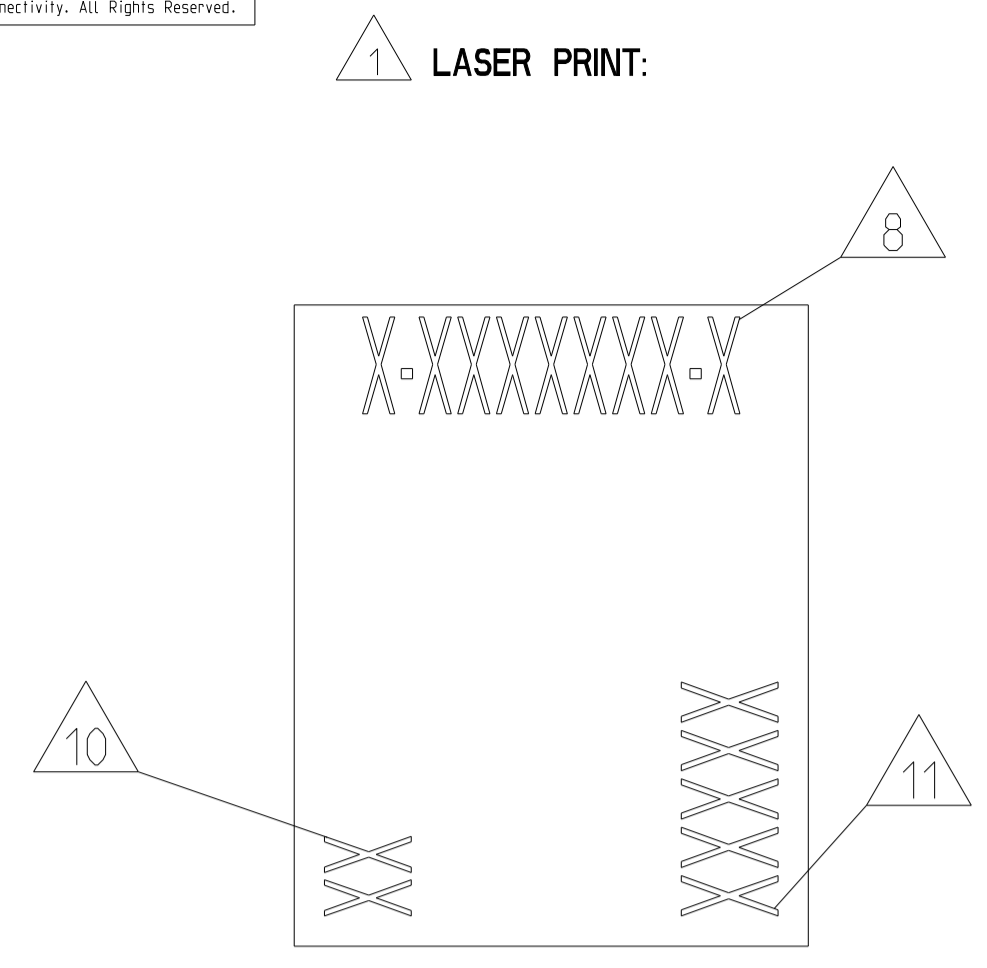

NOTES:

- 1 AREA FOR LASER PRINT
- 2 USABLE CONTACTS MCON 1.2 LL SEE TE-NO. 1452674
- 3 SEE PRODUCT SPECIFICATION NO.108-18782 FOR THE FOLLOWING PRODUCT PROPERTIES:
 - MAX. WIRE SIZE RANGE PERMITTED
 - PERMISSIBLE CURRENT CARRYING CAPACITY OF THE SINGLE CONTACT
 - MAX OPERATING VOLTAGE
 - VIBRATION RESISTANCE
 - MAX OPERATING TEMPERATURE
 MAX OPERATING TEMPERATURE 130°C
- 4 SUPPLIER-MARK (ONLY FOR TE CONNECTIVITY INTERNAL TRACKING)
- 5 SPACE OF ACTIVITY
- 6 SUPPLY CONDITION: CPA (4) AND RETAINER FLAP (1) IN PRELOCKED POSITION
- 7 WARPAGE PERMITTED TO MAX. -0.5mm
- 8 TE ORDER-NO.
- 9 ACCORDING TO INTERFACE DRAWING SEE TE-NO. 114-18679-3
- 10 ASSEMBLY LINE SEGMENT IDENTIFICATION
- 11 DATE CODE (DDYY)
- 12 QR CODE:
 - FIRST ROW: MANUFATCURING INFORMTATION ONLY FOR TE CONNECTIVITY
 - SECOND ROW: TE.COM ONLINE CATALOG LINK FOR CUSTOMER
- 14 THE MARKING ON THE COMPONENTS MAY VARY IN THE SAME BATCH TOO IT DOES NOT SERVE ANY FUNTION IT IS ONLY USED FOR TE CONNECTIVITY INTERNAL TRACKING FOR VALID CUSTOMER TRACKING PLEASE USE THE LASER PRINT - SEE NOTE 1
- 15 PLEASE CARRY OUT THE CLEARANCE TEST FOR THE SOCKET HOUSING BASED ON THE WIRE SIZE USED
- 16 SECONDARY LOCK THAT HAVE BEEN CLOSED DURING TRANSPORT CAN BE MOVED BACK TO PRE-LOCKED POSSITION ACCORDING TO INSTRUCTIONS FOUND IN THE APPLICATION SPEC. NO 114-94767
- 17 CONTACT TE SALES REPRESENTATIVE FOR ACTIVATION OF CROSSED OUT VERSIONS

D C1 C1

QTY REQD PER ASSY	DESCRIPTION	MATERIAL	COLOUR	ITEM NO	
-	1 1 1 1 1 1 1	NEXTGEN MCON 1.2 LL CPA	PBT-GF30	RED	4
1	1 1 1 1 1 1 1	3POS MCON 1.2 - SEAL	SILOPREN LSR	BLUE	3
1	1 1 1 1 1 1 1	3POS, NEXTGEN MCON 1.2 - PROTEC. COVER	PA6-GF15	BLACK	2
-	- - - 1 - - -	3POS NEXTGEN MCON 1.2LL REC HSG,SLD, - CODE D	PBT-GF20	VIOLET	1
1	- - - 1 - - -	3POS NEXTGEN MCON 1.2LL REC HSG,SLD, - CODE C	PBT-GF20	BLUE	1
-	- 1 - - - 1 - -	3POS NEXTGEN MCON 1.2LL REC HSG,SLD, - CODE B	PBT-GF20	BROWN	1
-	- - 1 - - - 1	3POS NEXTGEN MCON 1.2LL REC HSG,SLD, - CODE A	PBT-GF20	BLACK	1
3-	-62- -61- -64- -13- -12- -11- -1				
D	C C C C C C C				

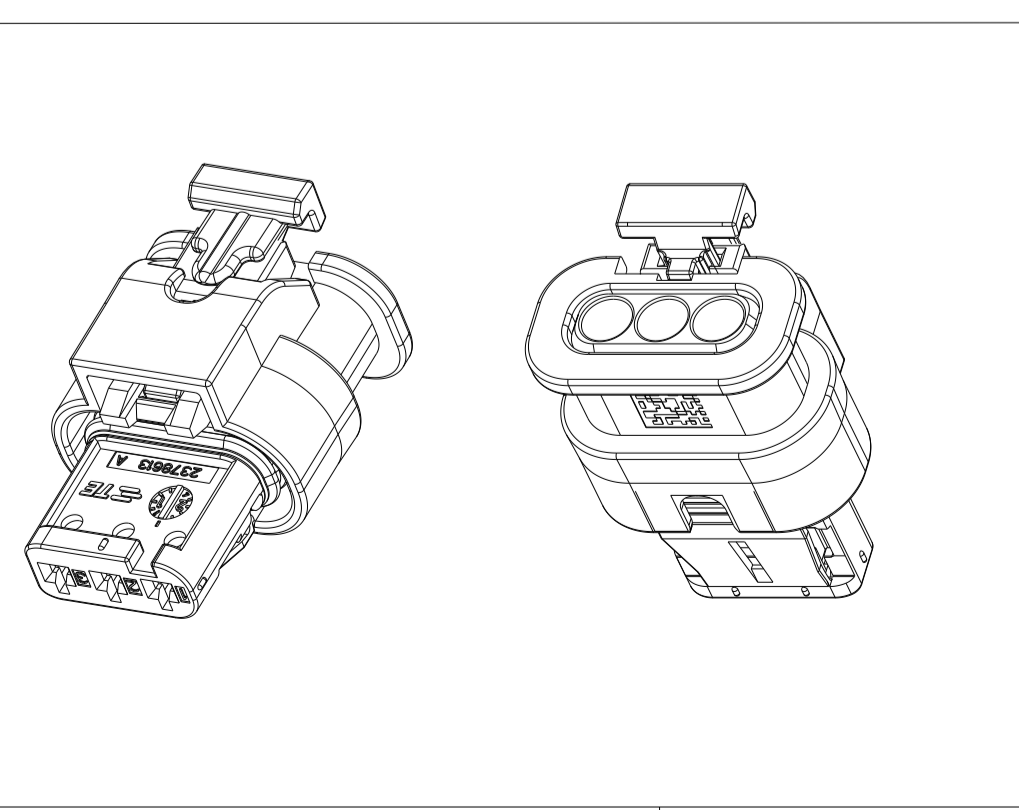

1-2378603-1 AS SHOWN

DIMENSIONS: mm TOLERANCES UNLESS OTHERWISE SPECIFIED ACC. TO DIN 9136-1:2015 (ENTIRE TO NOMINAL DIMENSION, EDITION 1992-11) SHALL APPLY.		DWN: 28 JUN 2021 CHK: SZEKELY LEHEL APVD: NEMES SZILARD NAME: GASPARD SZABOLCS PRODUCT SPEC: 108-94874 APPLICATION SPEC: 114-94767	
MATERIAL: See: Parts List FINISH:		WEIGHT: - CUSTOMER DRAWING:	
SIZE: A 00779 C=2378603		RESTRICTED TO: - SCALE: 5:1 SHEET 1 OF 1 REV: 01	