

THIS DRAWING IS UNPUBLISHED. RELEASED FOR PUBLICATION 20
 © COPYRIGHT 20 BY - ALL RIGHTS RESERVED.

REVISIONS					
P	LTR	DESCRIPTION	DATE	DWN	APVD
H5		REVISED PER ECR-22-160768	23JUN2022	WLS	VS
H6		REVISED PER ECN-23-240910	24NOV2023	WLS	VS
H7		REVISED PER ECN-24-279340	19AUG2024	WLS	JP
J		REVISED PER ECN-25-323497	02JUN2025	WLS	JP

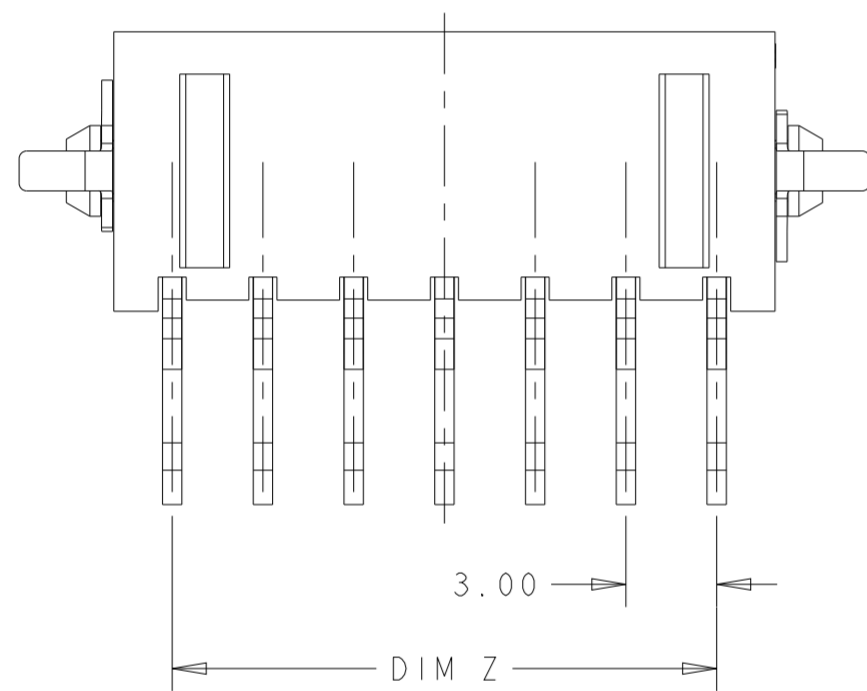
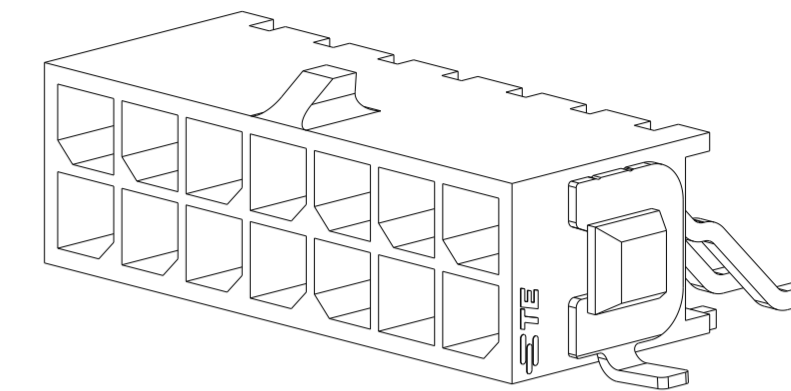
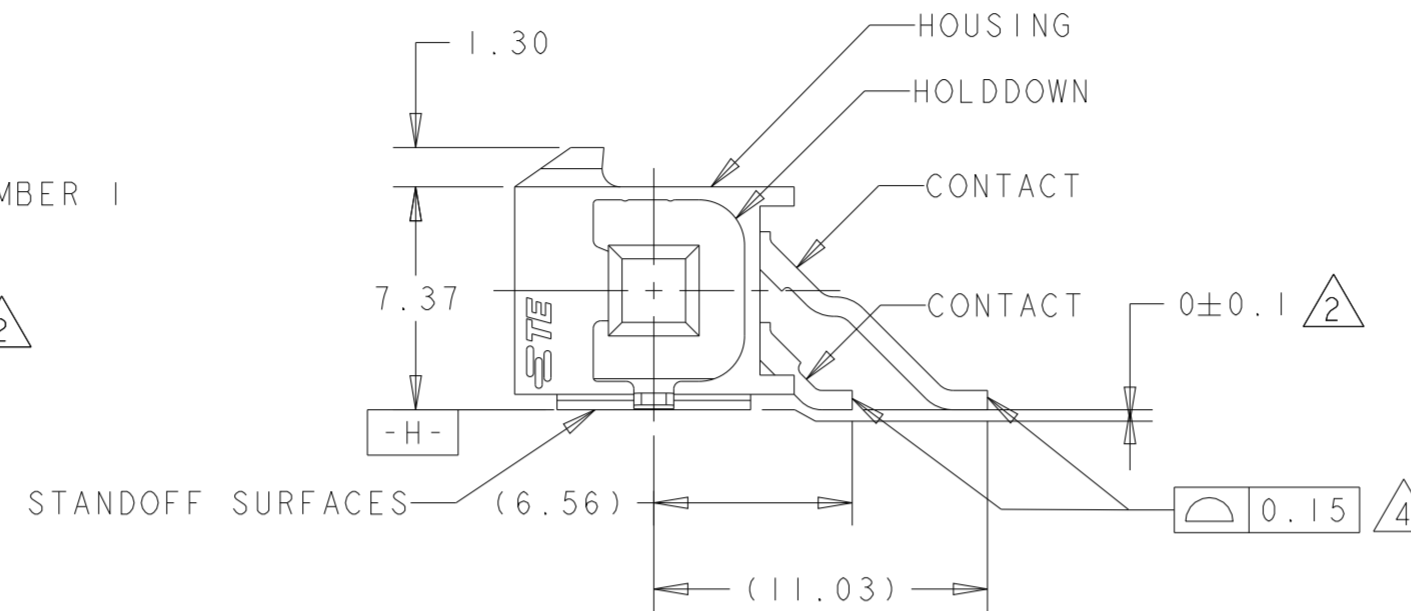
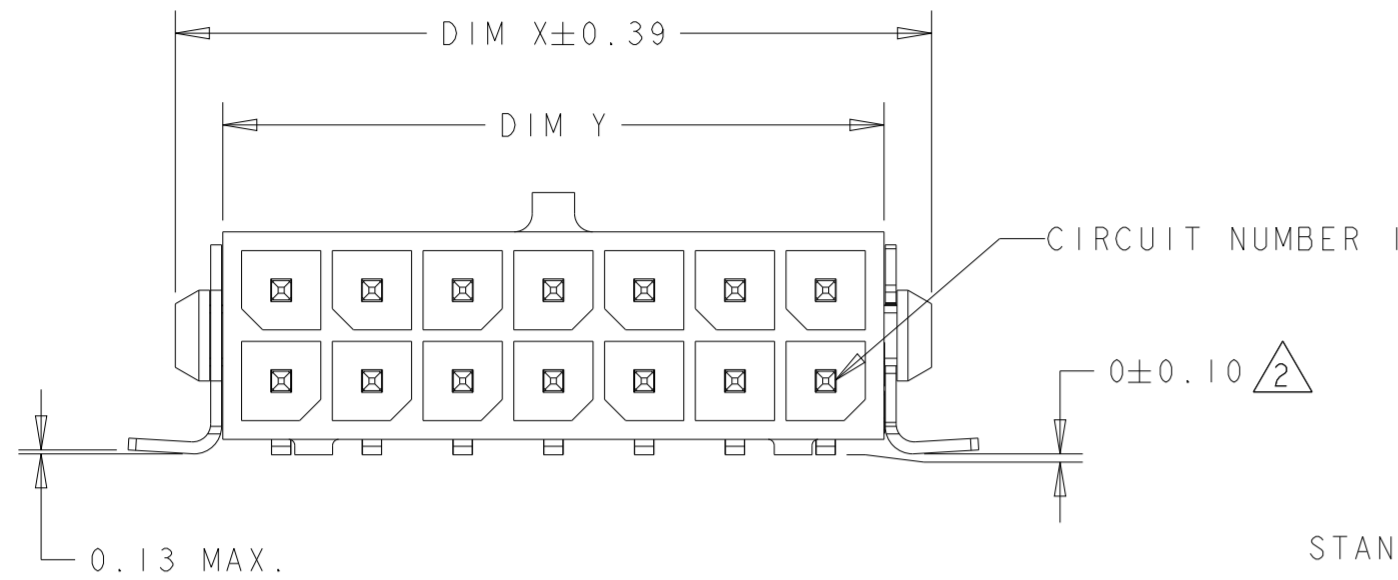

- 1 MATERIAL;
HOUSING - UL 94V-0 RATED HIGH TEMP NYLON, COLOR BLACK.
CONTACTS - BRASS.
HOLDDOWNS - PHOSPHOR BRONZE.
- 2 DIMENSION APPLIES TO SOLDERTAIL SURFACES, HOLDDOWNS SURFACES AND STANDOFF SURFACES.
- 3 RECOMMENDED PC BOARD THICKNESS OF 1.57.
- 4 ALL SOLDERTAILS AND HOLDDOWNS.
- 5 PLATING;
CONTACTS - 0.38µm MINIMUM GOLD,
OR
0.0762µm MINIMUM GOLD FLASH OVER 0.31µm MINIMUM PALLADIUM NICKEL,
ON MATING AREA PER TE CONNECTIVITY'S DISCRETION,

2.54µm MINIMUM MATTE TIN ON SOLDER TAIL.

ALL OVER 1.27µm MINIMUM NICKEL.

HOLDDOWNS - 2.54µm MINIMUM MATTE TIN OVER 1.27µm MINIMUM NICKEL.
- 6 COUNTERPART RECOMMENDED IS PN 794617 (DASH ACCORDING TO NUMBER OF POSITION).
- 7 FOR REELING DIRECTION AND PACKAGING TYPE, SEE SPECIFICATION 114-13000.

	36.86	40.27	33.00	40.00	24	5-794628-4
OBSOLETE	33.86	37.27	30.00	37.00	22	5-794628-2
	30.86	34.27	27.00	34.00	20	5-794628-0
OBSOLETE	27.86	31.27	24.00	31.00	18	4-794628-8
OBSOLETE	24.86	28.27	21.00	28.00	16	4-794628-6
OBSOLETE	21.86	25.27	18.00	25.00	14	4-794628-4
	18.86	22.27	15.00	22.00	12	4-794628-2
	15.86	19.27	12.00	19.00	10	4-794628-0
	12.86	16.27	9.00	16.00	8	3-794628-8
	9.86	13.27	6.00	13.00	6	3-794628-6
	6.86	10.27	3.00	10.00	4	3-794628-4
OBSOLETE	3.86	7.27		7.00	2	3-794628-2
	DIM Y	DIM W	DIM Z	DIM X	NO. OF POSN.	PART NUMBER

THIS DRAWING IS A CONTROLLED DOCUMENT.		DWN K. WHITAKER 19MAR2003	TE Connectivity			
DIMENSIONS: mm		CHK C. JONES 19MAR2003				
TOLERANCES UNLESS OTHERWISE SPECIFIED:		APVD C. JONES 19MAR2003	NAME SMT, RIGHT ANGLE, SMT HOLDDOWN HDR, ASSY, 0.38Au or 0.31PdNi DUAL ROW, MICRO MATE-N-LOK TM			
±0.20 ±0.15 ±0.1 ±0.05 ±0.025 ±0.015 ±0.0075		PRODUCT SPEC 108-1836	SIZE A2	CAGE CODE 0779	DRAWING NO. G-794628	RESTRICTED TO -
MATERIAL 1		APPLICATION SPEC 114-13000	WEIGHT -	SCALE 4:1	SHEET 1 OF 2	REV J
CUSTOMER DRAWING						

THIS DRAWING IS UNPUBLISHED. RELEASED FOR PUBLICATION 20
 © COPYRIGHT 20 BY - ALL RIGHTS RESERVED.

REVISIONS				
P	LTR	DESCRIPTION	DATE	APVD
-	-	SEE SHEET 1	-	-

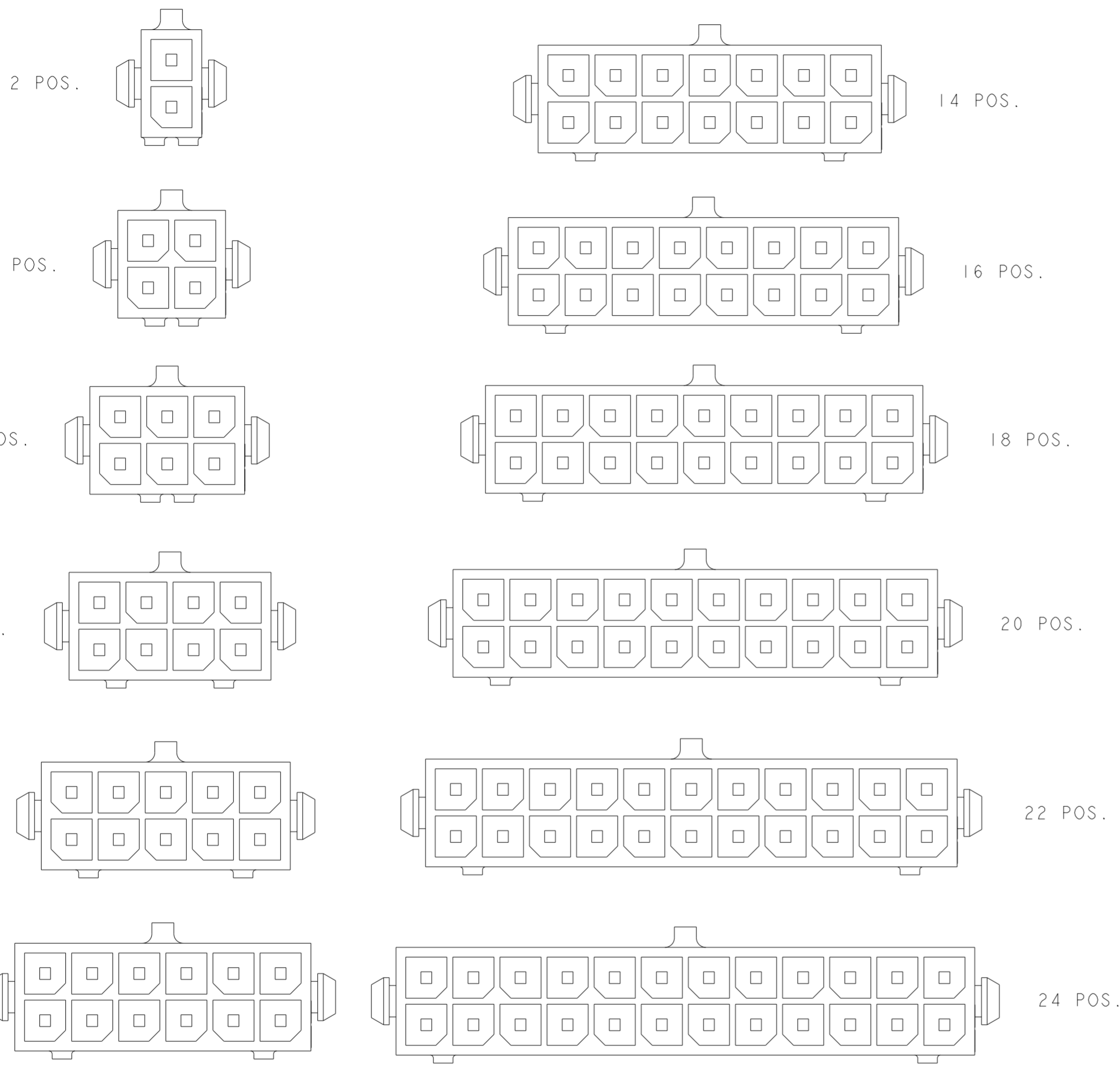

KEYING BY POSITION SIZE

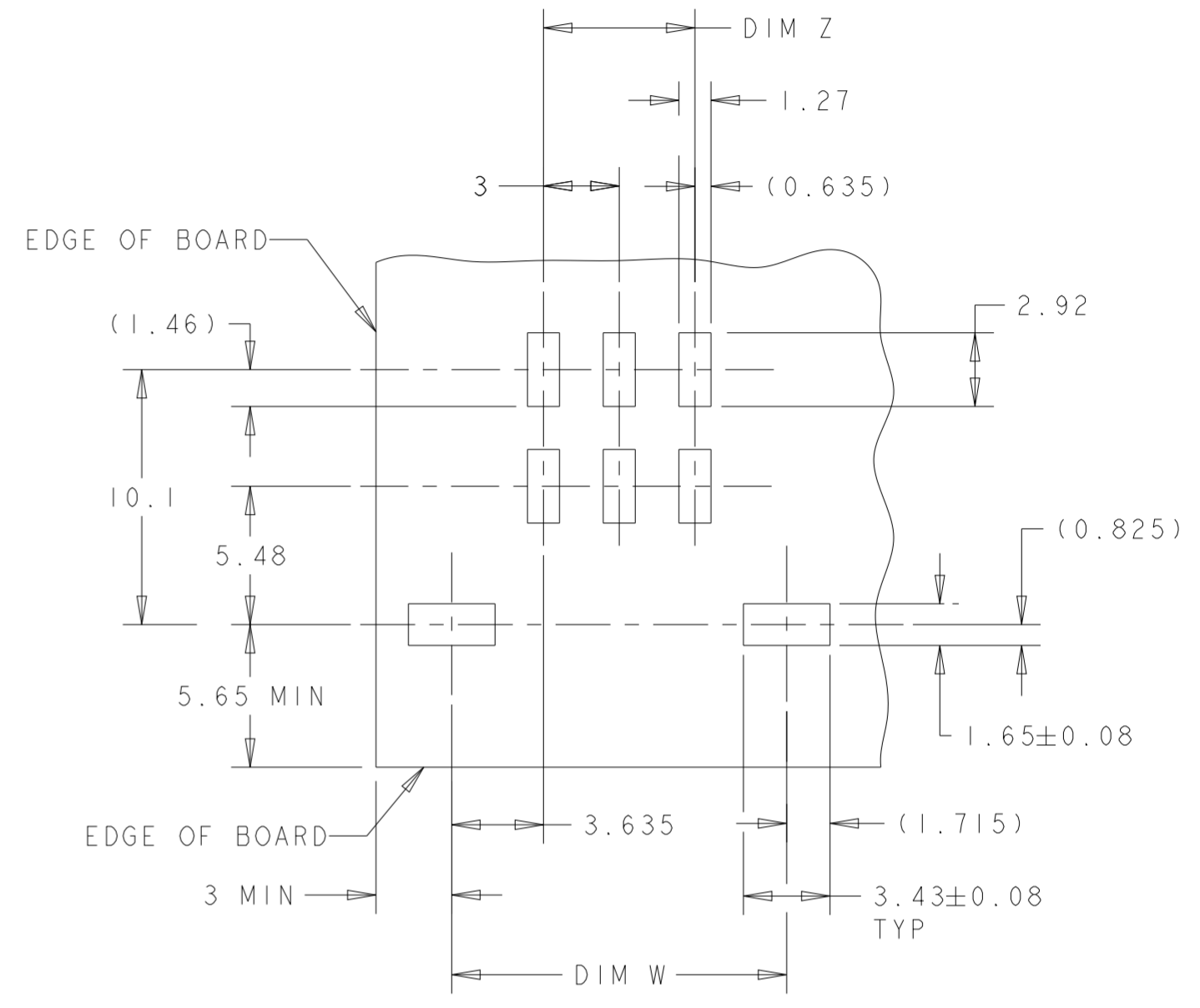

RECOMMENDED PCB LAYOUT $\triangle 3$

THIS DRAWING IS A CONTROLLED DOCUMENT.		DWN K. WHITAKER 19MAR2003	TE Connectivity
DIMENSIONS: mm		CHK C. JONES 19MAR2003	
TOLERANCES UNLESS OTHERWISE SPECIFIED:		APVD C. JONES 19MAR2003	NAME SMT, RIGHT ANGLE, SMT HOLDDOWN HDR, ASSY, 0.38Au or 0.31PdNi DUAL ROW, MICRO MATE-N-LOK
0 PLC ±	1 PLC ±	PRODUCT SPEC 108-1836	SIZE A20779
2 PLC ±0.20	3 PLC ±	APPLICATION SPEC 114-13000	CAGE CODE C-794628
4 PLC ±	ANGLES ±1°	WEIGHT -	DRAWING NO -
MATERIAL -	FINISH -	CUSTOMER DRAWING	RESTRICTED TO -
		SCALE 4:1	SHEET 2 OF 2
		REV J	