

REVISIONS				
P	LTN	DESCRIPTION	DATE	APVD
B1		REVISED PER ECN-25-330679	09JUL2025	AP SSH

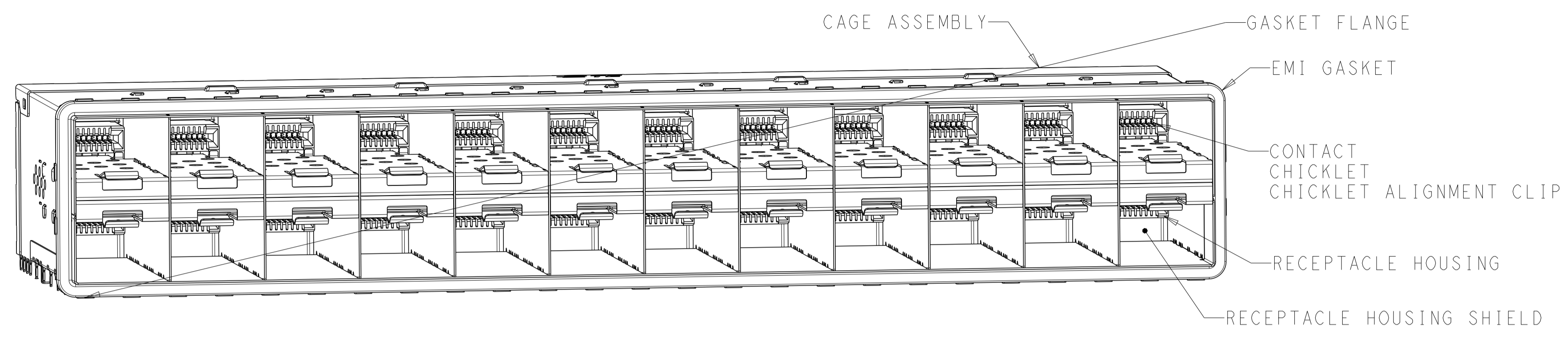

2288172-1

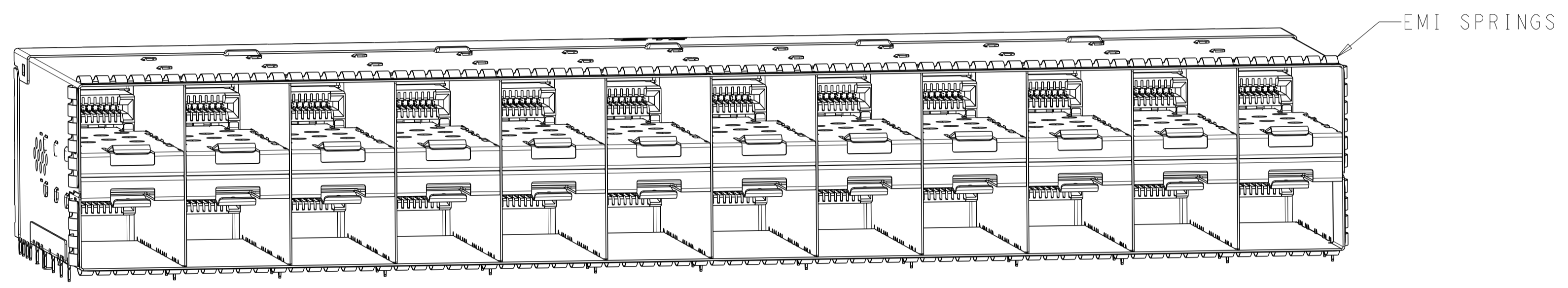

2288172-5

- MATERIALS:**
 CAGE ASSEMBLY - NICKEL-SILVER ALLOY PER ASTM B 122
 RECEPTACLE HOUSING - LCP, BLACK, UL 94V-0 RATED
 RECEPTACLE HOUSING SHIELD - COPPER ALLOY
 CHICKLET - LCP, BLACK, UL 94V-0 RATED
 CHICKLET ALIGNMENT CLIP - PBT
 CONTACT - COPPER ALLOY
 EMI GASKET - ELASTOMERIC
 GASKET FLANGE - STAINLESS STEEL
 LIGHT PIPE - POLYCARBONATE
 LIGHT PIPE HOUSING - ZINC ALLOY
 EMI SPRINGS - PHOSPHOR BRONZE PER ASTM B103
- CONTACT FINISH:**
 CONFORMS TO THE REQUIREMENTS OF TYCO ELECTRONICS
 PRODUCT SPECIFICATION 108-2481, BASED ON EIA/ECA-364-1000.01A,
 (CONTROLLED ENVIRONMENT APPLICATIONS) ON MATING INTERFACE,
 TIN ON NEEDLE EYE
- PCB MINIMUM THICKNESS = 1.5mm**
- FOR HOLE SIZE AND PLATINGS,**
 SEE APPLICATION SPECIFICATION 114-13319
- LIGHT PIPE PAD LAYOUT IS FOR 0805 LOW PROFILE**
 LED PACKAGE WITH A HEIGHT OF 0.8mm
- THE ENTIRE AREA OF THE CONNECTOR FOOTPRINT, INDICATED BY THE**
 DASHED LINE, TO BE CONSIDERED THE KEEPOUT AREA FOR COMPONENTS
 AND SIGNAL TRACES, TOP SIDE ONLY, TOP SIDE TRACES ALLOWED
 WITHIN CONNECTOR HOLE PATTERN
- DIMENSION APPLIES FROM EMI SPRINGS ONLY.**

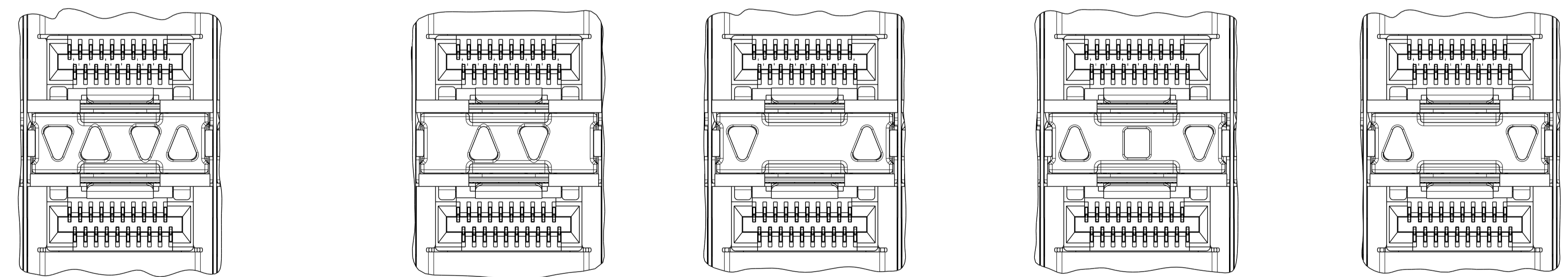

INNER/OUTER LIGHT PIPE
 2288172-2, 2288172-6
 SCALE 4:1

INNER LIGHT PIPE
 2288172-3, 2288172-7
 SCALE 4:1

OUTER LIGHT PIPE
 2288172-4, 2288172-8
 SCALE 4:1

CENTER/REVERSED OUTER
 1-2288172-7, 1-2288172-9
 SCALE 4:1

REVERSED OUTER
 1-2288172-8, 2-2288172-0
 SCALE 4:1

	173.5	EMI SPRINGS	REVERSED OUTER	2-2288172-0
			CENTER/REVERSED OUTER	1-2288172-9
OBSOLETE	176.25	EMI GASKET	REVERSED OUTER	1-2288172-8
			CENTER/REVERSED OUTER	1-2288172-7
	173.5	EMI SPRINGS	OUTER	2288172-8
			INNER	2288172-7
			INNER/OUTER	2288172-6
			NONE	2288172-5
OBSOLETE	176.25	EMI GASKET	OUTER	2288172-4
			INNER	2288172-3
			INNER/OUTER	2288172-2
			NONE	2288172-1
	(E)	CAGE TYPE	LIGHT PIPE CONFIGURATION	PART NUMBER

THIS DRAWING IS A CONTROLLED DOCUMENT. DIMENSIONING AND TOLERANCING PER ASME Y14.5M-2009.

DIMENSIONS: mm
 TOLERANCES UNLESS OTHERWISE SPECIFIED:
 0 PLC ±0.10
 1 PLC ±0.10
 2 PLC ±0.10
 3 PLC ±0.10
 4 PLC ±0.10
 ANGLES ±°
 FINISH ±

MATERIAL: SEE NOTES
 FINISH: SEE NOTES

DWN: M. SHIRK 26JAN2015
 CHK: P. RECCE 26JAN2015
 APVD:

NAME: RECEPTACLE ASSEMBLY, 2X12, STACKED, 2SFP+
 PRODUCT SPEC: 108-2431
 APPLICATION SPEC: 114-13319
 SIZE: A | 00779 | C=2288172
 WEIGHT: CUSTOMER DRAWING
 SCALE: 2:1 SHEET 1 OF 5 REV B1

TE TE Connectivity

REVISIONS				
P	LTN	DESCRIPTION	DATE	APVD
-		SEE SHEET 1	-	-

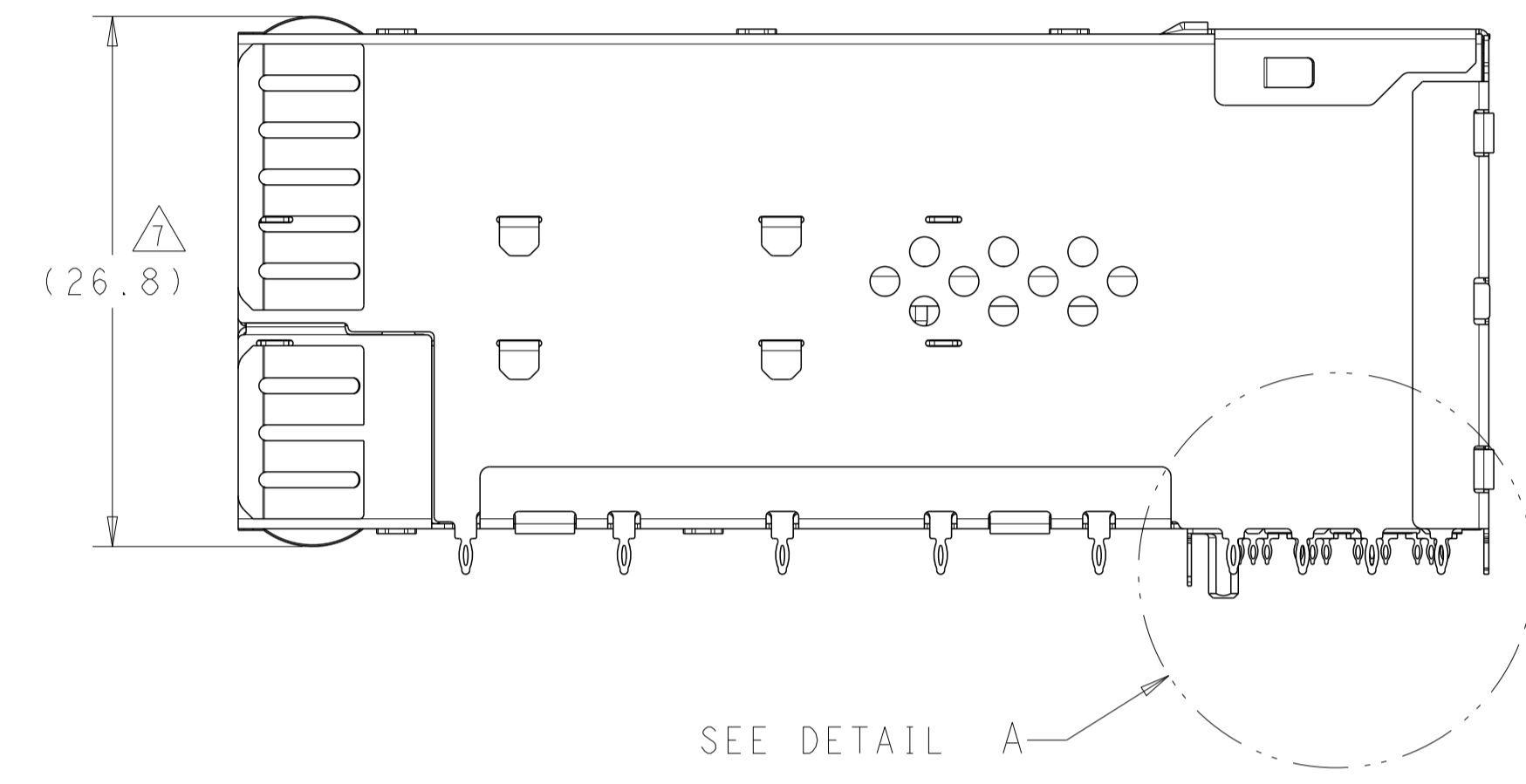
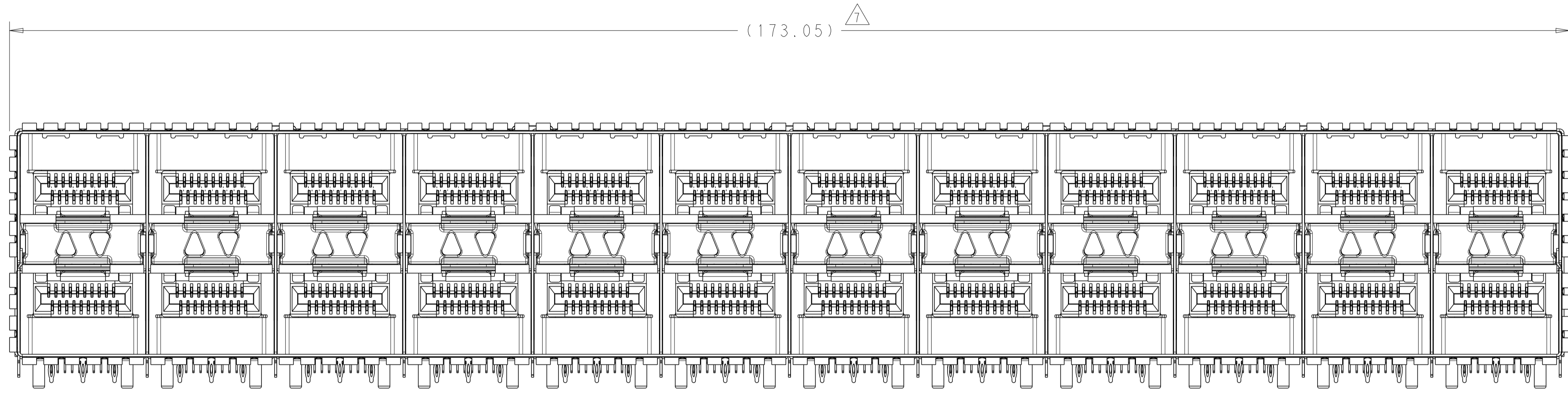

2288172-7
EMI SPRINGS ONLY
SCALE 3:1

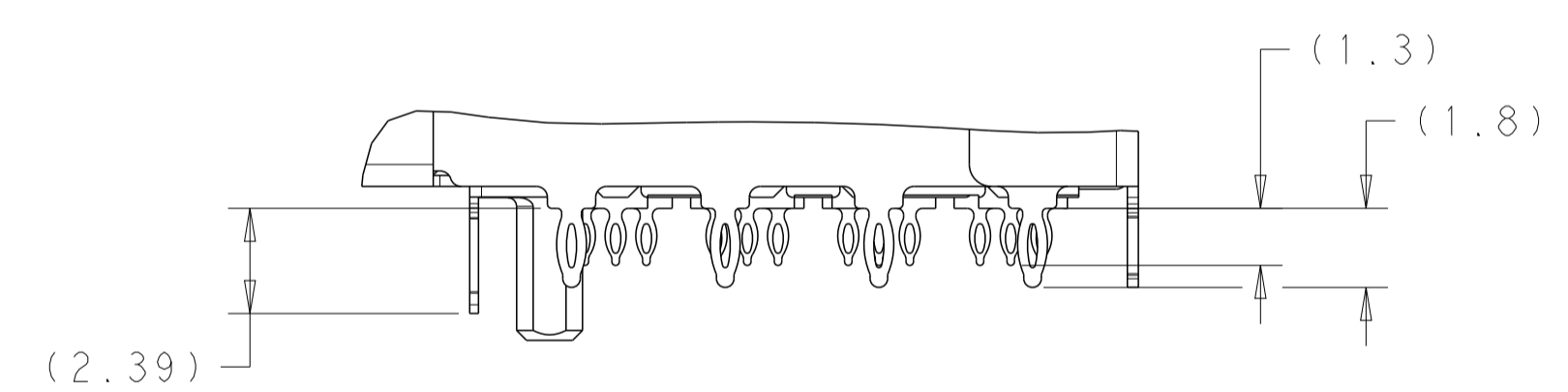
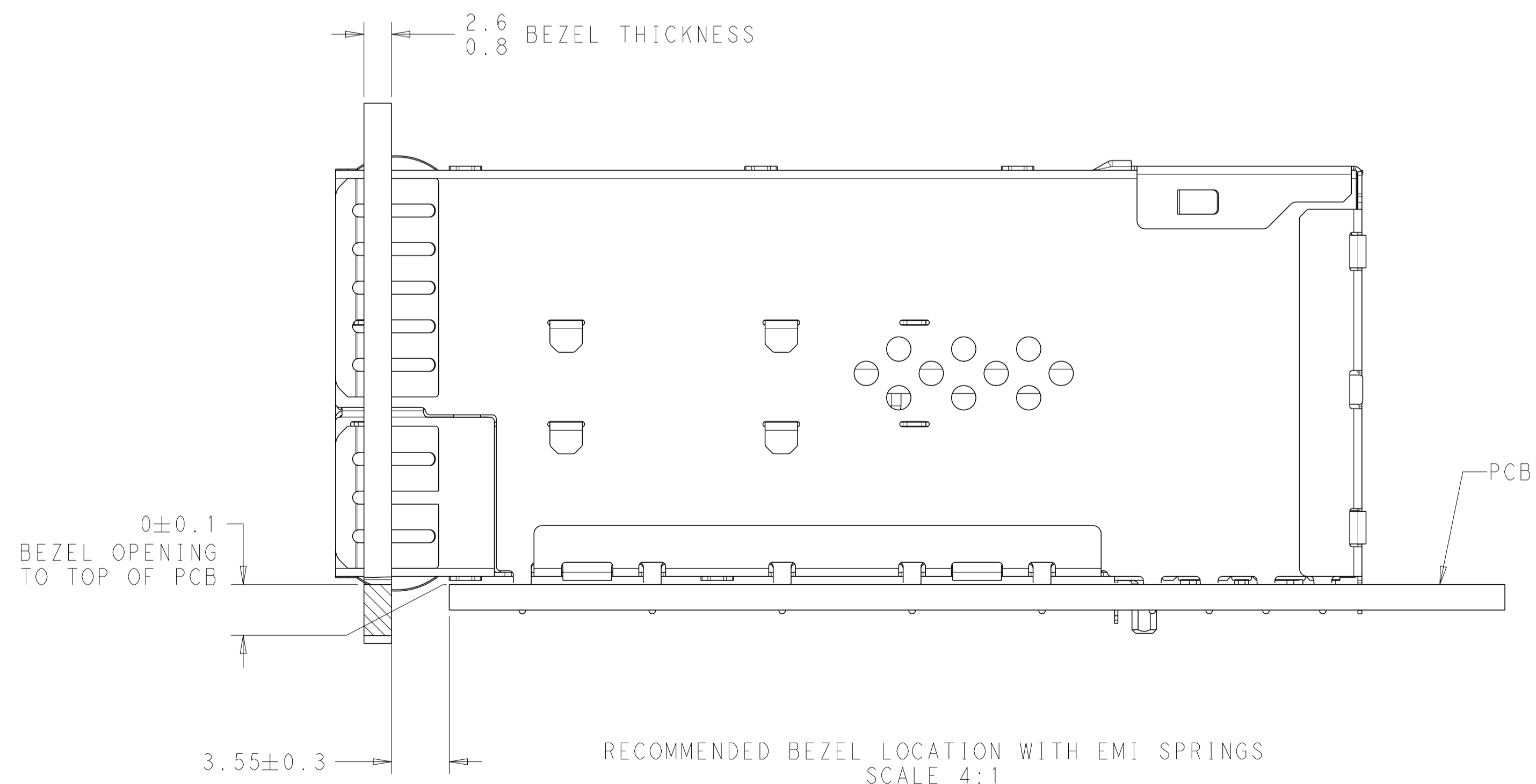

DETAIL A
SCALE 6:1

THIS DRAWING IS A CONTROLLED DOCUMENT.		DWN: M. SHIRK 26JAN2015 CHK: P. RECCE 26JAN2015 APVD: -	
DIMENSIONS: mm	TOLERANCES UNLESS OTHERWISE SPECIFIED: 0 PLC ±0.10 1 PLC ±0.10 2 PLC ±0.10 3 PLC ±0.10 4 PLC ±0.10 ANGLES ±°	NAME: RECEPTACLE ASSEMBLY, 2X12, STACKED, zSFP+ PRODUCT SPEC: 108-2431 APPLICATION SPEC: 114-13319	
MATERIAL: - FINISH: - SEE NOTES	WEIGHT: - SEE NOTES	SIZE: A 00779 C=2288172 CUSTOMER DRAWING	RESTRICTED TO: - SCALE: 2:1 SHEET 2 OF 5 REV: B1

REVISIONS				
P	LTN	DESCRIPTION	DATE	APVD
-		SEE SHEET 1	-	-

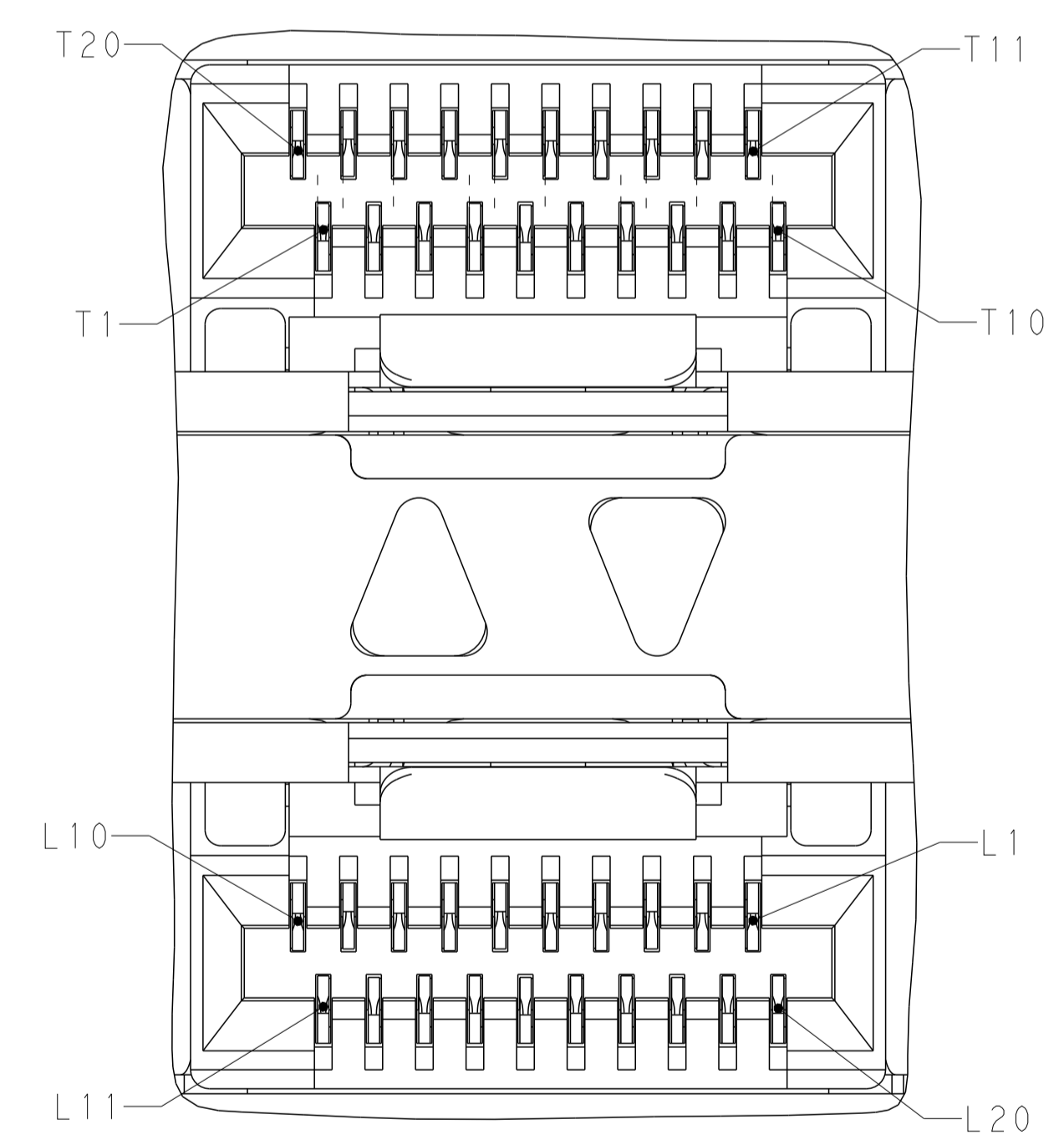
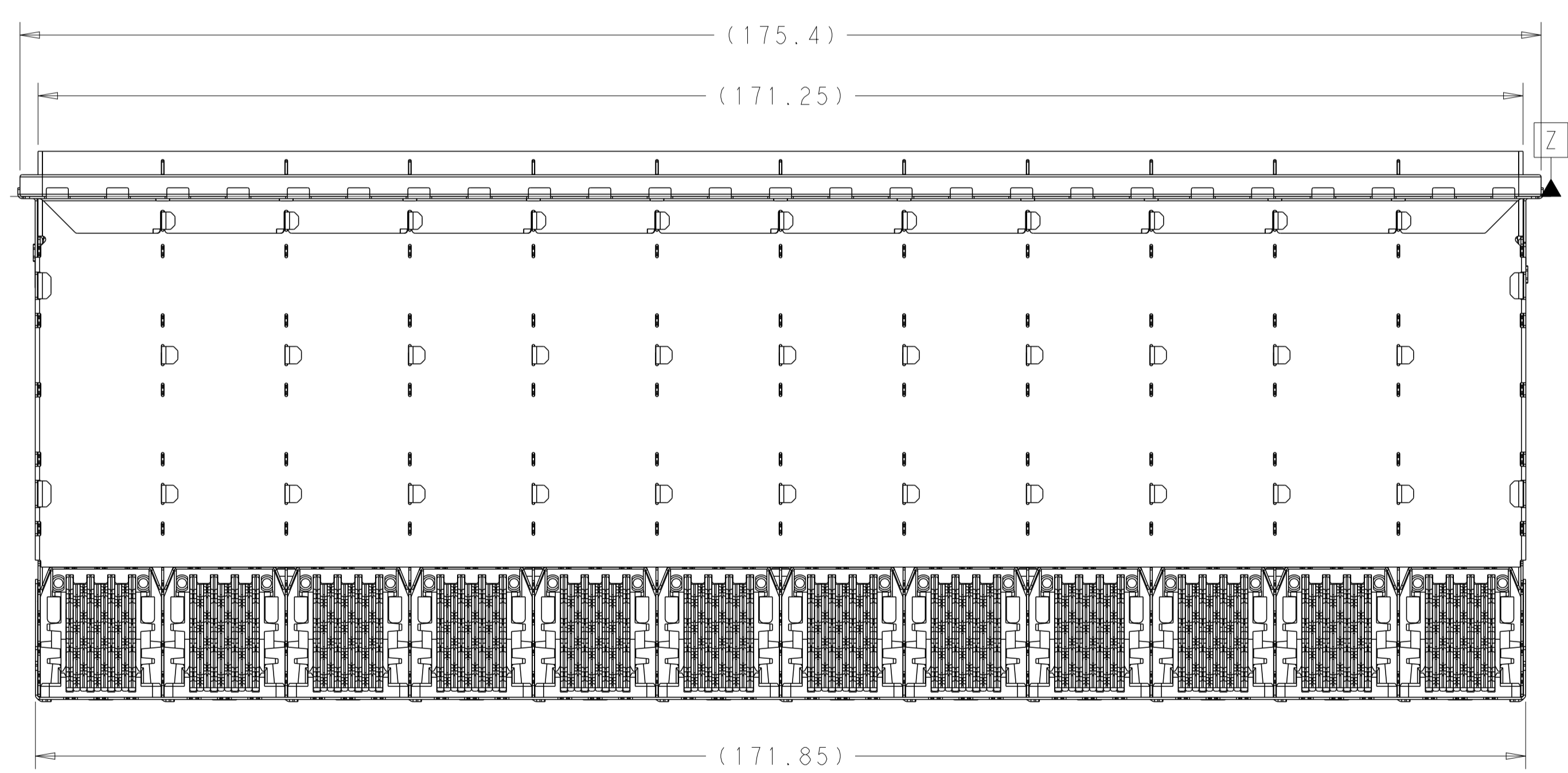
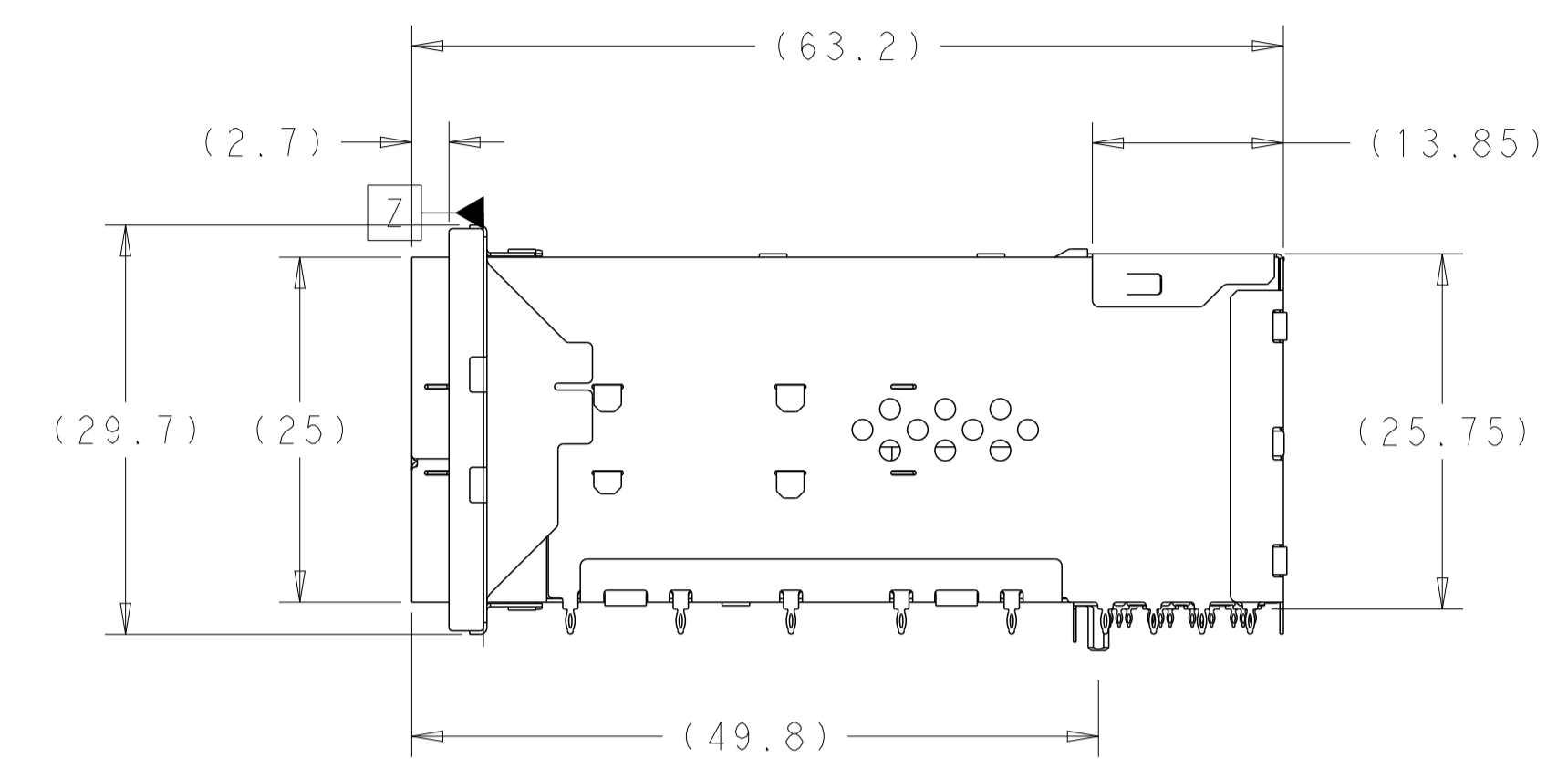
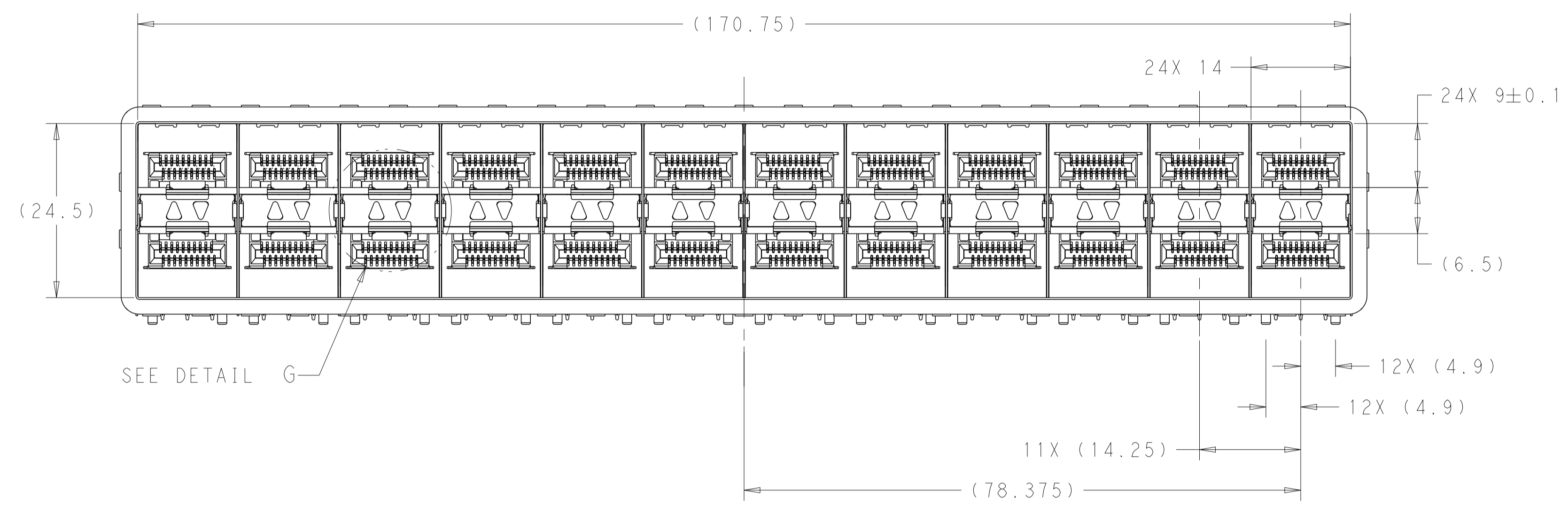

DETAIL G
12X INDIVIDUALLY
SCALE 10:1

THIS DRAWING IS A CONTROLLED DOCUMENT. DIMENSIONING AND TOLERANCING PER: ASME Y14.5M-2009		DWN: M. SHIRK 26 JAN 2015 CHK: P. RECCE 26 JAN 2015 APVD: -	
DIMENSIONS: mm 	TOLERANCES UNLESS OTHERWISE SPECIFIED: 0 PLC ±0.10 1 PLC ±0.10 2 PLC ±0.10 3 PLC ±0.10 4 PLC ±0.10 ANGLES ±° FINISH ±	PRODUCT SPEC: 108-2431 APPLICATION SPEC: 114-13319 WEIGHT: - CUSTOMER DRAWING	

REVISIONS				
P.	LTN.	DESCRIPTION	DATE	APVD.
-	-	SEE SHEET 1	-	-

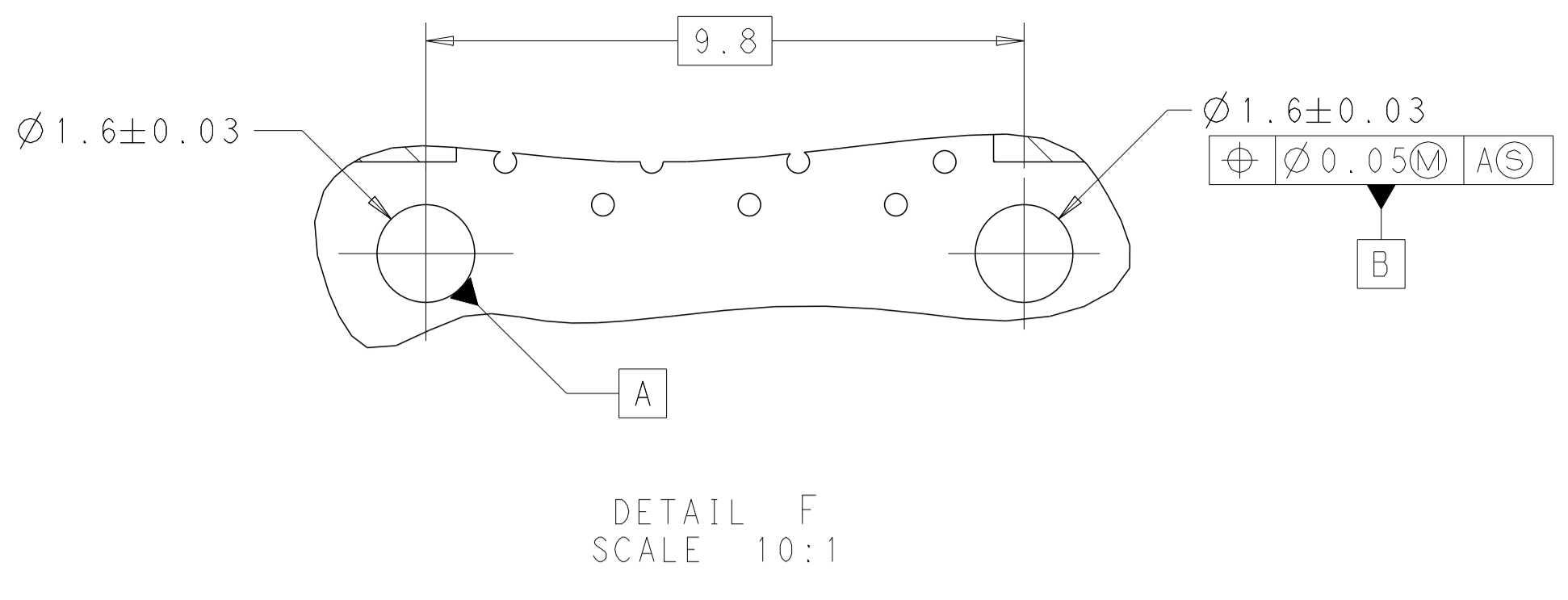
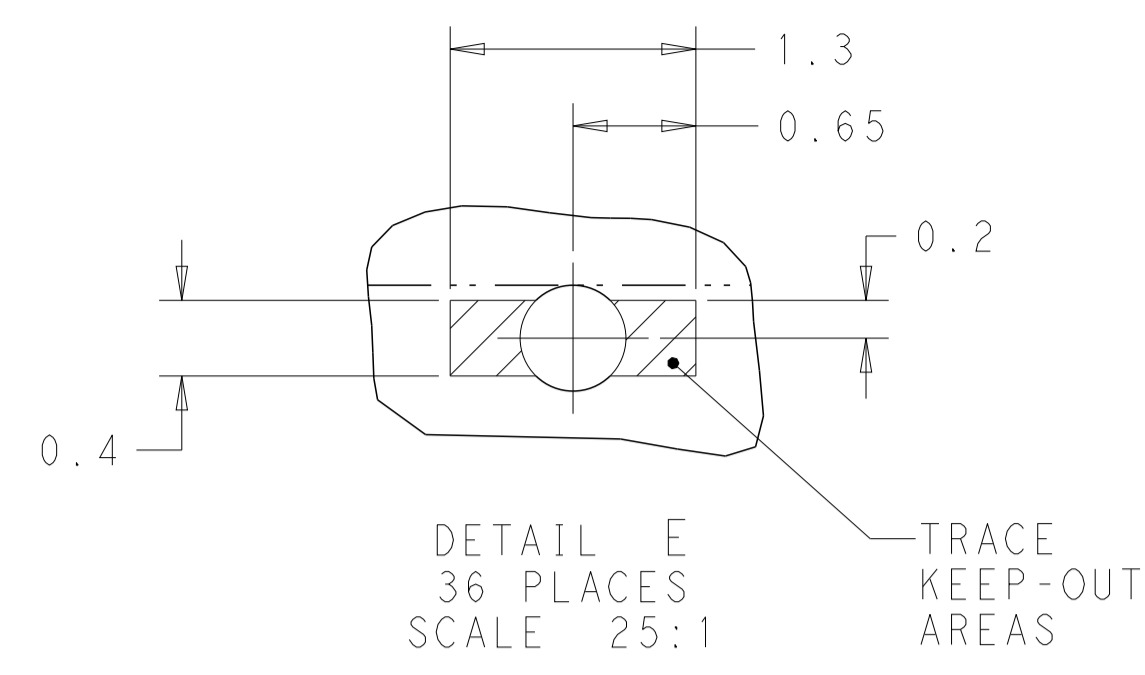

THIS DRAWING IS A CONTROLLED DOCUMENT. DIMENSIONING AND TOLERANCING PER ASME Y14.5M-2009.		DWN: M. SHIRK 26 JAN 2015 CHK: P. RECCE 26 JAN 2015 APVD: -	TE Connectivity	
DIMENSIONS: mm	TOLERANCES UNLESS OTHERWISE SPECIFIED:	PRODUCT SPEC	NAME: RECEPTACLE ASSEMBLY, 2X12, STACKED, zSFP+	
0 PLC ±0.10	1 PLC ±0.10	108-2431	SIZE: CAGE CODE DRAWING NO. RESTRICTED TO	
2 PLC ±0.10	3 PLC ±0.10	APPLICATION SPEC	A 00779 C=2288172	
4 PLC ±0.10	ANGLES ±°	114-13319	SCALE 2:1 SHEET 4 OF 5 REV B1	
MATERIAL: SEE NOTES	FINISH: SEE NOTES	WEIGHT: -	CUSTOMER DRAWING	

REVISIONS				
P	LTN	DESCRIPTION	DATE	APVD
-	-	SEE SHEET 1	-	-

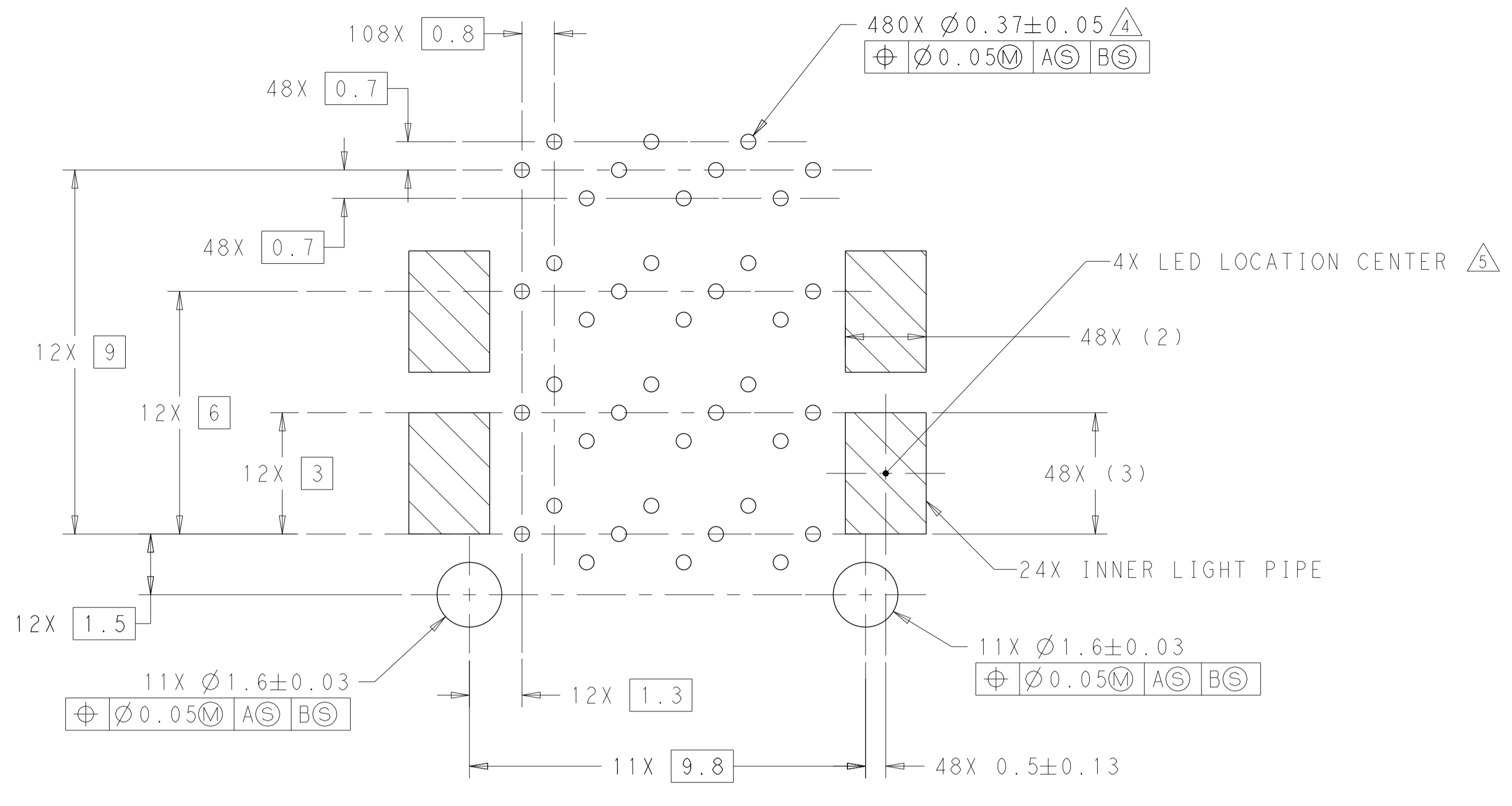

DETAIL C
RECOMMENDED PIN AND LIGHT PIPE LAYOUT
SCALE 10:1

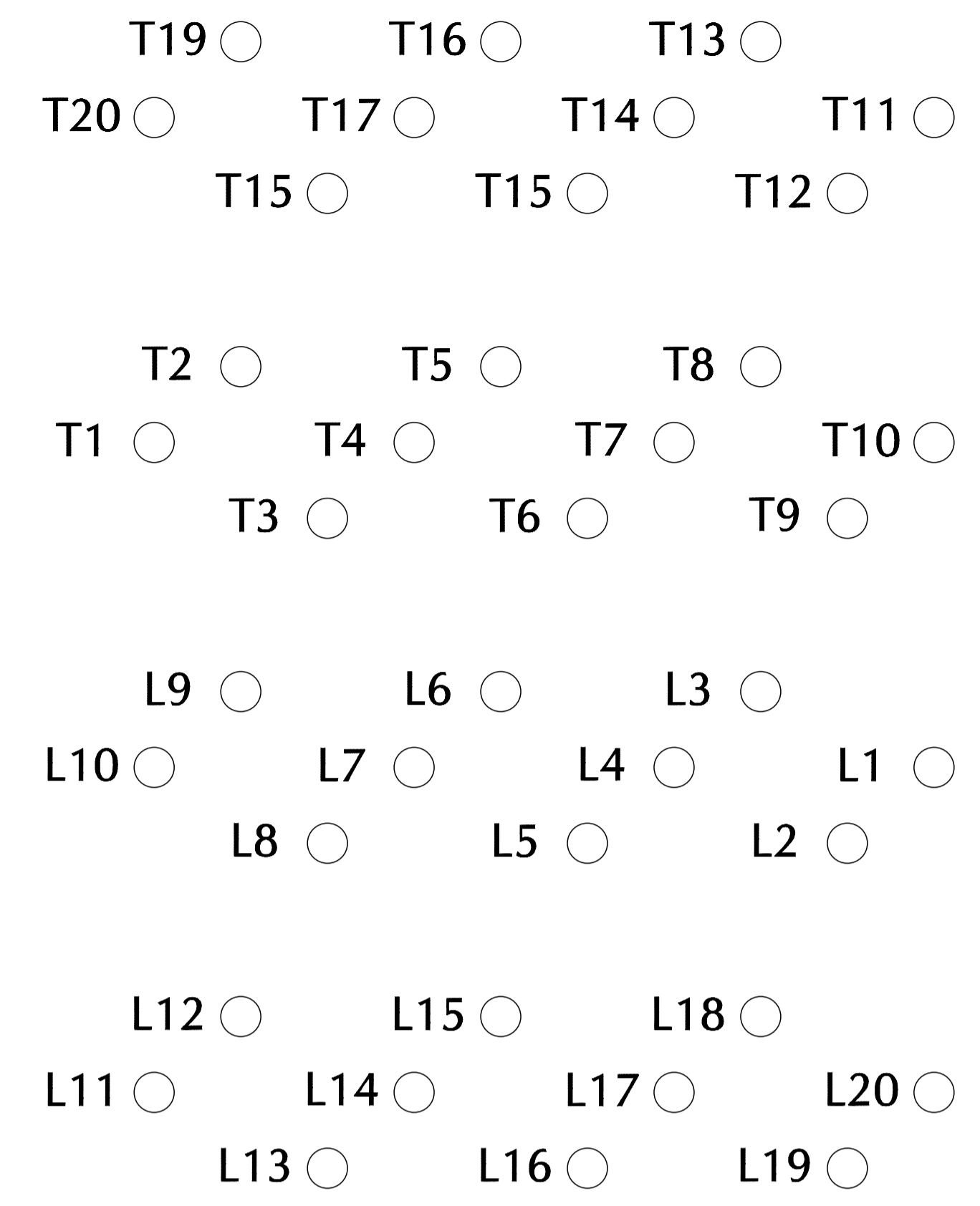

PIN MAP LEGEND	
PIN NUMBER	FUNCTION
L1/T1	VEET
L2/T2	TX-FAULT
L3/T3	TX-DISABLE
L4/T4	SDA
L5/T5	SCL
L6/T6	MOD_ABS
L7/T7	RS0
L8/T8	RX_LOS
L9/T9	RS1
L10/T10	VEER
L11/T11	VEER
L12/T12	RD-
L13/T13	RD+
L14/T14	VEER
L15/T15	VCCR
L16/T16	VCCT
L17/T17	VEET
L18/T18	TD+
L19/T19	TD-
L20/T20	VEET

DETAIL D
PIN MAP
12 PLACES
SCALE 20:1

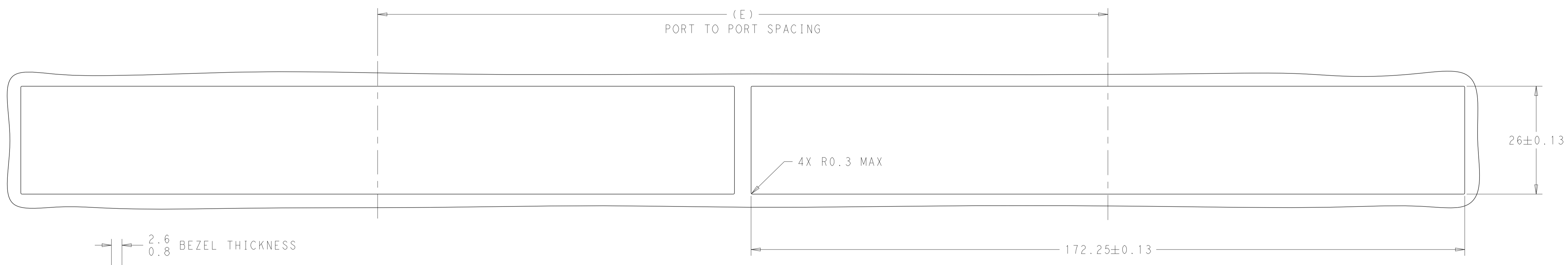

RECOMMENDED BEZEL CUT OUT DETAIL

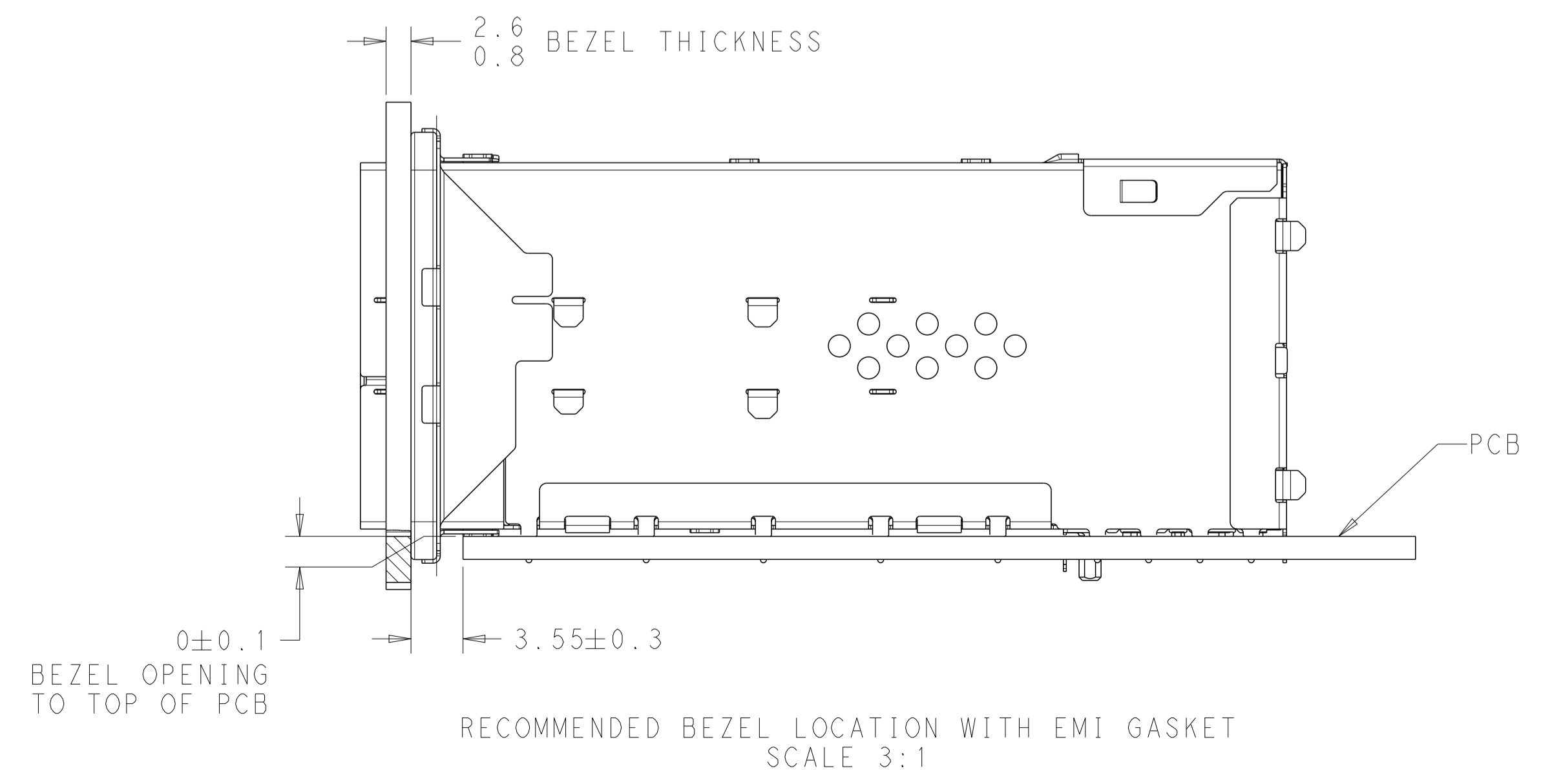

RECOMMENDED BEZEL LOCATION WITH EMI GASKET
SCALE 3:1

THIS DRAWING IS A CONTROLLED DOCUMENT. DIMENSIONING AND TOLERANCING PER ASME Y14.5M-2009.		DWN: M. SHIRK 26JAN2015 CHK: P. RECCE 26JAN2015 APVD:		NAME: RECEPTACLE ASSEMBLY, 2X12, STACKED, zSFP+
DIMENSIONS: mm TOLERANCES UNLESS OTHERWISE SPECIFIED: 0 PLC ±0.10 1 PLC ±0.10 2 PLC ±0.10 3 PLC ±0.10 4 PLC ±0.10 ANGLES ±°	PRODUCT SPEC: 108-2431 APPLICATION SPEC: 114-13319	SIZE: A 00779 C=2288172 WEIGHT:		RESTRICTED TO:
MATERIAL: SEE NOTES		CUSTOMER DRAWING		SCALE: 2:1 SHEET 5 OF 5 REV: B1