

Feb.1.2026 Copyright 2026 HIROSE ELECTRIC CO., LTD. All Rights Reserved.  
In case of consideration for using Automotive equipment / device which demand high reliability, kindly contact our sales window correspondents.

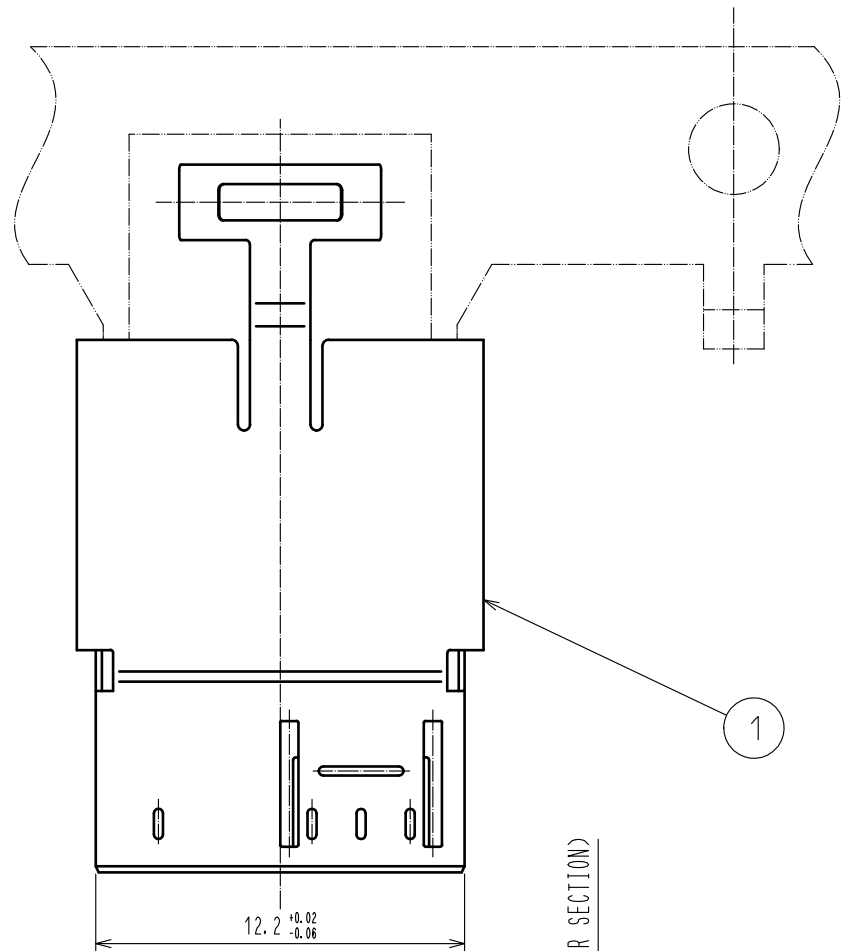

1 Fig-1 DRAWING FOR PACKING (FREE)

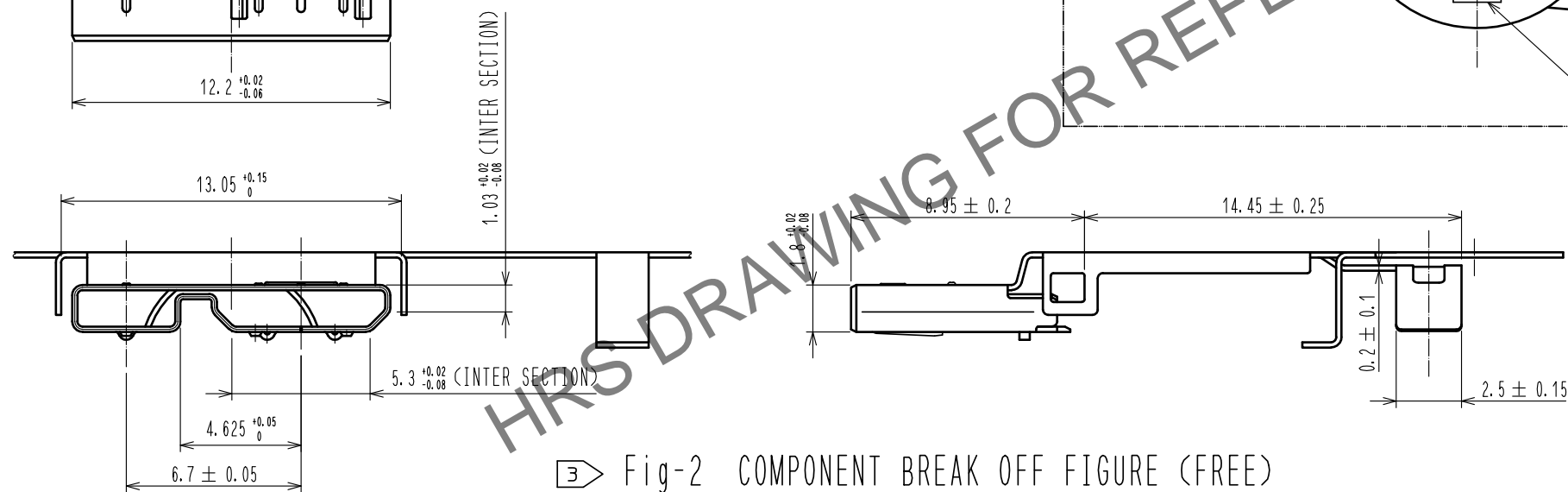
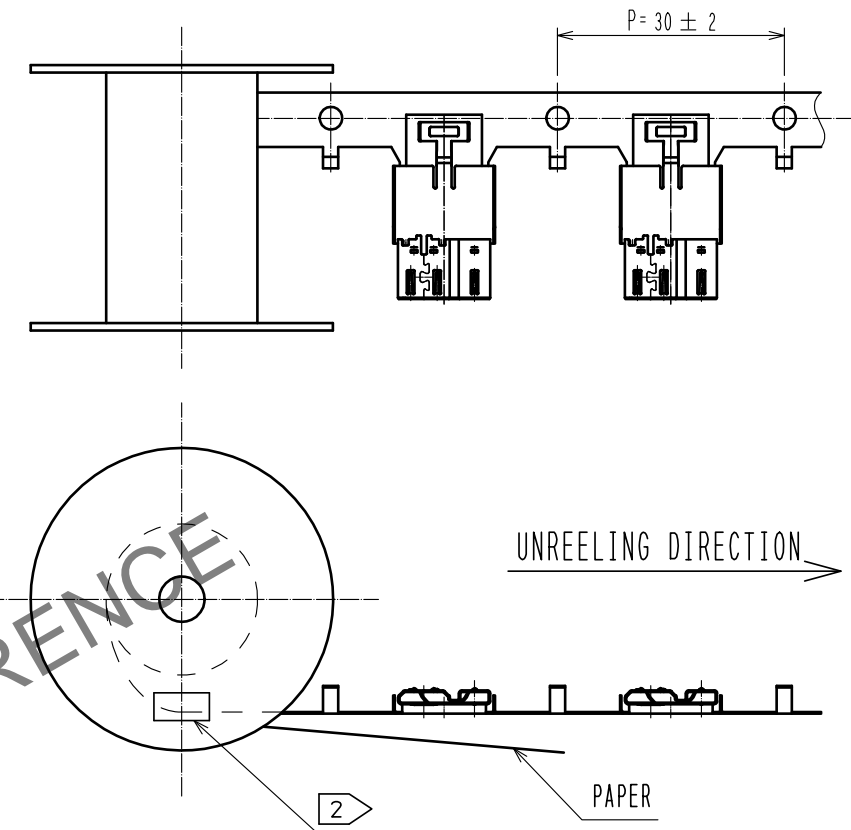

3 Fig-2 COMPONENT BREAK OFF FIGURE (FREE)

3
Halogen-Free
Lead Free Process
RoHS Compliant

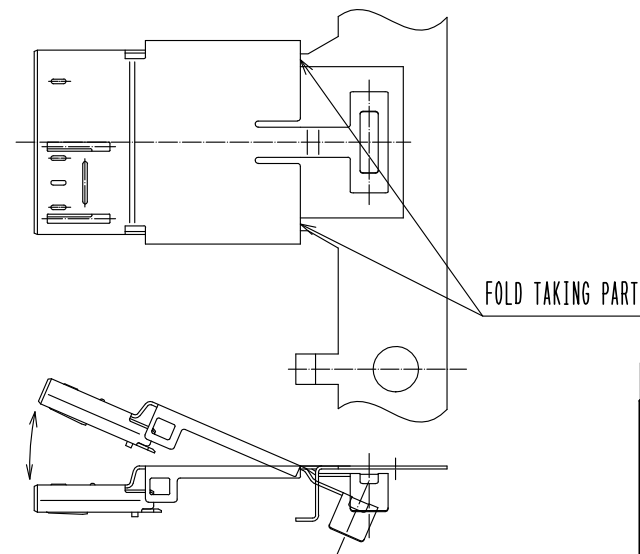
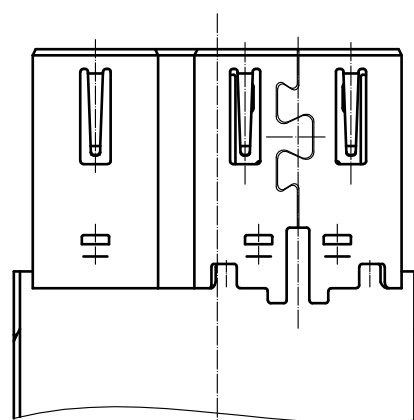

- NOTE 1 THIS IS DELIVERED BY A REEL. QTY : 2700 PCS.  
2 INDICATE 'Part No.', 'CL No.', 'Lot No.', AND QUANTITY ON BOTH REEL AND THE SIDE SURFACE OF THE SHIPPING OUTER BOX.  
3 REMOVE THE COMPONENT FROM THE CARRIER FOR USE AS SHOWN IN Fig.2.

NO.		MATERIAL		FINISH . REMARKS		1	STAINLESS STEEL	NICKEL PLATING 0.1μm min
UNITS		SCALE		COUNT		DESCRIPTION OF REVISIONS		DESIGNED
mm		4 : 1		1		DIS-E-00001801		Y.S. SAKODA
HRS		HIROSE ELECTRIC CO., LTD.		APPROVED : A.O. SUZUKI		20100807	DRAWING NO.	
				CHECKED : KN. ICHIKAWA		20100807	PART NO.	
				DESIGNED : TY. MIURA		20100806	CODE NO.	
				DRAWN : TY. MIURA		20100806	CL242-0502-7-00	
							EDC-127030-00-00	
							ZX360-B-SLDA	
							1/1	