

Special



Image for illustrative purpose only

Summary

[Request a quote](#)

[Catalog](#)

High Power	1
Wire Size/AWG	4 - 4
Gender	Reverse Gender
Socket / Receptacle	Socket / Receptacle - Free
Locking system	Ratchet
Size	4M
Series	M - Rugged Ratchet coupling

https://www.lemo.com/int_en/solutions/optima/m-ratchet-coupling/pmx-4m-h16-xlct.html

LEMO products and services are provided “as is”. LEMO makes no warranties or representations with regard to LEMO product & services or use of them, express, implied or statutory, including for accuracy, completeness, or security. The user is fully responsible for his products and applications using LEMO components.

Technical details

Electrical Configuration

High Power	1
Contact Termination High Power	Crimp
Insert configuration value	4M.H16 - 1 High Power (6 mm)
Insulator	L: PEEK
Rated current	138 A
Test voltage contact-shell	4.4 kV rms
Wire Size/AWG	4 - 4
Gender	Reverse Gender

Form & Material

Shell style / Model id	PM - Free receptacle with knurled grip and mold stop
Socket / Receptacle	Free
Housing material	Aluminium (nickel plated [SAE AMS QQ N 290], anthracite color) shell and nut, other pieces bronze/brass
Locking system	Ratchet
Keying	X: 5 keys (alpha=100, beta=125, gamma=40, delta=20, plug: female contacts, receptacle: male contacts)
Colour	Grey
Weight	26.87 g

Environment

Technical domain	Motorsport, Security and Defence, Transportation, Aerospace and UAV
Environmental sealing (IP rating)	IP68
Temperature range	-20°C / +200°C (max. temperature valid for short periods of use.)
EMI Shielding EIA 364-66A	>= 80 dB (1 GHz), >=70 dB (3 GHz), >= 58 dB (6 GHz), >= 40 dB (10 GHz)
Gunfire vibration	25 Hz - 2000 Hz, 3 axis (Apache helicopter)
Humidity (max)	21 days at 95%
Lighting strike EIA 364-76	10K amps - 6 times
Shock Resistance	300 g [3 ms]
Thermal shock	5 cycles: -65°C to +150°C
Vibration-Random	37.8 g rms - 3 axes, 4 hr amb [50 Hz - 2000 Hz]
Vibration-Sine	30 g, 3 axes, 12 hr [10 Hz - 2000 Hz]
Salt Spray Corrosion	max. 48 hr

https://www.lemo.com/int_en/solutions/optima/m-ratchet-coupling/pmx-4m-h16-xlct.html

LEMO products and services are provided "as is". LEMO makes no warranties or representations with regard to LEMO product & services or use of them, express, implied or statutory, including for accuracy, completeness, or security. The user is fully responsible for his products and applications using LEMO components.

Cable fixation

Cable termination protection

For overmolding

Fixation type

Mold stop (overmolding)

Drawings

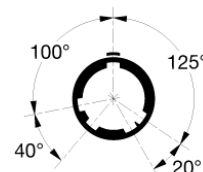
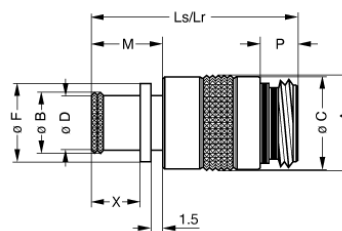
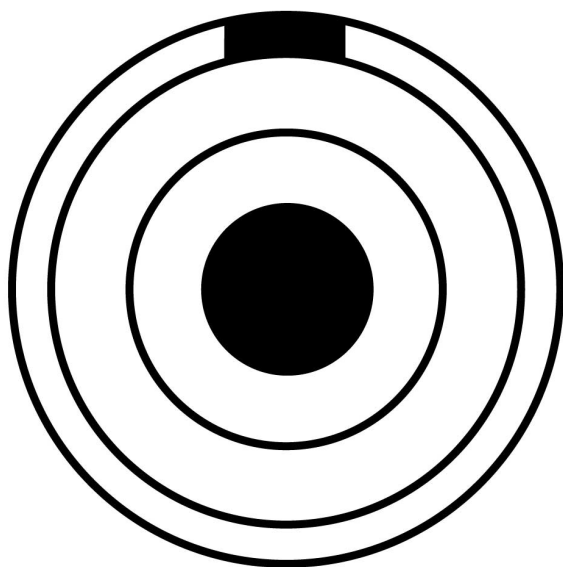

Dimensions

	A	B	C	D	F	Ls	Lr	M	P	X
mm.	25	20.7	24.5	19.5	22.6	31.2	31.2	10.6	7.9	7.6
in.	0.98	0.81	0.96	0.77	0.89	1.23	1.23	0.42	0.31	0.3

Recommended By Lemo

Accessories

Compatible cap

[BMF.4M.200.XAZ](#)

Tools

Extraction tool

[DCC.91.64H.PLC](#)

https://www.lemo.com/int_en/solutions/optima/m-ratchet-coupling/pmx-4m-h16-xlct.html

LEMO products and services are provided "as is". LEMO makes no warranties or representations with regard to LEMO product & services or use of them, express, implied or statutory, including for accuracy, completeness, or security. The user is fully responsible for his products and applications using LEMO components.