



Image for illustrative purpose only

Summary

[Request a quote](#)

[P series catalog](#)

Number of contacts Low Voltage	2
Gender	Standard
Socket / Receptacle	Socket / Receptacle - Fixed Panel Rear Mounted
Locking system	Push-pull
Size	1P
Series	REDEL P - Push-Pull

https://www.lemo.com/int_en/solutions/redel/redel-p-push-pull/pka-m0-2sl-vn.html

LEMO products and services are provided "as is". LEMO makes no warranties or representations with regard to LEMO product & services or use of them, express, implied or statutory, including for accuracy, completeness, or security. The user is fully responsible for his products and applications using LEMO components.

Technical details

Electrical Configuration

Number of contacts Low Voltage	2
Contact Termination Low voltage	PCB - Elbow
R (max)	3.5 mOhm
Insert configuration value	1P.M02 - 2 Low Voltage
Footprint IPC Class3 compatibility	Yes
Class3 Productibility Level Compatibility	A (General Design Producibility - Preferred)
Insulator	L: PEEK (UL 94 / V-0/1.5)
Rated current	10 A
Test voltage contact-contact	1.7 (kV DC)
Air clearance	1.3 mm
Creepage distance	1.3 mm
Contact Dia.	1.3 mm (0.0512in)
Gender	Standard

Form & Material

Shell style / Model id	PK - Fixed receptacle with two nuts (back panel mounting), 90° print contacts
Socket / Receptacle	Fixed Panel Rear Mounted
Housing material	PEI (Polyetherimide), grey
Locking system	Push-pull
Keying	A: 2 keys (alpha=40, Plug: male contacts, Receptacle: female contacts)
Colour	Grey - Black
Variant	Black front nut
Weight	4.94 g

https://www.lemo.com/int_en/solutions/redel/redel-p-push-pull/pka-m0-2sl-vn.html

LEMO products and services are provided "as is". LEMO makes no warranties or representations with regard to LEMO product & services or use of them, express, implied or statutory, including for accuracy, completeness, or security. The user is fully responsible for his products and applications using LEMO components.

Environment

Technical domain	Energy and Industrial, Medical, Test and Measurement, Transportation, Aerospace and UAV
Environmental sealing (IP rating)	IP50
Endurance	> 5000 mating cycles
Temperature range	-50°C / +170°C
F ret (max)	150 N
F ret (min)	50 N
Steam sterilization	Compiles with ISO 17665:2024 sterilization standard for autoclave, ISO 11135:2014 for EtO, and ISO 11137-1, -2, -3 standards for gamma, e-beam x-ray. For more details on sterilization methods and cycles, please contact us.

Drawings

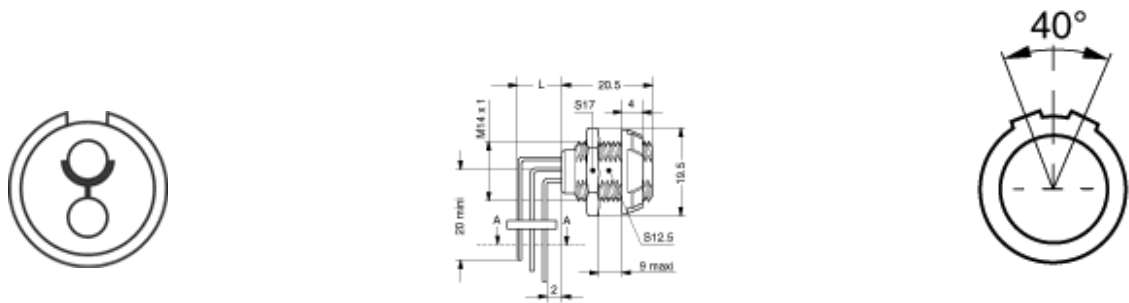

Dimensions

	A	L	N
mm.	19.5	5.2-12.9	20.5
in.	0.77		0.81

Recommended By Lemo

Accessories	
Compatible cap	PBG.200.BMV
Tools	
Spanner	POB.186.GN

Documents

PCB	Download
PCB Eagle	Download
Kicad	Download
PCB Altium	Download