

Special



Image for illustrative purpose only

Summary

[Request a quote](#)

SE series

Size	4S
------	----

Series	S - Indoor Stepped Insert
--------	---------------------------

https://www.lemo.com/int_en/solutions/originals/s-indoor-stepped-insert/gra-4s-269-ga.html

LEMO products and services are provided "as is". LEMO makes no warranties or representations with regard to LEMO product & services or use of them, express, implied or statutory, including for accuracy, completeness, or security. The user is fully responsible for his products and applications using LEMO components.

Technical details

Form & Material

Shell style / Model id	GRA - Insulating washer
Housing material	Polyamide, blue
Keying	No keying
Weight	0.68 g

Environment

Technical domain	Audio Video, Energy and Industrial, Semiconductor, Test and Measurement
Environmental sealing (IP rating)	No IP rating
Temperature range	-40°C / +90°C
Climatic Category	55/175/21
Humidity (max)	<=95% [at 60 deg C /140 F]
Shielding (min)	75 dB (10 MHz)
Shielding (min)	40 dB (1 GHz)
Shock Resistance	100 g [6 ms]
Vibration	15 g [10 Hz - 2000 Hz]

Drawings

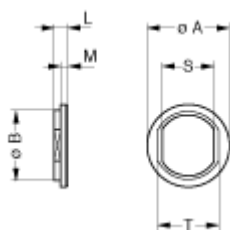

No keying

Dimensions

	A	B	L	M	S	T
mm.	31.9	28.7	2.5	1.5	23.6	27.1
in.	1.26	1.13	0.1	0.06	0.93	1.07

https://www.lemo.com/int_en/solutions/originals/s-indoor-stepped-insert/gra-4s-269-ga.html

LEMO products and services are provided "as is". LEMO makes no warranties or representations with regard to LEMO product & services or use of them, express, implied or statutory, including for accuracy, completeness, or security. The user is fully responsible for his products and applications using LEMO components.