

Standard



Image for illustrative purpose only

Summary

[Request a quote](#)

[Catalog](#)

Size

00

https://www.lemo.com/int_en/gra-00-269-gg.html

LEMO products and services are provided "as is". LEMO makes no warranties or representations with regard to LEMO product & services or use of them, express, implied or statutory, including for accuracy, completeness, or security. The user is fully responsible for his products and applications using LEMO components.

Technical details

Form & Material

Shell style / Model id	GRA - Insulating washer
Housing material	Polyamide, grey
Keying	No keying
Weight	0.06 g

Environment

Environmental sealing (IP rating)	No IP rating
Temperature range	-40°C / +90°C

Drawings

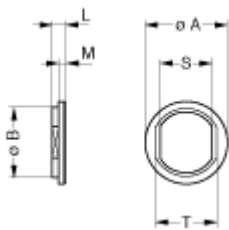

No keying

Dimensions

	A	B	L	M	S	T
mm.	10	8.8	1.8	1	6.4	8
in.	0.39	0.35	0.07	0.04	0.25	0.31