

Standard



*Image for illustrative purpose only*

## Summary

[Request a quote](#)

[Catalog](#)

Size

00

[https://www.lemo.com/int\\_en/gea-00-240-ln.html](https://www.lemo.com/int_en/gea-00-240-ln.html)

LEMO products and services are provided "as is". LEMO makes no warranties or representations with regard to LEMO product & services or use of them, express, implied or statutory, including for accuracy, completeness, or security. The user is fully responsible for his products and applications using LEMO components.

# Technical details

## Form & Material

Shell style / Model id	GEA - Hexagonal nuts
Housing material	Aluminum alloy (anodized) shell and collet nut, nickel plated [SAE AMS QQ N 290] brass latch sleeve and mid pieces
Keying	No keying
Weight	0.53 g

## Environment

Environmental sealing (IP rating)	No IP rating
-----------------------------------	--------------

# Drawings

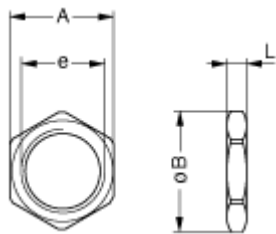

No keying

## Dimensions

	A	B	e	L
mm.	9	10.2	M7x0.5	2
in.	0.35	0.4		0.08

[https://www.lemo.com/int\\_en/gea-00-240-ln.html](https://www.lemo.com/int_en/gea-00-240-ln.html)

LEMO products and services are provided “as is”. LEMO makes no warranties or representations with regard to LEMO product & services or use of them, express, implied or statutory, including for accuracy, completeness, or security. The user is fully responsible for his products and applications using LEMO components.