



Image for illustrative purpose only

Summary

[Request a quote](#)

[P series catalog](#)

Number of contacts Low Voltage	12
Wire Size/AWG	30 - 22
Gender	Standard
Socket / Receptacle	Socket / Receptacle - Fixed Panel Rear Mounted
Locking system	Push-pull
Size	2P
Series	REDEL P - Push-Pull

https://www.lemo.com/int_en/solutions/redel/redel-p-push-pull/ckc-m12-gymg.html

LEMO products and services are provided "as is". LEMO makes no warranties or representations with regard to LEMO product & services or use of them, express, implied or statutory, including for accuracy, completeness, or security. The user is fully responsible for his products and applications using LEMO components.

Technical details

Electrical Configuration

Number of contacts Low Voltage	12
Contact Termination Low voltage	Crimp
Insert configuration value	2P.M12 - 12 Low V.
Insulator	Y: PEEK for crimp contacts
Rated current	7 A
Test voltage contact-contact	1.77 (kV DC)
Air clearance	0.85 mm
Creepage distance	0.85 mm
Bucket Dia.	0.8
Contact Dia.	0.7
Wire Size/AWG	30 - 22
Gender	Standard

Form & Material

Shell style / Model id	CK - Fixed receptacle with two nuts (back panel mounting)
Socket / Receptacle	Fixed Panel Rear Mounted
Housing material	PSU (Polysulfone), grey
Locking system	Push-pull
Keying	C: 3 keys (alpha=0, gamma=100, Plug: male contacts, Receptacle: female contacts)
Colour	Grey
Weight	6.1 g

https://www.lemo.com/int_en/solutions/redel/redel-p-push-pull/ckc-m12-gymg.html

LEMO products and services are provided "as is". LEMO makes no warranties or representations with regard to LEMO product & services or use of them, express, implied or statutory, including for accuracy, completeness, or security. The user is fully responsible for his products and applications using LEMO components.

Environment

Technical domain	Energy and Industrial, Medical, Test and Measurement, Transportation, Aerospace and UAV
Environmental sealing (IP rating)	IP50
Endurance	>5000 mating cycles
Temperature range	-50°C / +150°C
F ret (max)	250 N
F ret (min)	150 N
Steam sterilization	Compiles with ISO 17665:2024 sterilization standard for autoclave, ISO 11135:2014 for EtO, and ISO 11137-1, -2, -3 standards for gamma, e-beam x-ray. For more details on sterilization methods and cycles, please contact us.

Drawings

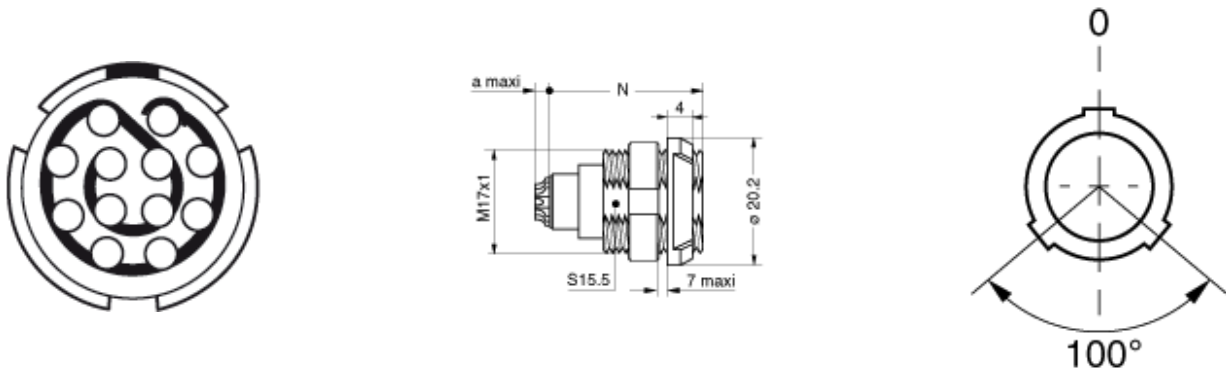

Dimensions

	N
mm.	25.1
in.	0.99

Recommended By Lemo

Accessories	
Replacement contact	EGG.2B.655.ZZM

Tools

Spanner	COP.155.GN
Positionner	DCE.91.072.BVM
Extraction tool	DCC.07.04B.LAG
Crimp tool	DPC.91.701.V

https://www.lemo.com/int_en/solutions/redel/redel-p-push-pull/ckc-m12-gymg.html

LEMO products and services are provided "as is". LEMO makes no warranties or representations with regard to LEMO product & services or use of them, express, implied or statutory, including for accuracy, completeness, or security. The user is fully responsible for his products and applications using LEMO components.