



7/16 DIN Male Precision Calibration Kit Component Open Operating from DC to 7.5 GHz

Calibration Kits Components Technical Data Sheet

PE5SC3032

Features

- Precision Controlled Impedance
- Controlled Electrical Length
- Published Calibration Coefficients
- Replaces Existing Calibrating Kit Components
- Serial Numbers on Shorts, Opens and Loads
- In Stock and Ready to Ship

Applications

- Vector Network Analyzer Calibration
- SOLT or OSLT Calibration
- Device Characterization
- De-embedding
- Precision Calibrating Kits

Description

Pasternack's PE5SC3032 7/16 DIN male precision open circuit is part of our full line of RF components available for same-day shipping. This 7/16 DIN, precision open circuit is suitable for calibrating on most network and site analyzers. Calibration coefficients for this 7/16 DIN open circuit are included in the datasheet and can be keyed in to most VNAs to provide a replacement for your broken or misplaced component. The controlled impedance and electrical length of this component support calibrations through the entire frequency range of the precision connector interface.

Our 7/16 DIN male precision open circuit datasheet, specifications and drawing with dimensions are shown below in this PDF. Pasternack's broad catalog of RF, microwave and millimeter wave components allow designers to configure and customize their test solutions however they like. Whether the need is to provide precise SOLT / OSLT network analyzer calibrations or calibration kit replacement, Pasternack can ship you the right components same day.

Electrical Specifications

Description	Minimum	Typical	Maximum	Units
Frequency Range	DC		7.5	GHz
Impedance		50		Ohms
Phase Accuracy			±1.25	deg
Offset Loss		0.63		GOhm/s
Electrical Delay		66.734		ps
Capacitance				
C0		32		10 ⁻¹⁵ F
C1		0		10 ⁻²⁷ F/Hz
C2		-50		10 ⁻³⁶ F/Hz ²
C3		100		10 ⁻⁴⁵ F/Hz ³

Click the following link (or enter part number in "SEARCH" on website) to obtain additional part information including price, inventory and certifications: [7/16 DIN Male Precision Calibration Kit Component Open Operating from DC to 7.5 GHz PE5SC3032](#)



7/16 DIN Male Precision Calibration Kit Component Open Operating from DC to 7.5 GHz

Calibration Kits Components Technical Data Sheet

PE5SC3032

Mechanical Specifications

Size

Length	2.31 in [58.67 mm]
Width/Diameter	1.311 in [33.3 mm]
Pin Depth	0.0682 to 0.0697 in

Connector 1

Connector Type	7/16 DIN Male
Body Material and Plating	Stainless Steel

Connector 2

Environmental Specifications

Compliance Certifications (see [product page](#) for current document)

Plotted and Other Data

Notes:

- Values at +25 °C, sea level

7/16 DIN Male Precision Calibration Kit Component Open Operating from DC to 7.5 GHz from Pasternack Enterprises has same day shipment for domestic and International orders. Our RF, microwave and millimeter wave products maintain a 99.4% availability and are part of the broadest selection in the industry.

Click the following link (or enter part number in "SEARCH" on website) to obtain additional part information including price, inventory and certifications: [7/16 DIN Male Precision Calibration Kit Component Open Operating from DC to 7.5 GHz PE5SC3032](#)

URL: <https://www.pasternack.com/7-16-din-male-calibration-kit-component-open-7.5-ghz-pe5sc3032-p.aspx>

The information contained in this document is accurate to the best of our knowledge and representative of the part described herein. It may be necessary to make modifications to the part and/or the documentation of the part, in order to implement improvements. Pasternack reserves the right to make such changes as required. Unless otherwise stated, all specifications are nominal. Pasternack does not make any representation or warranty regarding the suitability of the part described herein for any particular purpose, and Pasternack does not assume any liability arising out of the use of any part or documentation.

PE5SC3032 CAD Drawing

7/16 DIN Male Precision Calibration Kit Component Open Operating from DC to 7.5 GHz

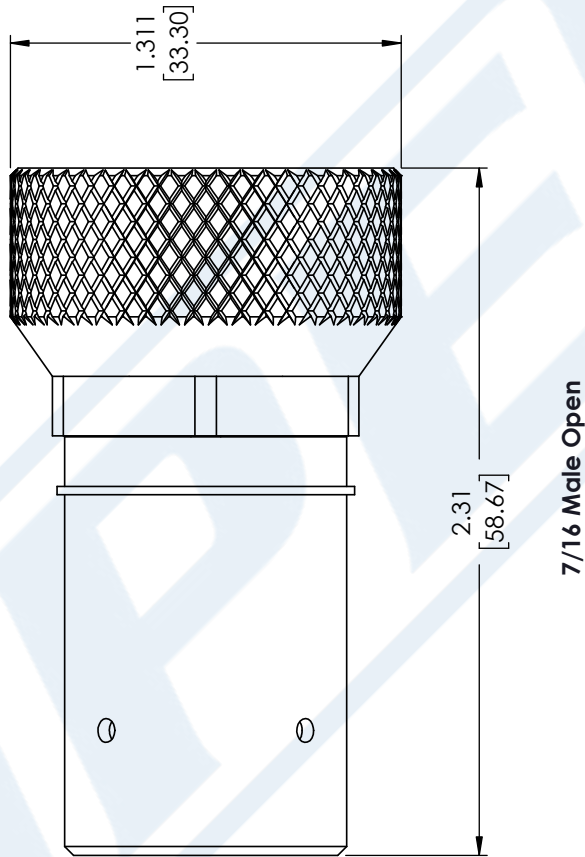

STANDARD TOLERANCES

.X ±0.2
.XX ±0.01
.XXX ±0.005

*STANDARD TOLERANCES APPLY ONLY TO DIMENSIONS IN INCHES



Pasternack Enterprises, Inc.
P.O. Box 16759 | Irvine | CA | 92623
Phone: (949) 261-1920 | Fax: (949) 261-7451
Website: www.pasternack.com | E-Mail: sales@pasternack.com

DWG TITLE

PE5SC3032

NOTES:
1. UNLESS OTHERWISE SPECIFIED ALL DIMENSIONS ARE NOMINAL.
2. ALL SPECIFICATIONS ARE SUBJECT TO CHANGE WITHOUT NOTICE AT ANY TIME.
3. DIMENSIONS ARE IN INCHES [mm].

CAGE CODE 53919

CAD FILE 01/24/2018

SCALE N/A

SIZE A

CN2245