

# XSZB130

Inductive proximity sensors XS, accessory for sensor, Ø 30 mm, fixing clamp with indexing, plastic



## Main

|                                       |  |
|---------------------------------------|--|
| Range of Product                      | Telemecanique Inductive proximity sensors XS |
| Accessory / separate part category    | Mounting and fixing accessories              |
| Accessory / Separate Part Type        | Fixing clamp                                 |
| Accessory / separate part designation | Fixing clamp                                 |
| Accessory / separate part destination | Cylindrical M30 sensor                       |
| Material                              | Plastic                                      |

## Complementary

|                       |  |
|-----------------------|--|
| Product Compatibility | XS cylindrical M30<br>XT cylindrical M30 |
| Net Weight            | 0.04 lb(US) (0.02 kg)                    |

## Ordering and shipping details

|                   |                           |
|-------------------|---------------------------|
| Category          | 22499-SENSORS ACCESSORIES |
| Discount Schedule | DS2                       |
| GTIN              | 3389110914054             |
| Returnability     | Yes                       |
| Country of origin | FR                        |

## Packing Units

|                              |                        |
|------------------------------|------------------------|
| Unit Type of Package 1       | PCE                    |
| Number of Units in Package 1 | 1                      |
| Package 1 Height             | 1.38 in (3.5 cm)       |
| Package 1 Width              | 1.57 in (4 cm)         |
| Package 1 Length             | 1.57 in (4 cm)         |
| Package 1 Weight             | 0.71 oz (20 g)         |
| Unit Type of Package 2       | S01                    |
| Number of Units in Package 2 | 50                     |
| Package 2 Height             | 5.91 in (15 cm)        |
| Package 2 Width              | 5.91 in (15 cm)        |
| Package 2 Length             | 15.75 in (40 cm)       |
| Package 2 Weight             | 2.56 lb(US) (1.162 kg) |

## Offer Sustainability

|                            |   |
|----------------------------|---|
| Sustainable offer status   | Green Premium product   |
| California proposition 65  | WARNING: This product can expose you to chemicals including: Diisononyl phthalate (DINP), which is known to the State of California to cause cancer, and Di-isodecyl phthalate (DIDP), which is known to the State of California to cause birth defects or other reproductive harm. For more information go to <a href="http://www.P65Warnings.ca.gov">www.P65Warnings.ca.gov</a> |
| REACH Regulation           | <a href="#">REACH Declaration</a>   |
| EU RoHS Directive          | Pro-active compliance (Product out of EU RoHS legal scope) <a href="#">EU RoHS Declaration</a>  |
| Mercury free               | Yes   |
| RoHS exemption information | <a href="#">Yes</a>   |
| Environmental Disclosure   | <a href="#">Product Environmental Profile</a>   |
| Circularity Profile        | <a href="#">End Of Life Information</a>   |

## Contractual warranty

|          |           |
|----------|-----------|
| Warranty | 18 months |
|----------|-----------|

Dimensions

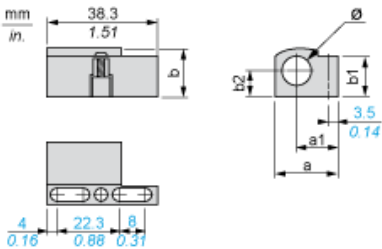

Dimensions in mm

| a  | a1   | b    | b1 | b2   | $\varnothing$ |
|----|------|------|----|------|---------------|
| 39 | 21.7 | 35.5 | 31 | 18.5 | 30            |

Dimensions in in.

| a    | a1   | b    | b1   | b2   | $\varnothing$ |
|------|------|------|------|------|---------------|
| 1.53 | 0.85 | 1.40 | 1.22 | 0.73 | 1.18          |