

## XSZB108

Inductive proximity sensors XS, accessory for sensor, Ø 8 mm, fixing clamp with indexing, plastic



### Main

Range of Product	Telemecanique Inductive proximity sensors XS
Accessory / separate part category	Mounting and fixing accessories
Accessory / Separate Part Type	Fixing clamp
Accessory / separate part designation	Fixing clamp
Accessory / separate part destination	Cylindrical M8 sensor
Material	Plastic

### Complementary

Product Compatibility	XU cylindrical M8 XS cylindrical M8
Net Weight	0.01 lb(US) (0.006 kg)

### Ordering and shipping details

Category	22499-SENSORS ACCESSORIES
Discount Schedule	DS2
GTIN	3389110914023
Nbr. of units in pkg.	1
Package weight(Lbs)	0.32 oz (9.0 g)
Returnability	Yes
Country of origin	FR

### Packing Units

Unit Type of Package 1	PCE
Package 1 Height	0.98 in (2.5 cm)
Package 1 width	1.18 in (3 cm)
Package 1 Length	1.97 in (5 cm)
Unit Type of Package 2	S01
Number of Units in Package 2	100
Package 2 Weight	2.44 lb(US) (1.109 kg)
Package 2 Height	5.91 in (15 cm)
Package 2 width	5.91 in (15 cm)
Package 2 Length	15.75 in (40 cm)

## Offer Sustainability

Sustainable offer status	Green Premium product
California proposition 65	WARNING: This product can expose you to chemicals including: Diisononyl phthalate (DINP), which is known to the State of California to cause cancer, and Di-isodecyl phthalate (DIDP), which is known to the State of California to cause birth defects or other reproductive harm. For more information go to <a href="http://www.P65Warnings.ca.gov">www.P65Warnings.ca.gov</a>
REACH Regulation	<a href="#">REACH Declaration</a>
EU RoHS Directive	Pro-active compliance (Product out of EU RoHS legal scope) <a href="#">EU RoHS Declaration</a>
Mercury free	Yes
RoHS exemption information	<a href="#">Yes</a>
Environmental Disclosure	<a href="#">Product Environmental Profile</a>
Circularity Profile	<a href="#">End Of Life Information</a>

## Contractual warranty

Warranty	18 months
----------	-----------

Dimensions

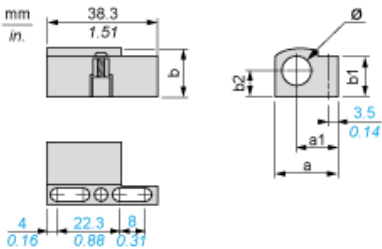

Dimensions in mm

a	a1	b	b1	b2	Ø
19.9	14.5	14	12.5	7.5	8

Dimensions in in.

a	a1	b	b1	b2	Ø
0.78	0.57	0.55	0.49	0.30	0.31