

APPROVED: _____

DATE: _____ TITLE: _____

Rev	AWO #	Description	Date	Appr
-		RELEASED	11/16/20	
A		UPDATE SPEC.	12/10/25	LW1/LZ

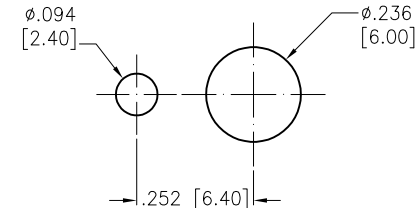
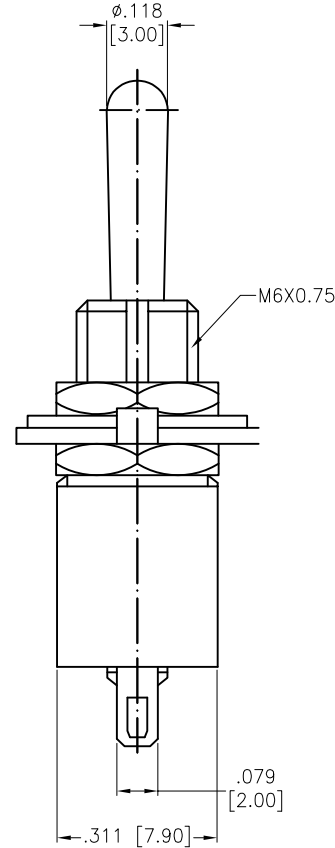
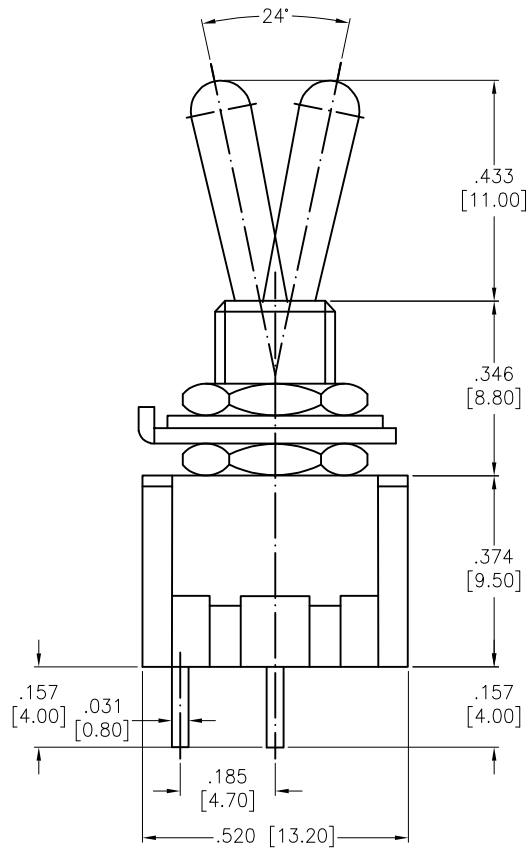

RECOMMENDED
PANEL CUT-OUT

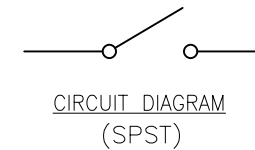

SW-T2-1X-A-A2-M1
A=ON-OFF
C=OFF-(ON)

SPECIFICATIONS:

Material:

Body: Bakelite, Color: Red

Lever: Brass, Nickel plated

Terminal: Brass, Silver plated

Electrical:

Rating: 3A @ 250V AC

6A @ 125V AC

Contact resistance: 20 mΩ max

Insulation resistance: 1000 MΩ min (500VDC)

Dielectric withstanding voltage: 1500V AC for 1 minute

Electrical Life: 6,000 cycles

Temperature Rating:

Operating temperature: -25°C to +85°C

Environmental:

Lead free, RoHS compliant.



UNLESS OTHERWISE SPECIFIED ALL DIMENSIONS
ARE INCHES [MM]. TOLERANCES: EXCEPT AS NOTED

.X	± .10	Ø.X	± .10
INCHES .XX	± .020	HOLES Ø.XX	± .015
.XXX	± .015	Ø.XXX	± .010

DRAWN OW 11/16/20

CHECKED AC 11/16/20

APPROVED

CONFIDENTIAL AND PROPRIETARY
© Adam Tech. All rights reserved. This document contains confidential and proprietary information belonging to Adam Tech. It is provided solely for design and reference purposes by authorized parties. Any reproduction, distribution, display, or disclosure to third parties, in whole or in part, without the prior written consent of Adam Tech, is strictly prohibited. Adam Tech retains all rights, including copyright, trademark, trade secret, and all other intellectual property rights worldwide.

ADAM
TECH

909 Rahway Avenue,
Union, NJ 07083
Phone: 908-687-5000
adam-tech.com

TITLE
**SWITCH, TOGGLE MINIATURE, SPST,
ON-OFF, OFF-(ON), SOLDER TYPE**

SIZE X	PART NO. SW-T2-1X-A-A2-M1	REV. A
REF: S00204C	SCALE: NTS	SHEET 1 OF 1