

APPROVED: _____
 DATE: _____ TITLE: _____

Rev	AWO #	Description	Date	Appr
-		RELEASED	03/23/07	
A		REVISED SHAPE	10/09/08	
B		REDRAWN	7/28/10	
C		REVISED SPEC.	2/22/12	
D		REVISED DIM.	3/10/14	HR/EH
E		UPDATED SPEC	7/4/16	HR/LL

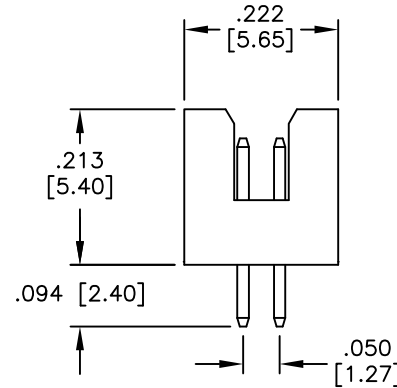
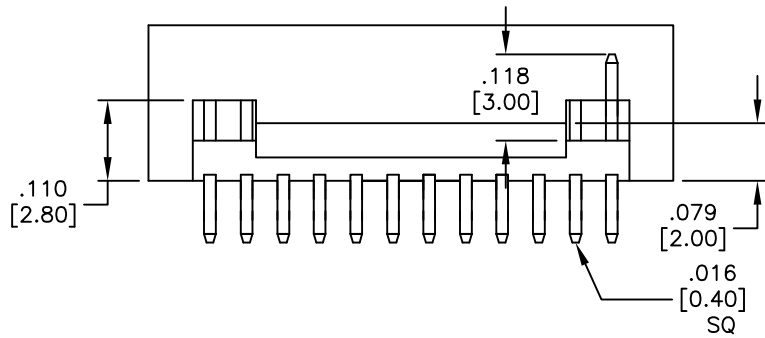
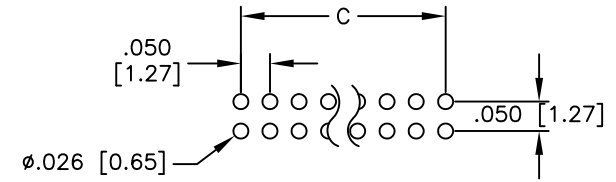
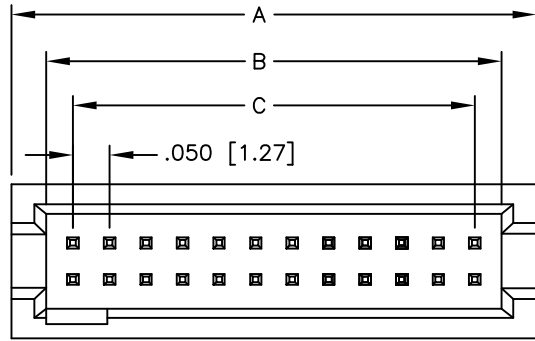

SPECIFICATIONS:

Material:
 Insulator: Hi-temp thermoplastic, rated UL 94V-0
 Insulator color: Black
 Contacts: Brass
 Plating:
 Gold flash over Nickel underplate on contact area,
 Tin over Copper underplate on tails.
 Electrical:
 Current rating: 1 Amp
 Contact resistance: 10 mohms max. @ DC 100 mA
 Insulation resistance: 5,000 Mohms min. @ 500 VDC
 Dielectric withstanding voltage: 500 VAC for 1 minute
 Temperature Rating:
 Operating temperature: -40°C to +105°C
 Environmental:
 Lead free, RoHS compliant.



Positions: 10 thru 92

A = .050 [1.27] x No. of Positions Per Row + .120 [3.06]
 B = .050 [1.27] x No. of Positions Per Row + .025 [0.64]
 C = .050 [1.27] x No. of Spaces Per Row

UNLESS OTHERWISE SPECIFIED ALL DIMENSIONS ARE INCHES [MM] TOLERANCES: EXCEPT AS NOTED		ADAM TECH 909 Rahway Avenue, Union, NJ 07083 Phone: 908-687-5000 Fax: 908-687-5710	
INCHES HOLES			
.X ± .10	∅X ± .10	TITLE .050 [1.27] PITCH SHROUDED MALE HEADER DUAL ROW DIP TYPE, SELECTIVE GOLD PLATED	
.XX ± .020	∅XX ± .015		
.XXX ± .015	∅XXX ± .010	SIZE X PART NO. HSH-XX-SG REV. E	
APPROVALS		DATE	
DRAWN AY		7/28/10	
CHECKED AH		7/28/10	
APPROVED		REF: S00059T SCALE: NTS SHEET 1 OF 1	