

6

5

4

3

2

1

APPROVED: _____

DATE: _____ TITLE: _____

Rev	AWO #	Description	Date	Appr
-		RELEASED	4/18/05	
A		REDRAW	9/14/11	

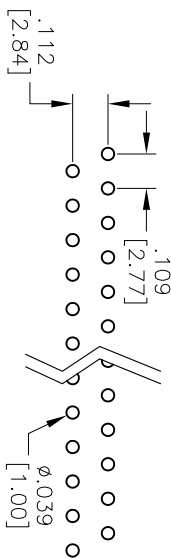
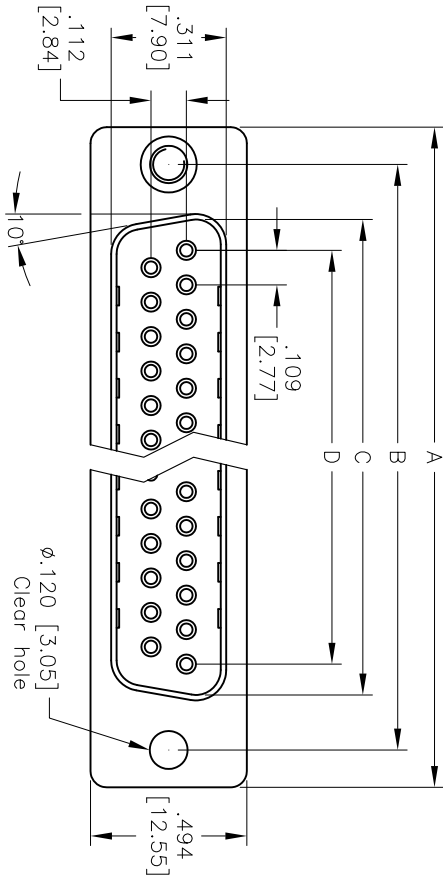

Recommended PCB Layout

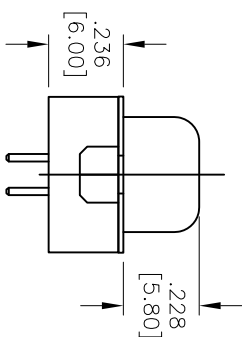
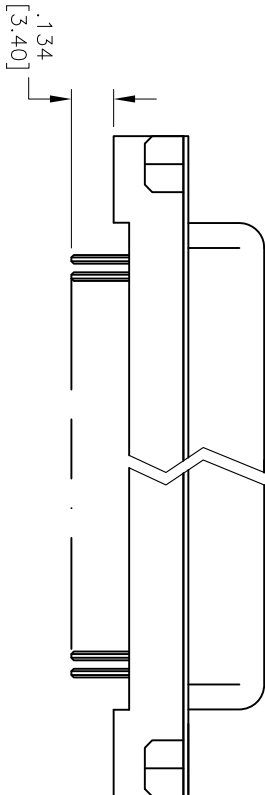

SPECIFICATIONS:

Material:

Insulator: PBT, glass reinforced, rated UL 94V-0

Insulator color: Black

Contacts: Copper ally

Nut: Brass, Nickel plated

Shell: SPCC

Screwlock: Brass, Nickel plated

Plating:

Gold flash over Nickel underplate overall

Electrical:

Operating voltage: 250 VAC max

Current rating: 1 Amps max

Contact resistance: 20 mohms max

Insulation resistance: 1,000 Mohms min

Dielectric withstanding voltage: 1,000 VAC for 1 minute

Temperature Rating:

Operating temperature: -65°C to +125°C

Environmental:

Lead free, RoHS compliant



DXXX	NO. OF CONTACTS	DIMENSIONS			
		A	B	C	D
DE09	9	1.213 [30.81]	.984 [24.99]	.643 [16.33]	.436 [11.08]
DA15	15	1.541 [39.14]	1.312 [33.32]	.971 [24.66]	.763 [19.39]
DB25	25	2.088 [53.04]	1.852 [47.04]	1.511 [38.38]	1.309 [33.24]
DC37	37	2.729 [69.32]	2.500 [63.50]	2.159 [54.84]	1.963 [49.86]

ADAM TECH

909 Rahway Avenue, Union, NJ 07083

Phone: 908-687-5000 Fax: 908-687-5710

D-SUB SOCKET, FLUSH MOUNT
STRAIGHT PCB TAIL

UNLESS OTHERWISE SPECIFIED ALL DIMENSIONS ARE INCHES [MM] TOLERANCES: EXCEPT AS NOTED INCHES .X ± .10 .XX ± .020 .XXX ± .015 HOLE ØX ± .10 ØXX ± .015 ØXXX ± .010		DATE		TITLE	
APPROVALS		DATE		D-SUB SOCKET, FLUSH MOUNT STRAIGHT PCB TAIL	
DRAWN	SS	4/18/05		SIZE	
CHECKED				X	
APPROVED				PART NO.	
				DXXX-SA-M1	
				REV.	
				A	

APPROVED

SS

4/18/05

X

PART NO.

DXXX-SA-M1

REV.

A

APPROVED

SS

4/18/05

X

PART NO.

DXXX-SA-M1

REV.

A

APPROVED

SS

4/18/05

X

PART NO.

DXXX-SA-M1

REV.

A

APPROVED

SS

4/18/05

X

PART NO.

DXXX-SA-M1

REV.

A

APPROVED

SS

4/18/05

X

PART NO.

DXXX-SA-M1

REV.

A

APPROVED

SS

4/18/05

X

PART NO.

DXXX-SA-M1

REV.

A

APPROVED

SS

4/18/05

X

PART NO.

DXXX-SA-M1

REV.

A

APPROVED

SS

4/18/05

X

PART NO.

DXXX-SA-M1

REV.

A

APPROVED

SS

4/18/05

X

PART NO.

DXXX-SA-M1

REV.

A

APPROVED

SS

4/18/05

X

PART NO.

DXXX-SA-M1

REV.

A

APPROVED

SS

4/18/05

X

PART NO.

DXXX-SA-M1

REV.

A

APPROVED

SS

4/18/05

X

PART NO.

DXXX-SA-M1

REV.

A

APPROVED

SS

4/18/05

X

PART NO.

DXXX-SA-M1

REV.

A

APPROVED

SS

4/18/05

X

PART NO.

DXXX-SA-M1

REV.

A

APPROVED

SS

4/18/05

X

PART NO.

DXXX-SA-M1

REV.

A

APPROVED

SS

4/18/05

X

PART NO.

DXXX-SA-M1

REV.

A

APPROVED

SS

4/18/05

X

PART NO.

DXXX-SA-M1

REV.

A

APPROVED

SS

4/18/05

X

PART NO.

DXXX-SA-M1

REV.

A

APPROVED

SS

4/18/05

X

PART NO.

DXXX-SA-M1

REV.

A

APPROVED

SS

4/18/05

X

PART NO.

DXXX-SA-M1

REV.

A

APPROVED

SS

4/18/05

X

PART NO.

DXXX-SA-M1

REV.

A

APPROVED

SS

4/18/05

X

PART NO.

DXXX-SA-M1

REV.

A

APPROVED

SS

4/18/05

X

PART NO.

DXXX-SA-M1

REV.

A

APPROVED

SS

4/18/05

X

PART NO.

DXXX-SA-M1

REV.

A

APPROVED

SS

4/18/05

X

PART NO.

DXXX-SA-M1

REV.

A

APPROVED

SS

4/18/05

X

PART NO.

DXXX-SA-M1

REV.

A

APPROVED

SS

4/18/05

X

PART NO.

DXXX-SA-M1

REV.

A

APPROVED

SS

4/18/05

X

PART NO.

DXXX-SA-M1

REV.

A

APPROVED

SS

4/18/05

X

PART NO.

DXXX-SA-M1

REV.

A

APPROVED

SS

4/18/05

X

PART NO.

DXXX-SA-M1

REV.

A

APPROVED

SS

4/18/05

X

PART NO.

DXXX-SA-M1

REV.

A

APPROVED

SS

4/18/05

X

PART NO.

DXXX-SA-M1

REV.

A

APPROVED

SS

4/18/05

X

PART NO.

DXXX-SA-M1

REV.

A

APPROVED

SS

4/18/05

X

PART NO.

DXXX-SA-M1

REV.

A

APPROVED

SS

4/18/05

X

PART NO.

DXXX-SA-M1

REV.

A

APPROVED

SS