

6

5

4

3

2

1

APPROVED: _____

DATE: _____ TITLE: _____

CUSTOM CABLE ASSEMBLIES ARE NON-CANCELLABLE / NON-RETURNABLE

Rev	AWO #	Description	Date	Appr
-		RELEASED	11/16/18	

P1

P2

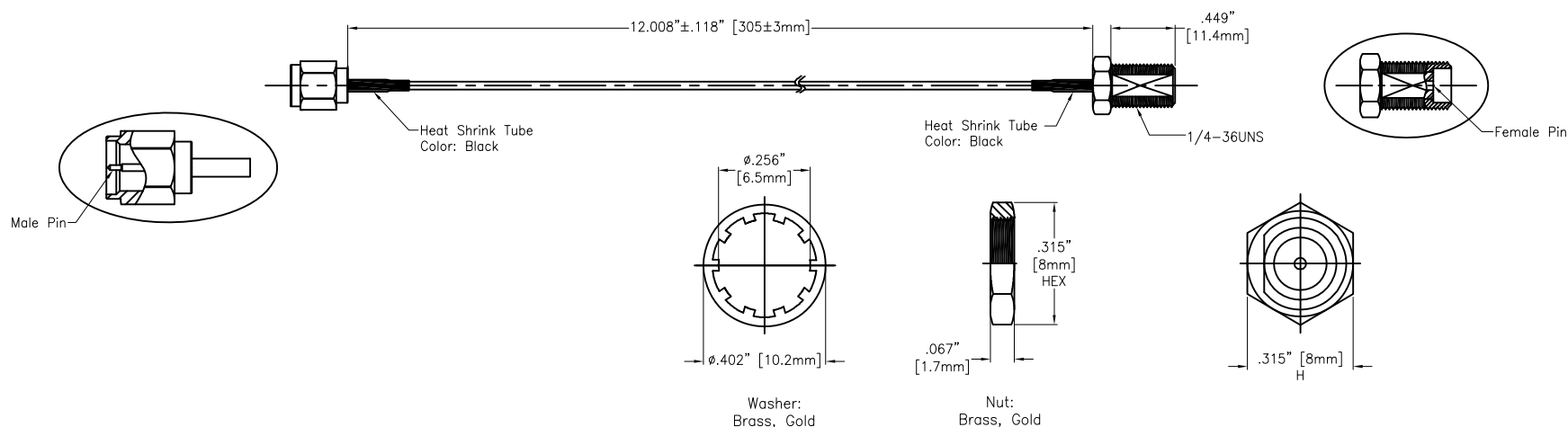
**SPECIFICATIONS:****Connector:**

P1= SMA Straight Plug Connector, Male Pin, Gold plated

P2= SMA Straight Jack Connector, Female Pin, Gold plated

Cable:

RG316

Electrical:

Impedance: 50 ohms

Frequency range: DC-6 GHz

Electrical Test:All Assemblies must be 100% Tested for
Shorts, Open, Continuity, and Physical Appearance.**Environmental:**

Lead free, RoHS compliant



UNLESS OTHERWISE SPECIFIED
ALL DIMENSIONS ARE INCHES [MM]
TOLERANCES: EXCEPT AS NOTED
INCHES HOLES
.X ± .10 Ø.X ± .10
.XX ± .020 Ø.XX ± .015
.XXX ± .015 Ø.XXX ± .010

APPROVALS		DATE
DRAWN	AY	11/16/18
CHECKED	AC	11/16/18
APPROVED		

ADAM
TECH
INTERCONNECTS

909 Rahway Avenue,
Union, NJ 07083
Phone: 908-687-5000
Fax: 908-687-5710

TITLE
CUSTOM ASSEMBLY, SMA ST PLUG TO
SMA ST JACK, RG316 CABLE

SIZE	PART NO.	REV.
X	CA#DKCA1-305L5-APAJ	-
REF: S00291T	SCALE: NTS	SHEET 1 OF 1