

Features

For Use with IP50 Linear Array Lights

Models

Model	For Use With Linear Array Models
LEDLAPFK145	LED_LA145X..
LEDLAPFK290	LED_LA290X..
LEDLAPFK435	LED_LA435X..
LEDLAPFK580	LED_LA580X..
LEDLAPFK870	LED_LA870X..
LEDLAPFK1160	LED_LA1160X..

Installing the Polarizer Filter

1. Clean the linear array window with glass cleaner and a lint-free cloth.
2. Check for any remaining dust on the window surface.
3. Peel away the first 2 to 3 inches of the clear backing from one end of the polarizer filter and fold the peeled backing material back onto itself.
4. With the clear backing side down, position the filter over the linear array window without allowing the exposed adhesive to contact the window surface.
5. Align the end of the filter that still has the backing in place, then press the end with the exposed adhesive down onto the window surface to lock the filter in place.
6. Lift up the other end of the filter, then grasp the end of the clear backing underneath and slowly pull it along the length of the window.
7. Press down the filter by sliding a finger along the top as the adhesive becomes exposed underneath. Continue peeling and pressing until the backing is fully removed.
8. Press from the center of the filter to the edges, repeating over the entire surface of the filter. This smooths out any trapped air bubbles and fully sets the adhesive.
9. Peel off the white paper and then the clear plastic film on the top surface.

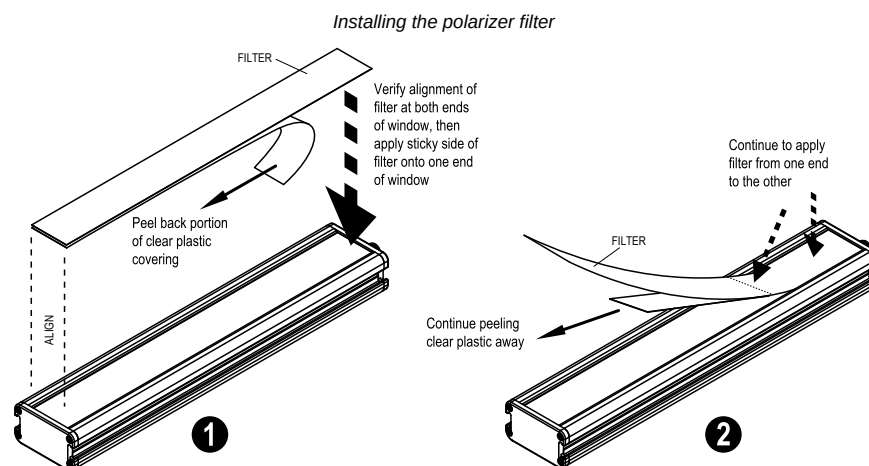

NOTE: Careful application of the filter will avoid trapped air bubbles but if they do occur they will not compromise the light quality or the polarizer function.

Banner Engineering Corp Limited Warranty

Banner Engineering Corp. warrants its products to be free from defects in material and workmanship for one year following the date of shipment. Banner Engineering Corp. will repair or replace, free of charge, any product of its manufacture which, at the time it is returned to the factory, is found to have been defective during the warranty period. This warranty does not cover damage or liability for misuse, abuse, or the improper application or installation of the Banner product.

THIS LIMITED WARRANTY IS EXCLUSIVE AND IN LIEU OF ALL OTHER WARRANTIES WHETHER EXPRESS OR IMPLIED (INCLUDING, WITHOUT LIMITATION, ANY WARRANTY OF MERCHANTABILITY OR FITNESS FOR A PARTICULAR PURPOSE), AND WHETHER ARISING UNDER COURSE OF PERFORMANCE, COURSE OF DEALING OR TRADE USAGE.

This Warranty is exclusive and limited to repair or, at the discretion of Banner Engineering Corp., replacement. **IN NO EVENT SHALL BANNER ENGINEERING CORP. BE LIABLE TO BUYER OR ANY OTHER PERSON OR ENTITY FOR ANY EXTRA COSTS, EXPENSES, LOSSES, LOSS OF PROFITS, OR ANY INCIDENTAL, CONSEQUENTIAL OR SPECIAL DAMAGES RESULTING FROM ANY PRODUCT DEFECT OR FROM THE USE OR INABILITY TO USE THE PRODUCT, WHETHER ARISING IN CONTRACT OR WARRANTY, STATUTE, TORT, STRICT LIABILITY, NEGLIGENCE, OR OTHERWISE.**

Banner Engineering Corp. reserves the right to change, modify or improve the design of the product without assuming any obligations or liabilities relating to any product previously manufactured by Banner Engineering Corp. Any misuse, abuse, or improper application or installation of this product or use of the product for personal protection applications when the product is identified as not intended for such purposes will void the product warranty. Any modifications to this product without prior express approval by Banner Engineering Corp will void the product warranties. All specifications published in this document are subject to change; Banner reserves the right to modify product specifications or update documentation at any time. Specifications and product information in English supersede that which is provided in any other language. For the most recent version of any documentation, refer to: www.bannerengineering.com.

For patent information, see www.bannerengineering.com/patents.