



Safety position switch with separate actuator 5 directions of approaches Metal enclosure, 56 mm wide ASIsafe integrated AS-i status: 1:F-IN1, 2: F-IN2 3:AS-i/FAULT Slow-action contacts 1 NC with M12 connector 4-pole Channel 1 to NC, Channel 2 to M12 socket on the right

| | |
|-----------------------------------------------------------|-------------------------------------------------------------------------------------------------------------------------------------------------------------------------------------------------------------------------------------------------------------------------------------------------------------------------------------------------------------|
| product brand name | SIRIUS |
| product designation | Mechanical safety switches |
| product type designation | 3SF11 |
| manufacturer's article number | 3SE5000-0AV01 standard actuator, 3SE5000-0AV02 actuator with vertical fixing, 3SE5000-0AV03 actuator with transverse fixing, 3SE5000-0AV04 radius actuator left, 3SE5000-0AV05 universal actuator, 3SE5000-0AV06 radius actuator right |
| • of the optional actuators | |
| suitability for use safety switch | Yes |
| General technical data | |
| product function positive opening | Yes |
| insulation voltage rated value | 30 V |
| degree of pollution | class 3 |
| surge voltage resistance rated value | 0.8 kV |
| shock resistance according to IEC 60068-2-27 | 30 g / 11 ms |
| vibration resistance according to IEC 60068-2-6 | 0.35 mm/5 g |
| mechanical service life (operating cycles) typical | 1 000 000 |
| material of the enclosure of the switch head | metal enclosure |
| reference code according to IEC 81346-2 | B |
| active principle | mechanical |
| repeat accuracy | 0.1 mm |
| Substance Prohibitance (Date) | 03/01/2017 |
| SVHC substance name | Lead CAS-No. 7439-92-1 Lead monoxide (lead oxide) CAS-No. 1317-36-8 2-methyl-1-(4-methylthiophenyl)-2-morpholinopropan-1-one CAS-No. 71868-10-5 Melamine CAS-No. 108-78-1 6,6'-di-tert-butyl-2,2'-methylenedi-p-cresol CAS-No. 119-47-1 Diboron trioxide CAS-No. 1303-86-2 Imidazolidine-2-thione (2-imidazoline-2-thiol) CAS-No. 96-45-7 |
| Net Weight | 0.578 kg |
| minimum actuating force in directions of actuation | 10 N |
| length of the sensor | 124 mm |
| width of the sensor | 56 mm |
| Ambient conditions | |
| ambient temperature | -25 ... +60 °C -40 ... +80 °C |
| • during operation | |
| • during storage | |
| design of the switching contact | mechanical |
| number of NC contacts for auxiliary contacts | 2 |
| number of NO contacts for auxiliary contacts | 0 |
| Enclosure | |

| | |
|---------------------------------------------|----------------------|
| design of the housing | block, wide |
| material of the enclosure | metal |
| coating of the enclosure | cathodic dip coating |
| design of the housing according to standard | No |

Drive Head

| | |
|---------------------------------------------|------------------------------------------------------------------------------------------|
| design of the actuating element | without |
| design of the switching function | positive opening |
| circuit principle | slow-action contacts |
| number of switching contacts safety-related | 1 |
| design of plug-in connection | M12 plug, 4-pole: Pin 1 = ASI+ , Pin 2 = not assigned, Pin 3= ASI-, Pin 4 = not assigned |

Installation/ mounting/ dimensions

| | |
|-------------------|--------------|
| mounting position | any |
| fastening method | screw fixing |

Connections/ Terminals

| | |
|-------------------------------|----------|
| type of electrical connection | plug M12 |
|-------------------------------|----------|

Supply voltage

| | |
|-------------------------------------------------------------------|---------------------------------------------------------------------------|
| type of voltage of the supply voltage of the optional LED display | DC |
| supply voltage of LED | 24 V |
| • | |
| design of the interface for safety-related communication | ASIsafe via M12 plug, channel 2 looped through to M12 socket on the right |

Approvals Certificates

| | |
|--------------------------|-------|
| General Product Approval | other |
|--------------------------|-------|



[Miscellaneous](#)

[Confirmation](#)

| | |
|-------|-------------|
| other | Environment |
|-------|-------------|



[Environmental Con-
firmations](#)

Further information

Information on the packaging

<https://support.industry.siemens.com/cs/ww/en/view/109813875>

Information for data generation and storage

<https://support.industry.siemens.com/cs/ww/en/view/109995012>

Information- and Downloadcenter (Catalogs, Brochures,...)

<https://www.siemens.com/ic10>

Industry Mall (Online ordering system)

<https://mall.industry.siemens.com/mall/en/en/Catalog/product?mlfb=3SF1124-1QV10-1BA2>

Cax online generator

<https://support.automation.siemens.com/WW/CAXorder/default.aspx?lang=en&mlfb=3SF1124-1QV10-1BA2>

Service&Support (Manuals, Certificates, Characteristics, FAQs,...)

<https://support.industry.siemens.com/cs/ww/en/ps/3SF1124-1QV10-1BA2>

Image database (product images, 2D dimension drawings, 3D models, device circuit diagrams, EPLAN macros, ...)

https://www.automation.siemens.com/bilddb/cax_de.aspx?mlfb=3SF1124-1QV10-1BA2&lang=en

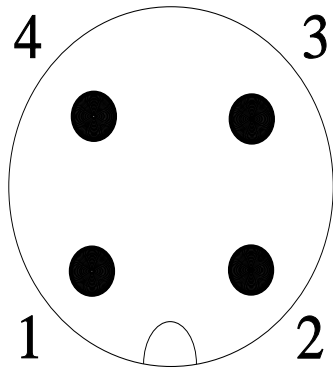
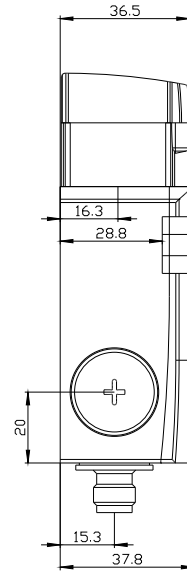
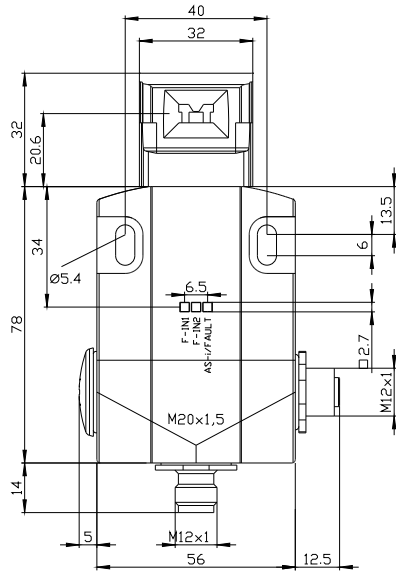

| | | |
|---|---|-------|
| 1 | → | ASI + |
| 2 | → | n. c. |
| 3 | → | ASI - |
| 4 | → | n. c. |

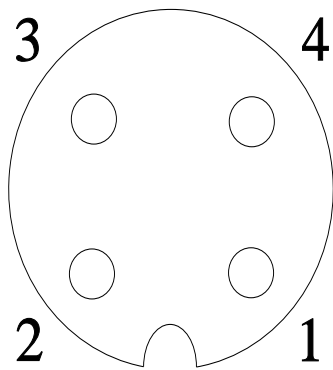

| | | |
|---|---|-------|
| 1 | → | Ch 2 |
| 2 | → | Ch 2 |
| 3 | → | n. c. |
| 4 | → | n. c. |

last modified:

4/4/2026