



HRC fuse base plastic Sz. 00 3-pole 160A 690V clamp connection 6 x 70 mm<sup>2</sup>

Model	
product brand name	SENTRON
product designation	LV HRC fuse base
design of the thread of the nut	M6
design of the thread of the connection screw	M6
General technical data	
number of poles	3
size of fuse system according to EN 60269-1	NH00
utilization category	Without
Supply voltage	
supply voltage	
• at AC	690 V
• at DC	690 V
Product details	
product component swivel-in mechanism	No
maximum short-circuit current breaking capacity (I <sub>cu</sub> )	
• at AC rated value	120 kA
• at DC rated value	120 kA
Connections	
connectable conductor cross-section on saddle-type connector	
• minimum	6 mm <sup>2</sup>
• maximum	70 mm <sup>2</sup>
tightening torque of the screw for securing the equipment maximum	3 N·m
tightening torque with screw-type terminals maximum	4 N·m
type of electrical connection	saddle-type connector
• for main current circuit	Saddle-type terminal
Mechanical Design	
height	140 mm
width	99 mm
depth	86 mm
fastening method	fixed mounting
fastening method bus-mounting	No
Net Weight	439 g
Approvals Certificates	
Environment	General Product Approval
	Maritime application



other

[Confirmation](#)



Further information

Information on the packaging

<https://support.industry.siemens.com/cs/ww/en/view/109813875>

Information for data generation and storage

<https://support.industry.siemens.com/cs/ww/en/view/109995012>

Information- and Downloadcenter (Catalogs, Brochures,...)

<https://www.siemens.com/lowvoltage/catalogs>

Industry Mall (Online ordering system)

<https://mall.industry.siemens.com/mall/en/en/Catalog/product?mlfb=3NH2032>

Service&Support (Manuals, Certificates, Characteristics, FAQs,...)

<https://support.industry.siemens.com/cs/ww/en/ps/3NH2032>

Image database (product images, 2D dimension drawings, 3D models, device circuit diagrams, ...)

[https://www.automation.siemens.com/bilddb/cax\\_en.aspx?mlfb=3NH2032](https://www.automation.siemens.com/bilddb/cax_en.aspx?mlfb=3NH2032)

CAX-Online-Generator

<https://www.siemens.com/cax>

Tender specifications

<https://www.siemens.com/specifications>

Characteristic curves

[https://curves.simaris.siemens.com/curves/<mmp\\_prod\\_noCOMP='HAUPT'></mmp\\_prod\\_no>](https://curves.simaris.siemens.com/curves/<mmp_prod_noCOMP='HAUPT'></mmp_prod_no>)

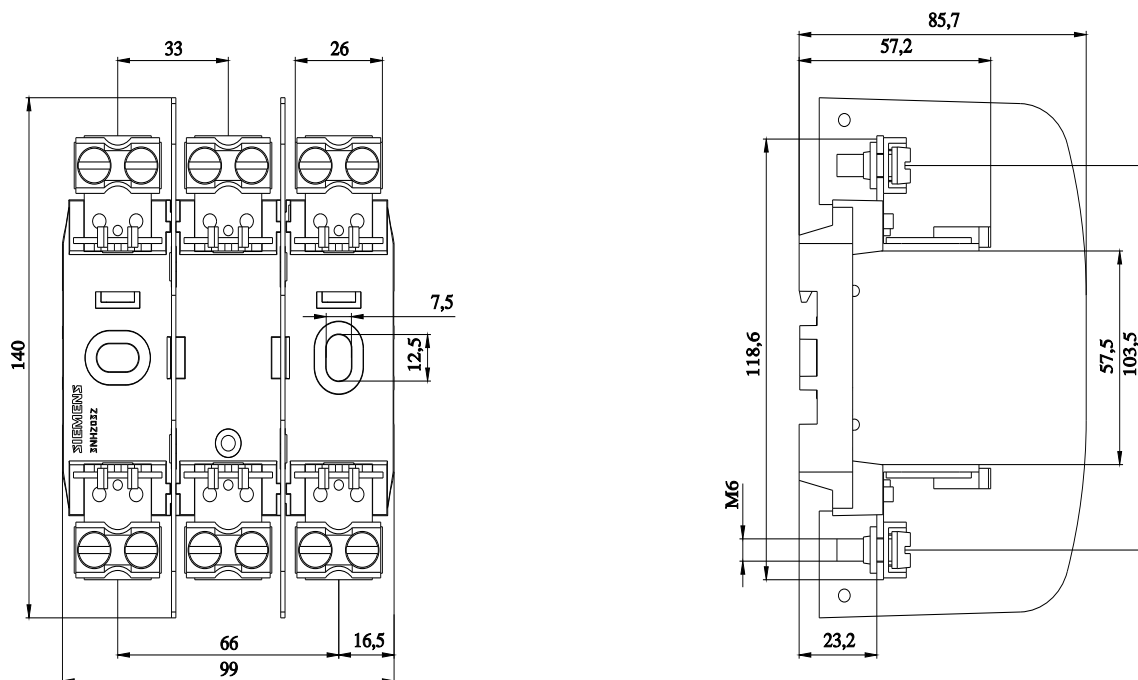



---

last modified:

8/8/2025 