

terminal cover on box terminal from 3RT1, 3RB2, 3RW407, 3RW444 3RW507 frame size S10 and S12

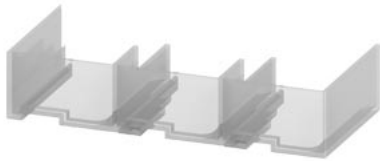

product brand name	SIRIUS
product category	Terminal covers
product designation	Terminal cover
design of the product	Additional touch protection to be fitted at the box terminals (2 units required per device), can be used for 3UF71.4-1BA00-0 or 3RW444.
product type designation	3RT19

General technical data

Substance Prohibittance (Date)	07/01/2006
Net Weight	0.038 kg

Approvals Certificates

Environment	General Product Approval	Maritime application
-------------	--------------------------	----------------------

[Environmental Confirmations](#)



Maritime application	other
----------------------	-------



[Confirmation](#)

[Miscellaneous](#)

Further information

Information on the packaging

<https://support.industry.siemens.com/cs/ww/en/view/109813875>

Information for data generation and storage

<https://support.industry.siemens.com/cs/ww/en/view/109995012>

Information- and Downloadcenter (Catalogs, Brochures,...)

<https://www.siemens.com/ic10>

Industry Mall (Online ordering system)

<https://mall.industry.siemens.com/mall/en/en/Catalog/product?mlfb=3RT1966-4EA2>

Cax online generator

<https://support.automation.siemens.com/WW/CAXorder/default.aspx?lang=en&mlfb=3RT1966-4EA2>

Service&Support (Manuals, Certificates, Characteristics, FAQs,...)

<https://support.industry.siemens.com/cs/ww/en/ps/3RT1966-4EA2>

Image database (product images, 2D dimension drawings, 3D models, device circuit diagrams, EPLAN macros, ...)

https://www.automation.siemens.com/bilddb/cax_de.aspx?mlfb=3RT1966-4EA2&lang=en

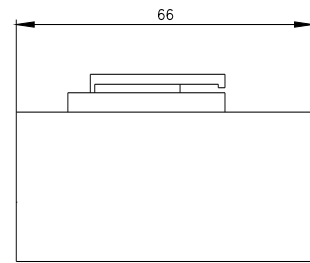
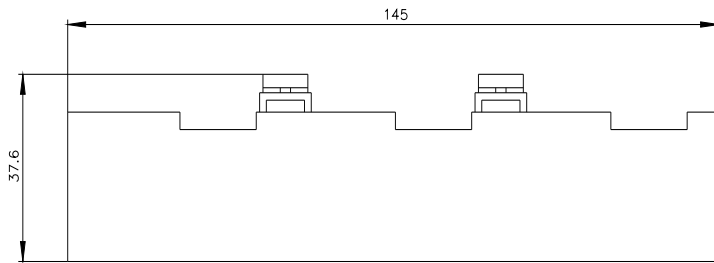

last modified:

11/11/2025 