

SIRIUS cable-operated switch Metal enclosure, 1x M20x1.5; 1 NO+1 NC, latching EN ISO 13850 and pushbutton release, with LED lamp 24 V DC, red, for wire lengths up to 50 m



| | |
|--|-----------------------|
| product brand name | SIRIUS |
| product designation | cable-operated switch |
| product type designation | 3SE7 |
| General technical data | |
| product function EMERGENCY STOP function | Yes |
| product component light source | Yes |
| insulation voltage rated value | 400 V |
| degree of pollution | class 3 |
| surge voltage resistance rated value | 6 kV |
| protection class IP | IP65 |
| mechanical service life (operating cycles) typical | 100 000 |
| thermal current | 6 A |
| reference code according to IEC 81346-2 | S |
| continuous current of the DIAZED fuse link gG | 6 A |
| Substance Prohibitance (Date) | 07/01/2006 |
| SVHC substance name | Lead - 7439-92-1 |
| Net Weight | 0.82 kg |
| Ambient conditions | |
| ambient temperature during operation | -25 ... +70 °C |
| number of NC contacts for auxiliary contacts | 1 |
| number of NO contacts for auxiliary contacts | 1 |
| operational current at AC-15 | |
| • at 240 V rated value | 6 A |
| • at 400 V rated value | 6 A |
| operational current at DC-13 | |
| • at 24 V rated value | 3 A |
| • at 250 V rated value | 0.27 A |
| Enclosure | |
| material of the enclosure | metal |
| material of the enclosure cover | Plastic |
| product component EMERGENCY STOP device | No |
| color | |
| • of the enclosure | black |
| • of the enclosure top part | grey |
| coating of the enclosure | painted |
| Display | |
| product function status display | No |
| Lamp | |
| color of the light source | red |

| | |
|--|-----------------------------------|
| circuit principle | Jump function |
| material of the contact | Silver |
| number of switching contacts safety-related | 1 |
| cable entry type | 1x M20 x 1,5 |
| Installation/ mounting/ dimensions | |
| fastening method | screw fixing |
| height | 105 mm |
| width | 167 mm |
| depth | 89 mm |
| Connections/ Terminals | |
| type of electrical connection | screw terminal |
| type of connectable conductor cross-sections | |
| • solid | 2x (0.5 ... 2.5 mm ²) |
| • finely stranded with core end processing | 2x (0.5 ... 2.5 mm ²) |
| • for AWG cables solid | 2x (20 ... 14) |
| • for AWG cables stranded | 2x (20 ... 14) |
| Supply voltage | |
| type of voltage of the supply voltage of the light source | DC |
| supply voltage 1 of the light source at DC rated value | 24 V |
| relative negative tolerance of the supply voltage | -15 % |
| relative positive tolerance of the supply voltage | 10 % |
| Safety related data | |
| proportion of dangerous failures with high demand rate according to SN 31920 | 50 % |
| B10 value with high demand rate according to SN 31920 | 100 000 |
| Approvals Certificates | |
| General Product Approval | other |



[Confirmation](#)

Environment

[Environmental Confirmations](#)

Further information

Information on the packaging

<https://support.industry.siemens.com/cs/ww/en/view/109813875>

Information for data generation and storage

<https://support.industry.siemens.com/cs/ww/en/view/109995012>

Information- and Downloadcenter (Catalogs, Brochures,...)

<https://www.siemens.com/ic10>

Industry Mall (Online ordering system)

<https://mall.industry.siemens.com/mall/en/en/Catalog/product?mlfb=3SE7140-1BD04>

Cax online generator

<https://support.automation.siemens.com/WW/CAXorder/default.aspx?lang=en&mlfb=3SE7140-1BD04>

Service&Support (Manuals, Certificates, Characteristics, FAQs,...)

<https://support.industry.siemens.com/cs/ww/en/ps/3SE7140-1BD04>

Image database (product images, 2D dimension drawings, 3D models, device circuit diagrams, EPLAN macros, ...)

https://www.automation.siemens.com/bilddb/cax_de.aspx?mlfb=3SE7140-1BD04&lang=en

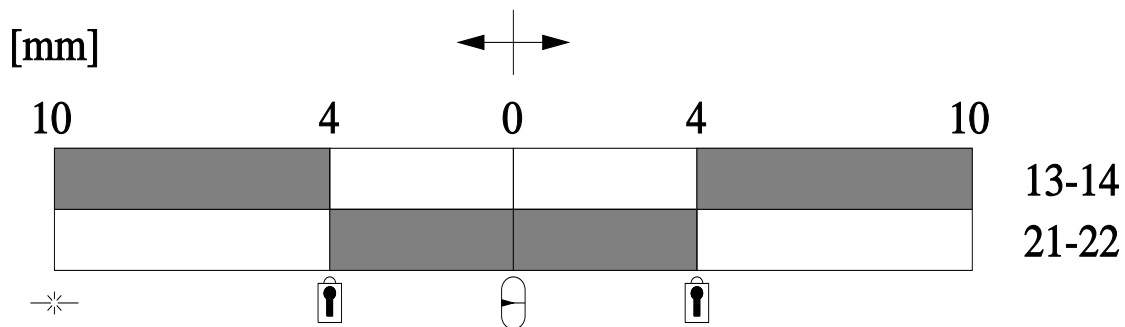
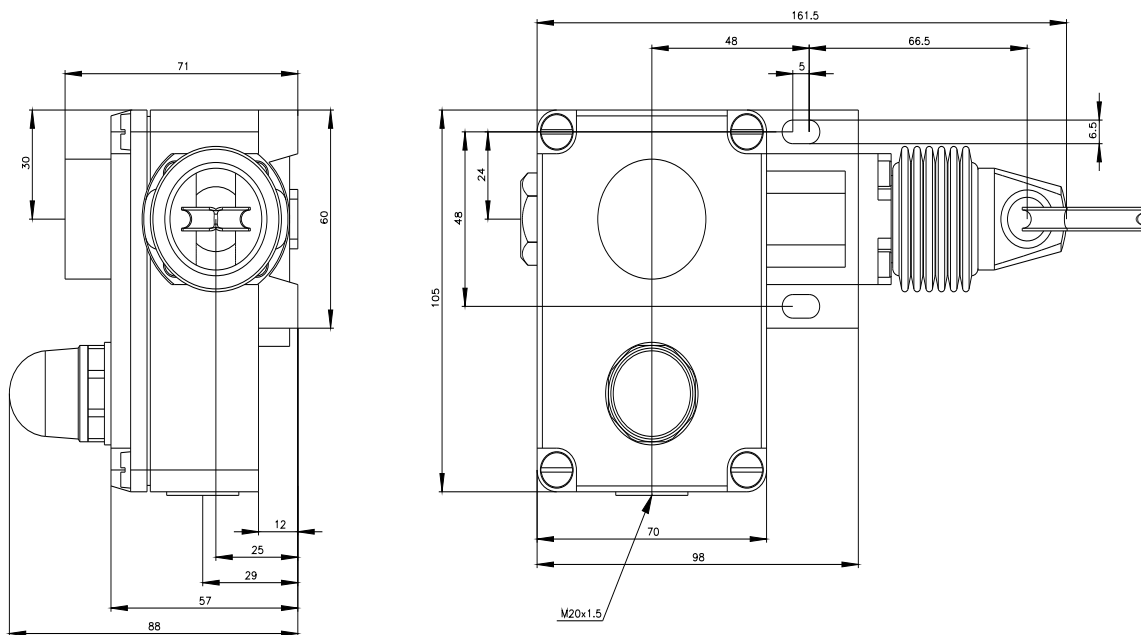

 Verriegelung / Locking

 Betätigungsrichtung / Travel

 Mittelstellung / Middle position

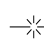
 Seilriss / Rope rip

 Schaltglied geschlossen / Contact element closed

 Schaltglied geöffnet / Contact element open

