







Withdrawable drive for contactors 3RT105, 3RT145 AC (50...60 Hz) / DC operation, 220 ... 240 V Operating mechanism: Standard,economy circuit Screw terminal

| | | | |
|---|---|--|---|
| product brand name | SIRIUS | | |
| product category | Solenoid coils | | |
| product designation | Changeover operating mechanism | | |
| product type designation | 3RT19 | | |
| General technical data | | | |
| Substance Prohibition (Date) | 05/01/2012 | | |
| Net Weight | 551 g | | |
| type of voltage of the control supply voltage | AC/DC | | |
| control supply voltage 1 at AC | 220 ... 240 V | | |
| • at 50 Hz | 220 ... 240 V | | |
| • at 60 Hz | 220 ... 240 V | | |
| control supply voltage 2 at AC | 240 V | | |
| • at 50 Hz rated value | 240 V | | |
| • at 60 Hz rated value | 240 V | | |
| control supply voltage 1 at DC | 220 ... 240 V | | |
| control supply voltage 2 at DC rated value | 240 V | | |
| apparent pick-up power of magnet coil at AC | 300 VA | | |
| • at 50 Hz | 300 VA | | |
| • at 60 Hz | 300 VA | | |
| inductive power factor with closing power of the coil | 0.9 | | |
| • at 50 Hz | 0.9 | | |
| • at 60 Hz | 0.9 | | |
| apparent holding power of magnet coil at AC | 5.8 VA | | |
| • at 50 Hz | 5.8 VA | | |
| • at 60 Hz | 5.8 VA | | |
| inductive power factor with the holding power of the coil | 0.8 | | |
| • at 50 Hz | 0.8 | | |
| • at 60 Hz | 0.8 | | |
| Approvals Certificates | | | |
| Environment | General Product Approval | EMV | Test Certificates |
| Environmental Con- firmations |  EG-Konf. |  UL |  |
| | |  RCM | Special Test Certifi- cate |
| Test Certificates | Maritime application | other | |



other Railway

[Miscellaneous](#)

[Special Test Certificate](#)

Further information

Information on the packaging

<https://support.industry.siemens.com/cs/ww/en/view/109813875>

Information for data generation and storage

<https://support.industry.siemens.com/cs/ww/en/view/109995012>

Information- and Downloadcenter (Catalogs, Brochures,...)

<https://www.siemens.com/ic10>

Industry Mall (Online ordering system)

<https://mall.industry.siemens.com/mall/en/en/Catalog/product?mlfb=3RT1955-5AP31>

Cax online generator

<https://support.automation.siemens.com/WW/CAXorder/default.aspx?lang=en&mlfb=3RT1955-5AP31>

Service&Support (Manuals, Certificates, Characteristics, FAQs,...)

<https://support.industry.siemens.com/cs/ww/en/ps/3RT1955-5AP31>

Image database (product images, 2D dimension drawings, 3D models, device circuit diagrams, EPLAN macros, ...)

https://www.automation.siemens.com/bilddb/cax_de.aspx?mlfb=3RT1955-5AP31&lang=en

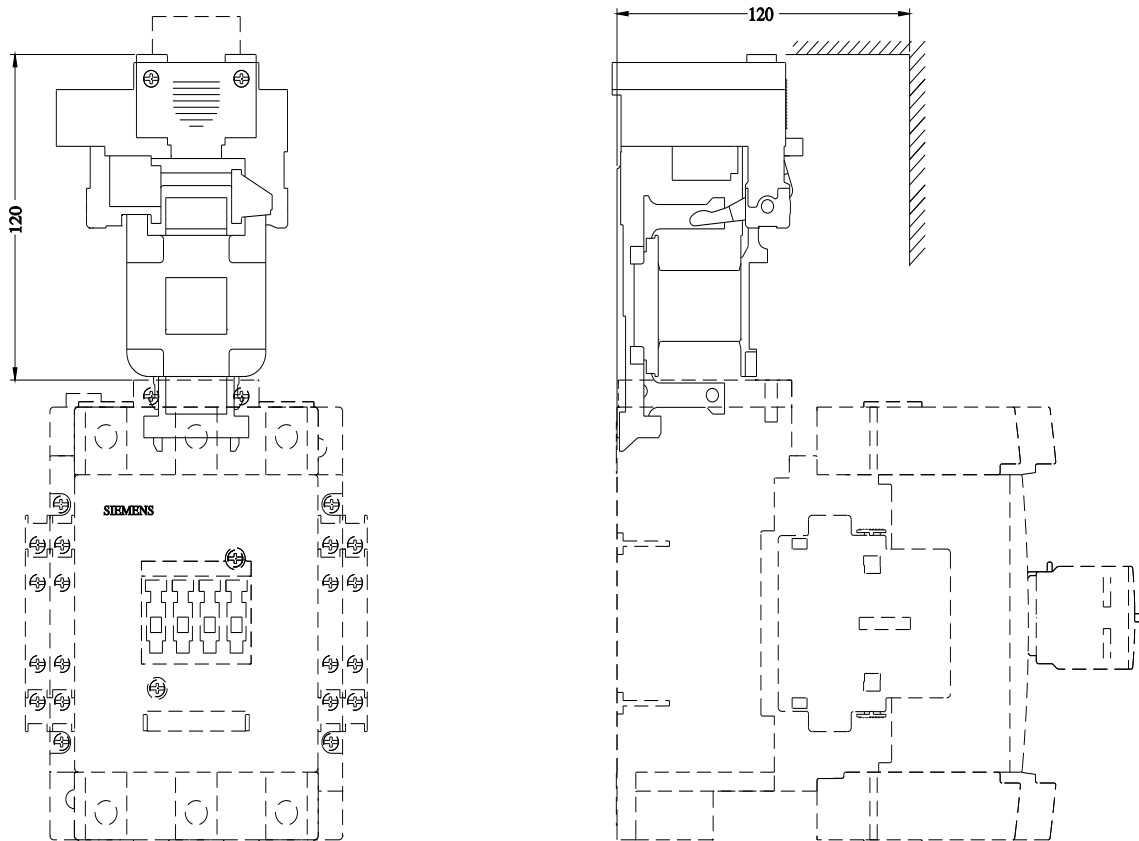

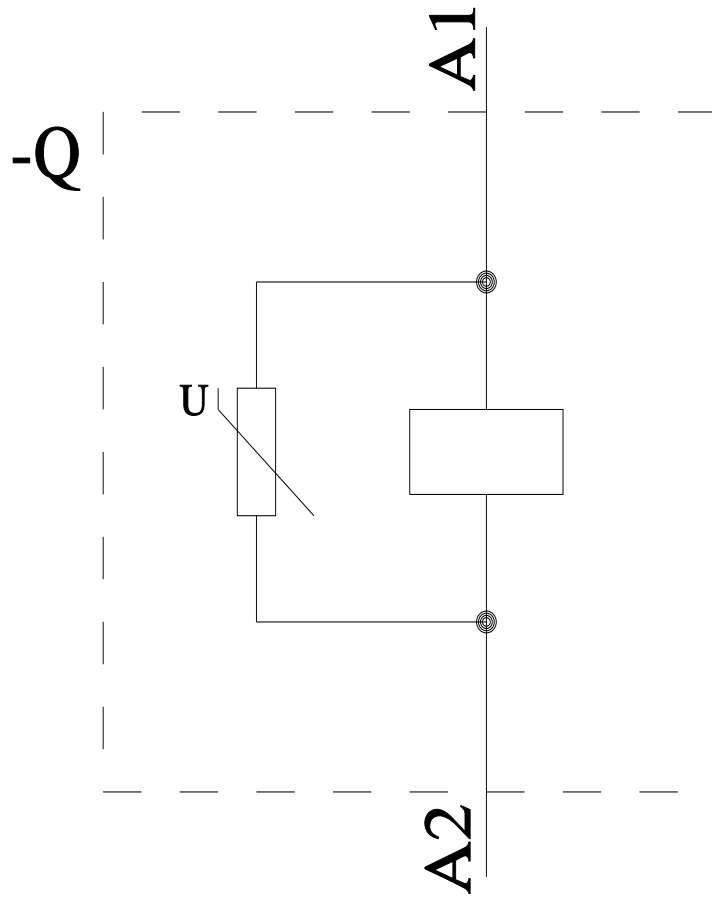

last modified:

4/2/2025 