



grounding screw for holder 3-fold, universal for plastic and metal (3SU1500-0AA10-0AA0), holder 3-fold, metal grounding of metal actuators for installation in front plates made of non-conductive materials



product brand name	SIRIUS ACT
product designation	Grounding stud
product type designation	3SU1
<b>General technical data</b>	
Substance Prohibittance (Date)	07/01/2006
Net Weight	1 g
<b>Connections/ Terminals</b>	
tightening torque	0.8 ... 1 N·m
<b>Ambient conditions</b>	
ambient temperature	
• during operation	-25 ... +70 °C
• during storage and transport	-40 ... +80 °C
<b>Accessories</b>	
material of accessory	Metal
color of accessory	Silver
<b>Approvals Certificates</b>	
Environmental Product Declaration	
• global warming potential [CO2 eq] / during manufacturing	0.625 kg
• global warming potential [CO2 eq] / during operation	0.235 kg
• global warming potential [CO2 eq] / after end of life	-0.267 kg
• global warming potential [CO2 eq] / total	0.593 kg
<b>Environment</b>	<b>General Product Approval</b>



[Environmental Con-  
firmations](#)



<b>General Product Ap- proval</b>	<b>Test Certificates</b>	<b>Maritime application</b>
---------------------------------------	--------------------------	-----------------------------



[Special Test Certific-  
ate](#)

[Type Test Certific-  
ates/Test Report](#)





[Confirmation](#)

Further information

Information on the packaging

<https://support.industry.siemens.com/cs/ww/en/view/109813875>

Information for data generation and storage

<https://support.industry.siemens.com/cs/ww/en/view/109995012>

Information- and Downloadcenter (Catalogs, Brochures,...)

<https://www.siemens.com/ic10>

Industry Mall (Online ordering system)

<https://mall.industry.siemens.com/mall/en/en/Catalog/product?mlfb=3SU1950-0KK80-0AA0>

Cax online generator

<https://support.automation.siemens.com/WW/CAXorder/default.aspx?lang=en&mlfb=3SU1950-0KK80-0AA0>

Service&Support (Manuals, Certificates, Characteristics, FAQs,...)

<https://support.industry.siemens.com/cs/ww/en/ps/3SU1950-0KK80-0AA0>

Image database (product images, 2D dimension drawings, 3D models, device circuit diagrams, EPLAN macros, ...)

[https://www.automation.siemens.com/bilddb/cax\\_de.aspx?mlfb=3SU1950-0KK80-0AA0&lang=en](https://www.automation.siemens.com/bilddb/cax_de.aspx?mlfb=3SU1950-0KK80-0AA0&lang=en)

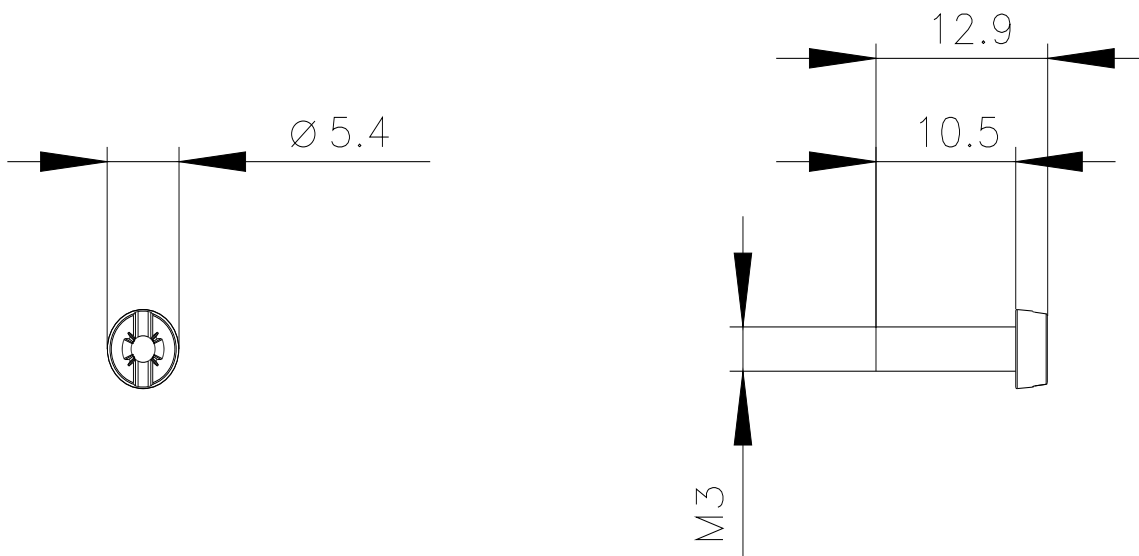

last modified:

4/2/2025