



Position switch Metal enclosure 40 mm according to EN 50041 Device connection 1x (M20 x 1.5) 1 NO/1 NC quick action contacts with rounded plunger Stainless steel plunger with 3 mm Overtravel functional at -40 °C Shock and vibration test according to EN 61373, Category 1B

|   |  |
|---|--|
| product brand name  | SIRIUS   |
| product designation   | Mechanical position switches                         |
| product type designation  | 3SE5   |
| manufacturer's article number                                     |  |
| • of the supplied basic switch                                    | <a href="#">3SE5112-0CA00-1AJ0</a>                   |
| • of the supplied switching contacts                              | <a href="#">3SE5000-0CA00</a>                        |
| suitability for use safety switch                                 | Yes  |
| <b>General technical data</b>                                     |  |
| product function positive opening                                 | Yes  |
| insulation voltage rated value                                    | 400 V  |
| degree of pollution   | class 3  |
| surge voltage resistance rated value                              | 6 kV   |
| protection class IP   | IP66/IP67  |
| shock resistance  |  |
| • according to IEC 60068-2-27                                     | 30g / 11 ms  |
| • for railway applications according to EN 61373                  | Category 1, Class B                                  |
| vibration resistance according to IEC 60068-2-6                   | 0.35 mm/5g   |
| mechanical service life (operating cycles) typical                | 15 000 000   |
| electrical endurance (operating cycles) at AC-15 at 230 V typical | 100 000  |
| thermal current   | 10 A   |
| material of the enclosure of the switch head                      | metal  |
| reference code according to IEC 81346-2                           | B  |
| continuous current of the C characteristic MCB                    | 1 A; for a short-circuit current smaller than 400 A  |
| continuous current of the quick DIAZED fuse link                  | 10 A; for a short-circuit current smaller than 400 A |
| continuous current of the DIAZED fuse link gG                     | 6 A  |
| active principle  | mechanical   |
| repeat accuracy   | 0.05 mm  |
| Substance Prohibitance (Date)                                     | 07/01/2006   |
| Net Weight  | 0.365 kg   |
| minimum actuating force in directions of actuation                | 20 N   |
| length of the sensor  | 103.5 mm   |
| width of the sensor   | 40 mm  |
| <b>Ambient conditions</b>   |  |
| ambient temperature   |  |
| • during operation  | -40 ... +85 °C                                       |
| • during storage  | -40 ... +90 °C                                       |
| explosion protection category for dust                            | none   |
| <b>Main circuit</b>   |  |
| design of the switching contact                                   | mechanical   |

|   |  |
|---|--|
| operating frequency rated value   | 50 ... 60 Hz   |
| number of NC contacts for auxiliary contacts  | 1  |
| number of NO contacts for auxiliary contacts  | 1  |
| operational current at AC-15 <ul style="list-style-type: none"> <li>at 24 V rated value</li> <li>at 125 V rated value</li> <li>at 240 V rated value</li> <li>at 400 V rated value</li> </ul>                          | 6 A<br>6 A<br>6 A<br>4 A   |
| operational current at DC-13 <ul style="list-style-type: none"> <li>at 24 V rated value</li> <li>at 125 V rated value</li> <li>at 250 V rated value</li> <li>at 400 V rated value</li> </ul>                          | 3 A<br>0.55 A<br>0.27 A<br>0.12 A  |
| <b>Enclosure</b>  |  |
| design of the housing   | block, narrow  |
| material of the enclosure   | metal  |
| coating of the enclosure  | cathodic dip coating   |
| design of the housing according to standard   | Yes  |
| <b>Drive Head</b>   |  |
| design of the actuating element   | Rounded plunger, high-grade steel plunger  |
| standard-compliant actuator head  | EN 50041, design B   |
| shape of the switch head  | rounded  |
| design of the switching function  | positive opening   |
| circuit principle   | snap-action contacts   |
| number of switching contacts safety-related   | 1  |
| cable entry type  | 1x (M20 x 1.5)   |
| <b>Installation/ mounting/ dimensions</b>   |  |
| mounting position   | any  |
| fastening method  | screw fixing   |
| <b>Connections/ Terminals</b>   |  |
| type of electrical connection   | screw terminal   |
| type of connectable conductor cross-sections <ul style="list-style-type: none"> <li>solid</li> <li>finely stranded with core end processing</li> <li>for AWG cables solid</li> <li>for AWG cables stranded</li> </ul> | 1x (0.5 ... 1.5 mm <sup>2</sup> ), 2x (0.5 ... 0.75 mm <sup>2</sup> )<br>1x (0.5 ... 1.5 mm <sup>2</sup> ), 2x (0.5 ... 0.75 mm <sup>2</sup> )<br>1x (20 ... 16), 2x (20 ... 18)<br>1x (20 ... 16), 2x (20 ... 18) |
| design of the interface for safety-related communication  | without  |
| <b>Communication/ Protocol</b>  |  |
| design of the interface   | without  |
| <b>Safety related data</b>  |  |
| product function suitable for safety function   | Yes  |
| service life maximum  | 20 a   |
| test wear-related service life necessary  | Yes  |
| proportion of dangerous failures <ul style="list-style-type: none"> <li>with low demand rate according to SN 31920</li> <li>with high demand rate according to SN 31920</li> </ul>                                    | 20 %<br>20 %   |
| B10 value with high demand rate according to SN 31920   | 1 000 000  |
| failure rate [FIT] with low demand rate according to SN 31920   | 100 FIT  |
| <b>ISO 13849</b>  |  |
| device type according to ISO 13849-1  | 3  |
| <b>Approvals Certificates</b>   |  |
| General Product Approval  |  |
| Functional Safety   |  |



[Type Examination Certificate](#)

[Type Test Certificates/Test Report](#)

[Type Test Certificates/Test Report](#)



[Confirmation](#)



[Environmental Confirmations](#)

#### Further information

##### Information on the packaging

<https://support.industry.siemens.com/cs/ww/en/view/109813875>

##### Information for data generation and storage

<https://support.industry.siemens.com/cs/ww/en/view/109995012>

##### Information- and Downloadcenter (Catalogs, Brochures,...)

<https://www.siemens.com/ic10>

##### Industry Mall (Online ordering system)

<https://mall.industry.siemens.com/mall/en/en/Catalog/product?mlfb=3SE5112-0CC02-1AJ0>

##### Cax online generator

<https://support.automation.siemens.com/WW/CAXorder/default.aspx?lang=en&mlfb=3SE5112-0CC02-1AJ0>

##### Service&Support (Manuals, Certificates, Characteristics, FAQs,...)

<https://support.industry.siemens.com/cs/ww/en/ps/3SE5112-0CC02-1AJ0>

##### Image database (product images, 2D dimension drawings, 3D models, device circuit diagrams, EPLAN macros, ...)

[https://www.automation.siemens.com/bilddb/cax\\_de.aspx?mlfb=3SE5112-0CC02-1AJ0&lang=en](https://www.automation.siemens.com/bilddb/cax_de.aspx?mlfb=3SE5112-0CC02-1AJ0&lang=en)

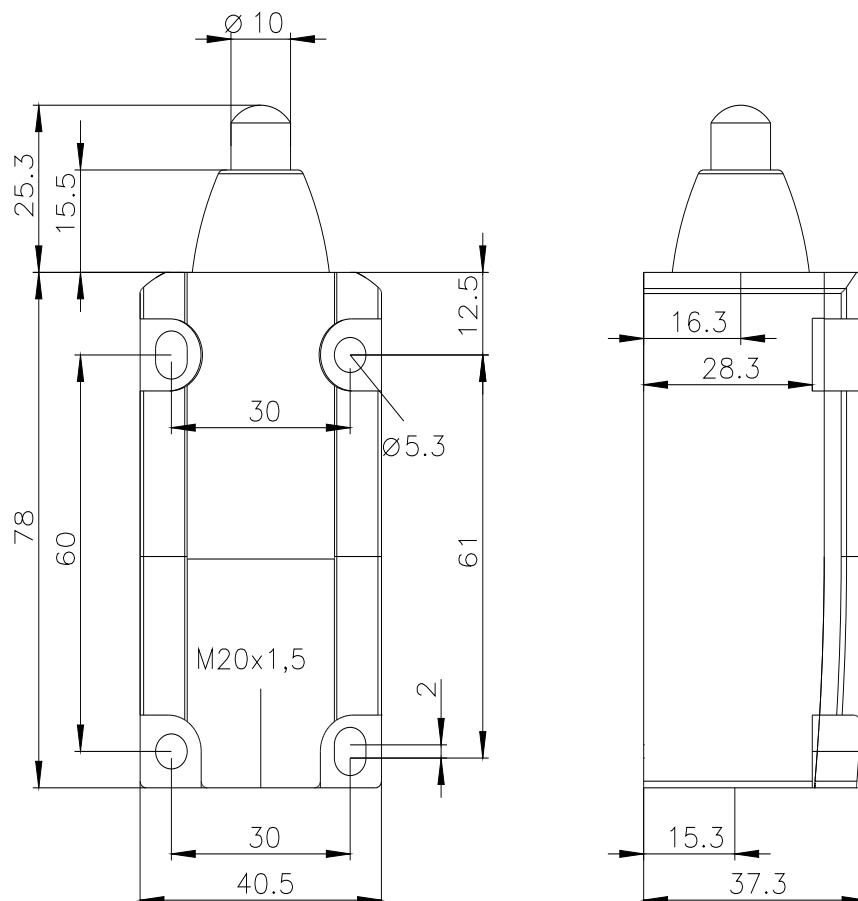

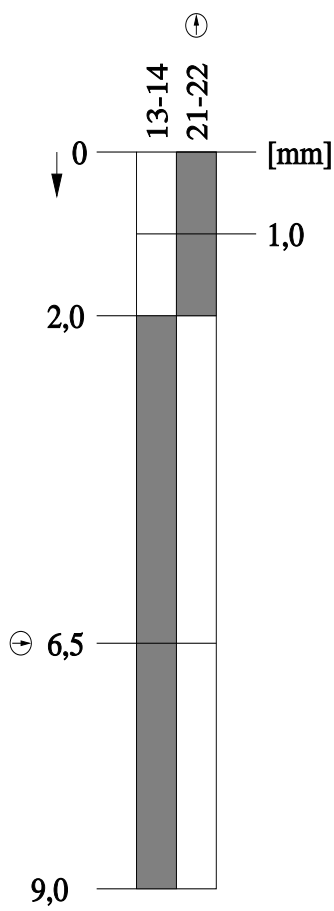
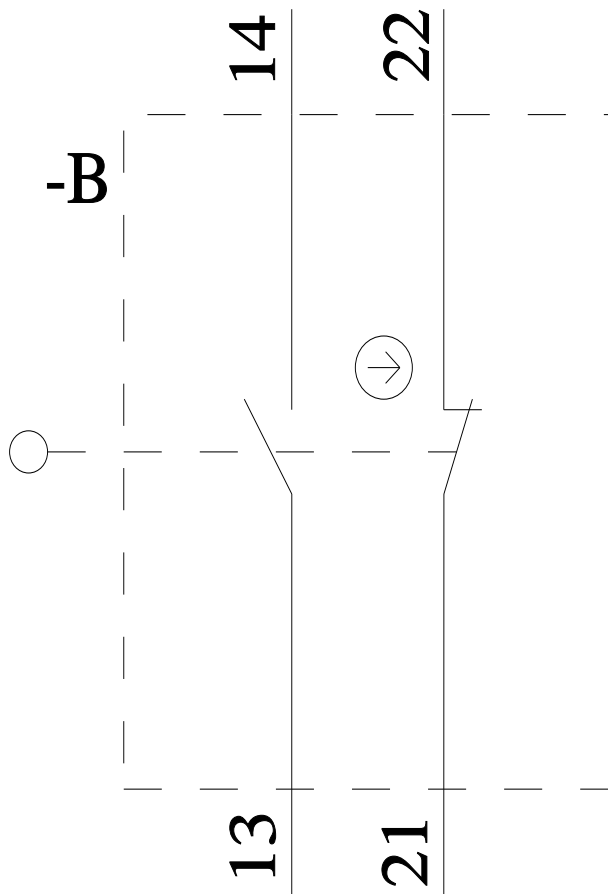

last modified:

12/7/2025