



AS-Interface mounting plate K60 for compact modules K60 for installation on standard mounting rail for 2 flat cables AS-i cable (yellow) and AS-i cable 24 V (black)

product brand name	SIRIUS
product category	accessories digital I/O modules for operation in the field, IP67 - K60
design of the product	K60 mounting plate for standard rail mounting
protection class IP	IP67 with screw-mounted K60 compact module
Substance Prohibitance (Date)	07/01/2006
Net Weight	91 g

Ambient conditions

ambient temperature	
• during operation	-25 ... +85 °C

Connections/ Terminals

type of electrical connection	insulation piercing method for AS-Interface flat cable
installation or assembly note	flat cable end in the module possible with additional seals (3RK1902-0AR00)

Approvals Certificates

Environment	General Product Approval	EMV	Maritime application
-------------	--------------------------	-----	----------------------

[Environmental Con-
firmations](#)



other



[Confirmation](#)

Further information

Siemens is working on the renewal of the current EAC certificates.
Please contact your local Siemens office on the status of validity of the EAC certification if you intend to import or offer to supply these products to an EAC relevant market (other than the sanctioned EAEU member states Russia or Belarus).
Siemens has decided to exit the Russian market (see here).
<https://press.siemens.com/global/en/pressrelease/siemens-wind-down-russian-business>
Information on the packaging
<https://support.industry.siemens.com/cs/ww/en/view/109813875>
Information for data generation and storage
<https://support.industry.siemens.com/cs/ww/en/view/109995012>
Information- and Downloadcenter (Catalogs, Brochures,...)
<https://www.siemens.com/ic10>
Industry Mall (Online ordering system)
<https://mall.industry.siemens.com/mall/en/en/Catalog/product?mlfb=3RK1901-0CB01>
Cax online generator

<https://support.automation.siemens.com/WW/CAXorder/default.aspx?lang=en&mlfb=3RK1901-0CB01>

Service&Support (Manuals, Certificates, Characteristics, FAQs,...)

<https://support.industry.siemens.com/cs/ww/en/ps/3RK1901-0CB01>

Image database (product images, 2D dimension drawings, 3D models, device circuit diagrams, EPLAN macros, ...)

https://www.automation.siemens.com/bilddb/cax_de.aspx?mlfb=3RK1901-0CB01&lang=en

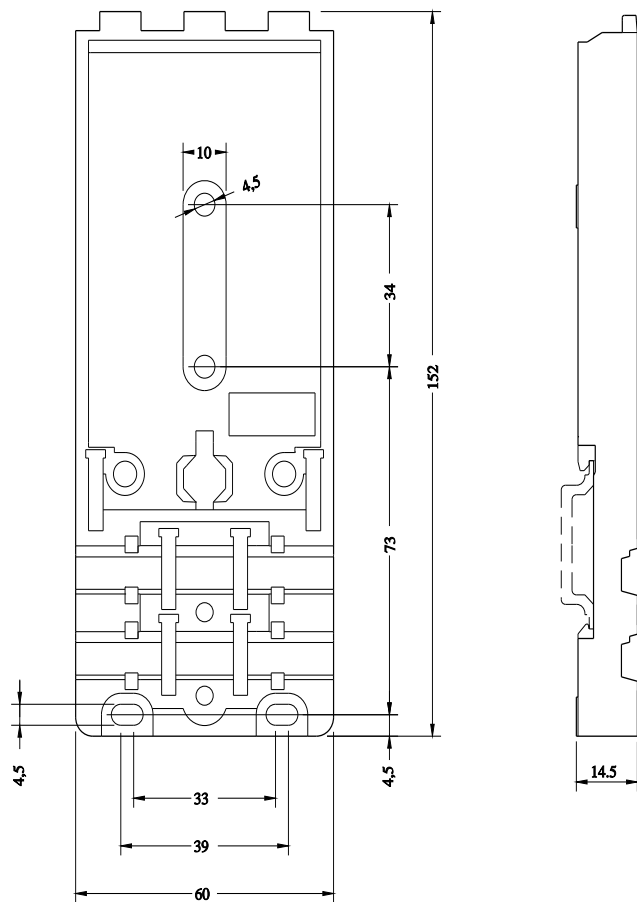

last modified:

12/3/2025 